

5/14/09

NOTES:
 1 TIE TO EXIST CURB AND GUTTER AT EXIST CONCRETE JOINT
 TRANSITION 2'-6" C&G TO MATCH EXIST GUTTER WIDTH AS NECESSARY
 2 TIE TO EXISTING CONCRETE SIDEWALK
 3 5' MONOLITHIC CONCRETE ISLAND (KEYED-IN)
 4 REMOVE EXIST CONCRETE ISLAND

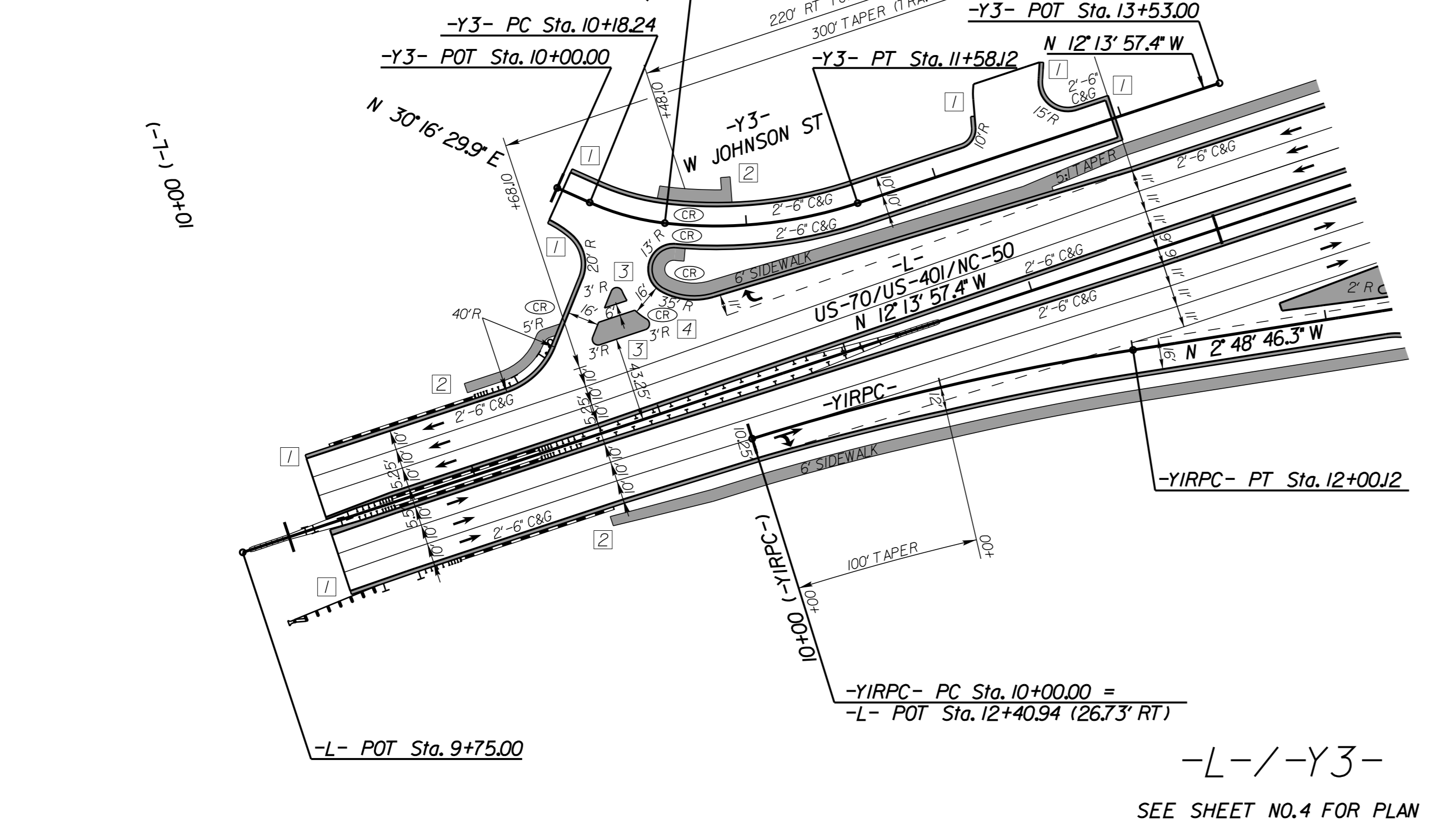

-L-/-Y3-
 SEE SHEET NO.4 FOR PLAN

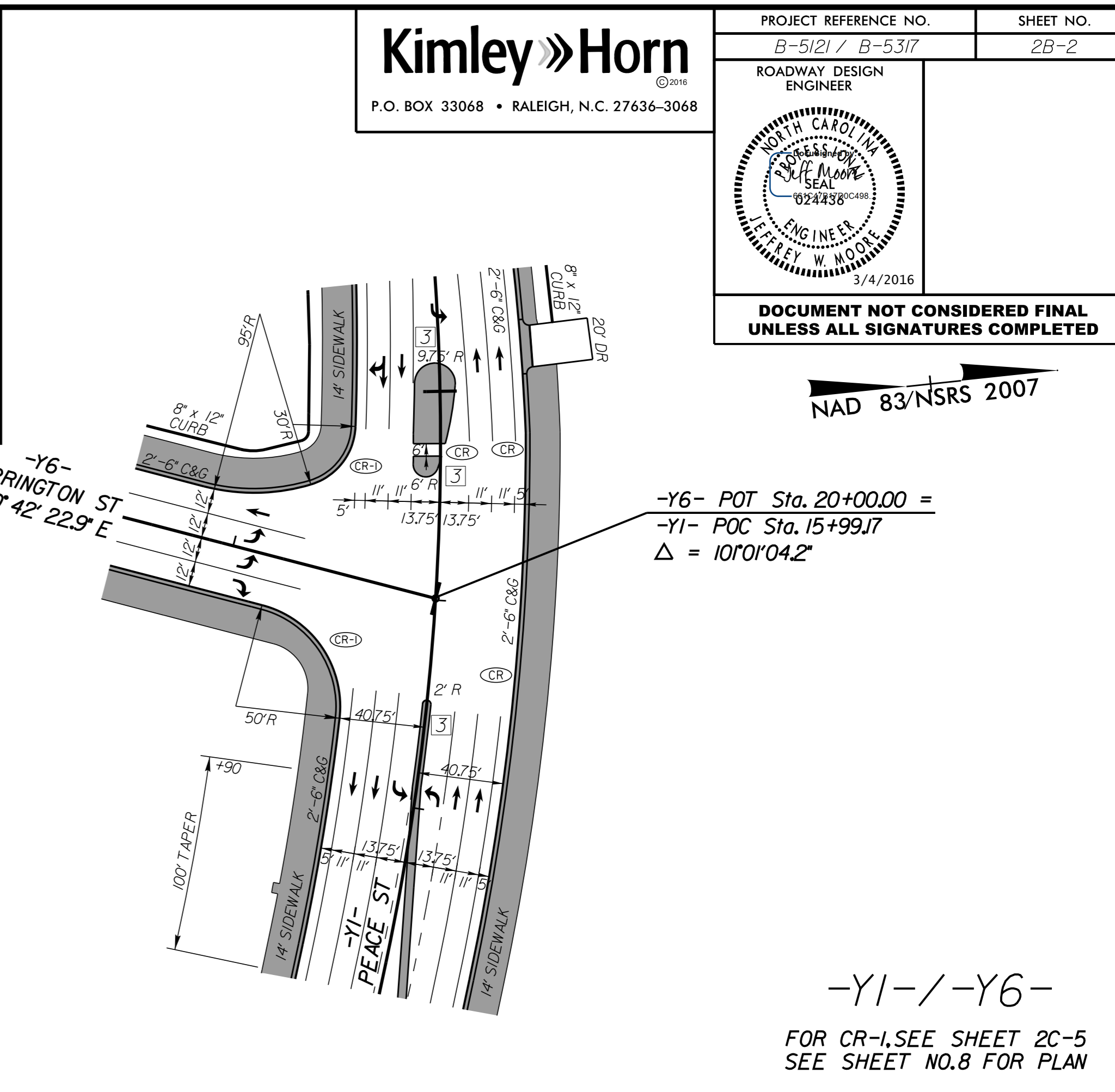
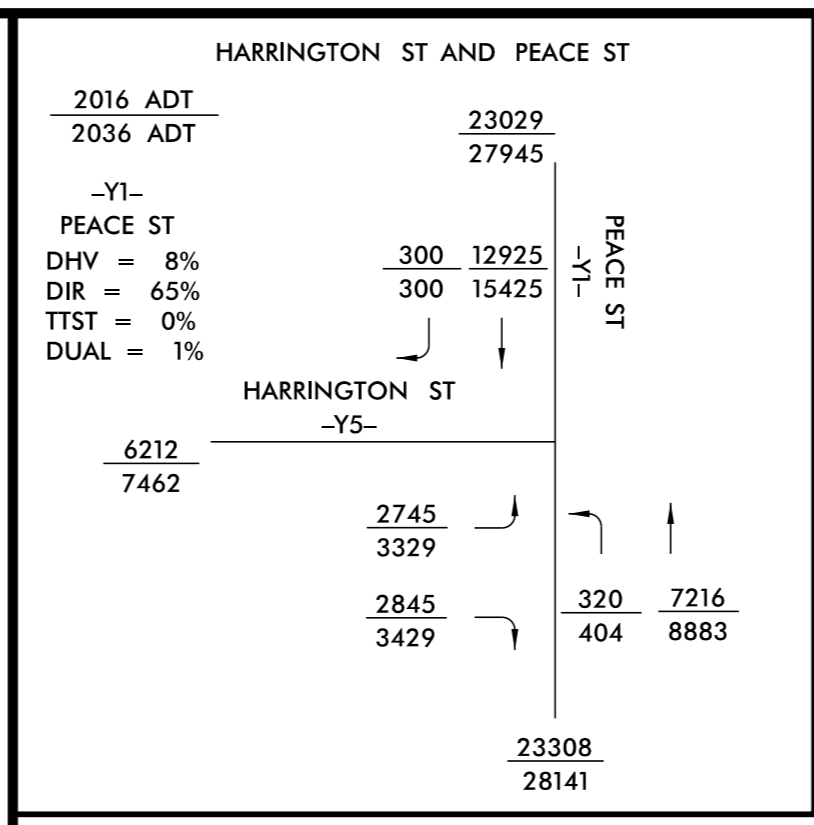

-Y1-/-Y6-
 FOR CR-1, SEE SHEET 2C-5
 SEE SHEET NO.8 FOR PLAN

Kimley Horn
 P.O. BOX 33068 • RALEIGH, N.C. 27636-3068

PROJECT REFERENCE NO. B-5121 / B-5317	SHEET NO. 2B-2
ROADWAY DESIGN ENGINEER	
DOCUMENT NOT CONSIDERED FINAL UNLESS ALL SIGNATURES COMPLETED	

2/02/2016

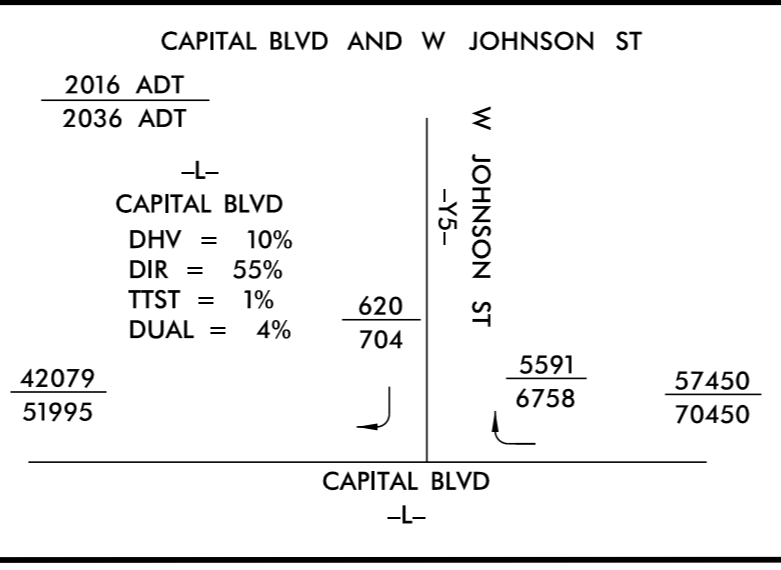
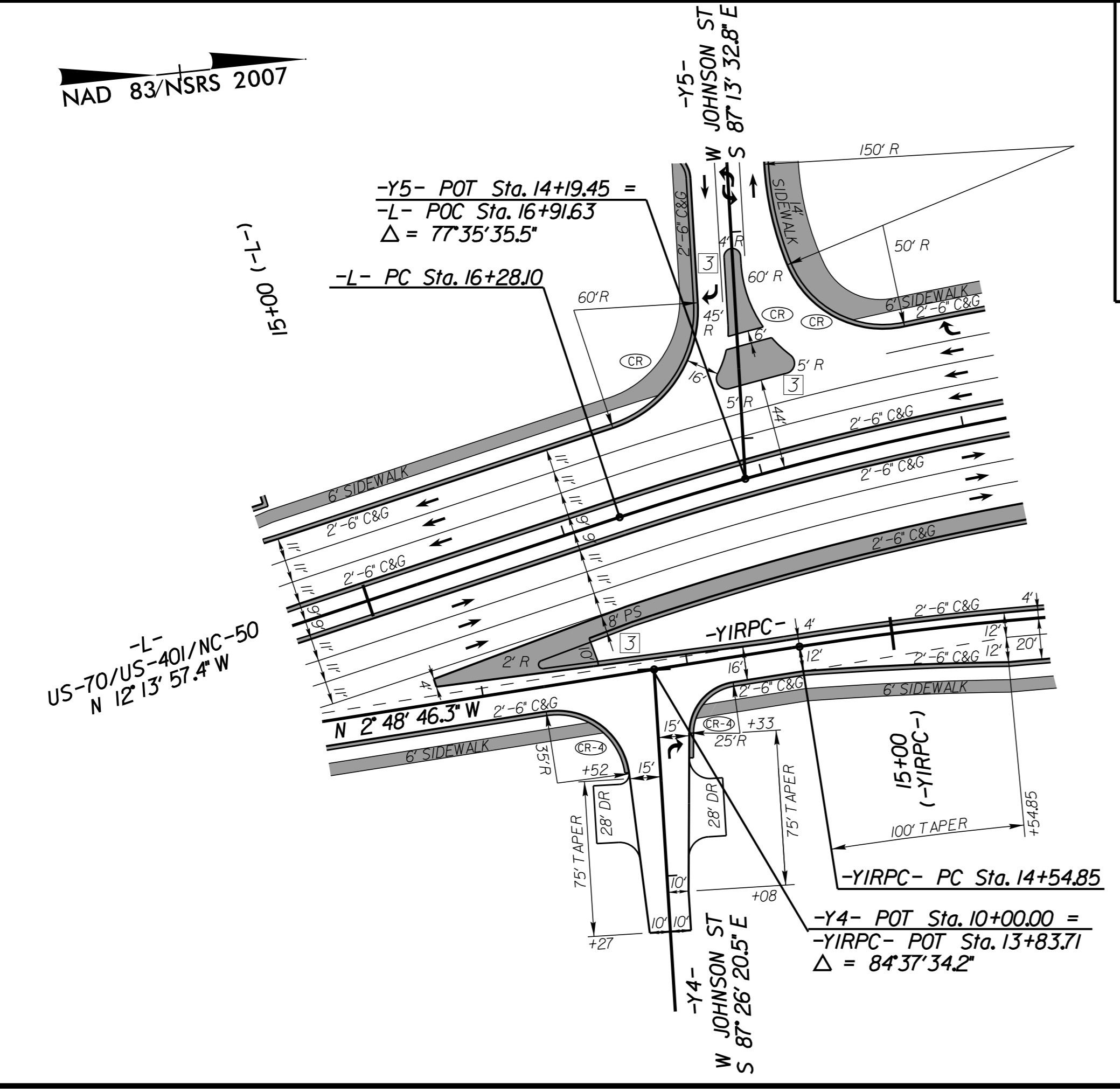

-L-/-Y5-
 -YIRPC-/-Y4-
 FOR CR-4, SEE SHEET 2C-5
 SEE SHEET NO.5 FOR PLAN

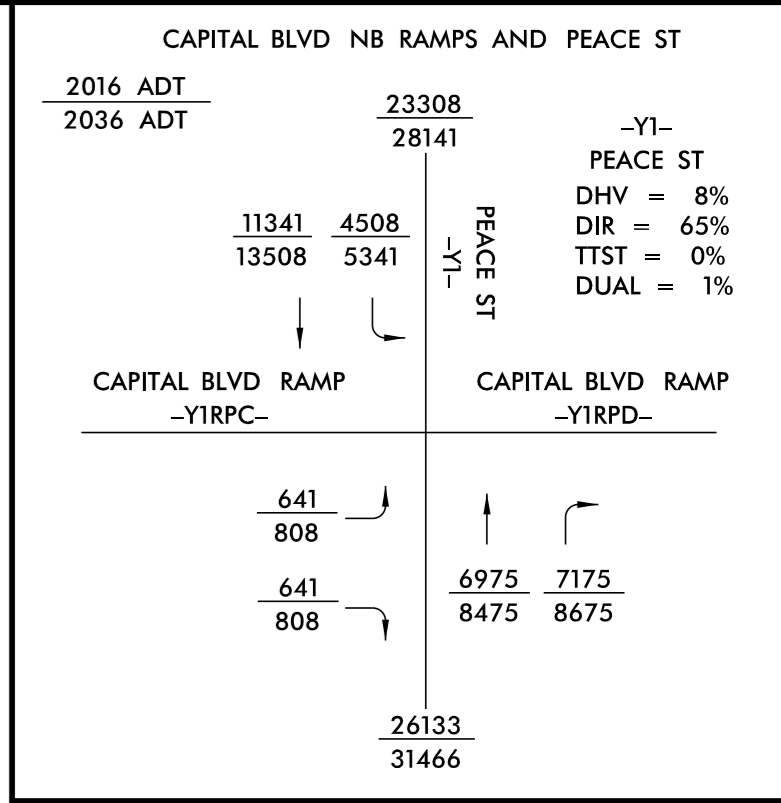
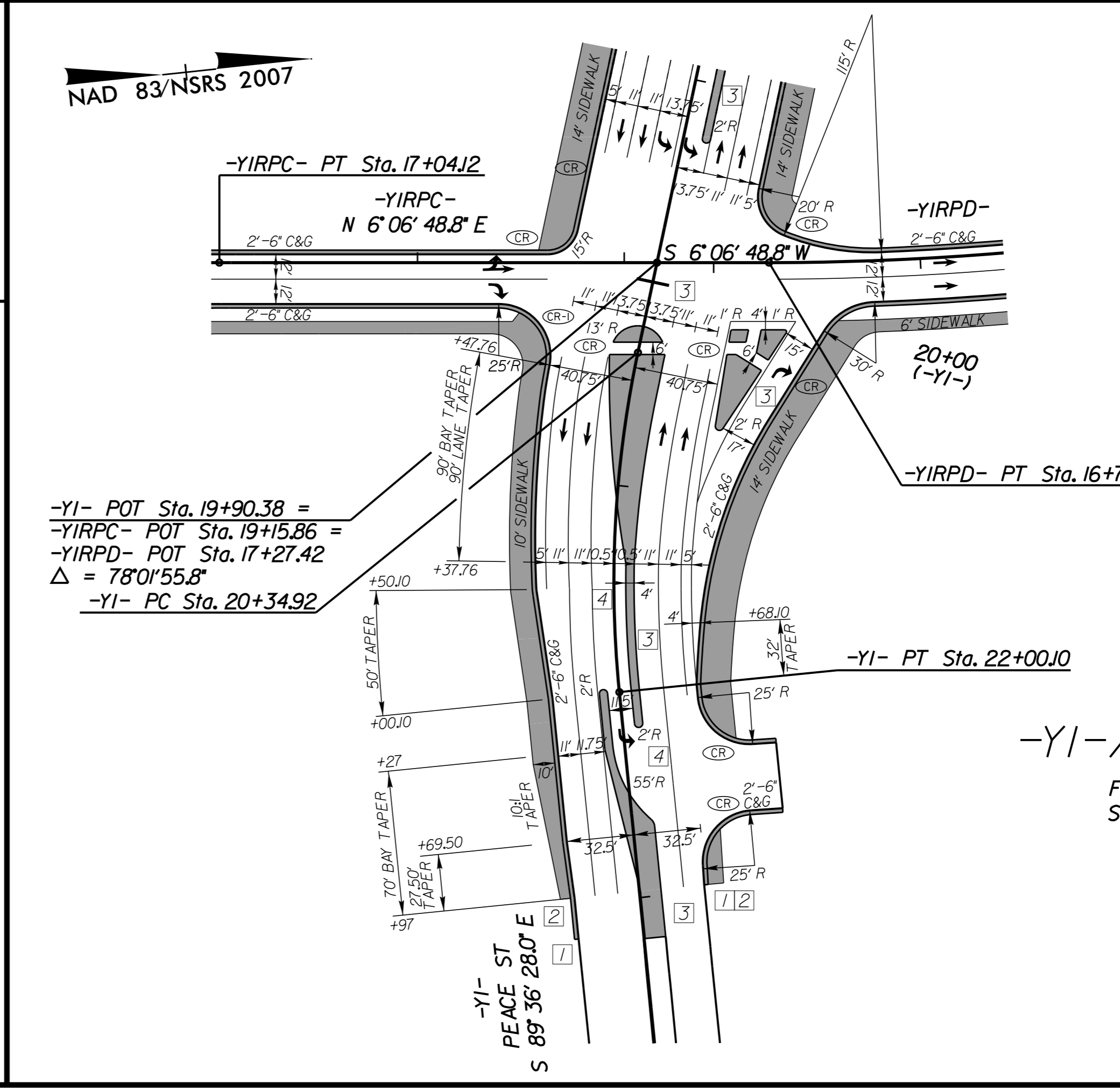

-Y1-/-YIRPC-/-YIRPD-
 FOR CR-1, SEE SHEET 2C-5
 SEE SHEET NO.5 FOR PLAN

INTERSECTION DETAILS