

PART TYPICAL SECTION
(SHOWING END BENT DIAPHRAGMS)

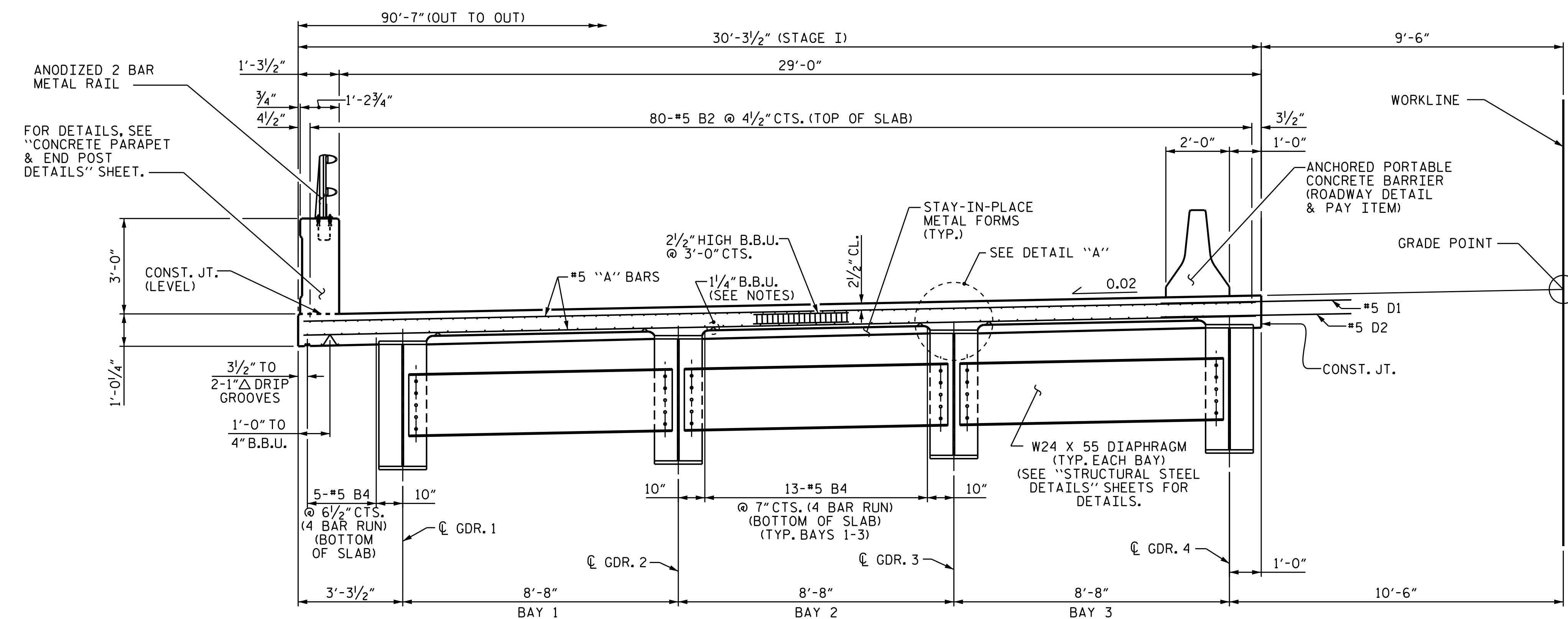

PART TYPICAL SECTION
(SHOWING BENT & INTERMEDIATE DIAPHRAGMS)
FOR DETAILS, SEE "STRUCTURAL STEEL DETAILS" SHEET 2 OF 3.
SEE FRAMING PLAN FOR LOCATION.
TYPICAL FOR EACH INTERMEDIATE DIAPHRAGM EXCEPT IN CLOSURE POUR.

NOTES

- PROVIDE 1/4" HIGH BEAM BOLSTERS UPPER AT 4'-0" CTS. ATOP THE METAL STAY-IN-PLACE FORMS TO SUPPORT THE BOTTOM MAT OF 'A' BARS, WHEN USING REMOVABLE FORMS. PROVIDE CONTINUOUS HIGH CHAIRS FOR METAL DECK (C.H.C.M.) @ 4'-0" CTS. WITH A HEIGHT TO SUPPORT THE BOTTOM MAT OF 'A' BARS A CLEAR DISTANCE OF 2 1/2" ABOVE THE TOP OF THE REMOVABLE FORM.
- PREVIOUSLY CAST CONCRETE IN A CONTINUOUS UNIT SHALL HAVE ATTAINED A MINIMUM COMPRESSIVE STRENGTH OF 3,000 PSI BEFORE ADDITIONAL CONCRETE IS CAST IN THE UNIT.
- PARAPET IN A CONTINUOUS UNIT SHALL NOT BE CAST UNTIL ALL SLAB CONCRETE IN THE UNIT HAS BEEN CAST AND HAS REACHED A MINIMUM COMPRESSIVE STRENGTH OF 3,000 PSI.
- DOWELS SHALL BE PLACED IN THE SAME HORIZONTAL PLANE AS THE TOP AND BOTTOM SLAB REINFORCING STEEL.
- SEE TRANSPORTATION MANAGEMENT PLANS FOR LOCATION AND PAY LIMITS OF THE ANCHORED PORTABLE CONCRETE BARRIER.
- STAGE III SIDEWALK NOT SHOWN, SEE "SIDEWALK DETAILS" SHEET AND "CONSTRUCTION SEQUENCE".

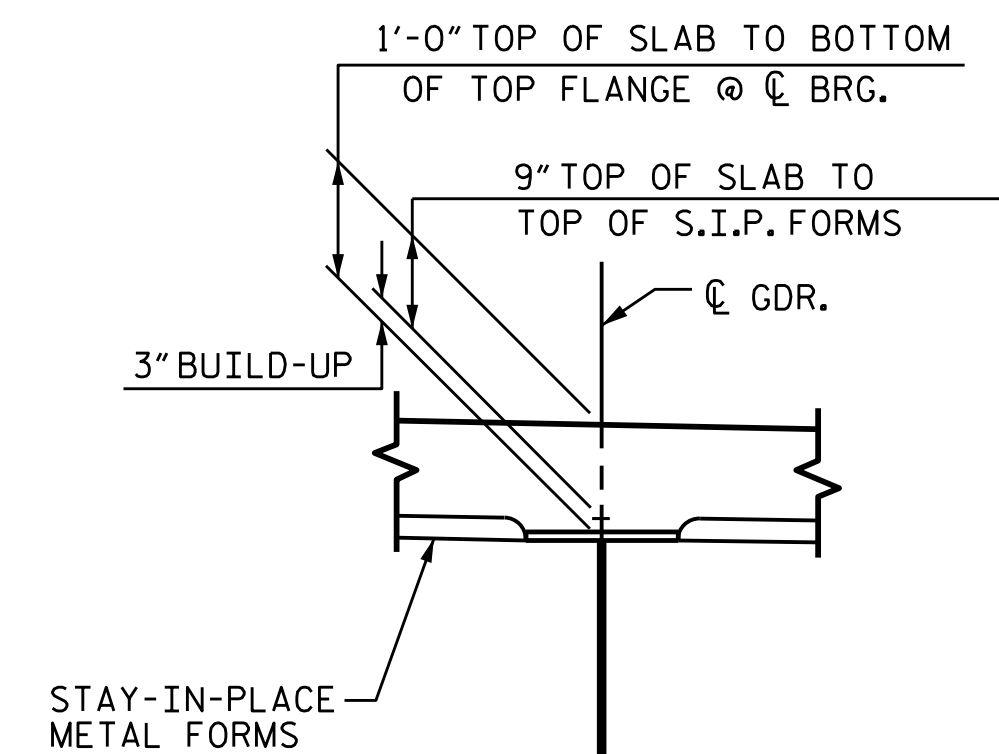

DETAIL "A"
(TYP. EACH GDR.)

PROJECT NO. U-3308
DURHAM COUNTY
STATION: 16+42.70-LALT-

SHEET 1 OF 3

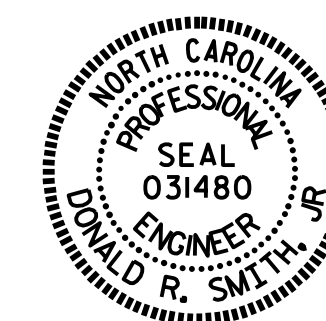

DocuSigned by:
Donald R. Smith, Jr.
EDC87706174B490
4/1/2016

STATE OF NORTH CAROLINA
DEPARTMENT OF TRANSPORTATION
RALEIGH
SUPERSTRUCTURE
TYPICAL SECTION
(STAGE I)

DRAWN BY : P.S. ADKINS DATE : 5/28/14
CHECKED BY : J.D. HAWK DATE : 9/5/14
DESIGN ENGINEER OF RECORD : D.R. SMITH DATE : 11/22/14

DOCUMENT NOT CONSIDERED
FINAL UNLESS ALL
SIGNATURES COMPLETED

REVISIONS						SHEET NO.
NO.	BY:	DATE:	NO.	BY:	DATE:	S1-7
1			3			TOTAL SHEETS
2			4			47