

PROJECT REFERENCE NO.	SHEET NO.
U-3308	EC-33/CONST-12
RW SHEET NO.	
ROADWAY DESIGN ENGINEER	HYDRAULICS ENGINEER

RW Revision 6/1/14 JCL
Converted Temporary Construction Easement (TCE) to Permanent Utility Easement (PUE) on Parcels 66, 67, 69, 70, 71, 202 and 204.

INSTALL INLET PROTECTION IN ACCORDANCE WITH ENGINEER'S RECOMMENDATIONS

NAD 83/95

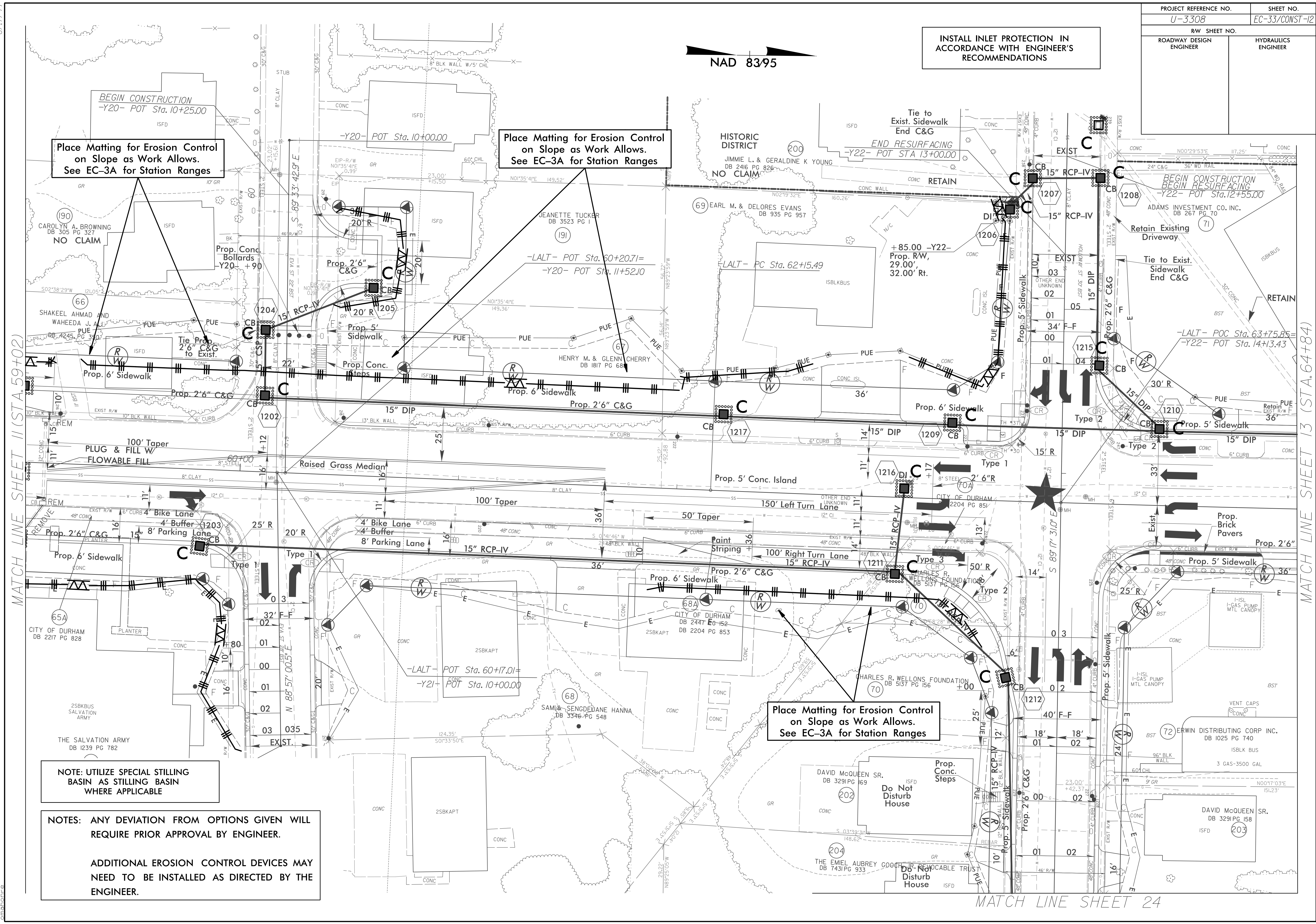

Place Matting for Erosion Control on Slope as Work Allows. See EC-3A for Station Ranges

Place Matting for Erosion Control on Slope as Work Allows. See EC-3A for Station Ranges

Place Matting for Erosion Control on Slope as Work Allows. See EC-3A for Station Ranges

NOTE: UTILIZE SPECIAL STILLING BASIN AS STILLING BASIN WHERE APPLICABLE

NOTES: ANY DEVIATION FROM OPTIONS GIVEN WILL REQUIRE PRIOR APPROVAL BY ENGINEER.

ADDITIONAL EROSION CONTROL DEVICES MAY NEED TO BE INSTALLED AS DIRECTED BY THE ENGINEER.

MATCH LINE SHEET 11 (STA. 59+02)

MATCH LINE SHEET 13 (STA. 64+84)

MATCH LINE SHEET 24

8/17/99
4/13/2015
R:\Projects\U3308\EC\U3308_r.dwg EC-ps12.dgn
mchabone