

PROJECT REFERENCE NO.	SHEET NO.
U-3308	EC-30/CONST-9
RW SHEET NO.	
ROADWAY DESIGN ENGINEER	HYDRAULICS ENGINEER

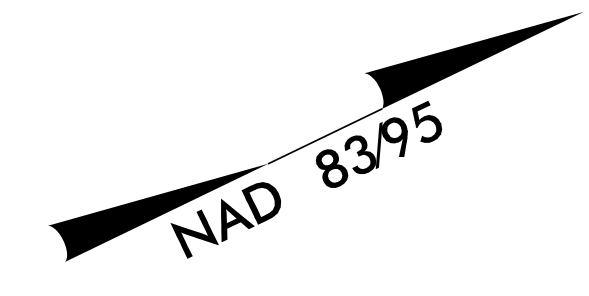

MATCH LINE SHEET 8 (STA. 44+03)

MATCH LINE SHEET 10 (STA. 47+56)

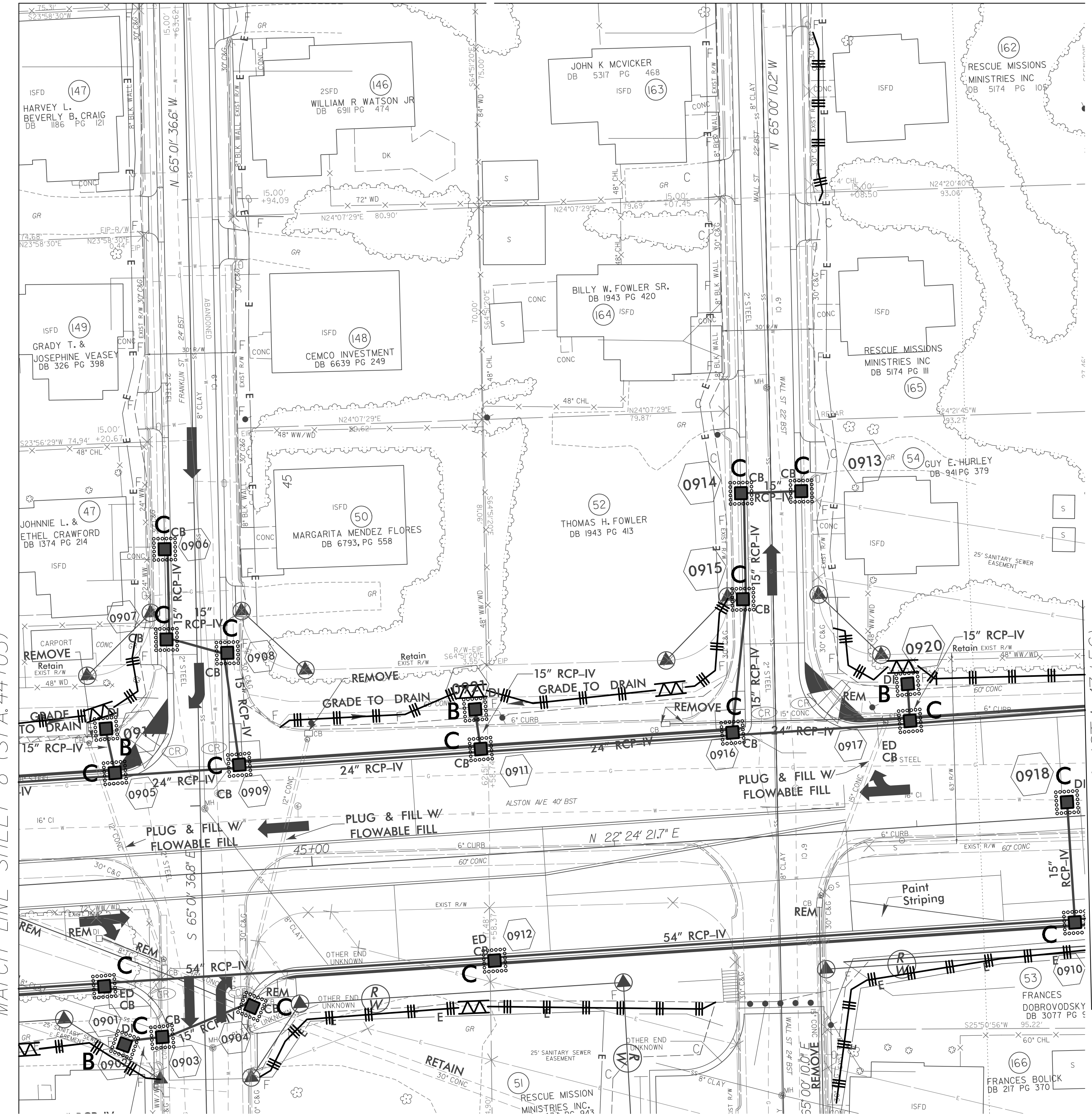

R/W Revision 3/31/14 JCL
 Added Proposed 12' Driveway to Parcel 46 Off of Franklin St.
 Changed Deed Book Description for Parcel 53

4/13/2015
 R:\Projects\4\EC\U3308_rdu_EC_ps09.dgn
 onahome

INSTALL INLET PROTECTION IN ACCORDANCE WITH ENGINEER'S RECOMMENDATIONS

NOTE: UTILIZE SPECIAL STILLING BASIN AS STILLING BASIN WHERE APPLICABLE

NOTES: ANY DEVIATION FROM OPTIONS GIVEN WILL REQUIRE PRIOR APPROVAL BY ENGINEER.

ADDITIONAL EROSION CONTROL DEVICES MAY NEED TO BE INSTALLED AS DIRECTED BY THE ENGINEER.