

PROJECT REFERENCE NO.	SHEET NO.
U-3308	EC-28/CONST-7
RW SHEET NO.	HYDRAULICS ENGINEER
ROADWAY DESIGN ENGINEER	

INSTALL INLET PROTECTION IN ACCORDANCE WITH ENGINEER'S RECOMMENDATIONS

NOTE: UTILIZE SPECIAL STILLING BASIN AS STILLING BASIN WHERE APPLICABLE

NOTES: ANY DEVIATION FROM OPTIONS GIVEN WILL REQUIRE PRIOR APPROVAL BY ENGINEER.

ADDITIONAL EROSION CONTROL DEVICES MAY NEED TO BE INSTALLED AS DIRECTED BY THE ENGINEER.

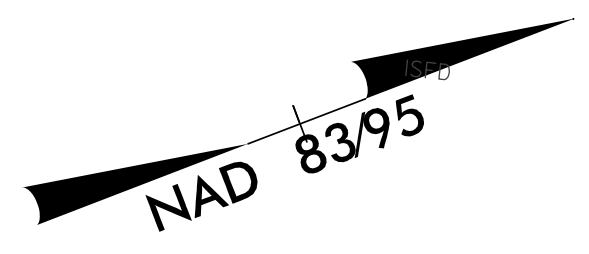

Place Matting for Erosion Control on Slope as Work Allows. See EC-3A for Station Ranges

RW Revision 6/1/14 JCL  
Added Permanent Utility Easement (PUE) and Adjusted Temporary Construction Easements (TCE) on Parcels 37 and 118

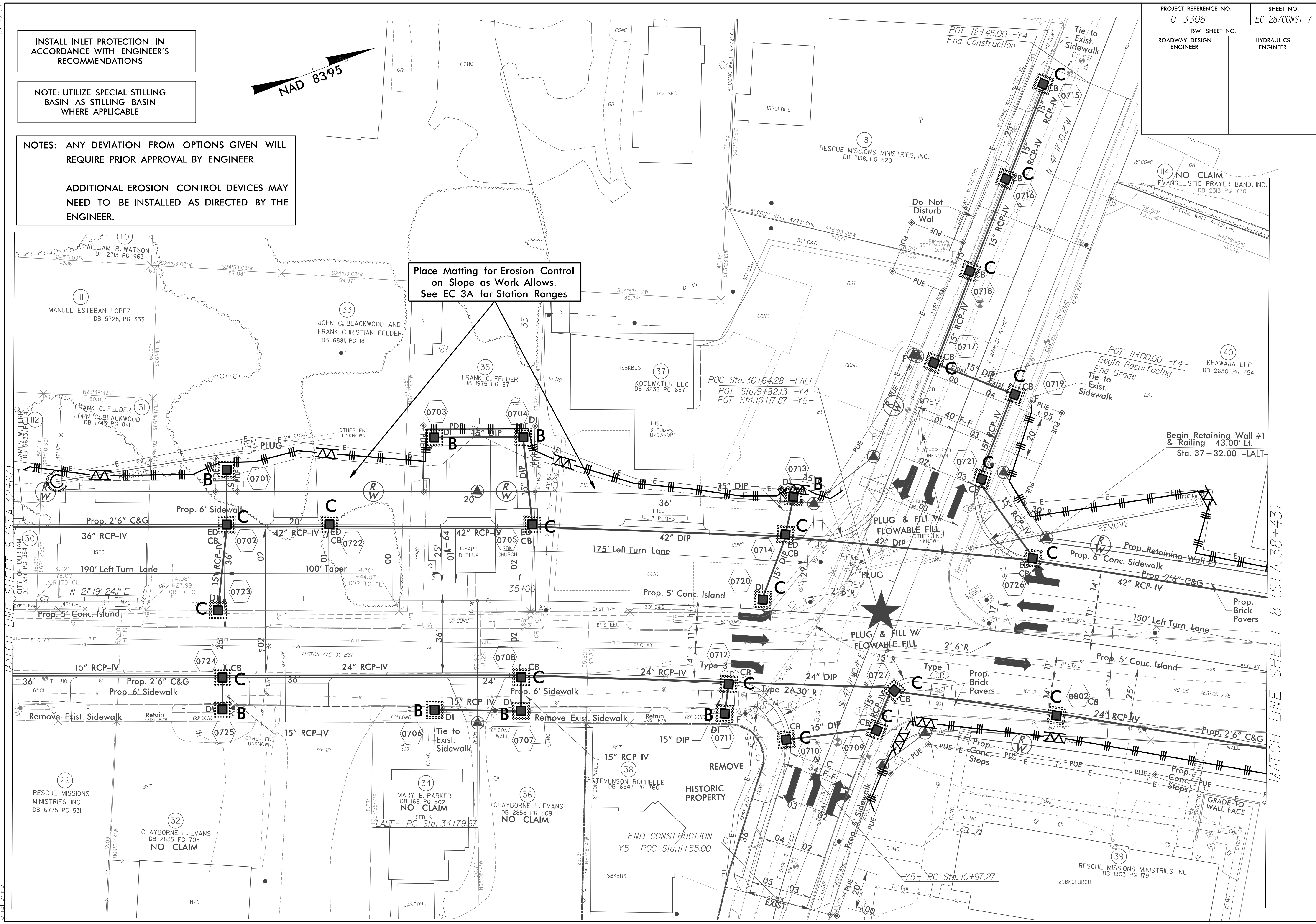

4/13/2015  
R:\Projects\U-3308\_r.dwg.ec\_ps07.dgn  
c:\p07\ec-28

MATCH LINE SHEET 8 (STA. 38+43)

8.17/99