

RW Revision 6/1/14 JCL

Added new Permanent Utility Easement (PUE) to Parcel 60, Converted Temporary Construction Easements (TCE) to PUE on Parcels 62, 66, 64 and 187, Converted PUE to TCE on Parcel 57.

8/17/99  
4/13/2015  
R:\Projects\3308\EC\3308\_r.dwg\EC\_psi11\_CG.dgn  
onshore

PROJECT REFERENCE NO. U-3308	SHEET NO. EC-11/CONST-11
RW SHEET NO.	
ROADWAY DESIGN ENGINEER	HYDRAULICS ENGINEER

MATCH LINE SHEET 10 (STA. 53+31)

MATCH LINE SHEET 22

MATCH LINE SHEET 23

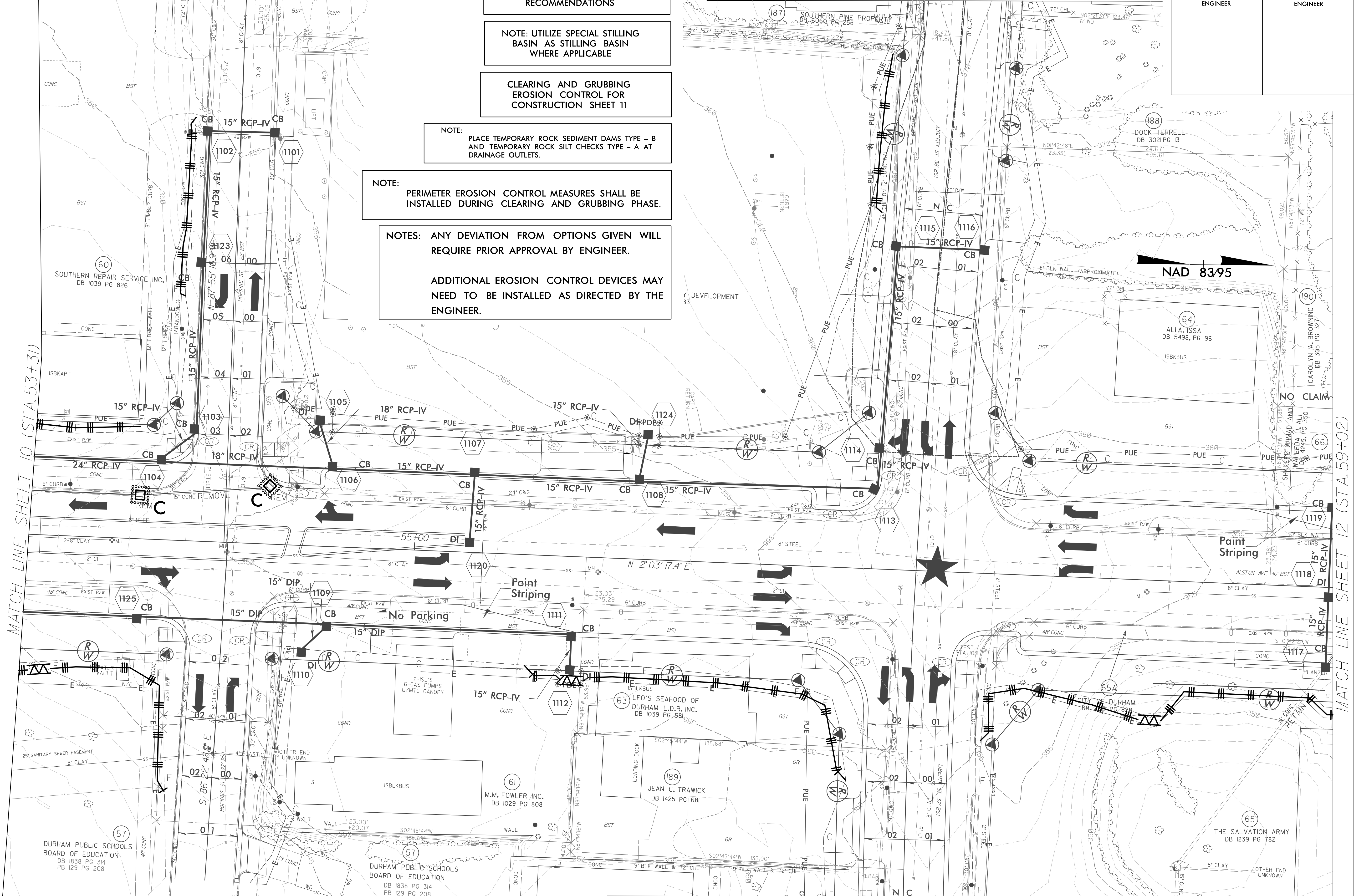

INSTALL INLET PROTECTION IN ACCORDANCE WITH ENGINEER'S RECOMMENDATIONS

NOTE: UTILIZE SPECIAL STILLING BASIN AS STILLING BASIN WHERE APPLICABLE

CLEARING AND GRUBBING EROSION CONTROL FOR CONSTRUCTION SHEET 11

NOTE: PLACE TEMPORARY ROCK SEDIMENT DAMS TYPE - B AND TEMPORARY ROCK SILT CHECKS TYPE - A AT DRAINAGE OUTLETS.

NOTE: PERIMETER EROSION CONTROL MEASURES SHALL BE INSTALLED DURING CLEARING AND GRUBBING PHASE.

NOTES: ANY DEVIATION FROM OPTIONS GIVEN WILL REQUIRE PRIOR APPROVAL BY ENGINEER.

ADDITIONAL EROSION CONTROL DEVICES MAY NEED TO BE INSTALLED AS DIRECTED BY THE ENGINEER.

NAD 8395

MATCH LINE SHEET 12 (STA. 59+02)