

PROJECT REFERENCE NO. U-3308	SHEET NO. 21
RW SHEET NO.	
ROADWAY DESIGN ENGINEER JAMES A. SPEER PROFESSIONAL SEAL 014571 NOV 15 2015 NORTH CAROLINA ENGINEER	HYDRAULICS ENGINEER WILLIAM H. ELAM PROFESSIONAL SEAL 019721 NOV 15 2015 NORTH CAROLINA ENGINEER
DocuSigned by: James Speer 11/24/2015	DocuSigned by: Wm. H. Elam 11/23/2015

8/17/99

Revisions

NOTE 1: REMOVE PIPE OR FILL WITH FLOWABLE FILL

NOTE 1: REMOVE PIPE OR FILL WITH FLOWABLE FILL

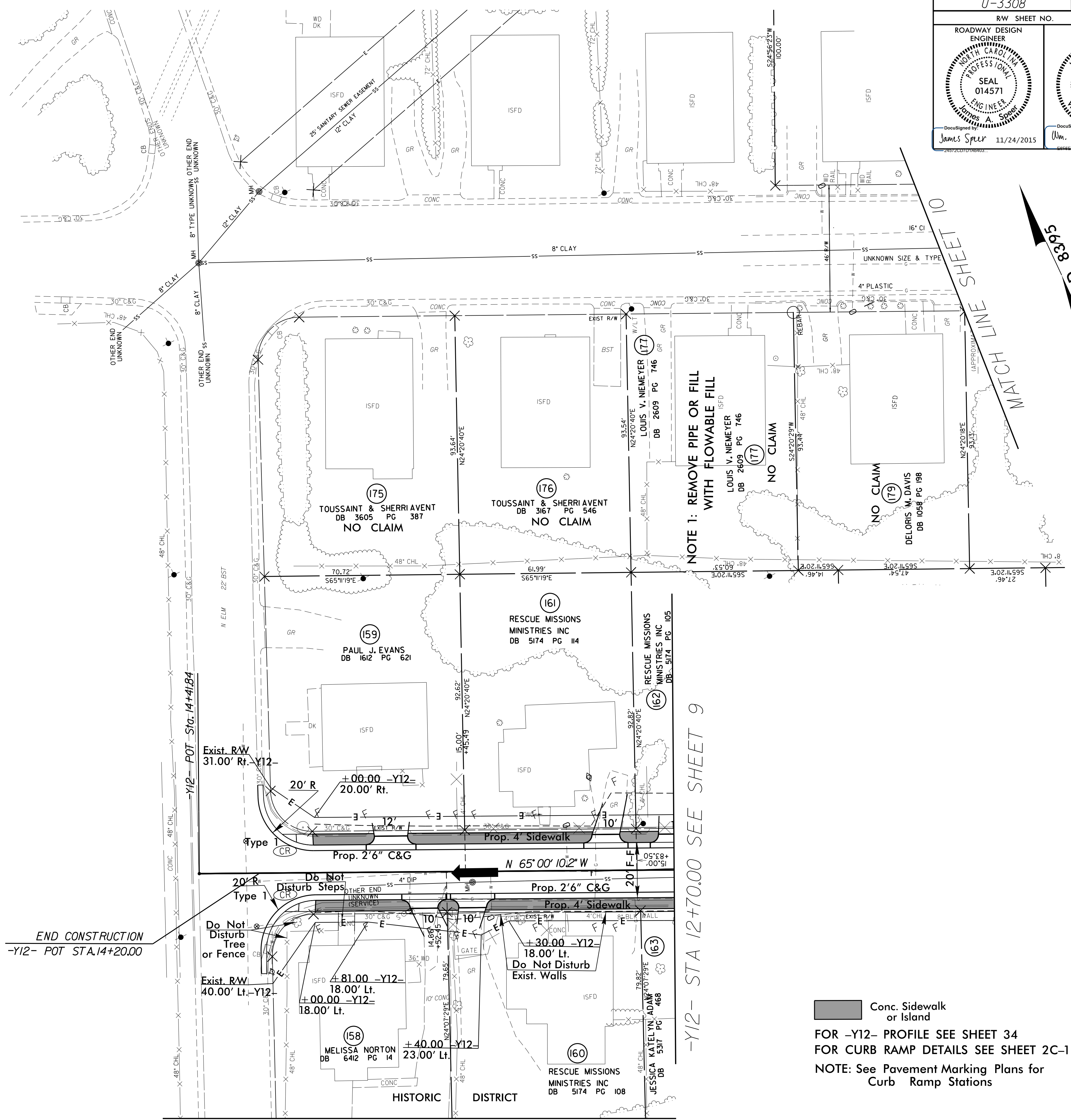

END CONSTRUCTION  
-Y12- POT STA. 14+20.00

-Y12- STA 12+70.00 SEE SHEET 9

Conc. Sidewalk or Island  
FOR -Y12- PROFILE SEE SHEET 34  
FOR CURB RAMP DETAILS SEE SHEET 2C-1 THRU 2C-4  
NOTE: See Pavement Marking Plans for Curb Ramp Stations

23-NOV-2015 10:46 U3308.rdy-ps21.dgn  
JAS:SPER:WHE:R:R:R

MATCH LINE SHEET 19

MATCH LINE SHEET 10