

6/2/09

PROJECT REFERENCE NO.	SHEET NO.
B-5171	1C-1
Location and Surveys	

SURVEY CONTROL SHEET B-5171 GRANVILLE COUNTY

LOCATION: BRIDGE NO. 125 OVER AARON'S CREEK ON
SR 1400 (GRASSY CREEK - VIRGINIA ROAD)

NCDOT GPS STATION B5171-2
LOCALIZED PROJECT COORDINATES

N=1011832.853
E=2079760.657

NCDOT GPS STATION B5171-1
LOCALIZED PROJECT COORDINATES

N=1012347.038
E=2078396.505

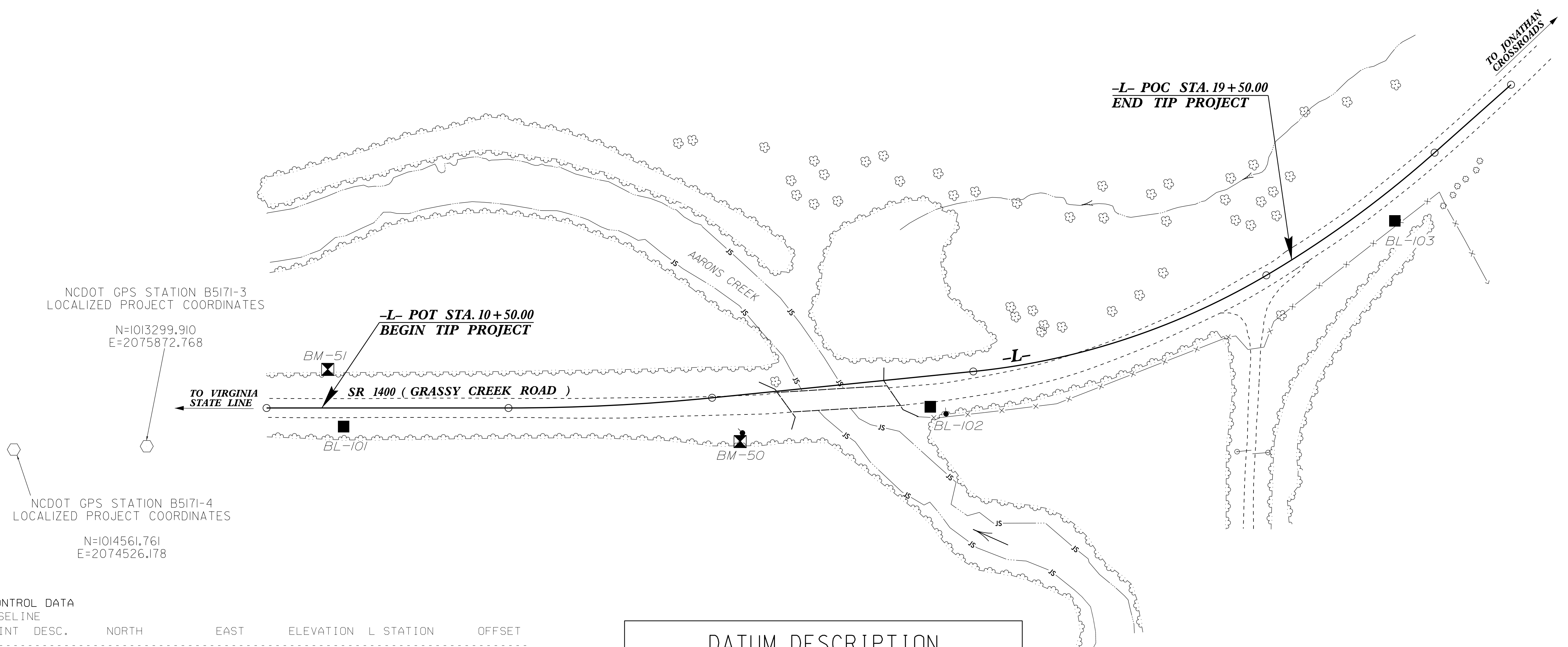
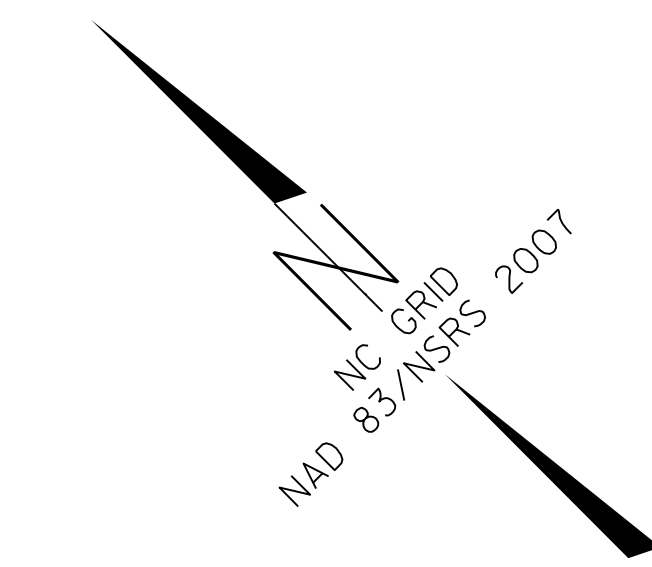

NCDOT GPS STATION B5171-3
LOCALIZED PROJECT COORDINATES

N=1013299.910
E=2075872.768

NCDOT GPS STATION B5171-4
LOCALIZED PROJECT COORDINATES

N=1014561.761
E=2074526.178

CONTROL DATA

POINT	DESC.	NORTH	EAST	ELEVATION	L STATION	OFFSET
101	BL-101	1012855.1800	2076285.2455	402.28	10+69.89	16.74 RT
102	BL-102	1012492.5282	2076673.8505	398.19	15+99.62	28.01 RT
103	BL-103	1012314.6338	2077090.5525	420.94	20+45.52	24.56 RT
104	BL-104	1012320.9012	2077765.6999	447.67	OUTSIDE PROJECT LIMITS	

BENCHMARK DATA

```

*****
BM50      ELEVATION = 394.64'
N 1012592      E 2076530
L STATION 14+25 42' RIGHT
R/R SPIKE SET 14" POPLAR
*****
BM51      ELEVATION = 400.18'
N 1012902      E 2076312
L STATION 10+55 35' LEFT
R/R SPIKE SET 16" POPLAR
*****

```

DATUM DESCRIPTION

THE LOCALIZED COORDINATE SYSTEM DEVELOPED FOR THIS PROJECT IS BASED ON THE STATE PLANE COORDINATES ESTABLISHED BY NCDOT FOR MONUMENT "B5171-3"
 WITH NAD 83/NSRS 2007 STATE PLANE GRID COORDINATES OF
 NORTHING: 1013299.910(ft) EASTING: 2075872.768(ft)
 ELEVATION: 416.064(ft)
 THE AVERAGE COMBINED GRID FACTOR USED ON THIS PROJECT (GROUND TO GRID) IS: 1.00010707
 THE N.C. LAMBERT GRID BEARING AND LOCALIZED HORIZONTAL GROUND DISTANCE FROM "B5171-3" TO -L- STATION 10+50.00 IS
 S 44°24'18" E 586.26'
 ALL LINEAR DIMENSIONS ARE LOCALIZED HORIZONTAL DISTANCES
 VERTICAL DATUM USED IS NAVD 88

NOTE: DRAWING NOT TO SCALE

NOTES:

1. THE CONTROL DATA FOR THIS PROJECT CAN BE FOUND ELECTRONICALLY BY SELECTING NCDOT PROJECT CONTROL DATA AT:
[HTTPS://CONNECT.NCDOT.GOV/RESOURCES/LOCATION](https://connect.ncdot.gov/resources/location)
 THE FILES TO BE FOUND ARE AS FOLLOWS:
 B5171_ls_control.txt
 SITE CALIBRATION INFORMATION HAS NOT BEEN PROVIDED FOR THIS PROJECT. IF FURTHER INFORMATION IS NEEDED, PLEASE CONTACT THE LOCATION AND SURVEYS UNIT.
- INDICATES GEODETIC CONTROL MONUMENTS USED OR SET FOR HORIZONTAL PROJECT CONTROL BY THE NCDOT LOCATION AND SURVEYS UNIT.
 PROJECT CONTROL ESTABLISHED USING GLOBAL POSITIONING SYSTEM.

I:\2010\Projects\B5171\1c.dgn