

**PROJECT: I-5731**

**CONTRACT NO: C203819**

STATE OF NORTH CAROLINA  
DIVISION OF HIGHWAYS

**CUMBERLAND COUNTY**

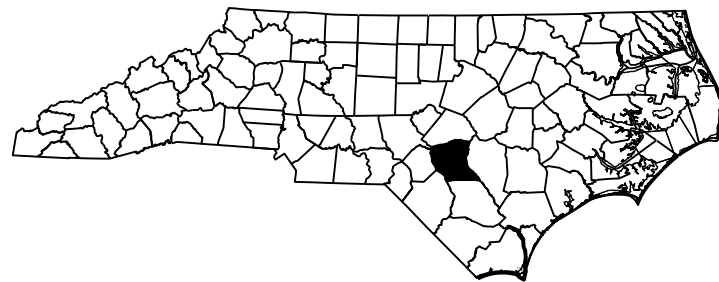

STATE	STATE PROJECT REFERENCE NO.	SHEET NO.	TOTAL SHEETS
N.C.	I-5731	1	
STATE PROJ. NO.	F.A. PROJ. NO.	DESCRIPTION	
52008.1.1	NHPP-0095(034)	PE	
52008.3.FS1	NHPP-0095(034)	CONST	

**LOCATION: BRIDGE #26 ON I-95 NBL AND BRIDGE #30 ON I-95 SBL OVER I-95 (BUS) AND SR 2284  
BRIDGE #77 ON I-95 NBL AND BRIDGE #83 ON I-95 SBL OVER ROCKFISH CREEK  
BRIDGE #99 ON I-95 NBL AND BRIDGE #103 ON I-95 SBL OVER NC 87  
BRIDGE #107 NB COLLECTOR AND BRIDGE #108 SB COLLECTOR ON I-95 OVER NC 87  
BRIDGE #109 ON I-95 NBL AND BRIDGE #111 ON I-95 SBL OVER CAPE FEAR RIVER  
BRIDGE #133 ON I-95 NBL AND BRIDGE #134 ON I-95 SBL OVER SR 1006 AND CSX RR**

**TYPE OF WORK: BRIDGE PRESERVATION - EPOXY OVERLAY, SCARIFICATION, HYDRO-DEMOLITION, DECK REPAIR, LATEX MODIFIED CONCRETE-VERY EARLY STRENGTH, JOINT DEMOLITION, PAINTING EXISTING STRUCTURE AND INCIDENTAL MILLING**

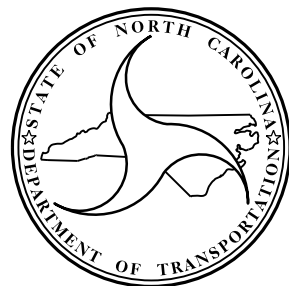
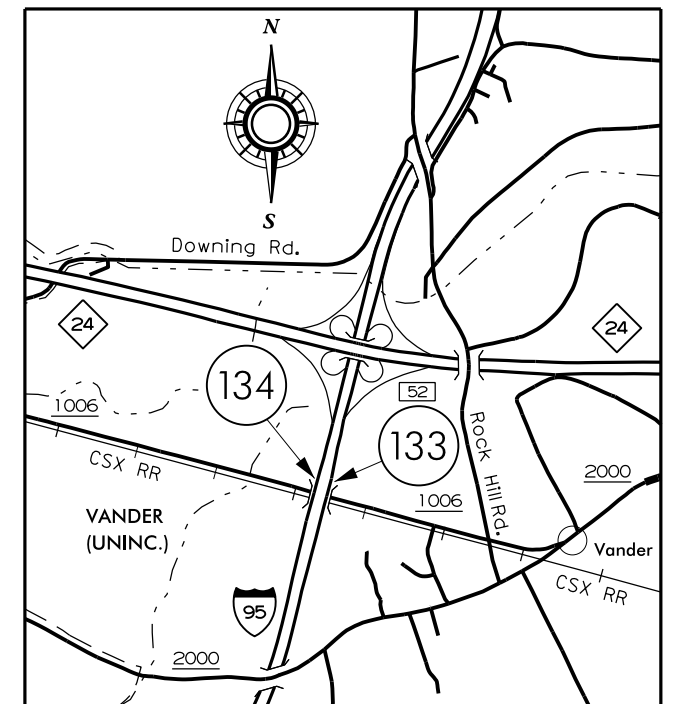
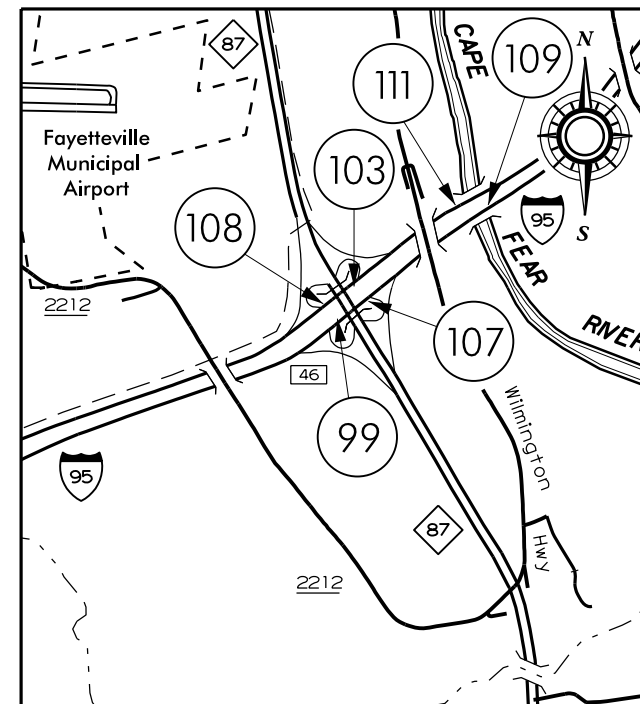
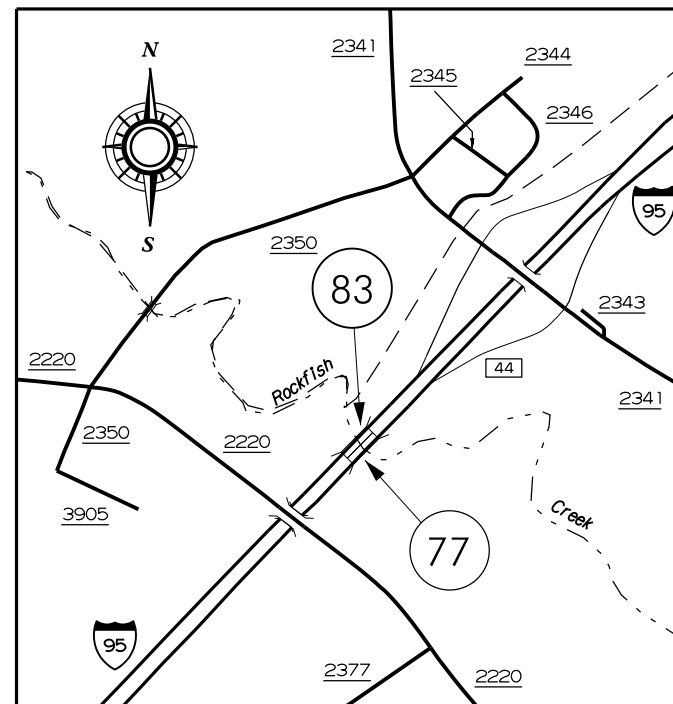
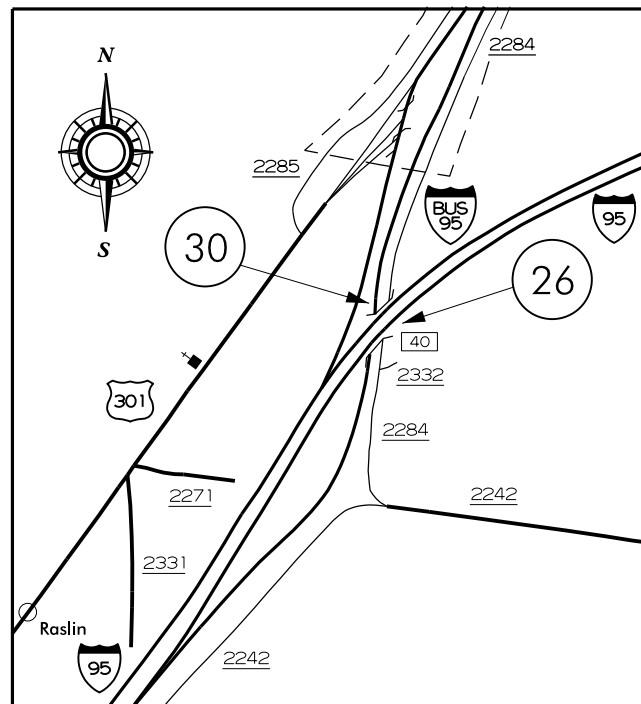

**DESIGN DATA**

BRIDGE #26	ADT 2013	=	15,500
BRIDGE #30	ADT 2013	=	15,500
BRIDGE #77	ADT 2012	=	19,000
BRIDGE #83	ADT 2012	=	19,000
BRIDGE #99	ADT 2012	=	18,000
BRIDGE #103	ADT 2012	=	21,000
BRIDGE #107	ADT 2012	=	18,000
BRIDGE #108	ADT 2012	=	18,000
BRIDGE #109	ADT 2011	=	21,000
BRIDGE #111	ADT 2011	=	21,000
BRIDGE #133	ADT 2010	=	15,000
BRIDGE #134	ADT 2012	=	18,500

**PROJECT LENGTH**

BRIDGE #26	=	0.08	MILE
BRIDGE #30	=	0.08	MILE
BRIDGE #77	=	0.05	MILE
BRIDGE #83	=	0.05	MILE
BRIDGE #99	=	0.08	MILE
BRIDGE #103	=	0.08	MILE
BRIDGE #107	=	0.08	MILE
BRIDGE #108	=	0.08	MILE
BRIDGE #109	=	0.13	MILE
BRIDGE #111	=	0.13	MILE
BRIDGE #133	=	0.05	MILE
BRIDGE #134	=	0.05	MILE

Prepared in the Office of:  
**DEPARTMENT OF TRANSPORTATION  
DIVISION OF HIGHWAYS**  
STRUCTURES MANAGEMENT UNIT  
1000 BIRCH RIDGE DR. RALEIGH, N.C. 27610

**E. E. MURRAY, P.E.**  
PROJECT ENGINEER

2012 STANDARD SPECIFICATIONS

LETTING DATE:  
MAY 17, 2016

DocuSigned by:



4/14/2016

**FARZIN ASEFNIA, P.E.**  
PROJECT DESIGN ENGINEER