

### EXIT 52 RAMP A - I-95

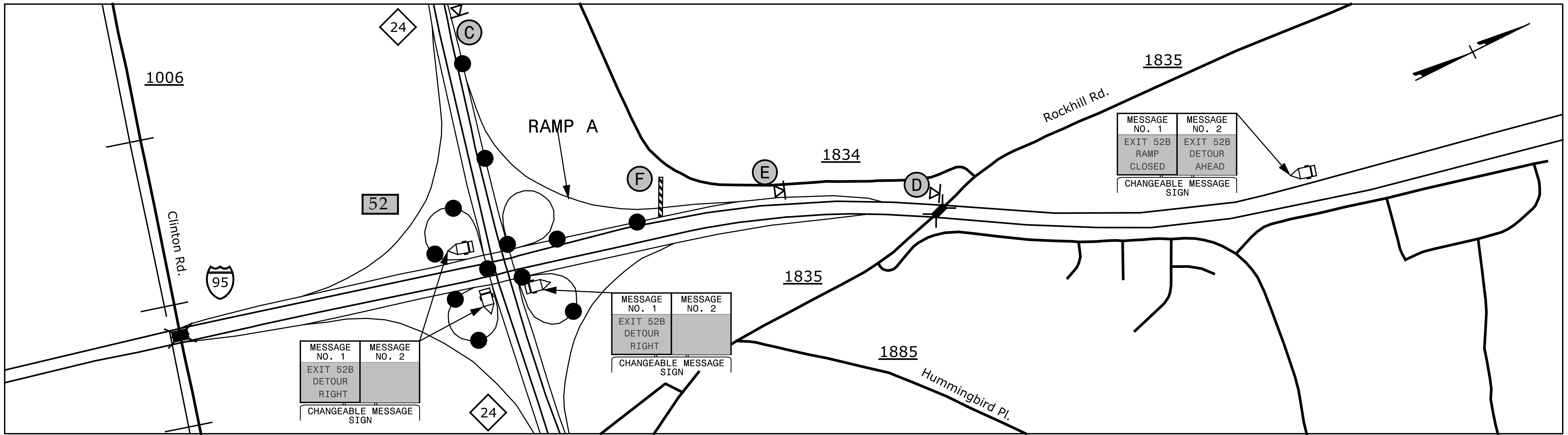

### EXIT 52 RAMP B - I-95

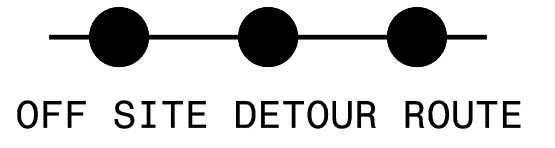
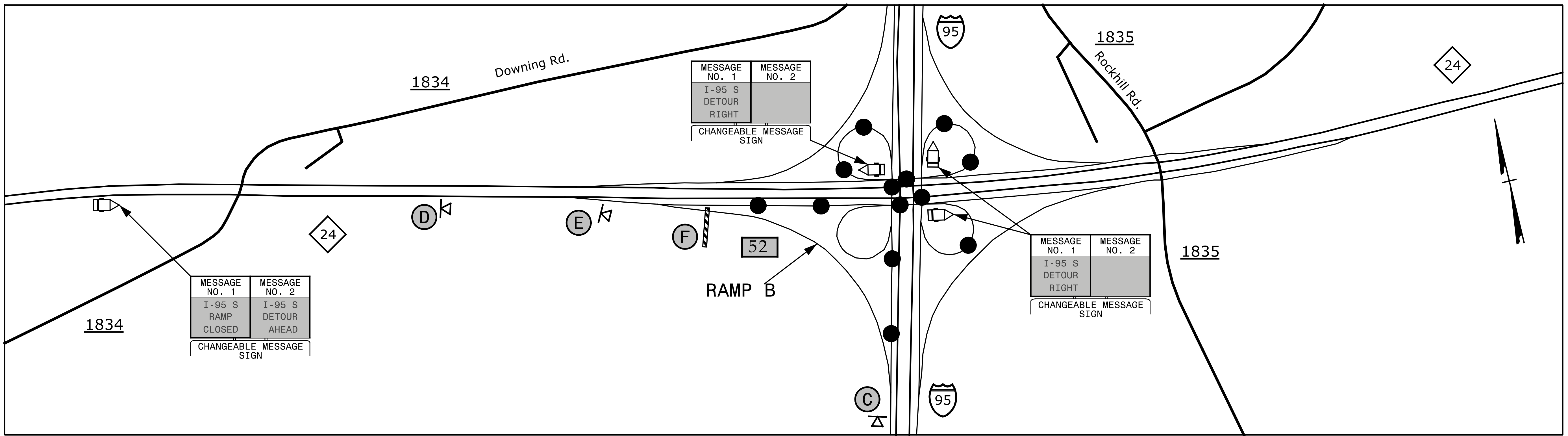

NOTE: 1. SEE TMP-2B FOR SIGN LEGEND  
2. SEE TMP-3 FOR RAMP CLOSURE

**SEPI**  
ENGINEERING & CONSTRUCTION  
1025 Wade Avenue  
Raleigh, NC 27605  
Tel: 919-789-9977  
Fax: 919-789-9591  
License: C-2197

APPROVED: *Steve Miller*  
DATE: 2/29/2016  
SEAL  
DOCUMENT NOT CONSIDERED FINAL UNLESS ALL SIGNATURES COMPLETED



NC 24  
DETOUR

2/4/2016 G:\Transportation\TR13.017.00 NCDOT 2012 Traffic LSA\TR13.017.17 (I-5731)\TMP\I-5731\TMP-16.dgn