

EXIT 46 LOOP C - I-95

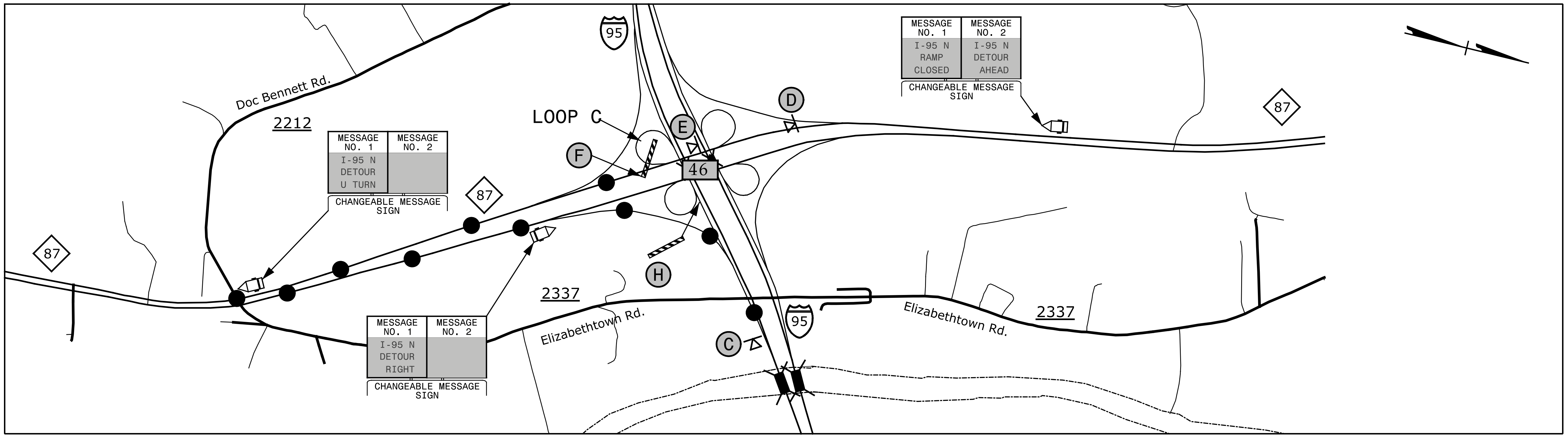

EXIT 46 LOOP D - I-95

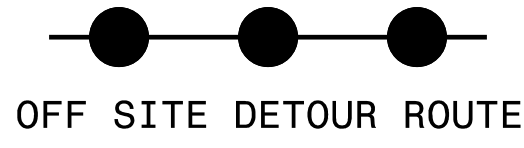
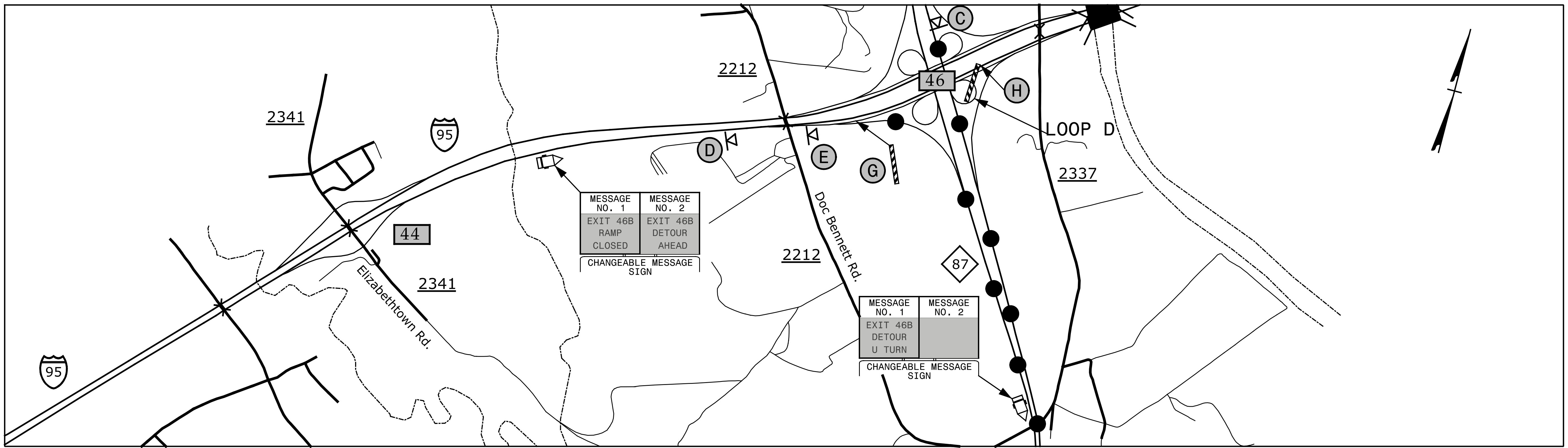

NOTE: 1. SEE TMP-2B FOR SIGN LEGEND
2. SEE TMP-3 FOR RAMP CLOSURE

SEPI
ENGINEERING & CONSTRUCTION

1025 Wade Avenue
Raleigh, NC 27605
Tel: 919-789-9977
Fax: 919-789-9591
License: C-2197

APPROVED: *Steve Miller*
DATE: 2/29/2016

SEAL

DOCUMENT NOT CONSIDERED FINAL UNLESS ALL SIGNATURES COMPLETED



NC 87 DETOUR

DIVISION OF HIGHWAYS
STATE OF NORTH CAROLINA
DEPARTMENT OF TRANSPORTATION
WORK ZONE TRAFFIC CONTROL

2/4/2016 G:\Transportation\TR13.017.00 NCDOT 2012 Traffic LSA\TR13.017.17 (I-5731)\TMP\I-5731\TMP-12.dgn