

EXIT 46 LOOP A - I-95

PROJ. REFERENCE NO.	SHEET NO.
I-5731	TMP-11

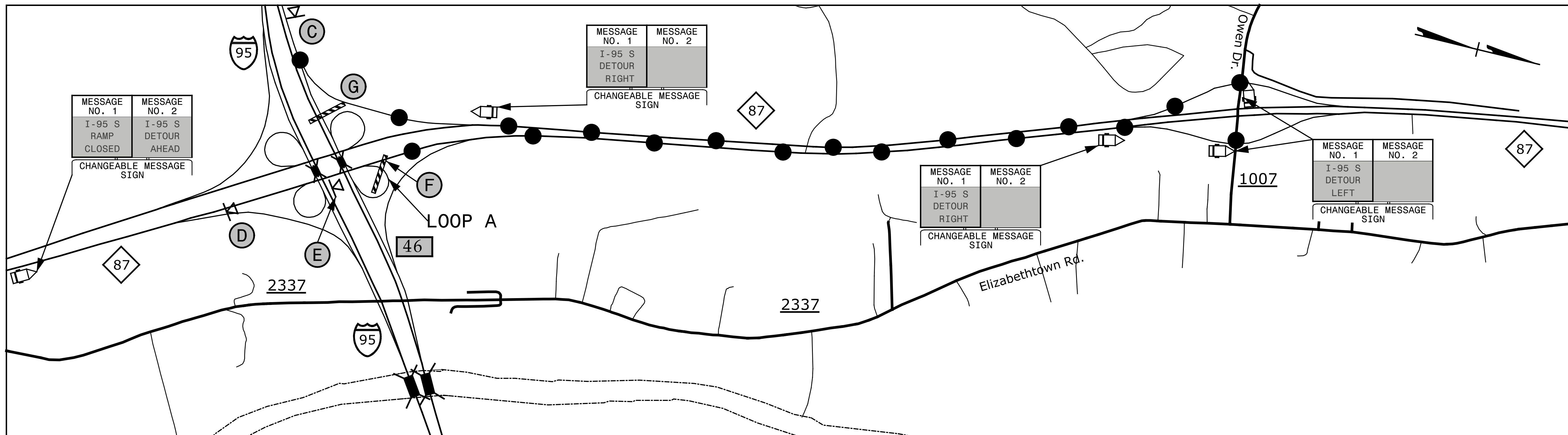

EXIT 46 LOOP B - I-95

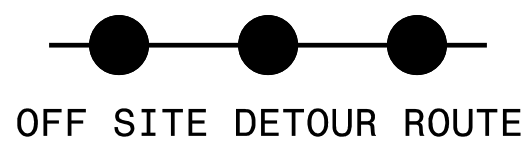
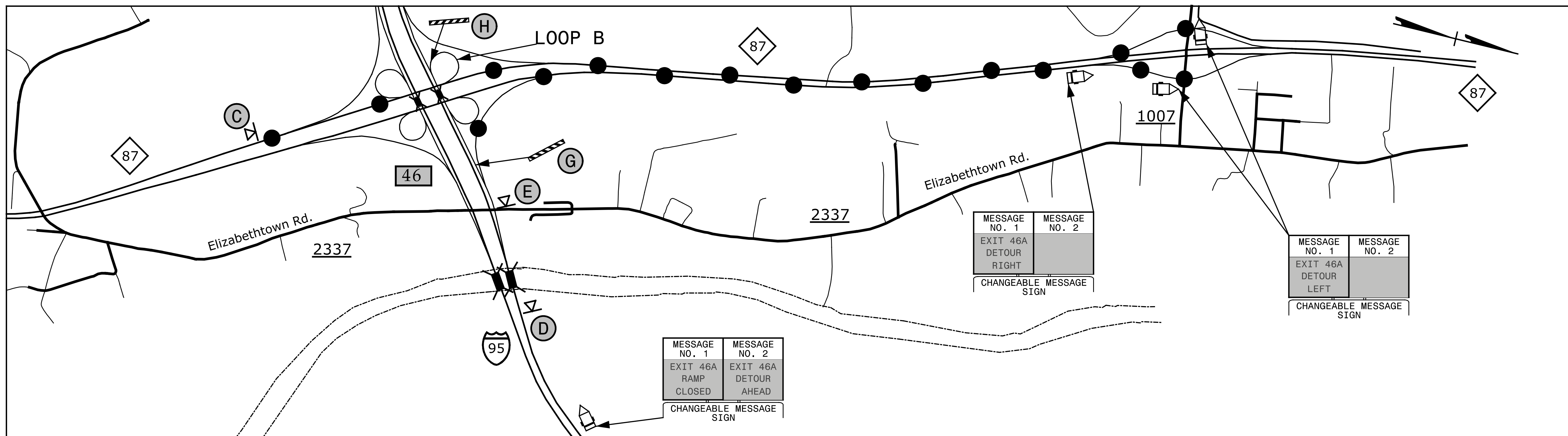

NOTE: 1. SEE TMP-2B FOR SIGN LEGEND
2. SEE TMP-3 FOR RAMP CLOSURE

SEPI
ENGINEERING & CONSTRUCTION
1025 Wade Avenue
Raleigh, NC 27605
Tel: 919-789-9977
Fax: 919-789-9591
License: C-2197

APPROVED: *Steve Miller*
DATE: 2/29/2016

SEAL

DOCUMENT NOT CONSIDERED FINAL
UNLESS ALL SIGNATURES COMPLETED

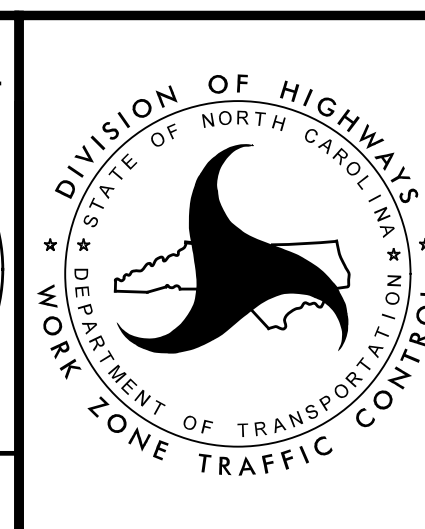

NC 87
DETOUR

2/4/2016 G:\Transportation\TR13.017.00 NCDOT 2012 Traffic LSA\TR13.017.00 I-5731\TMP-11.dgn