

# EXIT 46 RAMP A - I-95

PROJ. REFERENCE NO.	SHEET NO.
I-5731	TMP-9

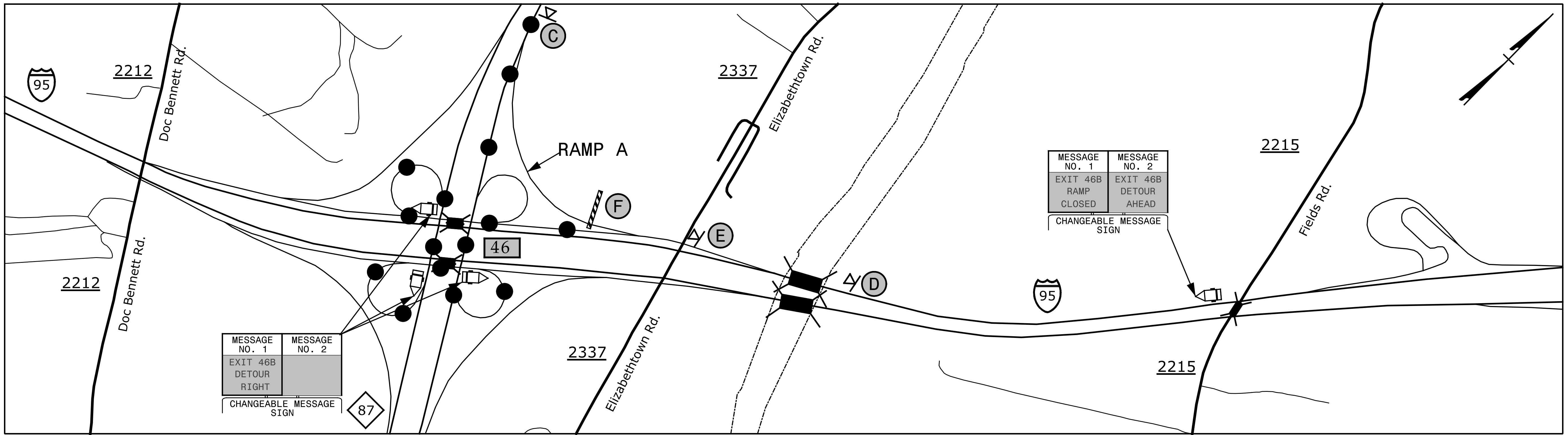

# EXIT 46 RAMP B - I-95

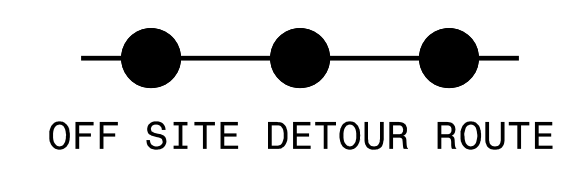
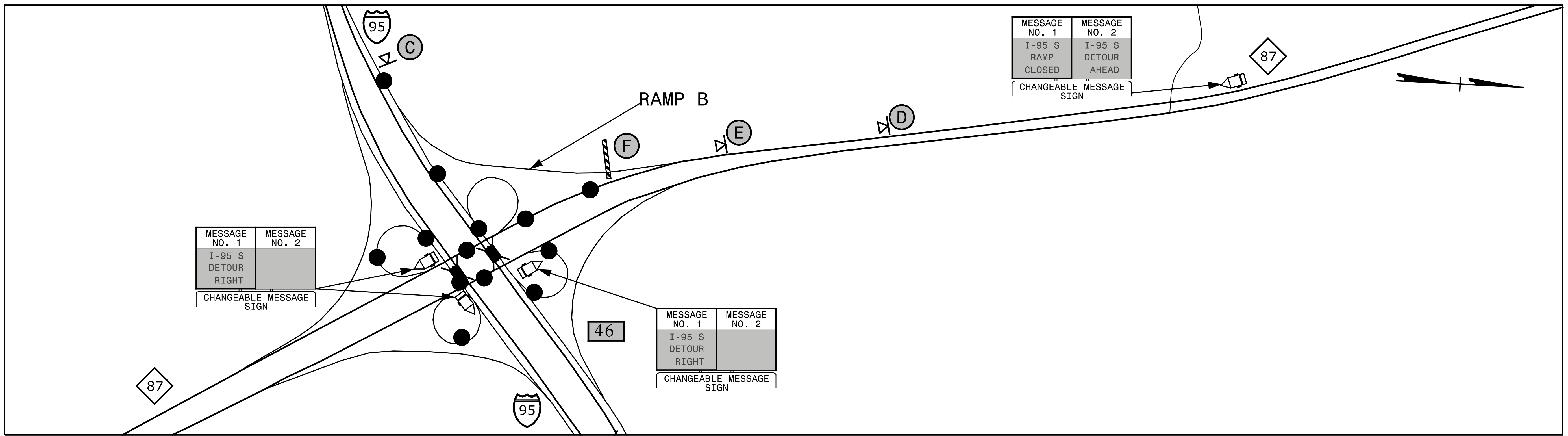

NOTE: 1. SEE TMP-2B FOR SIGN LEGEND  
2. SEE TMP-3 FOR RAMP CLOSURE

**SEPI**  
ENGINEERING & CONSTRUCTION

1025 Wade Avenue  
Raleigh, NC 27605  
Tel: 919-789-9977  
Fax: 919-789-9591  
License: C-2197

APPROVED: *Steve Miller*  
DATE: 2/29/2016

SEAL

DOCUMENT NOT CONSIDERED FINAL  
UNLESS ALL SIGNATURES COMPLETED



NC 87  
DETOUR

2/4/2016 G:\Transportation\TR13.017.00 NCDOT 2012 Traffic LSA\TR13.017.01 (-5731)\TMP\I-5731\TMP-9.dgn