

EXIT 44 RAMP A - I-95

PROJ. REFERENCE NO.	SHEET NO.
I-5731	TMP-7

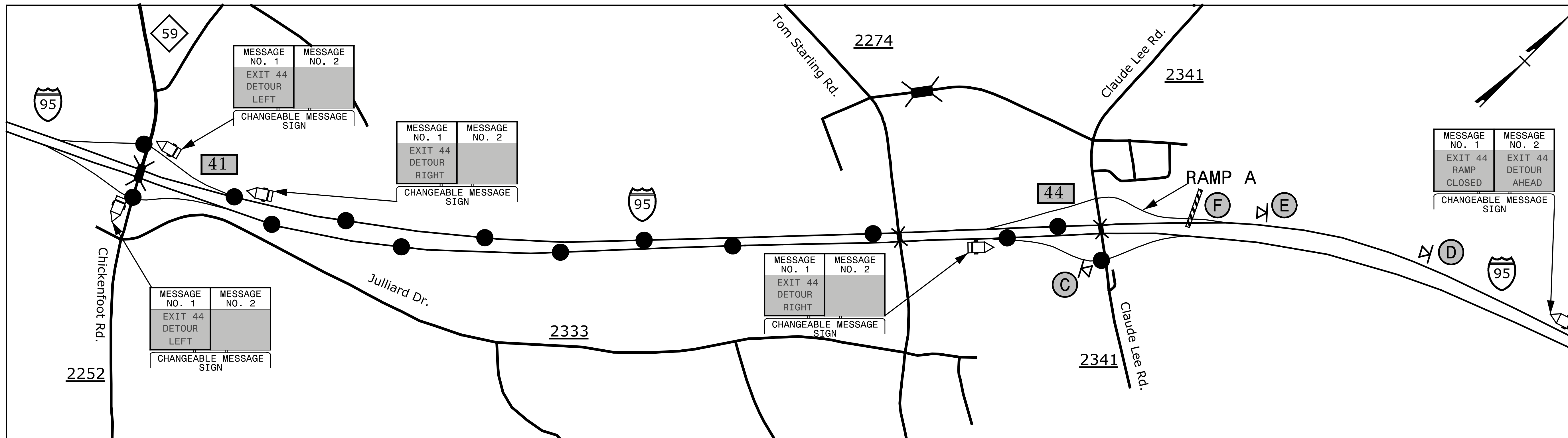

EXIT 44 RAMP B - I-95

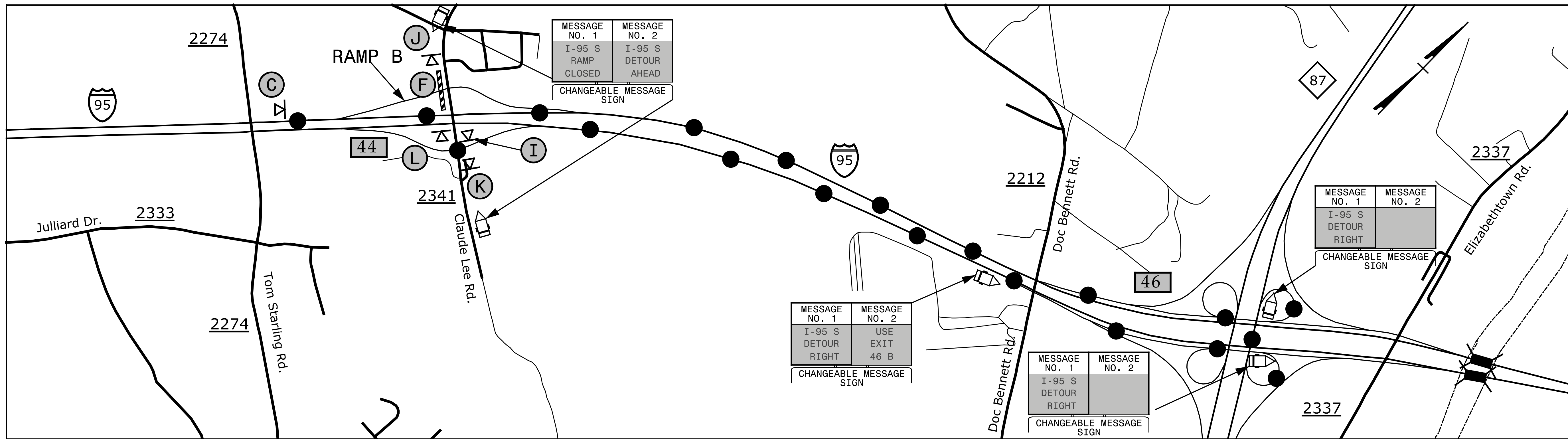

2/4/2016 G:\Transportation\TR13.017.00 NCDOT 2012 Traffic LSA\TR13.017.01 (I-5731)\TMP\I-5731-TMP-7.dgn

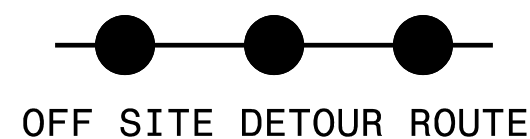

NOTE: 1. SEE TMP-2B FOR SIGN LEGEND
 2. SEE TMP-3 FOR RAMP CLOSURE

SEPI
 ENGINEERING & CONSTRUCTION
 1025 Wade Avenue
 Raleigh, NC 27605
 Tel: 919-789-9977
 Fax: 919-789-9591
 License: C-2197

APPROVED: *Steve Miller*
9FBC0C15CE8B486

DATE: 2/29/2016

SEAL

DOCUMENT NOT CONSIDERED FINAL UNLESS ALL SIGNATURES COMPLETED

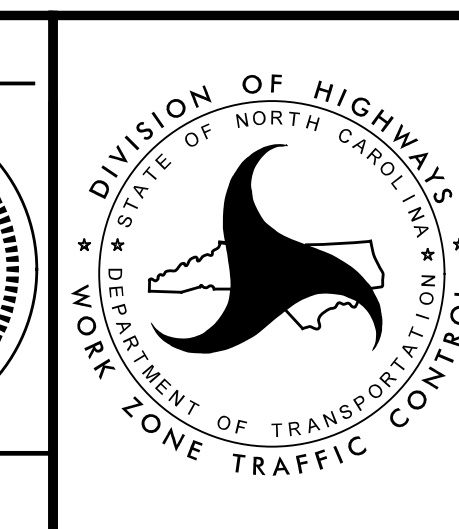

CLAUDE LEE RD. DETOUR