

EXIT 41 RAMP D - I-95

PROJ. REFERENCE NO.	SHEET NO.
I-5731	TMP-6

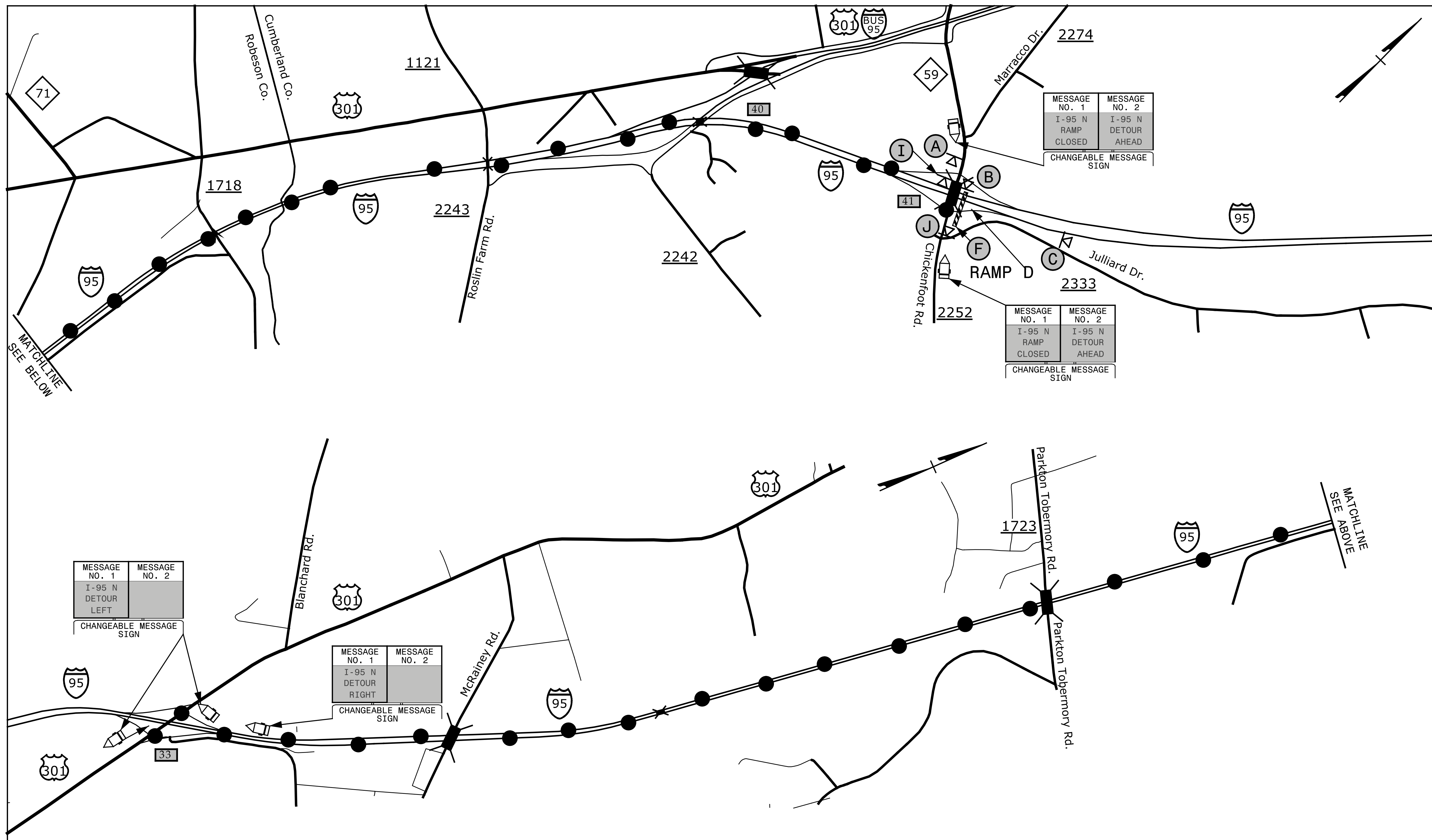

MESSAGE NO. 1	MESSAGE NO. 2
I-95 N DETOUR LEFT	
CHANGEABLE MESSAGE SIGN	

MESSAGE NO. 1	MESSAGE NO. 2
I-95 N DETOUR RIGHT	
CHANGEABLE MESSAGE SIGN	

MESSAGE NO. 1	MESSAGE NO. 2
I-95 N RAMP CLOSED	I-95 N DETOUR AHEAD
CHANGEABLE MESSAGE SIGN	

MESSAGE NO. 1	MESSAGE NO. 2
I-95 N RAMP CLOSED	I-95 N DETOUR AHEAD
CHANGEABLE MESSAGE SIGN	

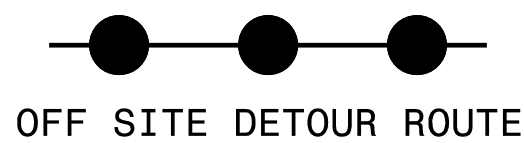

NOTE: 1. SEE TMP-2B FOR SIGN LEGEND
2. SEE TMP-3 FOR RAMP CLOSURE

SEPI
ENGINEERING & CONSTRUCTION
1025 Wade Avenue
Raleigh, NC 27605
Tel: 919-789-9977
Fax: 919-789-9591
License: C-2197

APPROVED: *Steve Miller*
DATE: 2/29/2016

SEAL

**DOCUMENT NOT CONSIDERED FINAL
UNLESS ALL SIGNATURES COMPLETED**

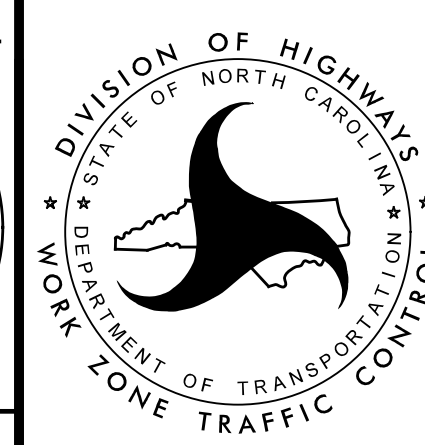
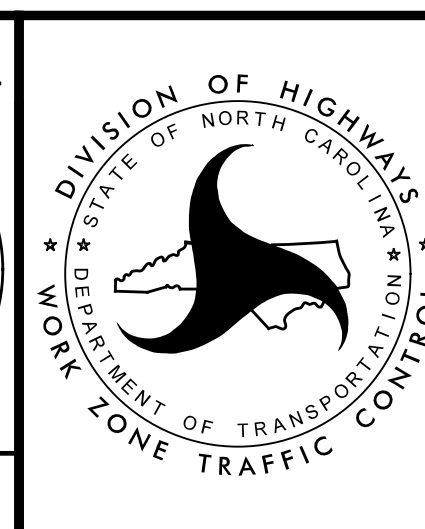

**NC 59
DETOUR**

2/4/2016 G:\Transportation\TR13.017.00 NCDOT 2012 Traffic LSA\TR13.017.01 (I-5731)\TMP\I-5731-TMP-6.dgn