

PROJECT REFERENCE NO.	SHEET NO.
R-4416	EC-28/CONST.12
RW SHEET NO.	
ROADWAY DESIGN ENGINEER	HYDRAULICS ENGINEER

8/17/99

NAD 83

-L- LINE

PI Sta 120+80.67	PI Sta 132+48.93
$\Theta_s = 5^\circ 46' 39.8"$	$\Delta = 84^\circ 53' 25.2" (LT)$
$L_s = 240.00'$	$D = 4^\circ 48' 53.2"$
$LT = 160.09'$	$L = 1,763.12'$
$ST = 80.08'$	$T = 1,088.34'$
	$R = 1,190.00'$
	$D_s = 60\text{mph}$
	$SE = .08$

-YI-

PI Sta 10+78.05
$\Delta = 43^\circ 51' 27.6" (LT)$
$D = 32^\circ 44' 25.6"$
$L = 133.96'$
$T = 70.45'$
$R = 175.00'$

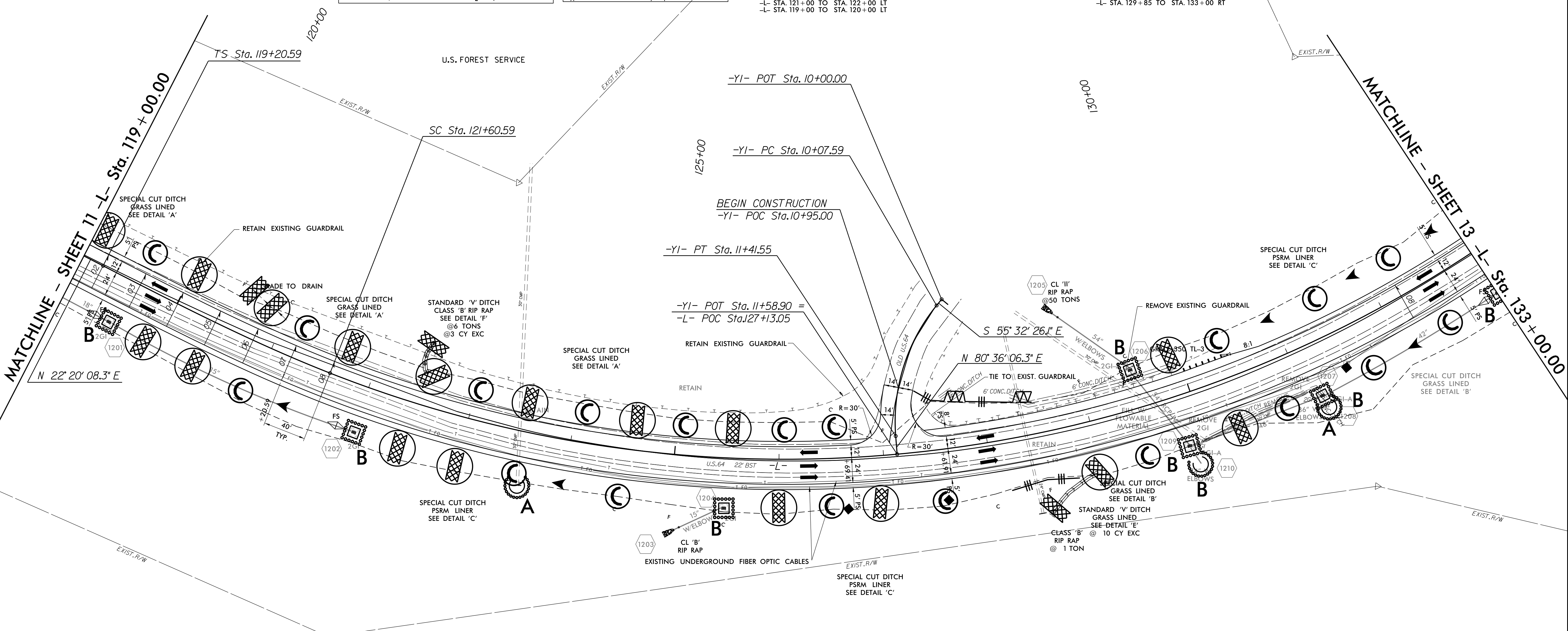
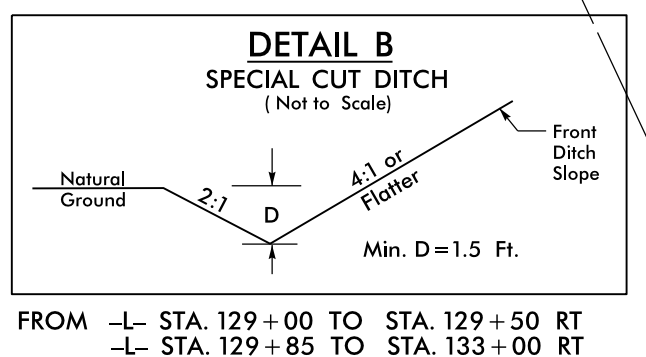
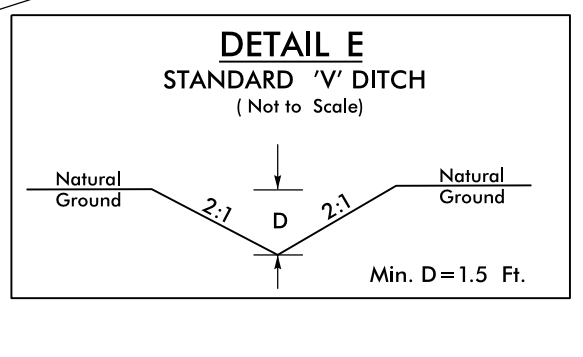
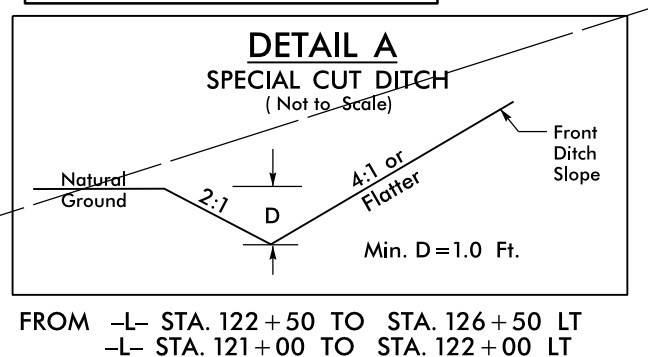
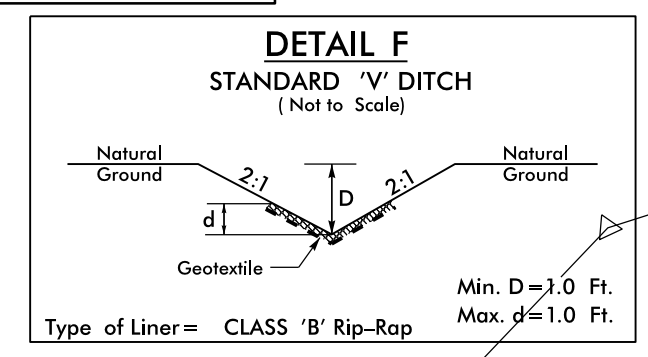
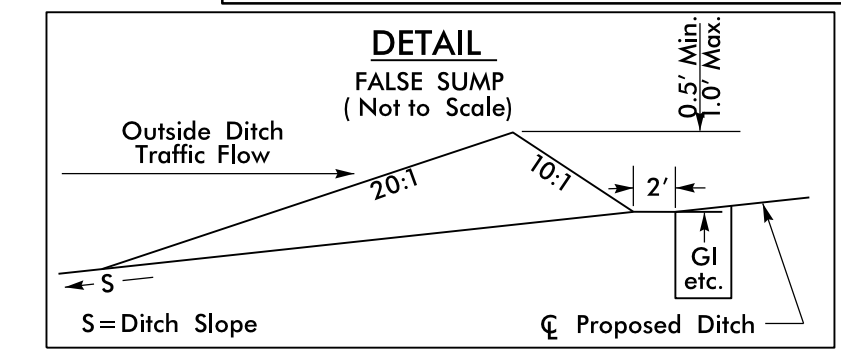
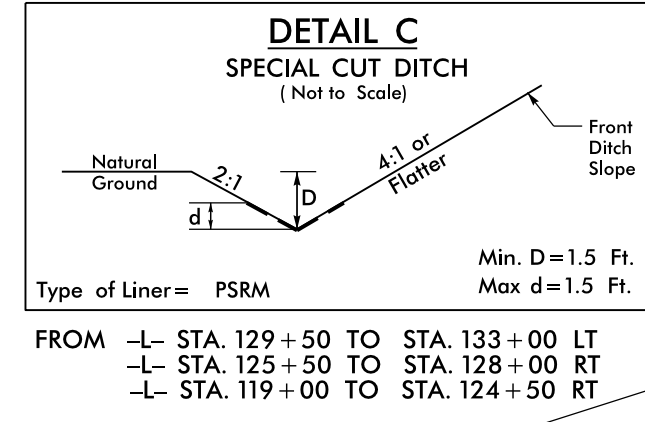

FOR -L- PROFILE SEE SHEET 24

C:\FEB 2006\JES\Projects\N-4416 (Clay Co. DDRL)\Revisions 2-11-2006\R-4416-EC_psh12.dgn
 User: jef
 Date: 2/11/06 10:55 AM