

PROJECT REFERENCE NO.	SHEET NO.
R-4416	EC-15/CONST.15
RW SHEET NO.	
ROADWAY DESIGN ENGINEER	HYDRAULICS ENGINEER

**-L- LINE**  
 Pls Sta 159+64.79  
 $\theta_s = 10^\circ 53' 04.9''$   
 Ls = 288.00'  
 LT = 192.36'  
 ST = 96.33'

**-L- LINE**  
 Pls Sta 167+60.96    Pl Sta 173+71.80  
 $\theta_s = 7^\circ 03' 06.4''$      $\Delta = 42^\circ 24' 29.6''$  (LT)  
 Ls = 320.00'    D = 4' 24" 26.5"  
 LT = 213.50'    L = 962.21'  
 ST = 106.82'    R = 1,300.00'  
                     Ds = 60mph  
                     SE = .08

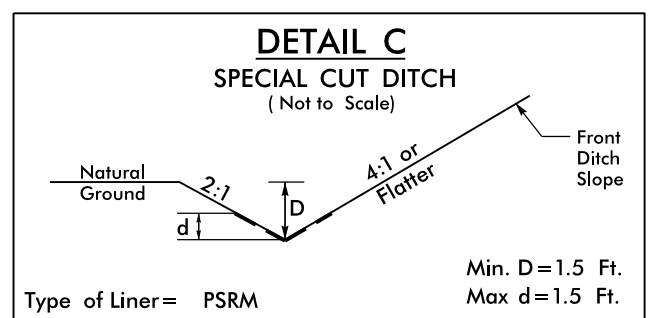
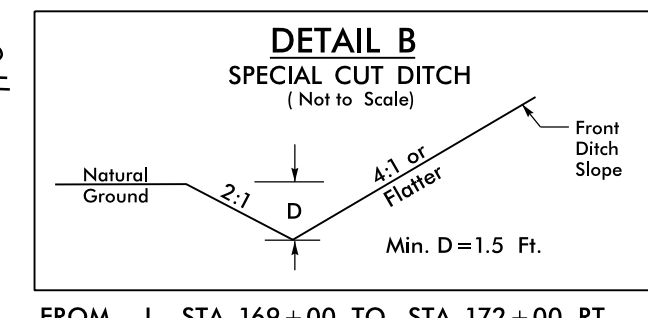
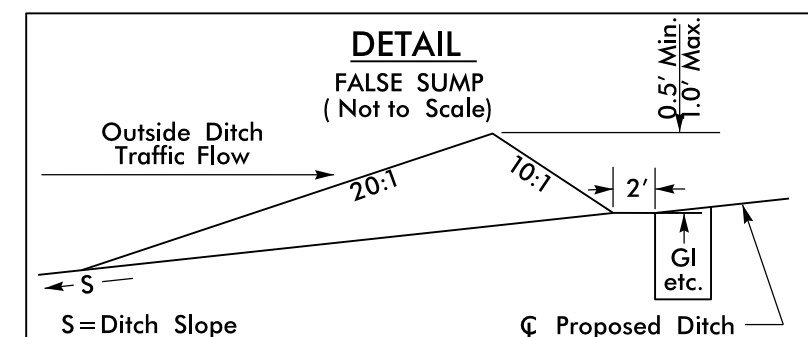
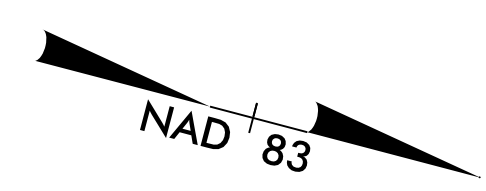

FROM -L- STA. 169+00 TO STA. 172+00 RT  
 -L- STA. 163+00 TO STA. 164+50 RT.

FROM -L- STA. 172+00 TO STA. 175+00 RT.  
 -L- STA. 165+00 TO STA. 168+50 RT.  
 -L- STA. 162+00 TO STA. 163+00 RT.

MATCHLINE - SHEET 14 -L- Sta. 161+00.00

MATCHLINE - SHEET 16 -L- Sta. 175+00.00

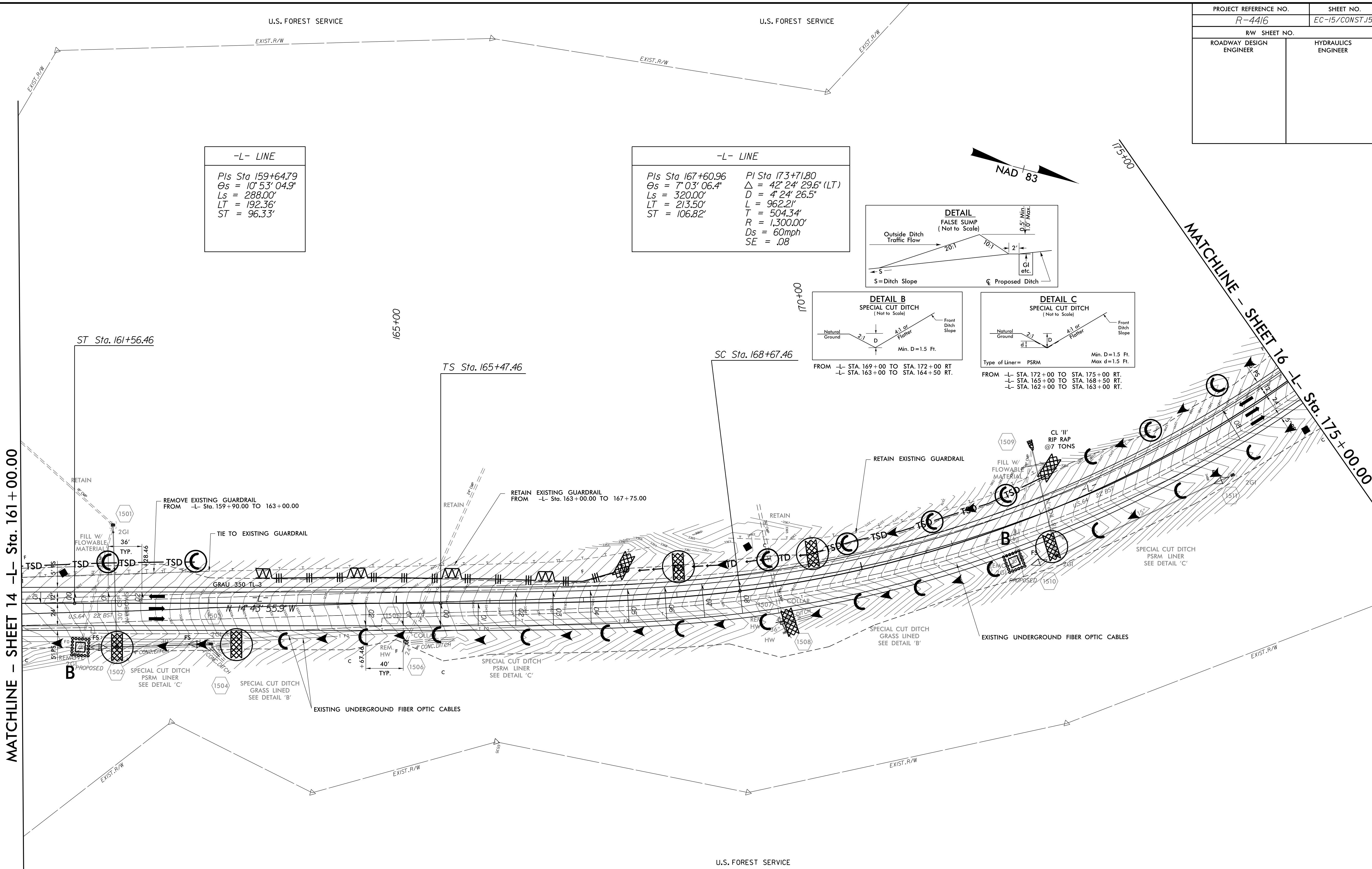

CLEARING AND GRUBBING  
 EROSION CONTROL FOR  
 CONSTRUCTION SHEET 15

NOTE:  
 PLACE TEMPORARY ROCK SEDIMENT DAMS TYPE - B  
 AND TEMPORARY ROCK SILT CHECKS TYPE - A AT  
 DRAINAGE OUTLETS.

FOR -L- PROFILE SEE SHEET 25 & 26

8/17/99  
 07-FEB-2006 12:25  
 C:\Users\jclay\Documents\2-11-2006\R-4416-EC-psht15.dgn  
 AT: RENV2410