

8/17/99

2/18/2016 2:28:19 PM R:\4416.rdy_psh15.dgn
USER: todd.buckner

MATCHLINE - SHEET 14 -L- Sta. 161+00.00

MATCHLINE - SHEET 16 -L- Sta. 175+00.00

-L- LINE

PIs Sta 159+64.79
 $\Theta_s = 10^\circ 53' 04.9''$
 $L_s = 288.00'$
 $LT = 192.36'$
 $ST = 96.33'$

-L- LINE

PIs Sta 167+60.96 PI Sta 173+71.80
 $\Theta_s = 7^\circ 03' 06.4''$ $\Delta = 42^\circ 24' 29.6''$ (LT)
 $L_s = 320.00'$ $D = 4' 24' 26.5''$
 $LT = 213.50'$ $L = 962.21'$
 $ST = 106.82'$ $T = 504.34'$
 $R = 1,300.00'$
 $D_s = 60\text{mph}$
 $SE = .08$

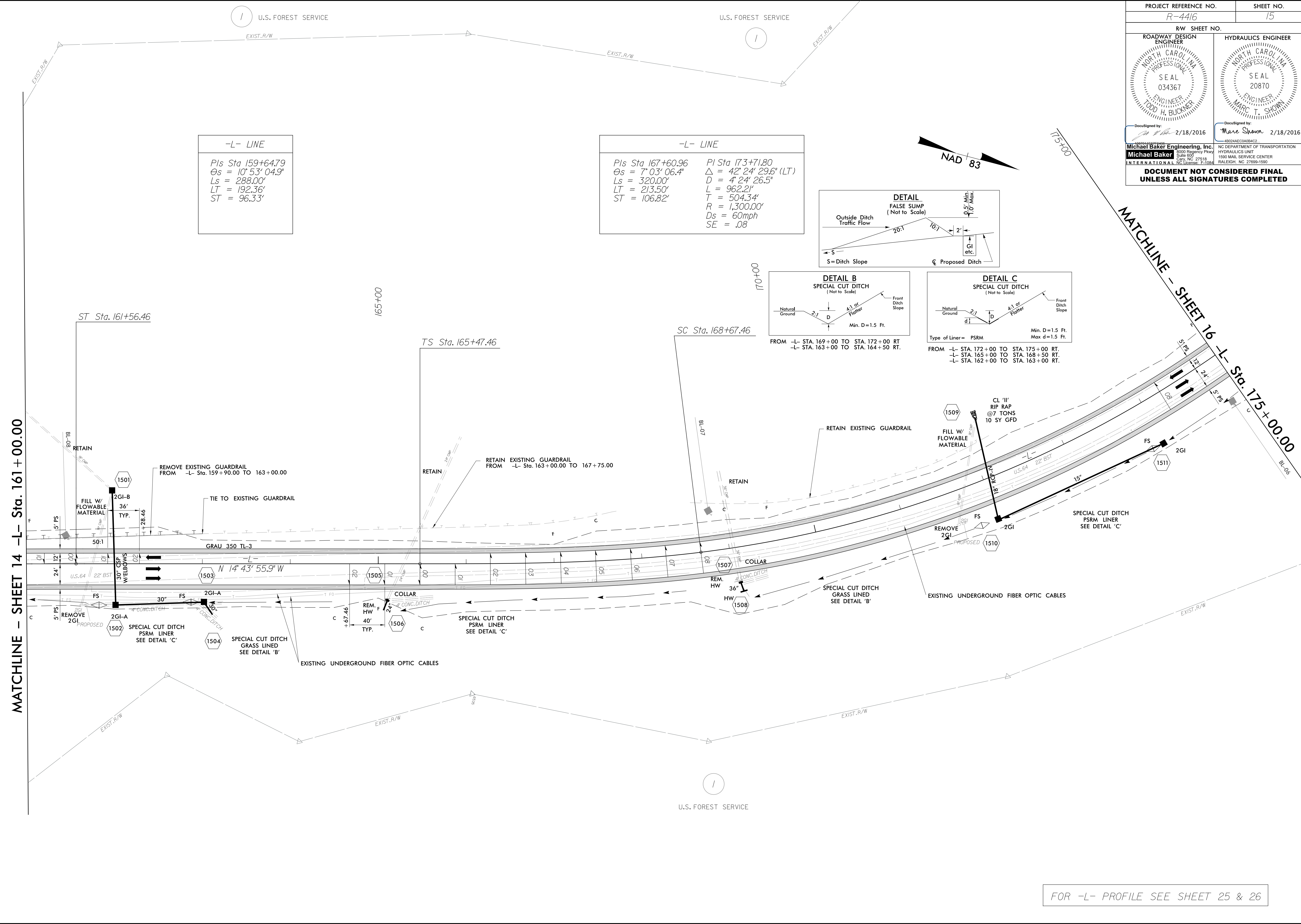
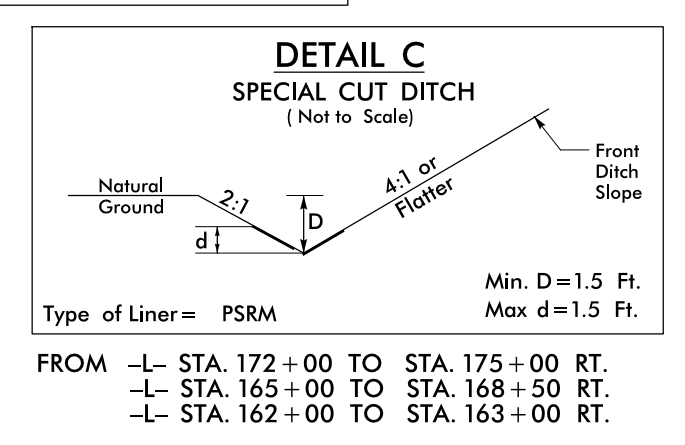
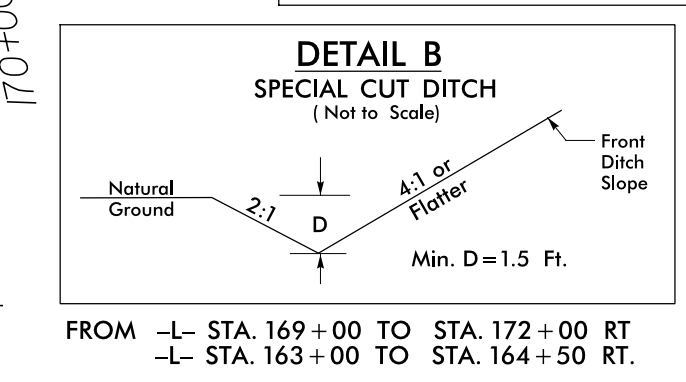
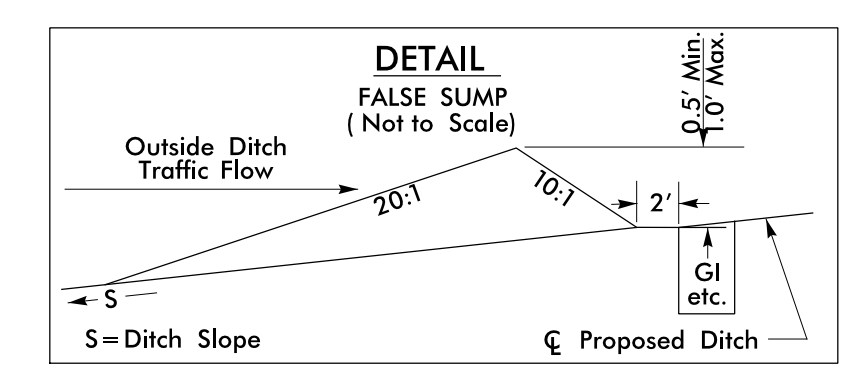

PROJECT REFERENCE NO. R-4416	SHEET NO. 15
RW SHEET NO.	
ROADWAY DESIGN ENGINEER NORTH CAROLINA PROFESSIONAL ENGINEER SEAL 034367 TODD H. BUCKNER	HYDRAULICS ENGINEER NORTH CAROLINA PROFESSIONAL ENGINEER SEAL 20870 MARC T. SHOWN
DocuSigned by: Todd H. Buckner 2/18/2016	DocuSigned by: Marc T. Shown 2/18/2016
Michael Baker Engineering, Inc. 1500 Regency Park Suite 600 Raleigh, NC 27618 INTERNATIONAL NC License: F-1084	NC DEPARTMENT OF TRANSPORTATION HYDRAULICS UNIT 1590 MAIL SERVICE CENTER RALEIGH, NC 27699-1590
DOCUMENT NOT CONSIDERED FINAL UNLESS ALL SIGNATURES COMPLETED	

REVISIONS

FOR -L- PROFILE SEE SHEET 25 & 26