

PROJECT REFERENCE NO. <i>R-4416</i>	SHEET NO. 9
RW SHEET NO.	
ROADWAY DESIGN ENGINEER NORTH CAROLINA PROFESSIONAL ENGINEER SEAL 034367 LODD H. BUCKNER	HYDRAULICS ENGINEER NORTH CAROLINA PROFESSIONAL ENGINEER SEAL 20870 MARC T. SHOWN
DocuSigned by: <i>L.H.B.</i> 2/18/2016	DocuSigned by: <i>Marc Shown</i> 2/18/2016
Michael Baker Engineering, Inc. 1500 Regency Park Suite 600 Raleigh, NC 27618 INTERNATIONAL NC License: F-1084	NC DEPARTMENT OF TRANSPORTATION HYDRAULICS UNIT 1590 MAIL SERVICE CENTER RALEIGH, NC 27699-1590

**DOCUMENT NOT CONSIDERED FINAL
UNLESS ALL SIGNATURES COMPLETED**

-L- LINE

PI Sta 81+32.59	PI s Sta 87+05.22
$\Delta = 47^{\circ} 22' 36.4''$ (LT)	$\Theta_s = 7^{\circ} 38' 22.0''$
$D = 4' 46' 28.7''$	$L_s = 320.00'$
$L = 992.26'$	$LT = 213.53'$
$T = 526.47'$	$ST = 106.85'$
$R = 1,200.00'$	
$D_s = 60\text{mph}$	
$SE = .08$	

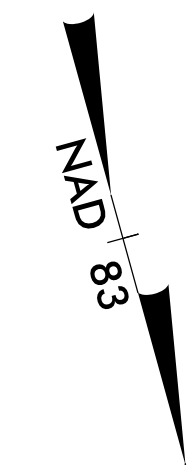
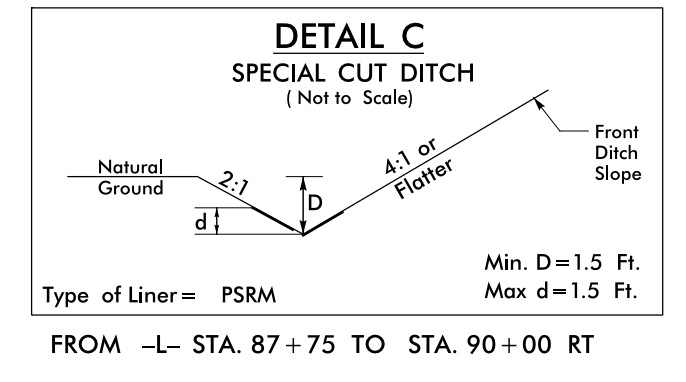
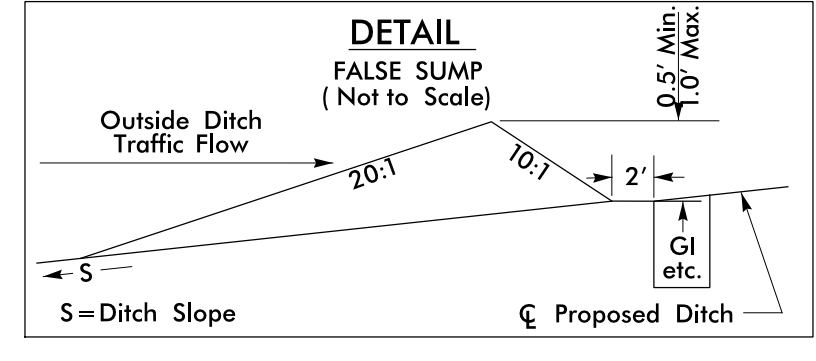
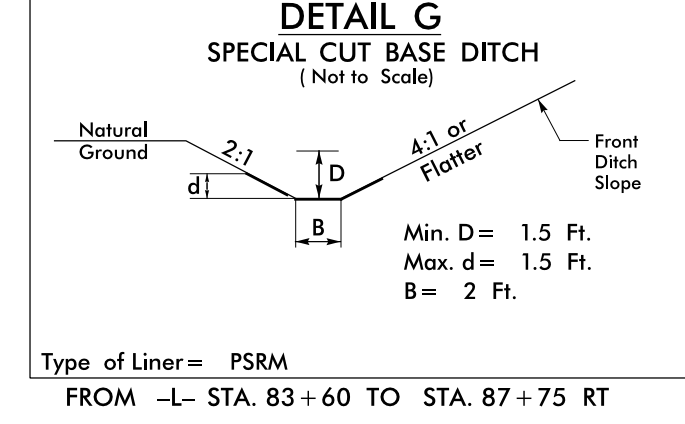
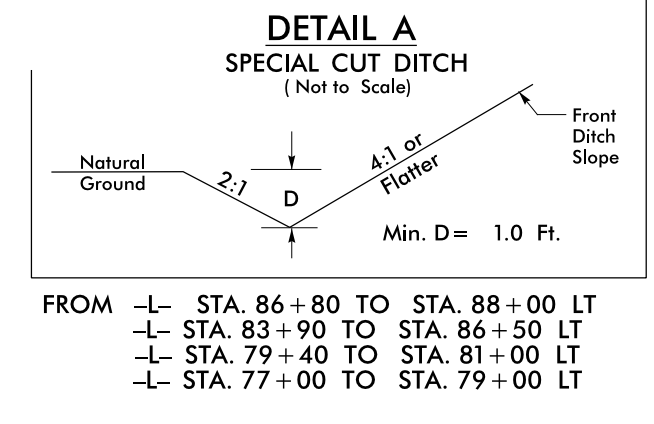

REVISIONS

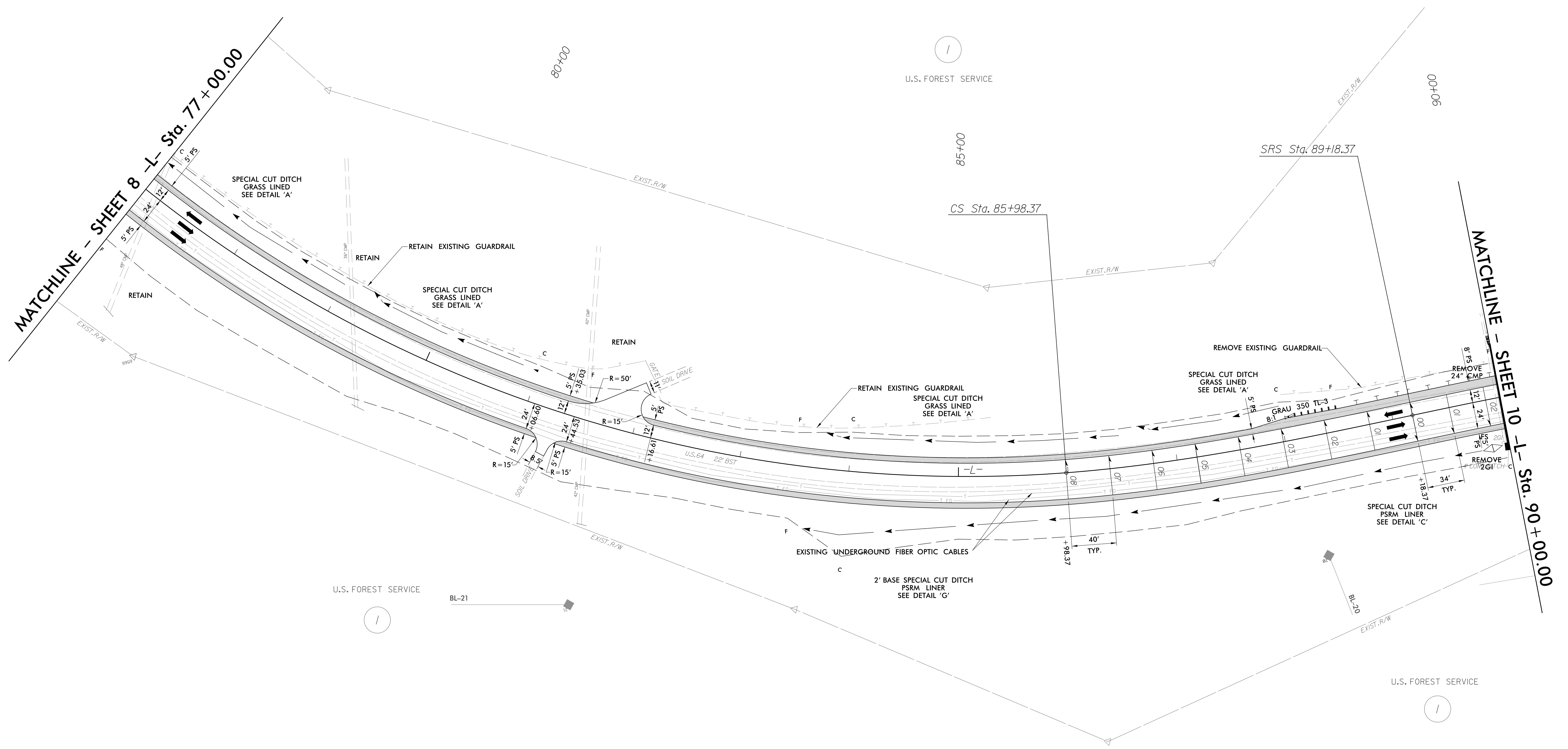

FOR -L- PROFILE SEE SHEET 22

2/18/2016 2:28:13 PM R:\4416.rdy_psh09.dgn
USER: loddh