

PROJECT REFERENCE NO. R-4416	SHEET NO. 6
RW SHEET NO.	
ROADWAY DESIGN ENGINEER NORTH CAROLINA PROFESSIONAL ENGINEER SEAL 034367 LODD H. BUCKNER	HYDRAULICS ENGINEER NORTH CAROLINA PROFESSIONAL ENGINEER SEAL 20870 MARC T. SHOWN
DocuSigned by: 2/18/2016	DocuSigned by: Marc Shown 2/18/2016
Michael Baker Engineering, Inc. 1500 Regency Park Suite 600 Cary, NC 27518 INTERNATIONAL NC License: F-1084	NC DEPARTMENT OF TRANSPORTATION HYDRAULICS UNIT 1590 MAIL SERVICE CENTER RALEIGH, NC 27699-1590
DOCUMENT NOT CONSIDERED FINAL UNLESS ALL SIGNATURES COMPLETED	

-L- LINE

Pls Sta 50+85.74
 $\Theta_s = 8^\circ 27' 43.7''$
 $L_s = 288.00'$
 $LT = 192.22'$
 $ST = 96.20'$

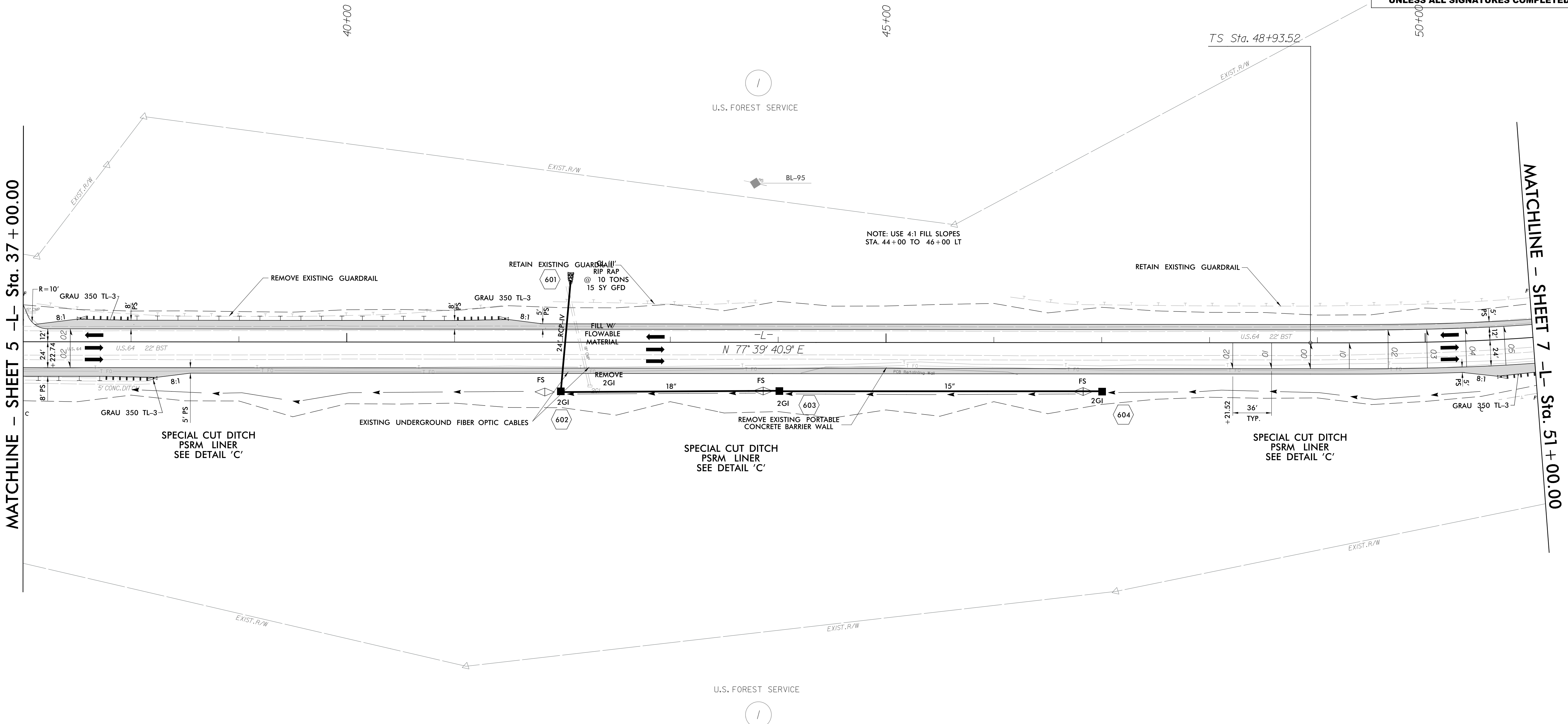
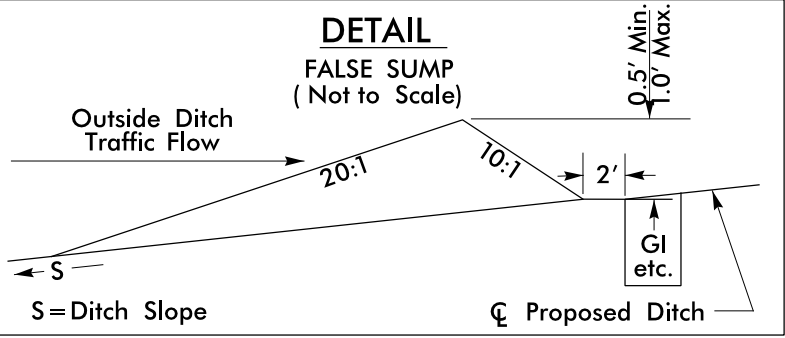
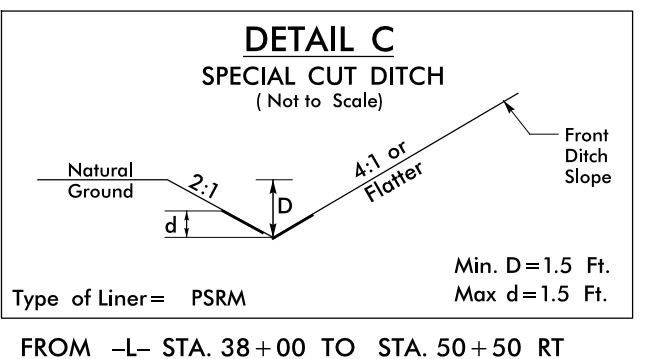
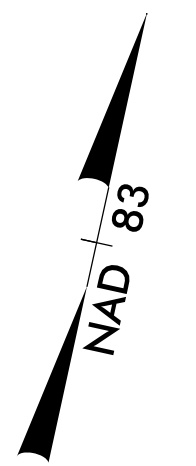

REVISIONS

2/18/2016 2:28:11 PM
 R:\N\4416\4416.rdy_psh06.dgn
 USER: loddh

FOR -L- PROFILE SEE SHEET 21