

SURVEY CONTROL SHEET B-5147

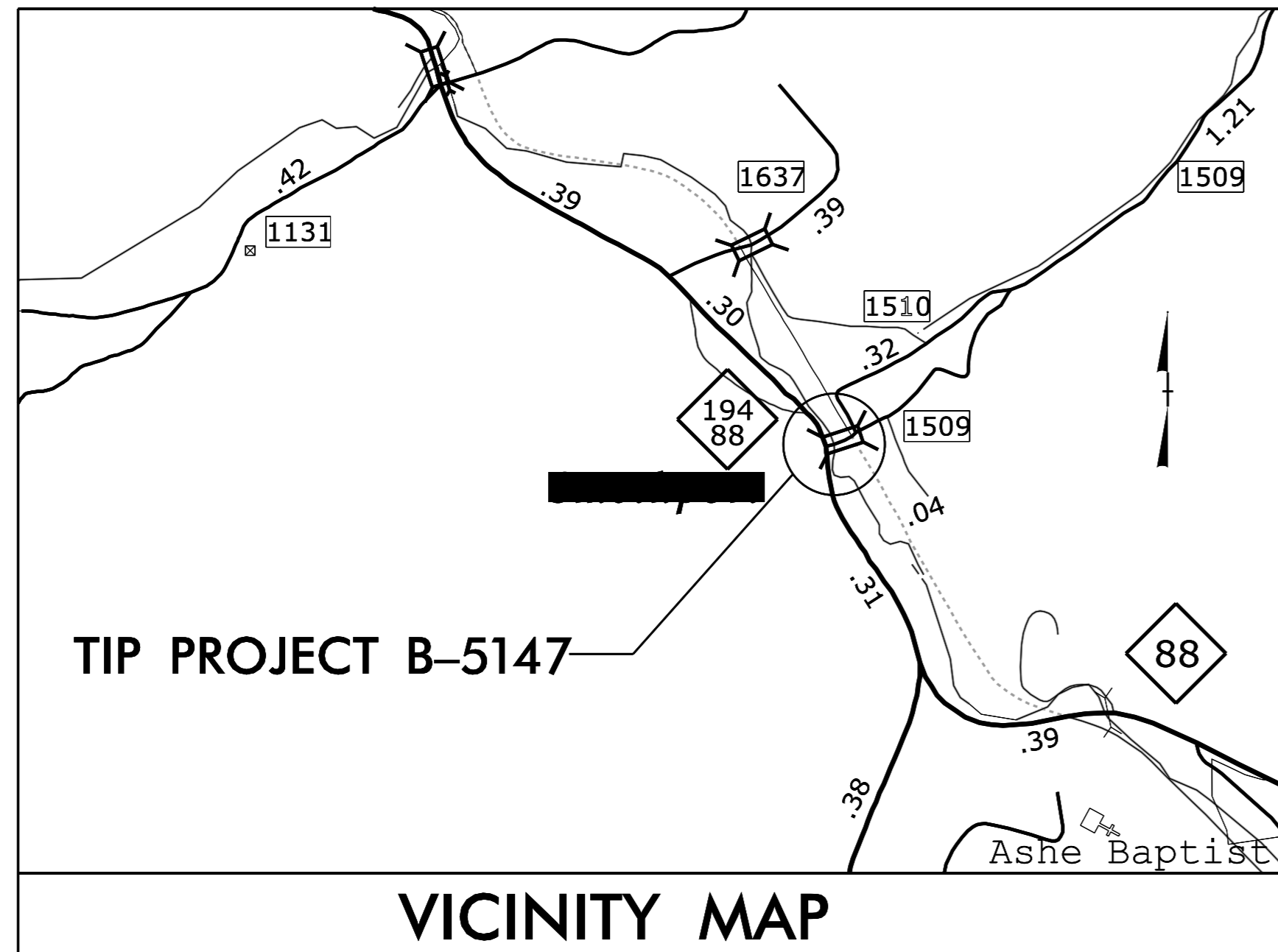

| BL POINT | DESC. | NORTH | EAST | ELEVATION | L STATION | OFFSET |
|----------|-------------|-------------|--------------|-----------|------------------------|-----------|
| 3 | BL-3 | 983564.9889 | 1263901.9576 | 2821.03 | OUTSIDE PROJECT LIMITS | |
| 4 | BL-4 | 983579.1061 | 1264217.3353 | 2820.10 | OUTSIDE PROJECT LIMITS | |
| 1 | GPS B5147-1 | 983784.2400 | 1264030.8120 | 2817.10 | 11+93.90 | 198.34 LT |
| 2 | GPS B5147-2 | 984314.9780 | 1264890.1120 | 2838.44 | OUTSIDE PROJECT LIMITS | |

| BY POINT | DESC. | NORTH | EAST | ELEVATION | L STATION | OFFSET |
|----------|-------|-------------|--------------|-----------|------------------------|--------|
| 5 | BY-5 | 984013.1664 | 1263569.4436 | 2816.63 | OUTSIDE PROJECT LIMITS | |
| 30 | BY | 983564.9889 | 1263901.9576 | 2821.03 | OUTSIDE PROJECT LIMITS | |
| 6 | BY-6 | 983253.7653 | 1264012.8072 | 2825.97 | OUTSIDE PROJECT LIMITS | |

| BY1 POINT | DESC. | NORTH | EAST | ELEVATION | L STATION | OFFSET |
|-----------|-------|-------------|--------------|-----------|------------------------|--------|
| 40 | BY-1 | 983579.1061 | 1264217.3353 | 2820.10 | OUTSIDE PROJECT LIMITS | |
| 7 | BY1-7 | 983779.9049 | 1264496.5067 | 2832.64 | OUTSIDE PROJECT LIMITS | |

 BM1 ELEVATION = 2827.58
 N 983265 E 1264033
 L STATION 12+29.00
 S 18°13'34.33" W DIST 376.37
 BM #1 RR SPIKE IN 16" PINE

 BM2 ELEVATION = 2822.55
 N 983945 E 1264211
 L STATION 12+29.00
 N 10°39'14.80" E DIST 328.35
 BM #2 RR SPIKE IN 18" PINE

●
 NC DOT GPS STATION B5147-2
 LOCALIZED PROJECT COORDINATES
 N= 984314.9780
 E= 1264890.1120
 ELEVATION= 2838.4400.

●
 NC DOT GPS STATION B5147-1
 LOCALIZED PROJECT COORDINATES
 N= 983784.2400
 E= 1264030.8120
 ELEVATION= 2817.1040'

BEGIN TIP PROJECT B-5147
STA. -L- 10+17.43
N=983527.7909
E=1263962.1353

END TIP PROJECT B-5147
STA. -L- 12+11.55
N=983614.9160
E=1264135.6051

DATUM DESCRIPTION

THE LOCALIZED COORDINATE SYSTEM DEVELOPED FOR THIS PROJECT IS BASED ON THE STATE PLANE COORDINATES ESTABLISHED BY NCDOT FOR MONUMENT "B5147-1"

WITH NAD 83/CORS96 STATE PLANE GRID COORDINATES OF
 NORTHING: 983784.2398(ft) EASTING: 1264030.8118(ft)
 ELEVATION: 2817.1040(ft)

THE AVERAGE COMBINED GRID FACTOR USED ON THIS PROJECT (GROUND TO GRID) IS: .9999534122

THE N.C. LAMBERT GRID BEARING AND LOCALIZED HORIZONTAL GROUND DISTANCE FROM "B5147-1" TO -L- STATION 10+17.43 IS
 S 14°59'31" W 265.49'

ALL LINEAR DIMENSIONS ARE LOCALIZED HORIZONTAL DISTANCES
 VERTICAL DATUM USED IS NAVD 88

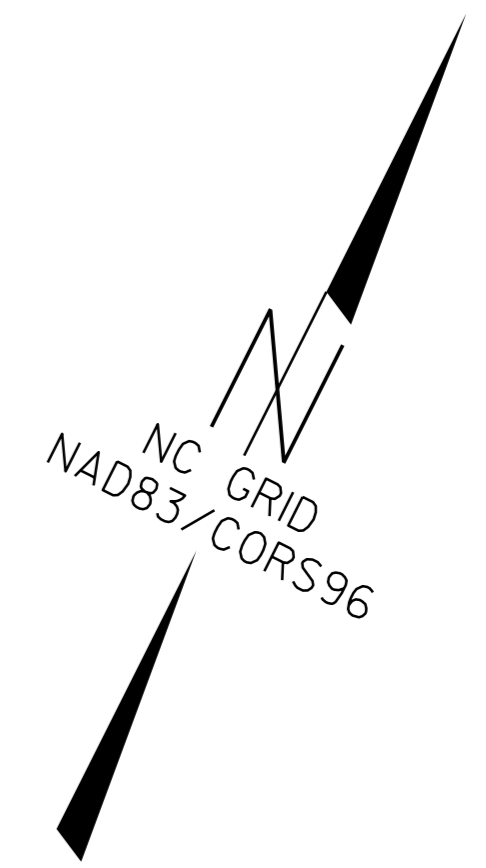
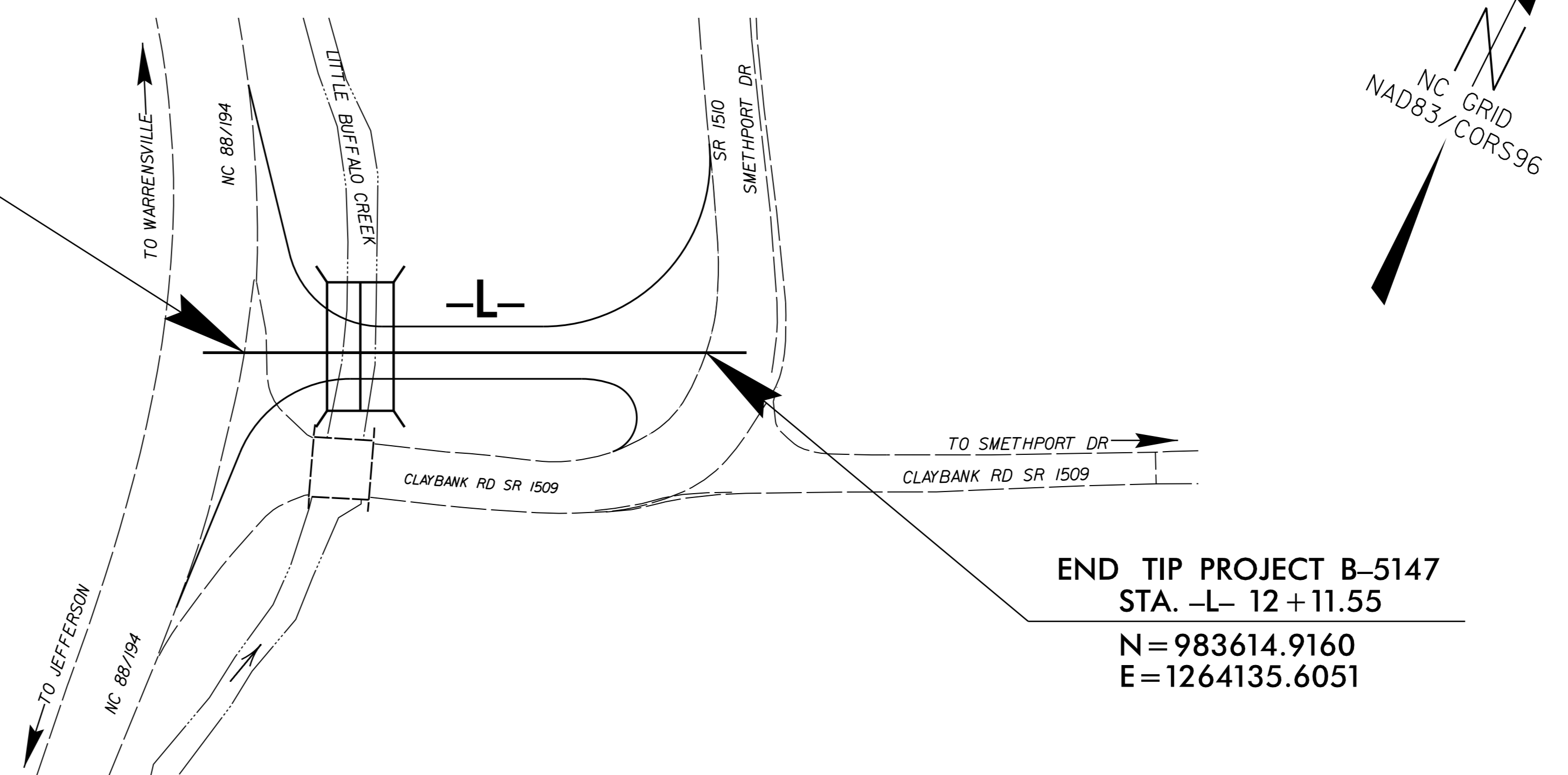

NOTE: DRAWING NOT TO SCALE

6/2/99
 16-FEB-2016 08:34
 C:\GIS\PROJECTS\B5147\1s-1c-1.dgn