

09/08/99

See Sheet 1A For Index of Sheets  
 See Sheet 1B For Conventional Symbols  
 See Sheet 1C-1 & 1C-2 For Survey Control Sheets

STATE OF NORTH CAROLINA  
 DIVISION OF HIGHWAYS

**RUTHERFORD COUNTY**

**LOCATION: BRIDGE 87 OVER THE BROAD RIVER ON US 64**  
**TYPE OF WORK: GRADING, DRAINAGE, PAVING, STRUCTURE AND SIGNALS**

| STATE           | STATE PROJECT REFERENCE NO. | SHEET NO.   | TOTAL SHEETS |
|-----------------|-----------------------------|-------------|--------------|
| N.C.            | B-4811                      | 1           |              |
| STATE PROJ. NO. | F.A. PROJ. NO.              | DESCRIPTION |              |
| 38581.1.1       | BRSTP-64(84)                | P.E.        |              |
| 38581.2.3       |                             | RW /UTIL.   |              |
| 38581.2.4       |                             | UTIL.       |              |
| 38581.3.2       |                             | CONST.      |              |

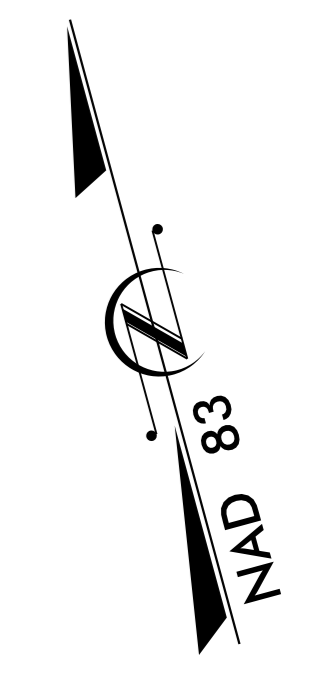
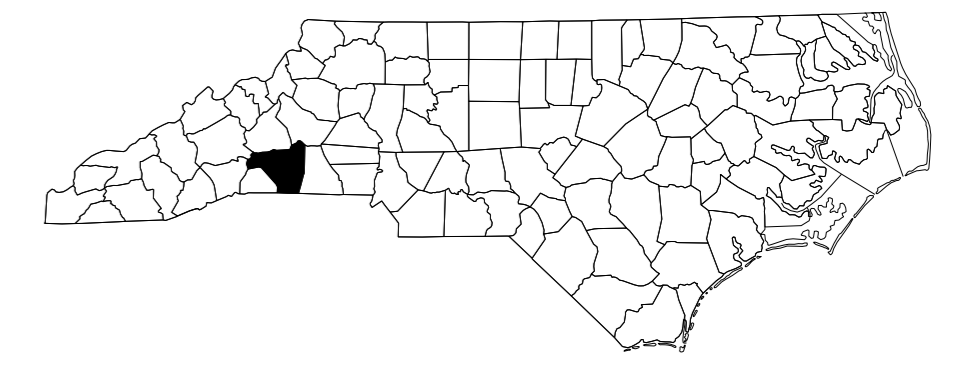

**TIP PROJECT: B-4811**

**CONTRACT: C203720**

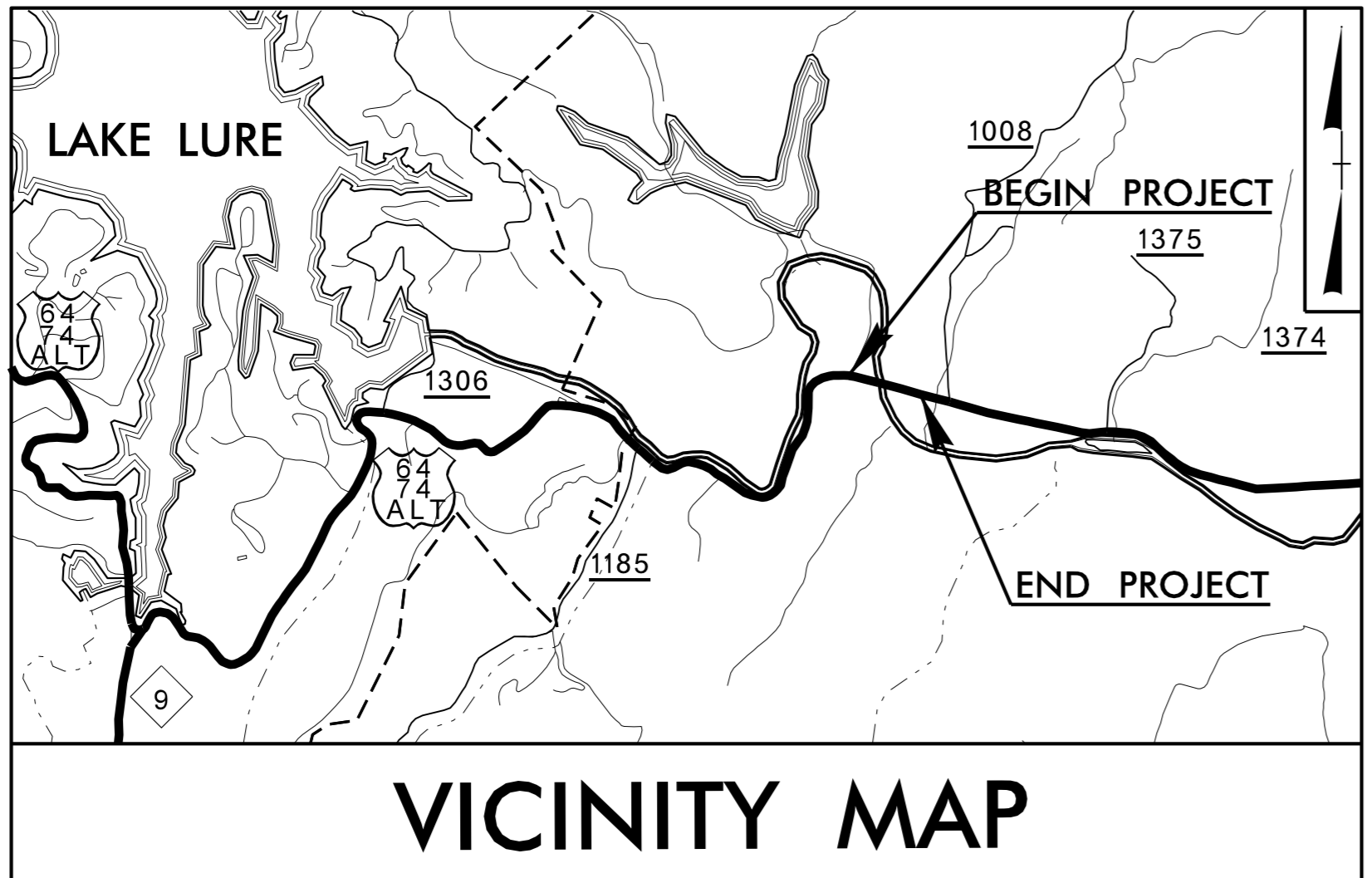

**VICINITY MAP**

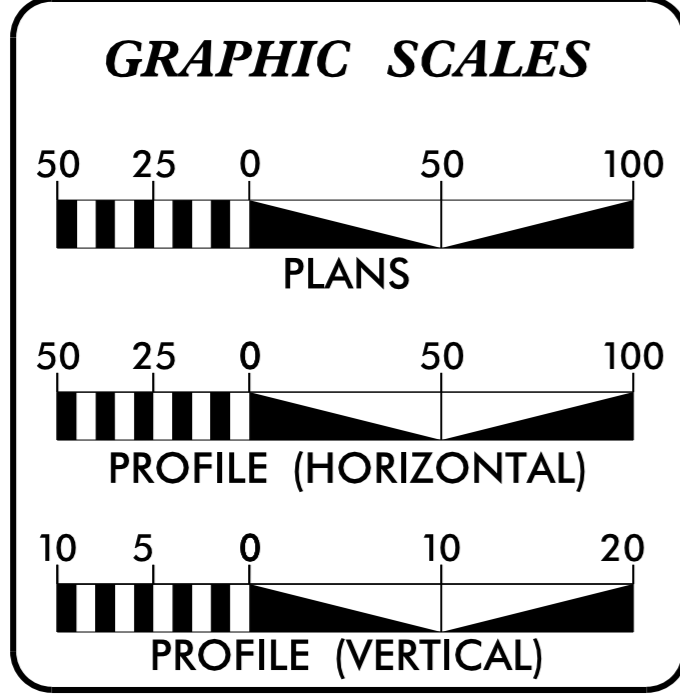
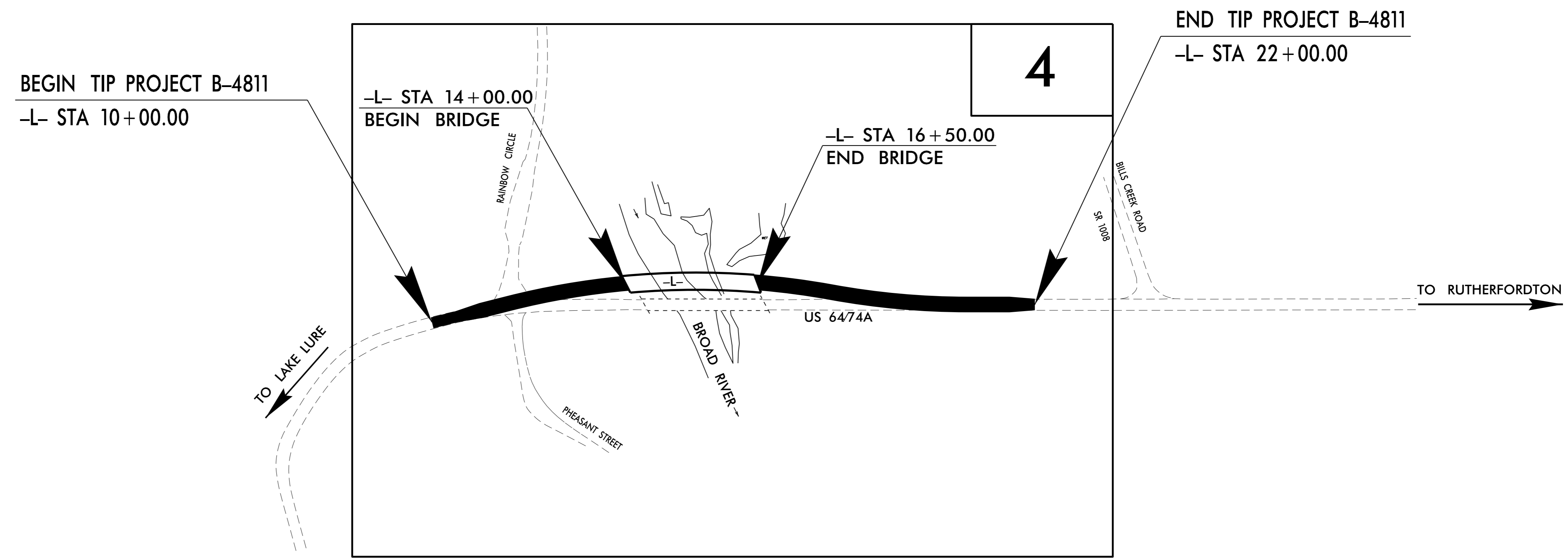

**DESIGN DATA**

|              |                        |
|--------------|------------------------|
| ADT 2016 =   | 3030                   |
| ADT 2036 =   | 4262                   |
| K =          | 11 %                   |
| D =          | 60 %                   |
| T =          | 7 % *                  |
| V =          | 50 MPH                 |
| * TTST =     | 1% DUAL = 6%           |
| FUNC CLASS = | ARTERIAL REGIONAL TIER |

**PROJECT LENGTH**

|                                           |           |
|-------------------------------------------|-----------|
| LENGTH OF ROADWAY TIP PROJECT B-4811 =    | 0.180 MI. |
| LENGTH OF STRUCTURES TIP PROJECT B-4811 = | 0.047 MI. |
| TOTAL LENGTH TIP PROJECT B-4811 =         | 0.227 MI. |

Prepared in the Office of:  
**DIVISION OF HIGHWAYS**  
 1000 Birch Ridge Dr., Raleigh NC, 27610

| 2012 STANDARD SPECIFICATIONS                |                                                         |
|---------------------------------------------|---------------------------------------------------------|
| <b>RIGHT OF WAY DATE:</b><br>MARCH 31, 2015 | <b>KEVIN E. MOORE, PE</b><br>PROJECT ENGINEER           |
| <b>LETTING DATE:</b><br>APRIL 19, 2016      | <b>STEVEN D. KENDALL, PE</b><br>PROJECT DESIGN ENGINEER |

**HYDRAULICS ENGINEER**

DocuSigned by:  
 James A. Byrd  
 SIGNATURE: 1/20/2016

**ROADWAY DESIGN ENGINEER**

DocuSigned by:  
 Steven D. Kendall  
 SIGNATURE: 1/20/2016

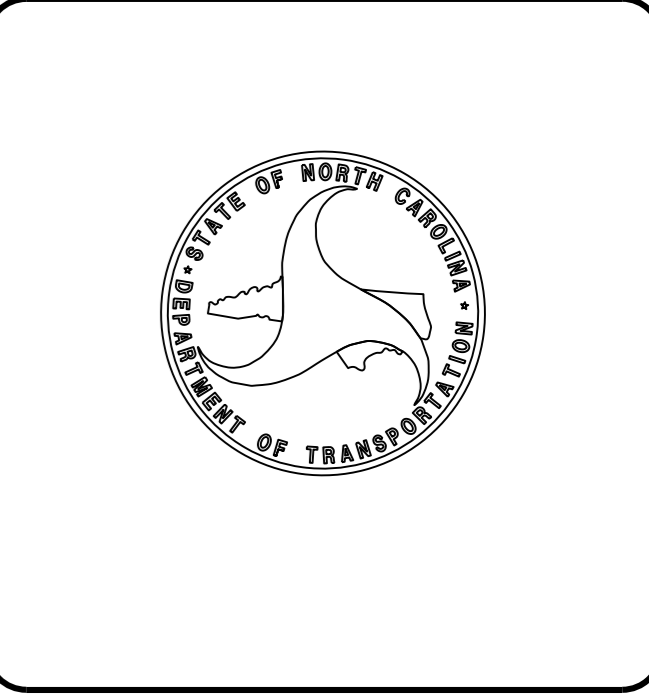

19-JAN-2016 11:50 R:\Roadway\Proj\B4811\rdy\_tsh.dgn \$\$\$\$\$\$USERNAME\$\$\$\$\$