

RW REVISION - 1/31/12 TR - REVISED RIGHT OF WAY ON PARCEL 22 TO ACCOMMODATE ONSITE MITIGATION AND CHANGED PARCEL 22 TO 22Z.

P:\2015\Projects\U2707\Traffic\Signing\CADD\Signing Layout Plans\U-2707\_Sgn\_SGN\_11.dgn  
User: raki101

MATCH LINE  
-L- STA 79+00 SEE SHEET SIGN-10

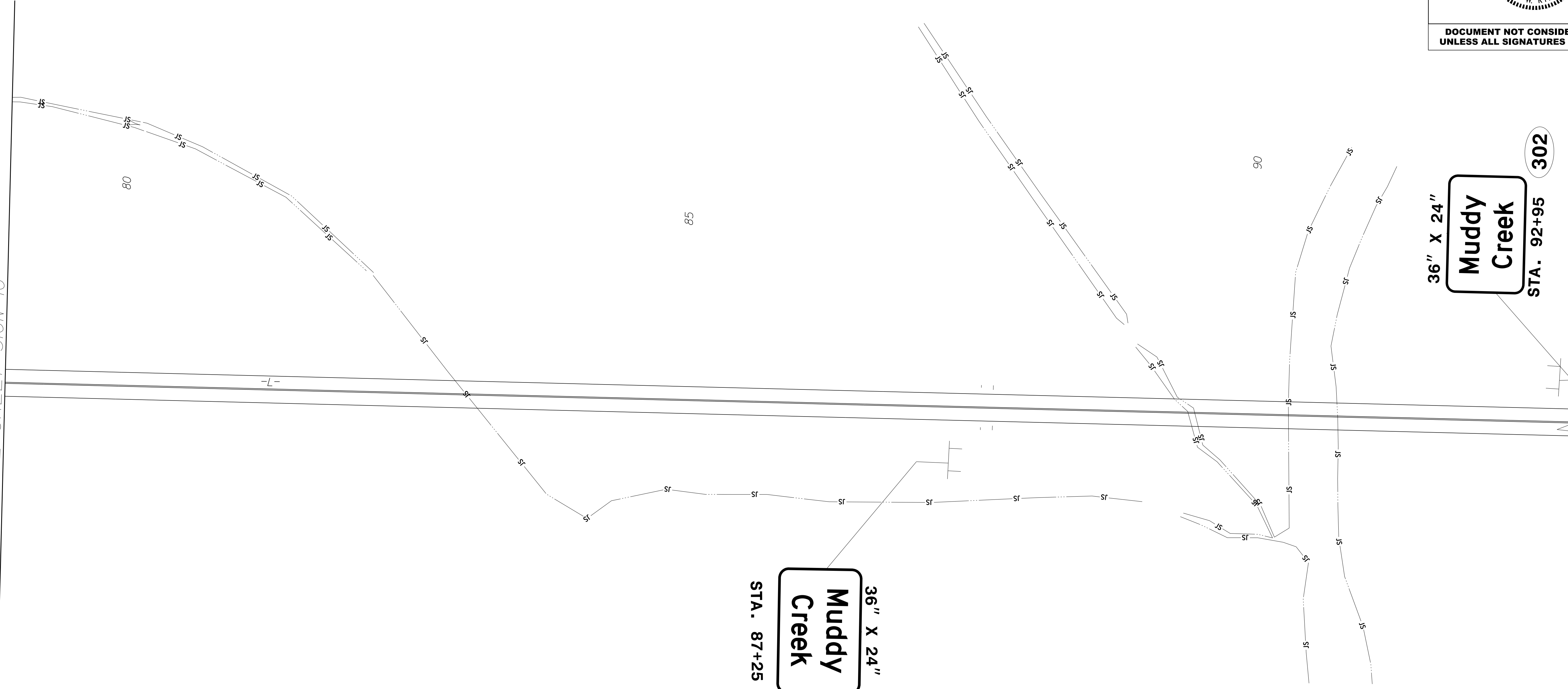

36" X 24"  
Muddy  
Creek  
STA. 87+25  
301

36" X 24"  
Muddy  
Creek  
STA. 92+95  
302

BREAK LINE -L- STA 93+00  
SEE SHEET SIGN-12 -L- STA.105.50

TIP NO. U-2707	SHEET NO. SIGN-11
APPROVED: <i>Ronald W King</i> <small>13E7AF7B8AA448...</small>	
DATE: 12/29/2015   12:32 PM PT	
SEAL	
DOCUMENT NOT CONSIDERED FINAL UNLESS ALL SIGNATURES COMPLETED	

**PROPOSED SIGNS**  
**-L- STA. 79+00 TO 93+00**