

PROJECT REFERENCE NO. U-2707		SHEET NO. 8	
RW SHEET NO.		HYDRAULICS ENGINEER	
ROADWAY DESIGN ENGINEER		2/10/2016	
2/10/2016		2/11/2016	

SEPI
ENGINEERING & CONSTRUCTION

1025 Wade Avenue
Raleigh, NC 27605
Tel: 919-789-9977
Fax: 919-789-9591
License: C-2197

MULKEY
ENGINEERS & CONSULTANTS

PO Box 33127
Raleigh, N.C. 27636
(919) 851-1912
(919) 851-1918 (FAX)
WWW.MULKEYINC.COM

DOCUMENT NOT CONSIDERED FINAL UNLESS ALL SIGNATURES COMPLETED

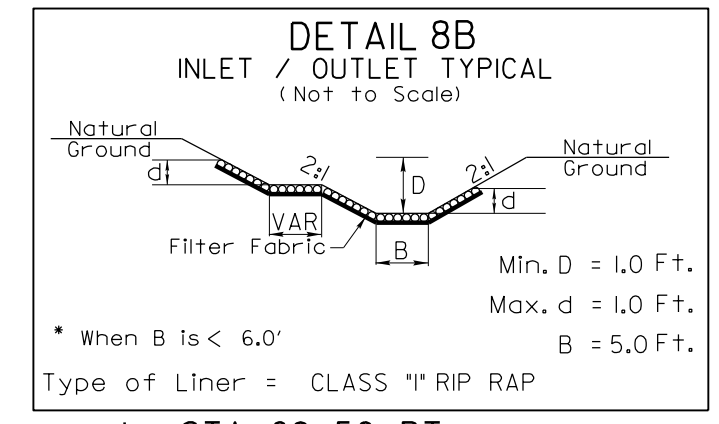

-L- STA. 68+50 RT

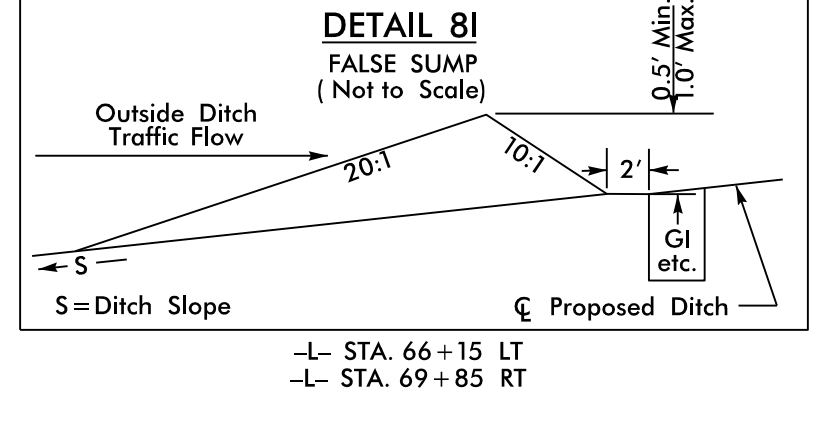

-L- STA. 66+15 LT, -L- STA. 69+85 RT

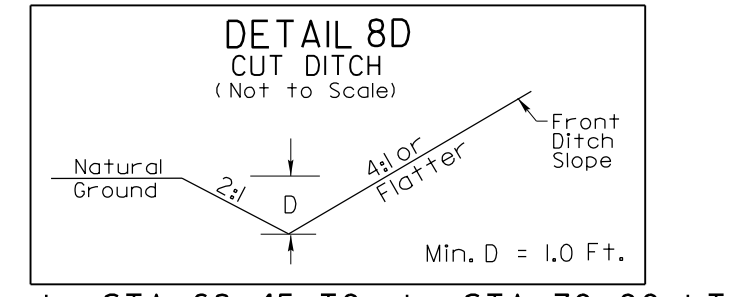

-L- STA. 68+45 TO -L- STA. 70+00 LT, -L- STA. 70+00 TO -L- STA. 71+50 RT

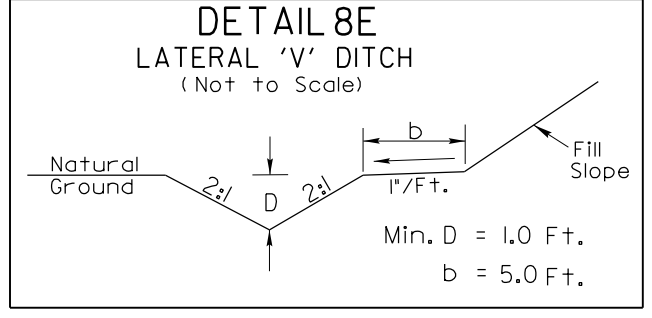

-L- STA. 68+58 TO -L- STA. 69+50 RT, -L- STA. 74+50 TO -L- STA. 79+00 LT

-DRI-

PI Sta 11+20.93 Δ = 36° 00' 35.0" (RT)
D = 28° 06' 14.7"
L = 128.13'
T = 66.26'
R = 203.87'
SE = NC

PI Sta 12+50.65 Δ = 8° 19' 40.8" (RT)
D = 6° 08' 51.4"
L = 135.47'
T = 67.85'
R = 932.00'
SE = NC

EDNA W. BINGHAM HEIRS
DB 786 PG 441
DB 2684 PG 2181

EDNA W. BINGHAM HEIRS
DB 786 PG 441
DB 2684 PG 2181

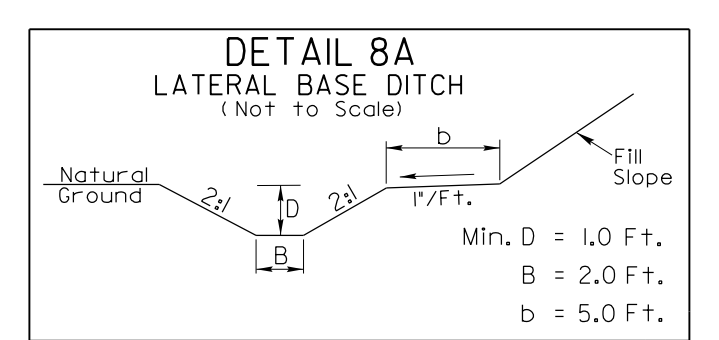
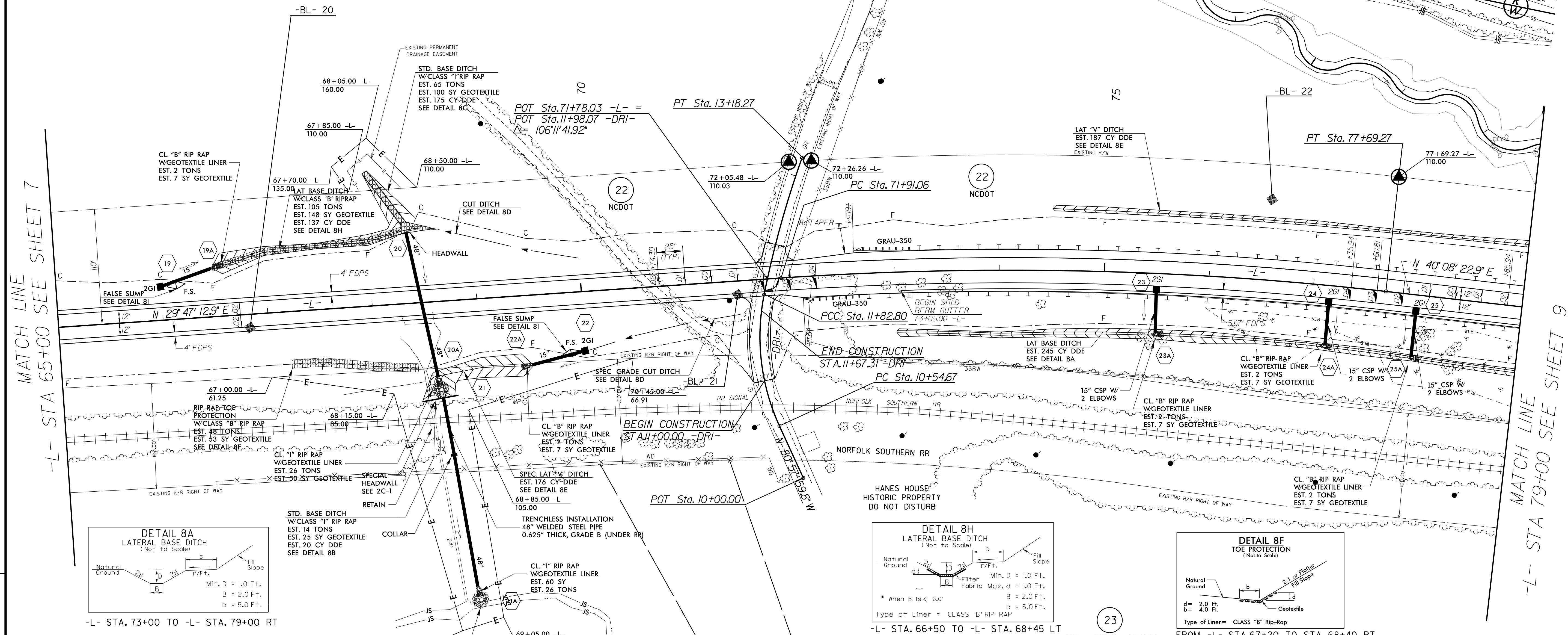
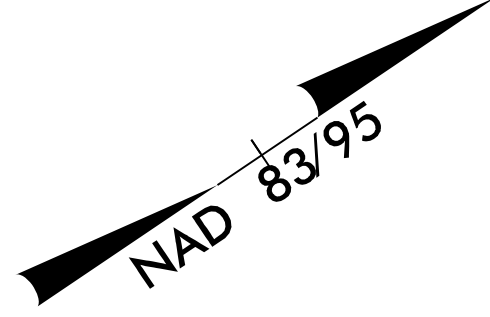

-L- STA. 73+00 TO -L- STA. 79+00 RT

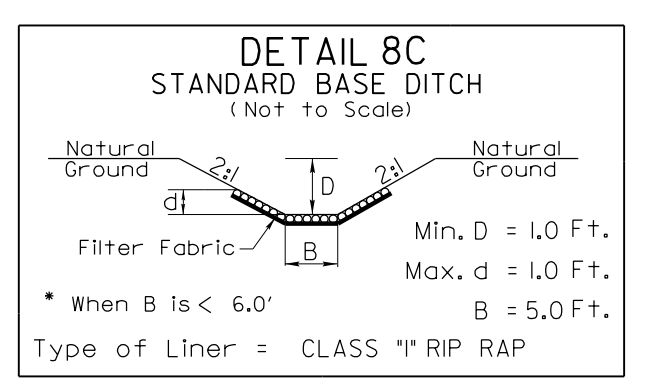

-L- STA. 68+45 LT

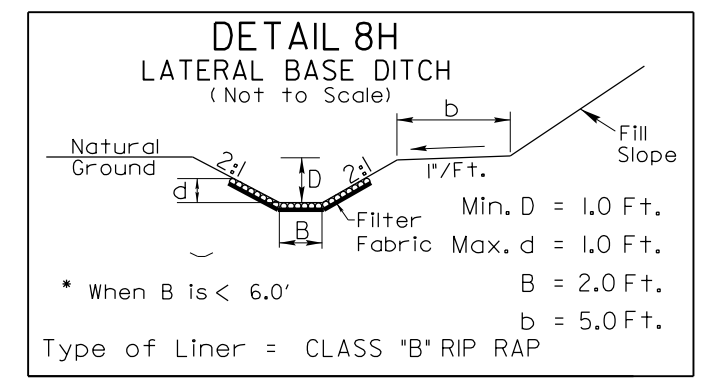

-L- STA. 66+50 TO -L- STA. 68+45 LT

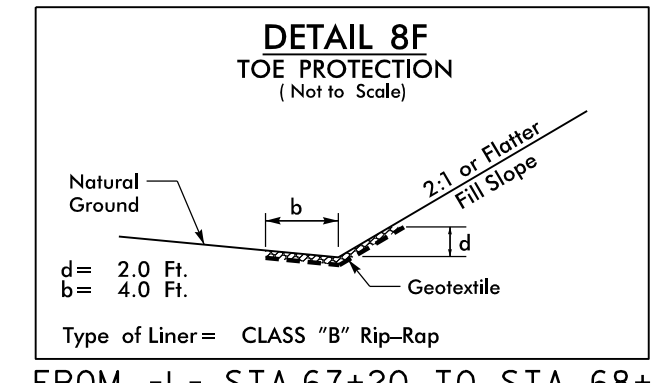

FROM -L- STA. 67+20 TO STA. 68+40 RT

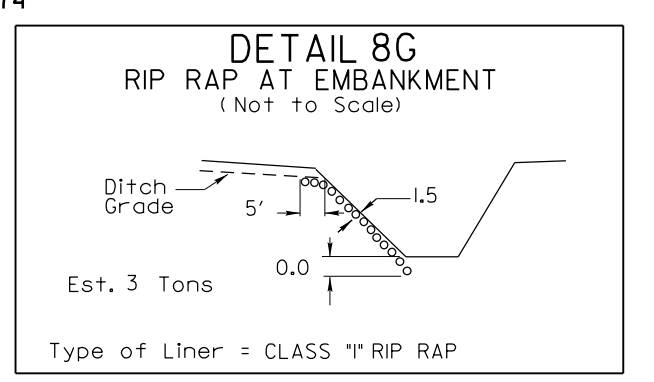

-L- STA. 90+90 RT

-L-

PI Sta 74+80.95 Δ = 10° 21' 10.0" (RT)
D = 1° 47' 25.8"
L = 578.21'
T = 289.89'
R = 3,200.00'
SE = 0.04
RUNOFF = 100'

REVISIONS

MATCH LINE
-L- STA 65+00 SEE SHEET 7

MATCH LINE
-L- STA 79+00 SEE SHEET 9

SEE SHEET 16 FOR -L- GRADE

SEE SHEET 19 FOR -DRI- GRADE

SEE THE NATURAL STREAM PLANS FOR STREAM RELOCATION