

8/17/99

SEPI ENGINEERING & CONSTRUCTION
 1025 Wade Avenue
 Raleigh, NC 27605
 Tel: 919-789-9977
 Fax: 919-789-8591
 License: C-2197

MULKEY
 ENGINEERS & CONSULTANTS
 PO Box 33127
 Raleigh, NC 27636
 (919) 851-1912
 (919) 851-1918 (FAX)
 WWW.MULKEYINC.COM

PROJECT REFERENCE NO. U-2707	SHEET NO. 6
RW SHEET NO.	
ROADWAY DESIGN ENGINEER 2/10/2016	HYDRAULICS ENGINEER 2/11/2016

DOCUMENT NOT CONSIDERED FINAL UNLESS ALL SIGNATURES COMPLETED

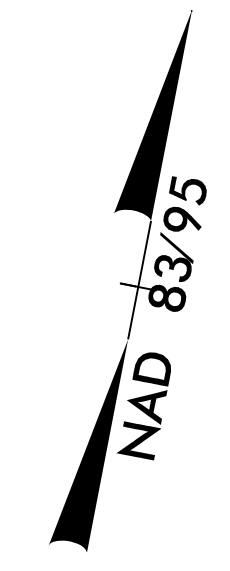
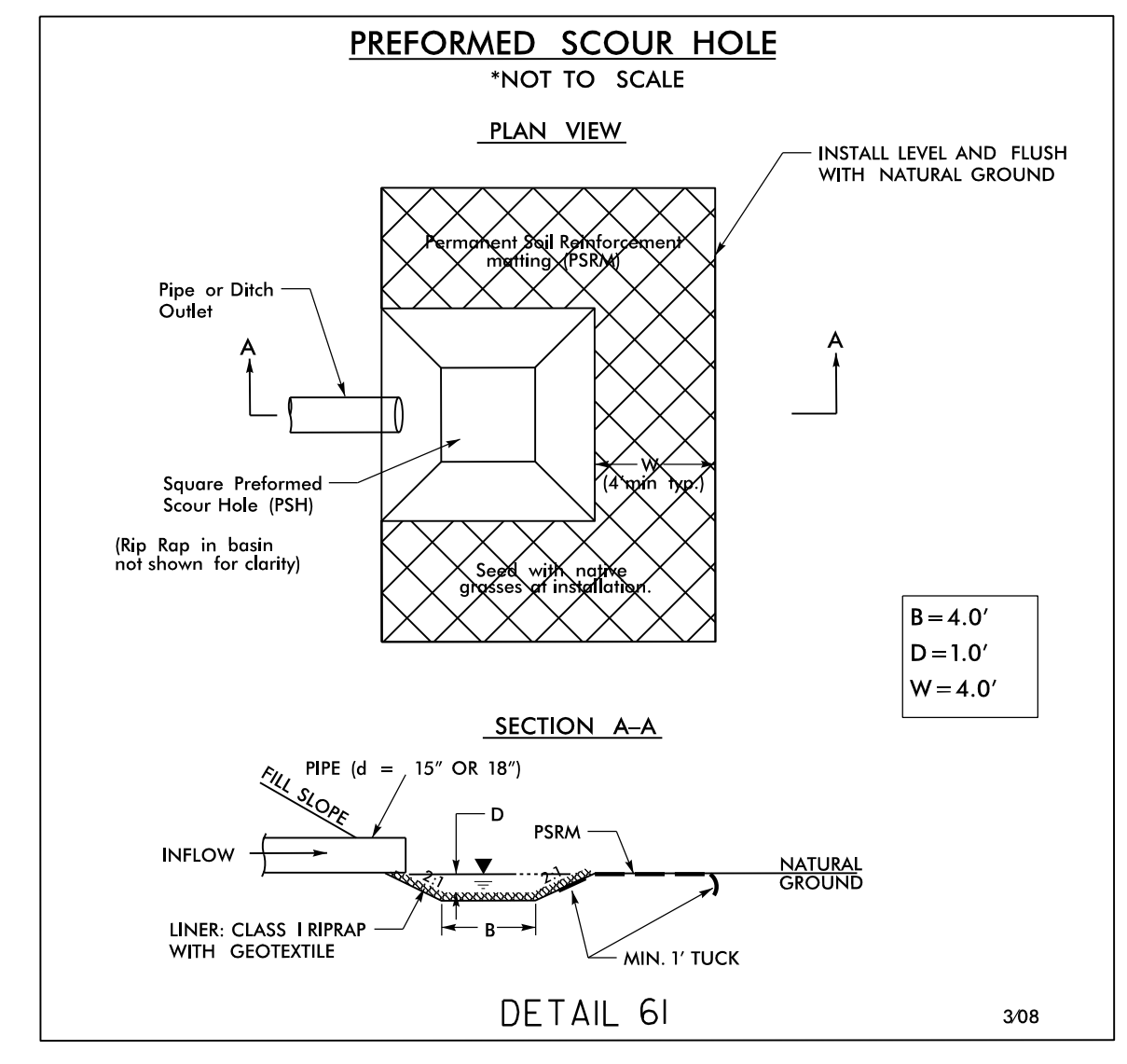

EDNA W. BINGHAM HEIRS
DB 786 PG 441
DB 2684 PG 2181

CLARK S. GENTRY AND WIFE
LINDA C. GENTRY
DB 1620 PG 697
DB 1620 PG 702
DB 2645 PG 3153

WF INVESTMENTS OF DAVIE COUNTY, LLC
DB 2927 PG 1620
DB 269 PG 1446

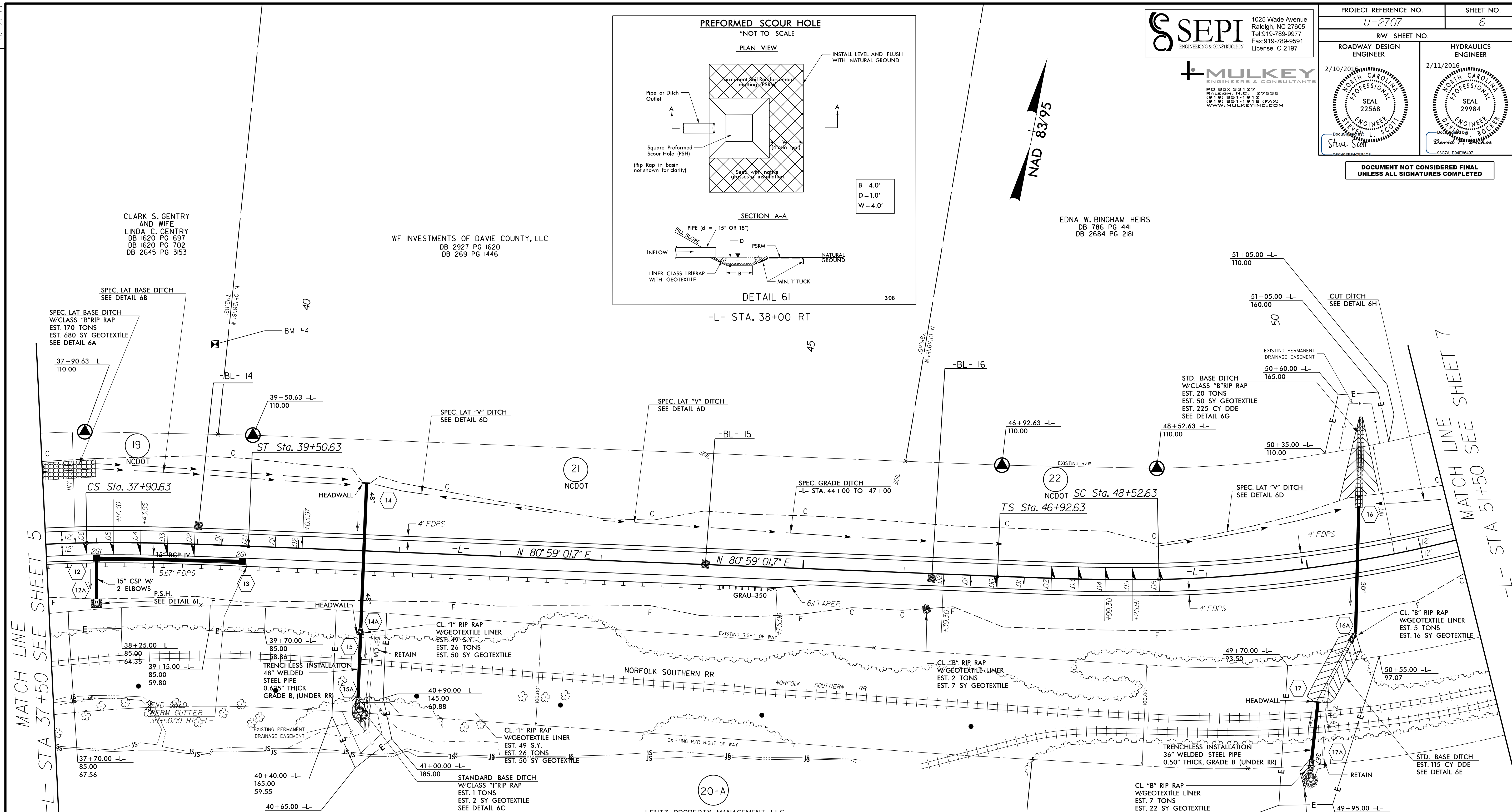

MATCH LINE SEE SHEET 5
-L- STA 37+50

MATCH LINE SEE SHEET 7
-L- STA 51+50

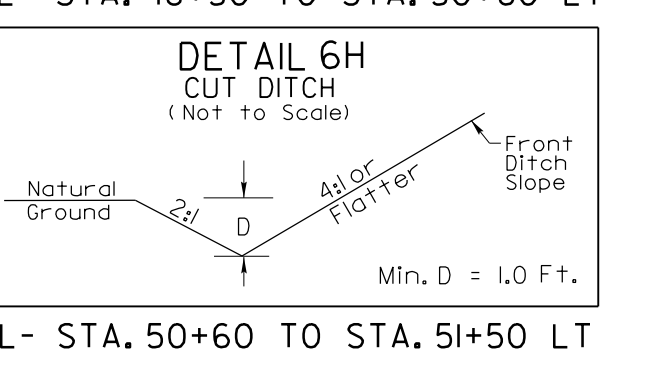
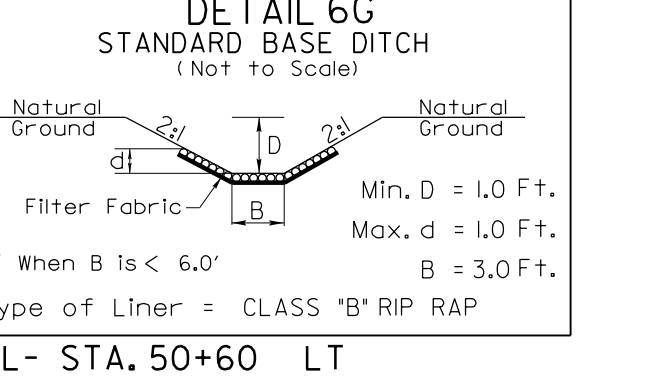
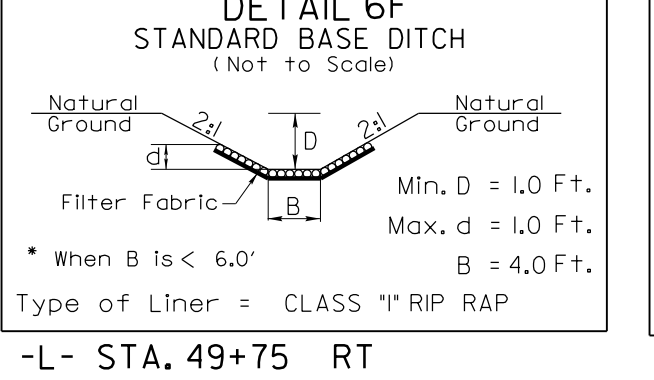
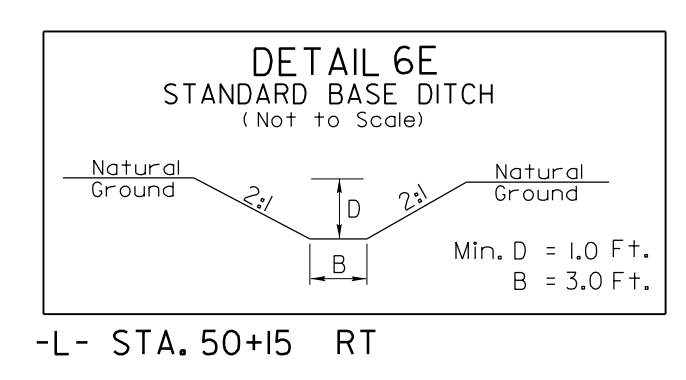
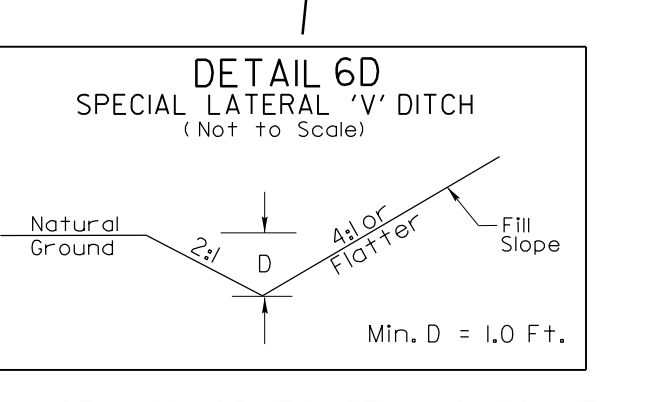
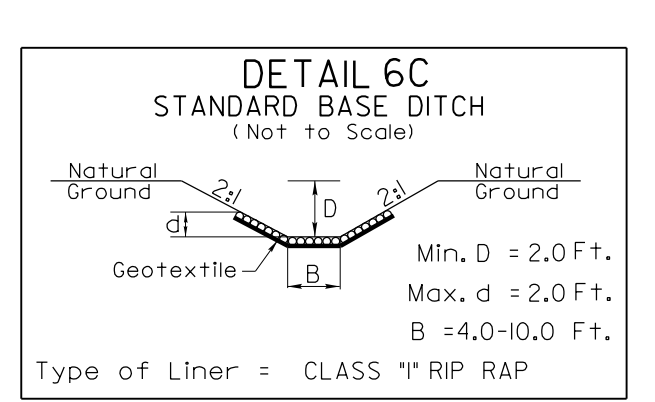
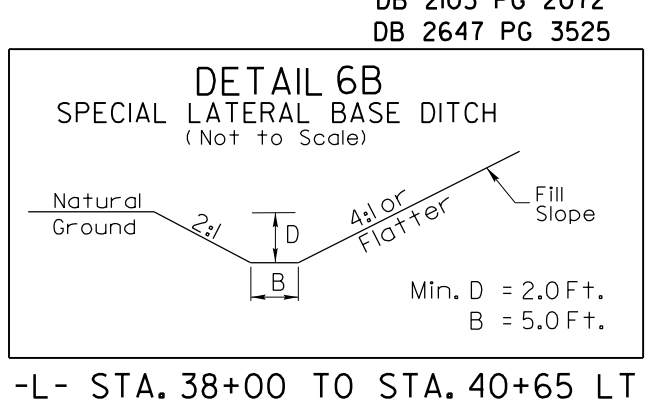
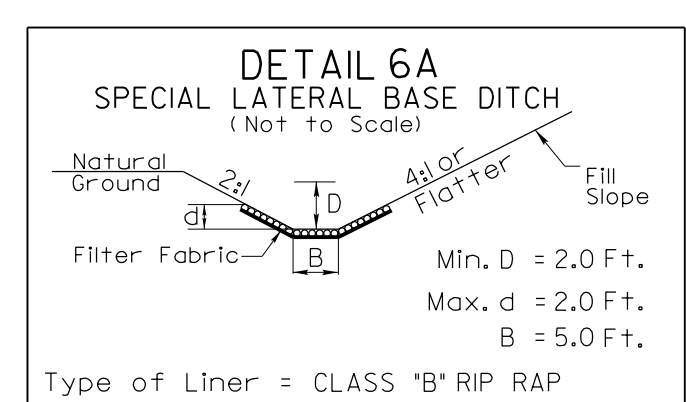

LENTZ PROPERTY MANAGEMENT, LLC
DB 2103 PG 2072
DB 2647 PG 3525

HUBBARD REALTY & MCGUIRE CONSTRUCTION
DB 1641 PG 1137

Pls Sta 38+43.98
 $\theta_s = 3^\circ 20' 00.9''$
 $L_s = 160.00'$
 $LT = 106.69'$
 $ST = 53.35'$

Pls Sta 47+99.32
 $\theta_s = 3^\circ 26' 46.9''$
 $L_s = 160.00'$
 $LT = 106.69'$
 $ST = 53.35'$

Pls Sta 53+94.10
 $\Delta = 44^\circ 18' 15.0'' (LT)$
 $D = 4' 18' 28.6''$
 $T = 541.47'$
 $R = 1,330.00'$
 $SE = 0.06$
 $RUNOFF = 160'$

SEE SHEET 15 FOR -L- GRADE

REVISIONS

1/28/2016 12:07_Pdly_psh_06.dgn