

PROJECT REFERENCE NO.	SHEET NO.
2016CPT.09.22.10341.1 2016CPT.09.23.20341.1	1

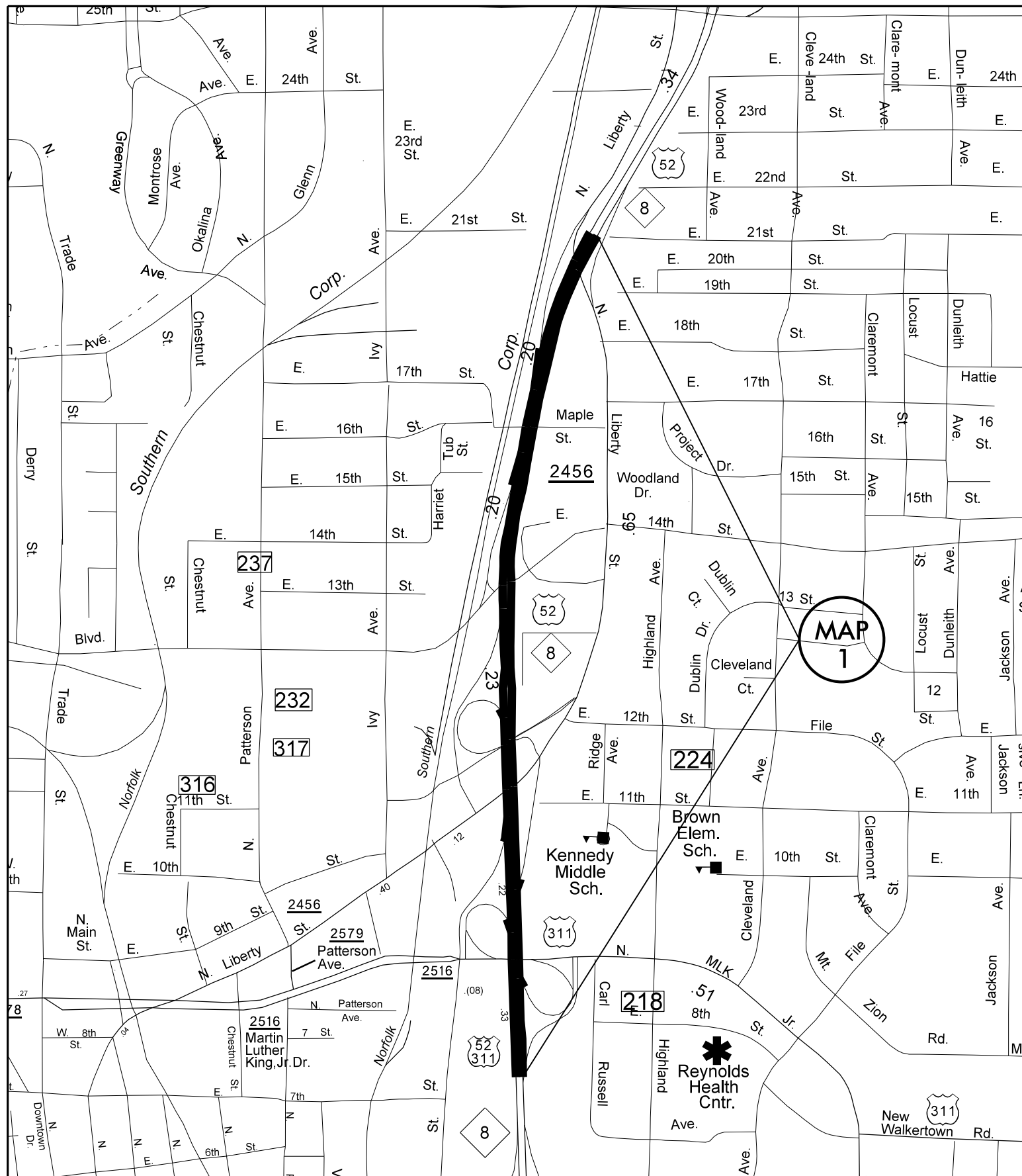

MAP 1
US 52/NC 8 NORTHBOUND
US 52/NC 8 SOUTHBOUND

ALL WORK ON THESE MAPS TO BE
NIGHT TIME ONLY 8 P.M. TO 6 A.M.,
Monday-Sunday.

Mill Black surface only, Approximately 5/8" depth.
DO NOT MILL INTO EXISTING RUMBLE STRIPS,

Pave Back with Ultra-thin Bonded Wearing Course.
Start and stop all paving at concrete pavement joints on ramps.

FORSYTH COUNTY
NORTH CAROLINA