

**This electronic collection of documents is provided
for the convenience of the user
and is Not a Certified Document –**

**The documents contained herein were originally issued
and sealed by the individuals whose names and license
numbers appear on each page, on the dates appearing
with their signature on that page.**

**This file or an individual page
shall not be considered a certified document.**

STATE OF NORTH CAROLINA
DIVISION OF HIGHWAYS

TRANSPORTATION MANAGEMENT PLAN

ROWAN COUNTY

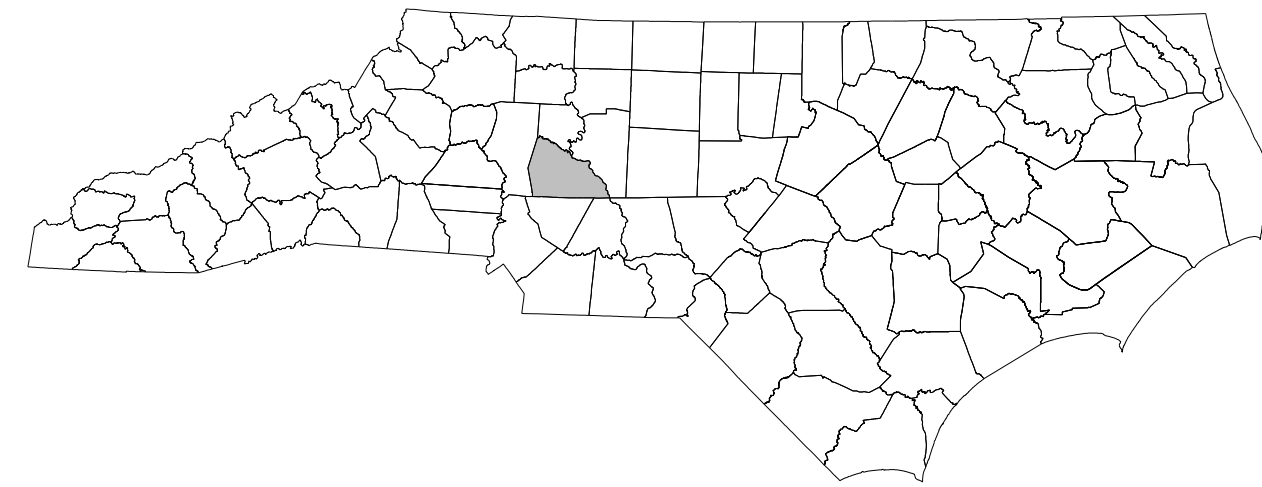

LOCATION: INTERSTATE 85 FROM US 601 (JAKE ALEXANDER BLVD.)
TO 0.5 MILE SOUTH OF US 52 (INNES ST.) IN SALISBURY

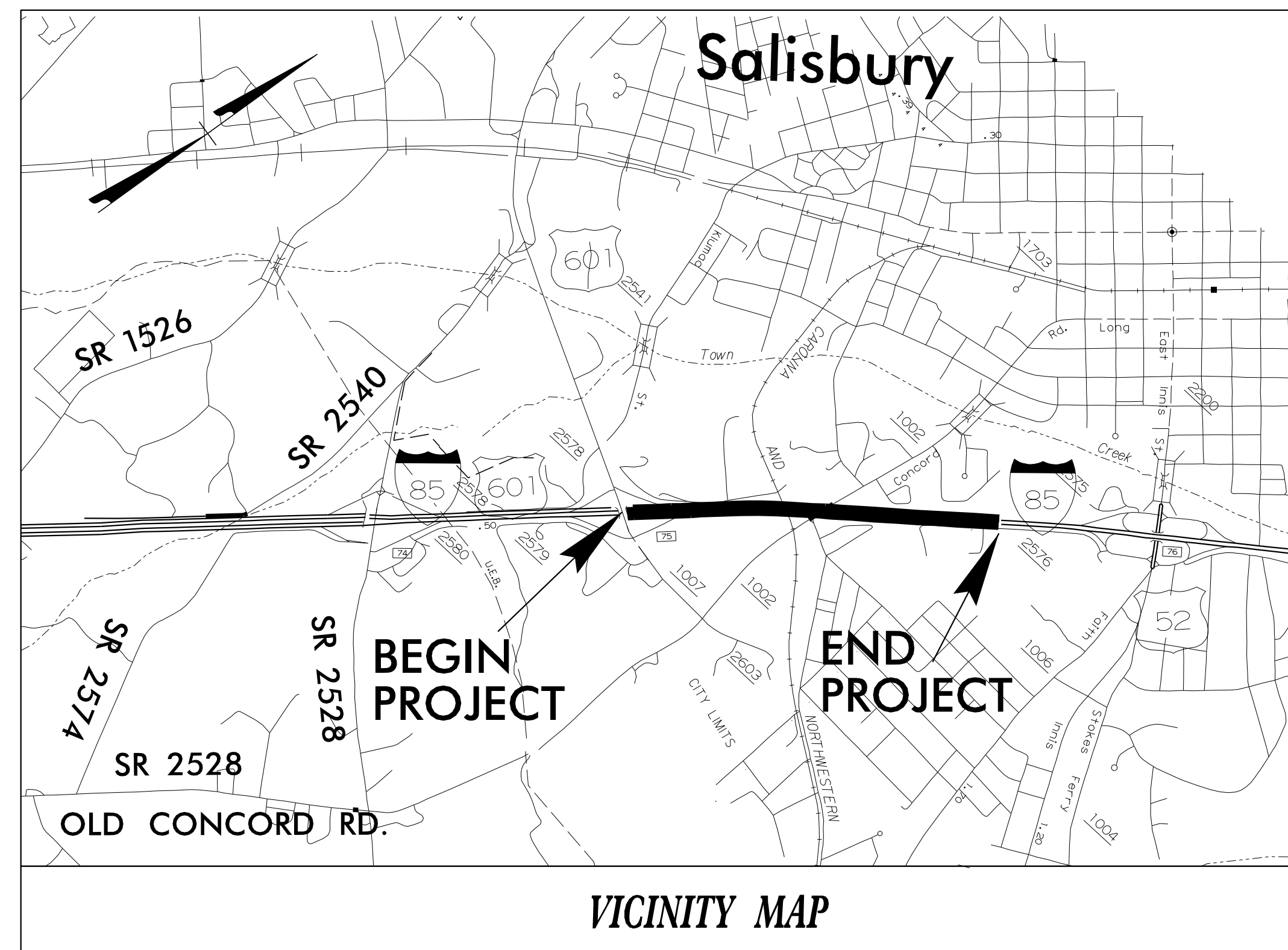

TYPE OF WORK: CONCRETE PAVEMENT REHABILITATION, GRADING, DRAINAGE,
BRIDGE PRESERVATION

INDEX OF SHEETS

SHEET NO.	TITLE
TMP-1	TITLE SHEET, VICINITY MAP, AND INDEX OF SHEETS
TMP-1A	LIST OF APPLICABLE ROADWAY STANDARD DRAWINGS, LEGEND, AND TEMPORARY PAVEMENT MARKING SCHEDULE
TMP-2	TRANSPORTATION OPERATIONS PLAN: (GENERAL AND LOCAL NOTES)
TMP-3	TRANSPORTATION OPERATIONS PLAN: (MANAGEMENT STRATEGIES AND PHASING)
TMP-4	ALTERNATE ROUTE FOR I-85 TRAFFIC
TMP-5	OVERHEAD DMS's
TMP-6 - TMP-8	I-85 SB TRIPLE LANE CLOSURES DETAILS
TMP-9	TEMPORARY LANE CLOSURES, DIVIDED MULTI-LANE ROADWAY WITH 3 LANES CLOSED
TMP-10	OFFSITE DETOUR ROUTE FOR E INNES ST SOUTHBOUND OFF RAMP TRAFFIC

SHEET NO.
TMP-1

I-5741

TIP PROJECT:

12/16/2015
P:\TIP\Projects-N5741\TrafficControl\TCPV-5505_TC_TMP_1.dgn
User:alyudmi

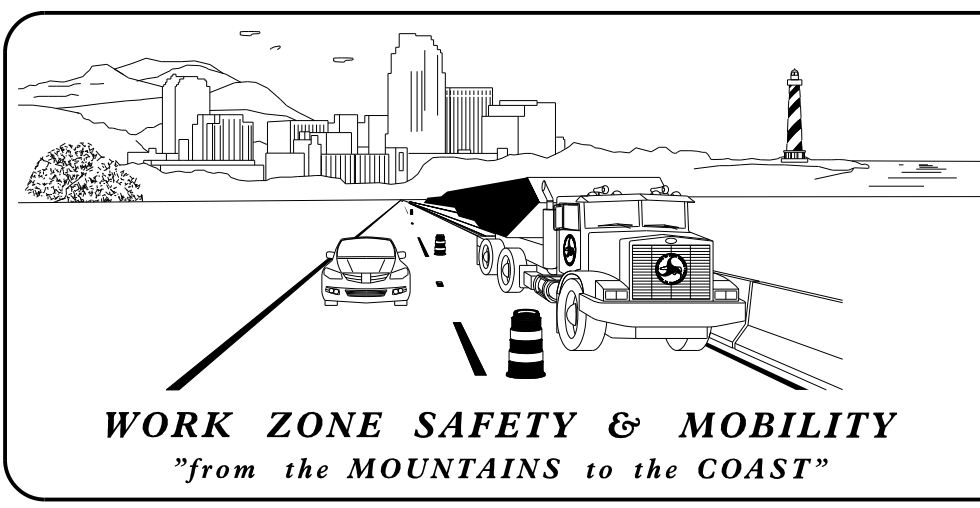

N.C.D.O.T. WORK ZONE TRAFFIC CONTROL
1561 MAIL SERVICE CENTER (MSC) RALEIGH, NC 27699-1561
750 N. GREENFIELD PARKWAY, GARNER, NC 27529 (DELIVERY)
PHONE: (919) 773-2800 FAX: (919) 771-2745

J. S. BOURNE, P.E. — STATE TRAFFIC MANAGEMENT ENGINEER
DAVID BISSETTE, P.E. — TRAFFIC CONTROL PROJECT ENGINEER
HELEN SHYU, P.E. — TRAFFIC CONTROL PROJECT DESIGN ENGINEER
ALLA LYUDMIRSKAYA — TRAFFIC CONTROL DESIGN ENGINEER

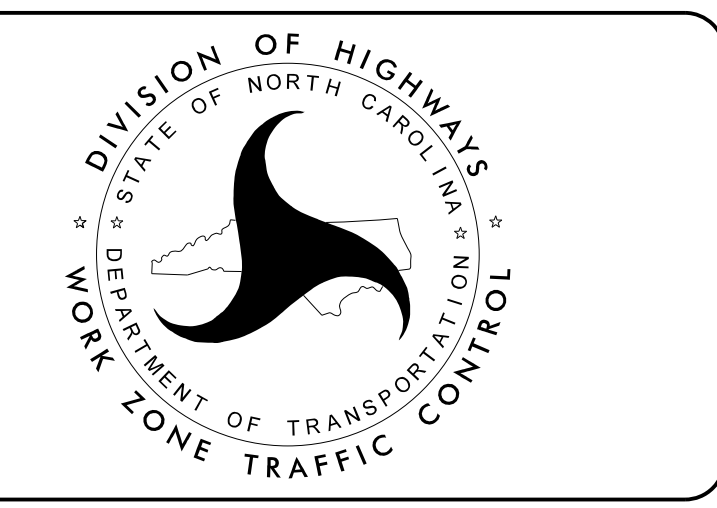

APPROVED: *David Bisette*
ECDC698C875348C

DATE: 12/17/2015

SEAL

ROADWAY STANDARD DRAWINGS

THE FOLLOWING ROADWAY STANDARDS AS SHOWN IN "ROADWAY STANDARD DRAWINGS" - PROJECT SERVICES UNIT - N.C. DEPARTMENT OF TRANSPORTATION - RALEIGH, N.C., DATED JANUARY 2012 ARE APPLICABLE TO THIS PROJECT AND BY REFERENCE HEREBY ARE CONSIDERED A PART OF THESE PLANS:

STD. NO.	TITLE
1101.01	WORK ZONE ADVANCE WARNING SIGNS
1101.02	TEMPORARY LANE CLOSURES
1101.04	TEMPORARY SHOULDER CLOSURES
1101.05	WORK ZONE VEHICLE ACCESSES
1101.11	TRAFFIC CONTROL DESIGN TABLES
1110.01	STATIONARY WORK ZONE SIGNS
1110.02	PORTABLE WORK ZONE SIGNS
1115.01	FLASHING ARROW BOARDS
1130.01	DRUM
1135.01	CONES
1145.01	BARRICADES
1150.01	FLAGGING DEVICES
1160.01	TEMPORARY CRASH CUSHION
1165.01	WORK VEHICLE LIGHTING SYSTEMS AND TMA DELINEATION
1170.01	POSITIVE PROTECTION
1180.01	SKINNY-DRUM
1205.01	PAVEMENT MARKINGS - LINE TYPES AND OFFSETS
1205.02	PAVEMENT MARKINGS - TWO-LANE AND MULTI-LANE ROADWAYS
1205.03	PAVEMENT MARKINGS - EXITS AND ENTRANCE RAMPS
1205.04	PAVEMENT MARKINGS - INTERSECTIONS
1205.05	PAVEMENT MARKINGS - TURN LANES
1205.06	PAVEMENT MARKINGS - LANE DROPS
1205.12	PAVEMENT MARKINGS - BRIDGES
1205.13	PAVEMENT MARKINGS - LANE REDUCTIONS
1250.01	RAISED PAVEMENT MARKERS - INSTALLATION SPACING
1251.01	RAISED PAVEMENT MARKERS - PERMANENT AND TEMPORARY
1261.01	GUARDRAIL AND BARRIER DELINEATORS - INSTALLATION SPACING
1261.02	GUARDRAIL AND BARRIER DELINEATORS - TYPES AND MOUNTING
1262.01	GUARDRAIL END DELINEATION

LEGEND

GENERAL

- DIRECTION OF TRAFFIC FLOW
- DIRECTION OF PEDESTRIAN TRAFFIC FLOW
- EXIST. PVMT.
- NORTH ARROW
- PROPOSED PVMT.
- TEMP. SHORING (LOCATION PURPOSES ONLY)
- WORK AREA
- REMOVAL

SIGNALS

- EXISTING
- PROPOSED
- TEMPORARY

PAVEMENT MARKINGS

- EXISTING LINES
- TEMPORARY LINES

TRAFFIC CONTROL DEVICES

- BARRICADE (TYPE III)
- CONE
- DRUM
- SKINNY DRUM
- TUBULAR MARKER
- TEMPORARY CRASH CUSHION
- FLASHING ARROW BOARD
- FLAGGER
- LAW ENFORCEMENT
- TRUCK MOUNTED ATTENUATOR (TMA)
- CHANGEABLE MESSAGE SIGN
- DYNAMIC MESSAGE SIGN

TEMPORARY SIGNING

- PORTABLE SIGN
- STATIONARY SIGN
- STATIONARY OR PORTABLE SIGN

PAVEMENT MARKERS

- CRYSTAL/CRYSTAL
- CRYSTAL/RED
- YELLOW/YELLOW

PAVEMENT MARKING SYMBOLS

- PAVEMENT MARKING SYMBOLS

TEMPORARY PAVEMENT MARKING

SYMBOL	DESCRIPTION
PAVEMENT MARKING LINES:	
P6	PAINT WHITE EDGELINE (6")
P7	PAINT YELLOW EDGELINE (6")
PJ	PAINT 10 FT. WHITE SKIP (6")
PS	PAINT WHITE GORE LINE (12")
PAVEMENT MARKERS:	
MI	CRYSTAL & RED TEMPORARY RAISED (IF REQUIRED)

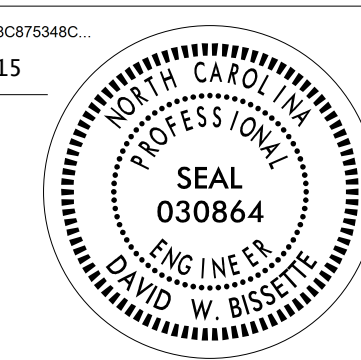
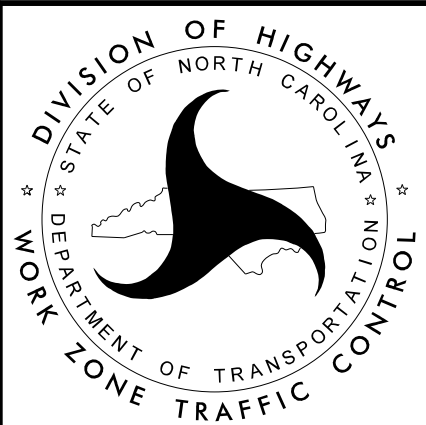
APPROVED: <i>David Bisette</i> <small>ECCDC98C875348C...</small> DATE: 12/17/2015 SEAL			ROADWAY STANDARD DRAWINGS & LEGEND
---	---	---	---

GENERAL NOTES

CHANGES MAY BE REQUIRED WHEN PHYSICAL DIMENSIONS IN THE DETAIL DRAWINGS, STANDARD DETAILS, AND ROADWAY DETAILS ARE NOT ATTAINABLE TO MEET FIELD CONDITIONS OR RESULT IN DUPLICATE OR UNDESIRABLE OVERLAPPING OF DEVICES. MODIFICATION MAY INCLUDE: MOVING, SUPPLEMENTING, COVERING, OR REMOVAL OF DEVICES AS DIRECTED BY THE ENGINEER.

THE FOLLOWING GENERAL NOTES APPLY AT ALL TIMES FOR THE DURATION OF THE CONSTRUCTION PROJECT EXCEPT WHEN OTHERWISE NOTED IN THE PLAN OR DIRECTED BY THE ENGINEER.

TIME RESTRICTIONS

A) DO NOT CLOSE OR NARROW TRAVEL LANES AS FOLLOWS:

ROAD NAME	DAY AND TIME RESTRICTIONS
I-85	MONDAY THROUGH THURSDAY FROM 6:00 A.M. TO 8:00 P.M. AND FRIDAY THROUGH SUNDAY FROM 6:00 A.M. TO 10:00 P.M.

B) DO NOT CLOSE OR NARROW TRAVEL LANES DURING HOLIDAYS AND SPECIAL EVENTS AS FOLLOWS:

ROAD NAME	HOLIDAY
I-85	<ol style="list-style-type: none"> FOR ANY UNEXPECTED OCCURRENCE THAT CREATES UNUSUALLY HIGH TRAFFIC VOLUMES, AS DIRECTED BY THE ENGINEER. FOR NEW YEAR'S, BETWEEN THE HOURS OF 6:00 A.M. DECEMBER 31st TO 8:00 P.M. JANUARY 2ND. IF NEW YEAR'S DAY IS ON A FRIDAY, SATURDAY, SUNDAY, OR MONDAY THEN UNTIL 8:00 P.M. THE FOLLOWING TUESDAY. FOR EASTER, BETWEEN THE HOURS OF 6:00 A.M. THURSDAY AND 8:00 P.M. MONDAY. FOR MEMORIAL DAY, BETWEEN THE HOURS OF 6:00 A.M. FRIDAY TO 8:00 P.M. TUESDAY. FOR LABOR DAY, BETWEEN THE HOURS OF 6:00 A.M. FRIDAY AND 8:00 P.M. TUESDAY. FOR THANKSGIVING DAY, BETWEEN THE HOURS OF 6:00 A.M. TUESDAY TO 8:00 P.M. MONDAY. FOR CHRISTMAS, BETWEEN THE HOURS OF 6:00 A.M. THE FRIDAY BEFORE THE WEEK OF CHRISTMAS DAY AND 8:00 P.M. THE FOLLOWING TUESDAY AFTER THE WEEK OF CHRISTMAS.

C) DO NOT CONDUCT ANY HAULING OPERATIONS AGAINST THE FLOW OF TRAFFIC OF AN OPEN TRAVELWAY UNLESS THE HAULING OPERATION IS PROTECTED BY BARRIER OR GUARDRAIL OR AS DIRECTED BY THE ENGINEER.

LANE AND SHOULDER CLOSURE REQUIREMENTS

- D) REMOVE LANE CLOSURE DEVICES FROM THE LANE WHEN WORK IS NOT BEING PERFORMED BEHIND THE LANE CLOSURE OR WHEN A LANE CLOSURE IS NO LONGER NEEDED OR AS DIRECTED BY THE ENGINEER.
- E) WHEN PERSONNEL AND/OR EQUIPMENT ARE WORKING WITHIN 15 FT OF AN OPEN TRAVEL LANE, CLOSE THE NEAREST OPEN SHOULDER USING ROADWAY STANDARD DRAWING NO. 1101.04 UNLESS THE WORK AREA IS PROTECTED BY BARRIER OR GUARDRAIL OR A LANE CLOSURE IS INSTALLED.
- F) WHEN PERSONNEL AND/OR EQUIPMENT ARE WORKING ON THE SHOULDER ADJACENT TO AN UNDIVIDED FACILITY AND WITHIN 5 FT OF AN OPEN TRAVEL LANE, CLOSE THE NEAREST OPEN TRAVEL LANE USING ROADWAY STANDARD DRAWING NO. 1101.02 UNLESS THE WORK AREA IS PROTECTED BY BARRIER OR GUARDRAIL.

WHEN PERSONNEL AND/OR EQUIPMENT ARE WORKING ON THE SHOULDER ADJACENT TO A DIVIDED FACILITY AND WITHIN 10 FT OF AN OPEN TRAVEL LANE, CLOSE THE NEAREST OPEN TRAVEL LANE USING ROADWAY STANDARD DRAWING NO. 1101.02 UNLESS THE WORK AREA IS PROTECTED BY BARRIER OR GUARDRAIL.

- G) WHEN PERSONNEL AND/OR EQUIPMENT ARE WORKING WITHIN A LANE OF TRAVEL OF AN UNDIVIDED OR DIVIDED FACILITY, CLOSE THE LANE ACCORDING TO THE TRAFFIC CONTROL PLANS, ROADWAY STANDARD DRAWINGS, OR AS DIRECTED BY THE ENGINEER. CONDUCT THE WORK SO THAT ALL PERSONNEL AND/OR EQUIPMENT REMAIN WITHIN THE CLOSED TRAVEL LANE.
- H) DO NOT WORK SIMULTANEOUSLY WITHIN 15 FT ON BOTH SIDES OF AN OPEN TRAVELWAY, RAMP, OR LOOP WITHIN THE SAME LOCATION UNLESS PROTECTED WITH GUARDRAIL OR BARRIER.
- I) DO NOT INSTALL MORE THAN 2.0 MILES OF LANE CLOSURE ON MEASURED FROM THE BEGINNING OF THE MERGE TAPER TO THE END OF THE LANE CLOSURE.
- J) DO NOT INSTALL MORE THAN ONE LANE CLOSURE IN ANY ONE DIRECTION ON I-85.

PAVEMENT EDGE DROP OFF REQUIREMENTS

- K) BACKFILL AT A 6:1 SLOPE UP TO THE EDGE AND ELEVATION OF EXISTING PAVEMENT IN AREAS ADJACENT TO AN OPENED TRAVEL LANE THAT HAS AN EDGE OF PAVEMENT DROP-OFF AS FOLLOWS:
- BACKFILL DROP-OFFS THAT EXCEED 2 INCHES ON ROADWAYS WITH POSTED SPEED LIMITS OF 45 MPH OR GREATER.
- BACKFILL DROP-OFFS THAT EXCEED 3 INCHES ON ROADWAYS WITH POSTED SPEED LIMITS LESS THAN 45 MPH.
- BACKFILL WITH SUITABLE COMPACTED MATERIAL, AS APPROVED BY THE ENGINEER, AT NO EXPENSE TO THE DEPARTMENT.
- L) DO NOT EXCEED A DIFFERENCE OF 2 INCHES IN ELEVATION BETWEEN OPEN LANES OF TRAFFIC FOR NOMINAL LIFTS OF 1.5 INCHES. INSTALL ADVANCE WARNING "UNEVEN LANES" SIGNS (W8-11) 1000 FT. IN ADVANCE AND A MINIMUM OF EVERY HALF MILE THROUGHOUT THE UNEVEN AREA.

SIGNING

- M) INSTALL ADVANCE WORK ZONE WARNING SIGNS WHEN WORK IS WITHIN 40 FT FROM THE EDGE OF TRAVEL LANE AND NO MORE THAN THREE (3) DAYS PRIOR TO THE BEGINNING OF CONSTRUCTION.
- N) ENSURE ALL NECESSARY SIGNING IS IN PLACE PRIOR TO ALTERING ANY TRAFFIC PATTERN.
- O) PROVIDE SIGNING AND DEVICES REQUIRED TO CLOSE THE ROAD ACCORDING TO THE ROADWAY STANDARD DRAWINGS AND TRAFFIC CONTROL PLANS.
- PROVIDE SIGNING REQUIRED FOR THE OFF-SITE DETOUR ROUTE AS SHOWN IN THE TRAFFIC CONTROL PLANS.
- P) COVER OR REMOVE ALL SIGNS AND DEVICES REQUIRED TO CLOSE THE ROAD WHEN ROAD CLOSURE IS NOT IN OPERATION.
- COVER OR REMOVE ALL SIGNS REQUIRED FOR THE OFF-SITE DETOUR WHEN THE DETOUR IS NOT IN OPERATION

TRAFFIC BARRIER

- Q) INSTALL TEMPORARY BARRIER ACCORDING TO THE TRANSPORTATION MANAGEMENT PLANS A MAXIMUM OF TWO (2) WEEKS PRIOR TO BEGINNING WORK IN ANY LOCATION. ONCE TEMPORARY BARRIER IS INSTALLED AT ANY LOCATION PROCEED IN A CONTINUOUS MANNER TO COMPLETE THE PROPOSED WORK IN THAT LOCATION UNLESS OTHERWISE STATED IN THE TRANSPORTATION MANAGEMENT PLANS OR AS DIRECTED BY THE ENGINEER.
- DO NOT PLACE BARRIER DIRECTLY ON ANY SURFACE OTHER THAN ASPHALT OR CONCRETE.
- ONCE TEMPORARY BARRIER IS INSTALLED AT ANY LOCATION AND NO WORK IS PERFORMED BEHIND THE TEMPORARY BARRIER FOR A PERIOD LONGER THAN TWO (2) MONTHS, REMOVE / RESET TEMPORARY BARRIER AT NO COST TO THE DEPARTMENT UNLESS OTHERWISE STATED IN THE TRANSPORTATION MANAGEMENT PLANS, TEMPORARY BARRIER IS PROTECTING A HAZARD, OR AS DIRECTED BY THE ENGINEER.

INSTALL TEMPORARY BARRIER WITH THE TRAFFIC FLOW BEGINNING WITH THE UPSTREAM SIDE OF TRAFFIC. REMOVE TEMPORARY BARRIER AGAINST THE TRAFFIC FLOW BEGINNING WITH THE DOWNSTREAM SIDE OF TRAFFIC.

INSTALL AND SPACE DRUMS NO GREATER THAN TWICE THE POSTED SPEED LIMIT (MPH) TO CLOSE OR KEEP THE SECTION OF THE ROADWAY CLOSED UNTIL THE TEMPORARY BARRIER CAN BE PLACED OR AFTER THE TEMPORARY BARRIER IS REMOVED.

- R) PROTECT THE APPROACH END OF MOVABLE/PORTABLE CONCRETE BARRIER AT ALL TIMES DURING THE INSTALLATION AND REMOVAL OF THE BARRIER BY EITHER A TRUCK MOUNTED ATTENUATOR (MAXIMUM 72 HOURS) OR A TEMPORARY CRASH CUSHION.

PROTECT THE APPROACH END OF MOVABLE/PORTABLE CONCRETE BARRIER FROM ONCOMING TRAFFIC AT ALL TIMES BY A TEMPORARY CRASH CUSHION UNLESS THE APPROACH END OF MOVABLE/PORTABLE CONCRETE BARRIER IS OFFSET FROM ONCOMING TRAFFIC AS FOLLOWS OR AS SHOWN IN THE PLANS: (SEE ALSO 1101.11, SHEET 3 OF 4)

POSTED SPEED LIMIT	MINIMUM OFFSET
40 OR LESS	15 FT
45 - 50	20 FT
55	25 FT
60 MPH or HIGHER	30 FT

TRAFFIC CONTROL DEVICES

- S) WHEN LANE CLOSURES ARE NOT IN EFFECT SPACE CHANNELIZING DEVICES IN WORK AREAS NO GREATER IN FEET THAN TWICE THE POSTED SPEED LIMIT (MPH) EXCEPT, 10 FT ON-CENTER IN RADIUS, AND 3 FT OFF THE EDGE OF AN OPEN TRAVELWAY. REFER TO STANDARD SPECIFICATIONS FOR ROADS AND STRUCTURES SECTIONS 1130 (DRUMS), 1135 (CONES) AND 1180 (SKINNY DRUMS) FOR ADDITIONAL REQUIREMENTS.
- T) PLACE ADDITIONAL SETS OF THREE CHANNELIZING DEVICES DRUMS PERPENDICULAR TO THE EDGE OF TRAVELWAY ON 500 FT CENTERS WHEN UNOPENED LANES ARE CLOSED TO TRAFFIC.

PAVEMENT MARKINGS AND MARKERS

- U) INSTALL TEMPORARY PAVEMENT MARKINGS AND TEMPORARY PAVEMENT MARKERS AS FOLLOWS:
- | ROAD NAME | MARKING | MARKER |
|-----------|---------|------------------|
| I-85 | PAINT | TEMPORARY RAISED |
- V) PLACE ONE APPLICATION OF PAINT FOR TEMPORARY TRAFFIC PATTERNS. PLACE A SECOND APPLICATION OF PAINT SIX (6) MONTHS AFTER THE INITIAL APPLICATION AND EVERY SIX MONTHS AS DIRECTED BY THE ENGINEER.
- W) TIE PROPOSED PAVEMENT MARKING LINES TO EXISTING PAVEMENT MARKING LINES.
- X) REMOVE/REPLACE ANY CONFLICTING/DAMAGED PAVEMENT MARKINGS AND MARKERS BY THE END OF EACH DAY'S OPERATION.

MISCELLANEOUS

- Y) LAW ENFORCEMENT MAY BE USED TO MAINTAIN TRAFFIC THROUGH THE WORK AREA AND/OR INTERSECTIONS AS DIRECTED BY THE ENGINEER.

LOCAL NOTE

- 1) COORDINATE WITH STATE TRANSPORTATION OPERATIONS CENTER TO UTILIZE EXISTING DMS'S FOR PUBLIC INFORMATION OF POSSIBLE DELAYS ON I-85, AND USING ALTERNATE ROUTE VIA I-40 AND I-77

APPROVED: *David Bisette*
DocuSigned by:
ECC09808C97548C...
 DATE: 2/29/2016

SEAL

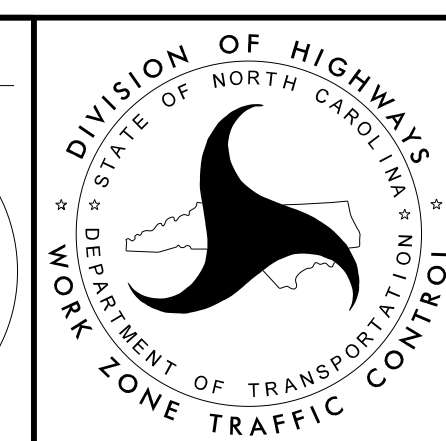

TRANSPORTATION
OPERATIONS PLAN:
GENERAL AND
LOCAL NOTES

MANAGEMENT STRATEGIES

- USING LANE CLOSURES, PERFORM PAVEMENT REHABILITATION, STRUCTURE PRESERVATION AND DRAINAGE WORK ON I-85.
- CONTRACTOR SHALL PERFORM CONCRETE SLAB REPLACEMENT AND PROPOSED ROADWAY WORK ON I-85 SOUTH BOUND BEHIND TEMPORARY PCB FOR A PERIOD NOT TO EXCEED 35 DAYS (SEE SHEET TMP-6). THE E. INNES ST. TO I-85 SOUTH BOUND RAMP WILL BE CLOSED AND TRAFFIC DETOURED OFF SITE FOR PAVEMENT REPAIR AND DRAINAGE WORK (SEE SHEETS TMP-4, TMP-5, TMP-8 AND TMP-10).
- CONTRACTOR SHALL COORDINATE WITH STATEWIDE TRANSPORTATION OPERATIONS CENTER REGARDING PUBLIC INFORMATION OF UTILIZING AN ALTERNATE ROUTE FOR I-85 TRAFFIC VIA I-40 AND I-77 WHILE PROJECT IS COMPLETED (SEE SHEET TMP-4).

PHASING

- NOTE: PROTECT ANY EXCAVATION LEFT OVER NIGHT WITH PORTABLE BARRIER, STEEL PLATES, OR A TMA.
- NOTE: PROTECT ANY BREAK IN THE GUARDRAIL LEFT OVER NIGHT WITH PORTABLE BARRIER OR A TMA.
- STEP 1: USING RSD 1101.01, SHEET 1 OF 3, INSTALL WORK ZONE ADVANCE WARNING SIGNS.
- STEP 2: USING RSD 1101.02, SHEETS 4 AND 8 OF 15 AND SHEET TMP-9 AS NEEDED BEGIN PROPOSED ROADWAY AND STRUCTURE WORK.

COMPLETE THE WORK REQUIRED OF STEPS 3 AND 4 IN THIRTY-FIVE (35) CONSECUTIVE CALENDAR DAYS. (SEE INTERMEDIATE CONTRACT TIME AND LIQUIDATED DAMAGES)

- STEP 3: USING RSD 1101.03, SHEET 2 OF 9, SHEETS TMP-4, TMP- 5, TMP-8, AND TMP-10,CLOSE THE E. INNES ST. TO I-85 SOUTH BOUND RAMP AND DETOUR TRAFFIC TO THE S. JAKE ALEXANDER BLVD. TO I-85 SOUTH BOUND RAMP.
- USING RSD 1101.02 AND SHEETS TMP-6 THROUGH TMP-9, CLOSE THE THREE OUTSIDE LANES OF I-85 SOUTH BOUND, INSTALL TEMPORARY PCB FROM -L- STA. 499+20+/- TO -L- STA. 503+66+/-, AND INSTALL TEMPORARY PAVEMENT MARKINGS AS SHOWN.
- MAINTAIN THE I-85 SOUTH BOUND TRAFFIC IN A TEMPORARY PATTERN ON THE TWO INSIDE LANES AND WORKING BEHIND TEMPORARY PCB, PERFORM CONCRETE SLAB REPLACEMENT, AND PROPOSED ROADWAY WORK. PLACE TEMPORARY PAVEMENT MARKINGS.
- STEP 4: REMOVE TEMPORARY PCB, INSTALLED IN STEP 3, AND OPEN LANE 3 ON I-85 SOUTH BOUND.
- REMOVE OFFSITE DETOUR SIGNS AND DEVICES AND REOPEN E. INNES ST. TO I-85 SOUTH BOUND RAMP.
- STEP 5: USING RSD 1101.02, SHEETS 4 AND 8 OF 15 AND SHEET TMP-9 AS NEEDED COMPLETE THE PROPOSED ROADWAY AND STRUCTURE WORK.
- STEP 6: INSTALL FINAL PAVEMENT MARKINGS AND MARKERS.
- STEP 7: REMOVE ALL TEMPORARY TRAFFIC CONTROL DEVICES.

2/29/2016 P:\TIP\Projects-15741\TrafficControl\Turn-In_Docs\Revised_022516\1-5505_1C_TMP_3rev_022916.dgn User:slvudml

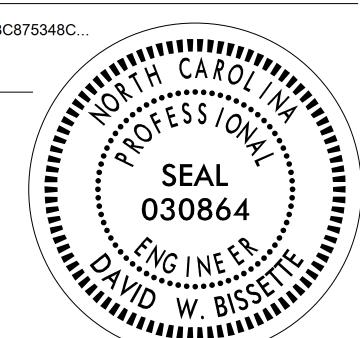
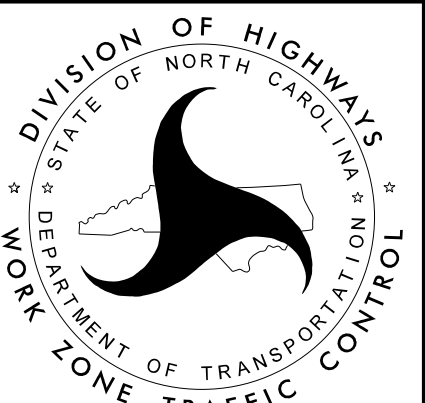
APPROVED: <i>David Bisette</i> <small>ECDC068C875348C...</small> DATE: 2/29/2016			TRANSPORTATION OPERATION PLAN: MANAGEMENT STRATEGIES AND PHASING
--	---	---	---

ROWAN COUNTY

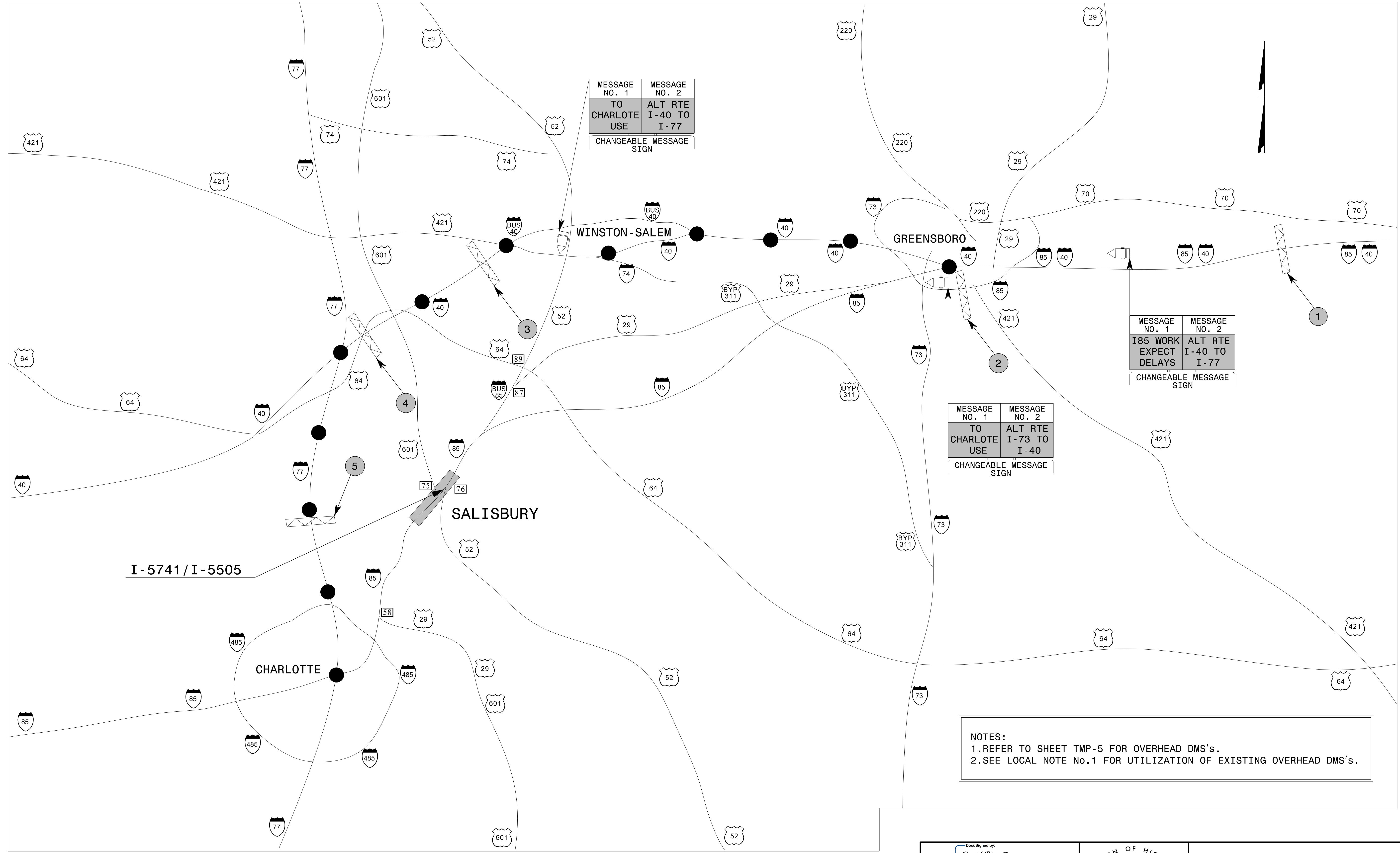

MESSAGE NO. 1	MESSAGE NO. 2
TO CHARLOTTE USE	ALT RTE I-40 TO I-77
CHANGEABLE MESSAGE SIGN	

MESSAGE NO. 1	MESSAGE NO. 2
I85 WORK EXPECT DELAYS	ALT RTE I-40 TO I-77
CHANGEABLE MESSAGE SIGN	

MESSAGE NO. 1	MESSAGE NO. 2
TO CHARLOTTE USE	ALT RTE I-73 TO I-40
CHANGEABLE MESSAGE SIGN	

I-5741 / I-5505

NOTES:
 1. REFER TO SHEET TMP-5 FOR OVERHEAD DMS'S.
 2. SEE LOCAL NOTE No.1 FOR UTILIZATION OF EXISTING OVERHEAD DMS'S.

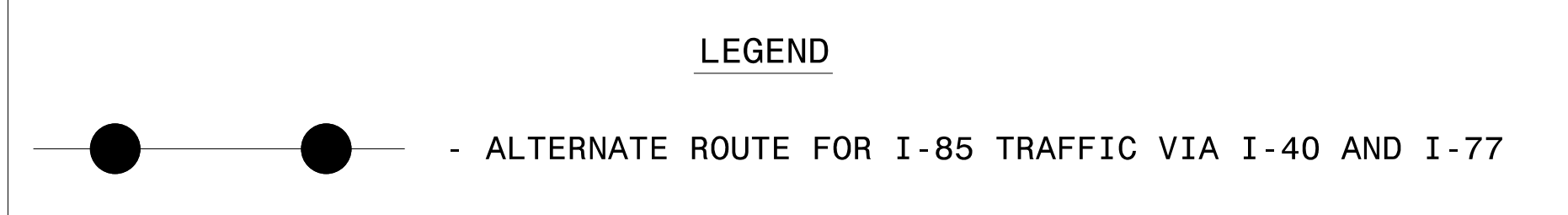

APPROVED: *David Bisette*
 DATE: 12/17/2015



ALTERNATE ROUTE FOR I-85 TRAFFIC

12/16/2015 P:\Projects\I-5741\TrafficControl\TCPV-5505_TC_TMP_4.dgn User:slvudm1

DMS D7-02 I-40/I-85 SB MM 137

1

I-85 ROAD WORK MAJOR DELAYS USE ALT ROUTE	I-85 ALT ROUTE I-40 W TO I-77 S TO REACCESS I-85
PANEL 1	PANEL 2

DMS D7-19 I-85 SB MM 124

2

I-85 ROAD WORK MAJOR DELAYS USE ALT ROUTE	EXIT 121 I-73 N TO I-40 W TO I-77 S TO REACCESS I-85
PANEL 1	PANEL 2

DMS D9-19 I-40 WB MM 186

3

I-85 TRAFFIC TAKE EXIT 152 A TO I-77 SOUTH	I-77 SOUTH TO REACCESS I-85
PANEL 1	PANEL 2

DMS D12 I-40 WB MM 154

4



I-85 TRAFFIC TAKE EXIT 152 A TO I-77 SOUTH	I-77 SOUTH TO REACCESS I-85
PANEL 1	PANEL 2

DMS D12 I-77 SB MM 34.5

5

I-85 TRAFFIC CONTINUE STRAIGHT TO EXIT 13	EXIT 13 A-B TO REACCESS I-85
PANEL 1	PANEL 2

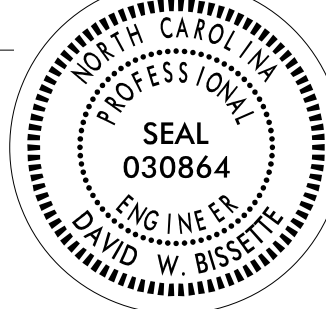
NOTE:
REFER TO SHEET TMP-4 FOR LOCATION OF OVERHEAD DMS's.

APPROVED: <i>David Bisette</i> <small>ECDC0808178348C</small> DATE: 12/17/2015			OVERHEAD DMS's
--	---	---	-----------------------

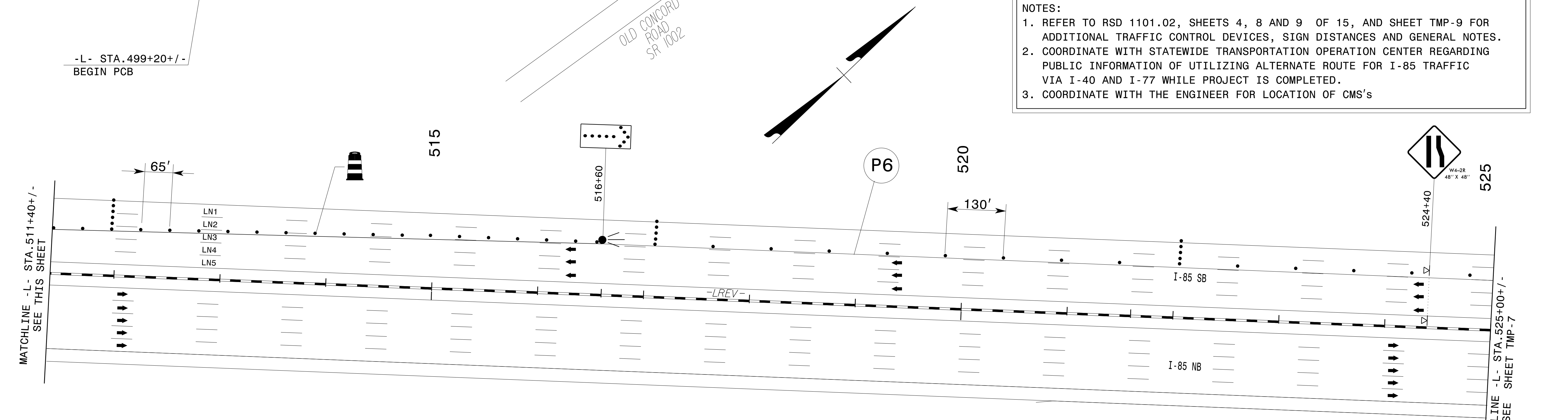
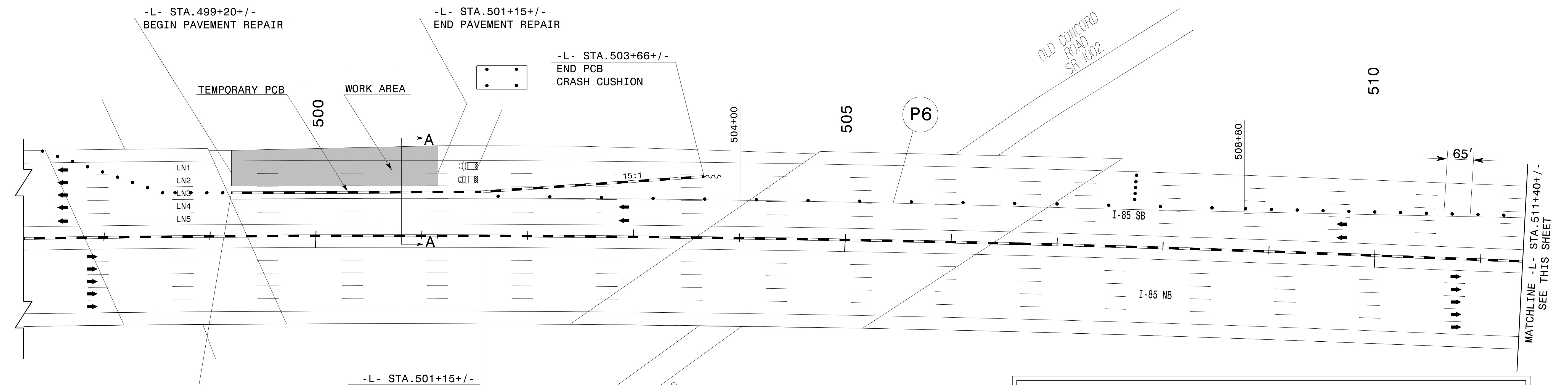

NOTES:

1. REFER TO RSD 1101.02, SHEETS 4, 8 AND 9 OF 15, AND SHEET TMP-9 FOR ADDITIONAL TRAFFIC CONTROL DEVICES, SIGN DISTANCES AND GENERAL NOTES.
2. COORDINATE WITH STATEWIDE TRANSPORTATION OPERATION CENTER REGARDING PUBLIC INFORMATION OF UTILIZING ALTERNATE ROUTE FOR I-85 TRAFFIC VIA I-40 AND I-77 WHILE PROJECT IS COMPLETED.
3. COORDINATE WITH THE ENGINEER FOR LOCATION OF CMS'S

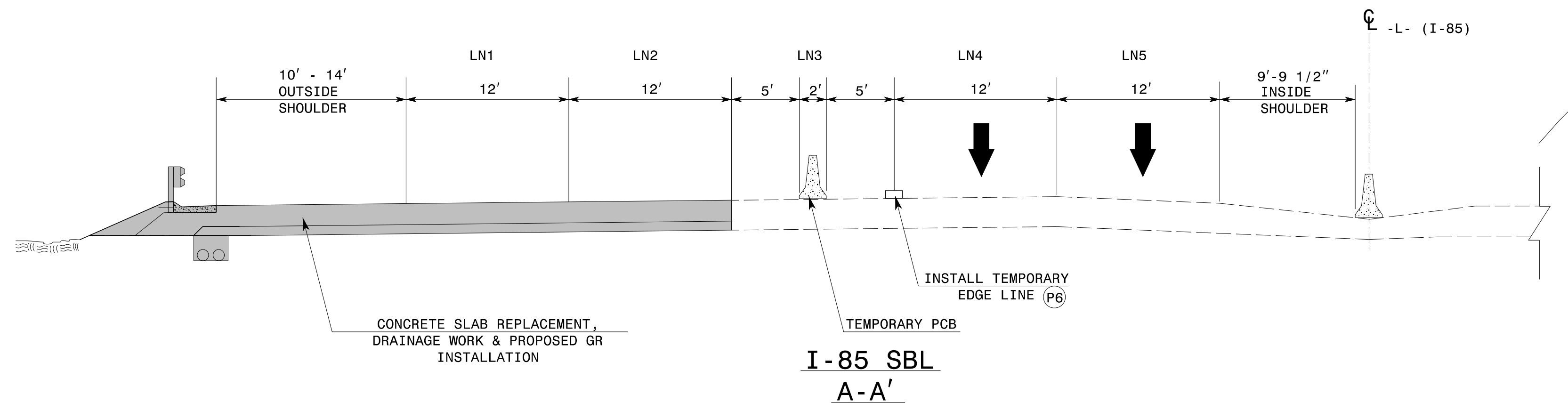

APPROVED: *David Bisette*
 ECDC080817545C
 DATE: 12/17/2015

PROFESSIONAL SEAL
 030864
 ENGINEER
 DAVID W. BISSETTE



**I-85 SB
TRIPLE LANE CLOSURES
DETAIL 1**

12/16/2015
 P:\Projects\I-85\TrafficControl\TC\I-85\5505_TC_TMP_6.dgn
 User:slvudm1

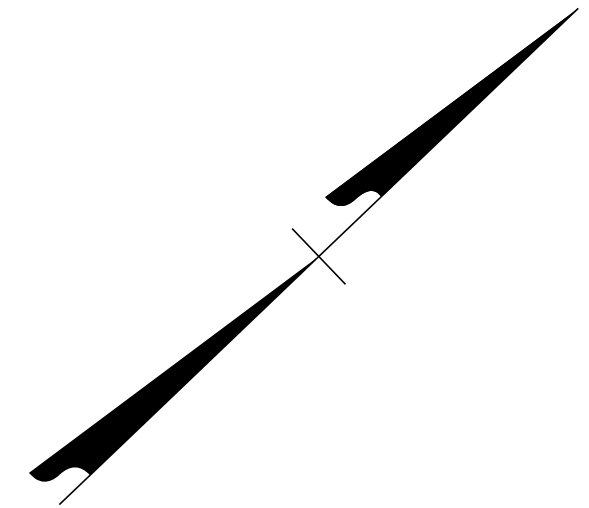
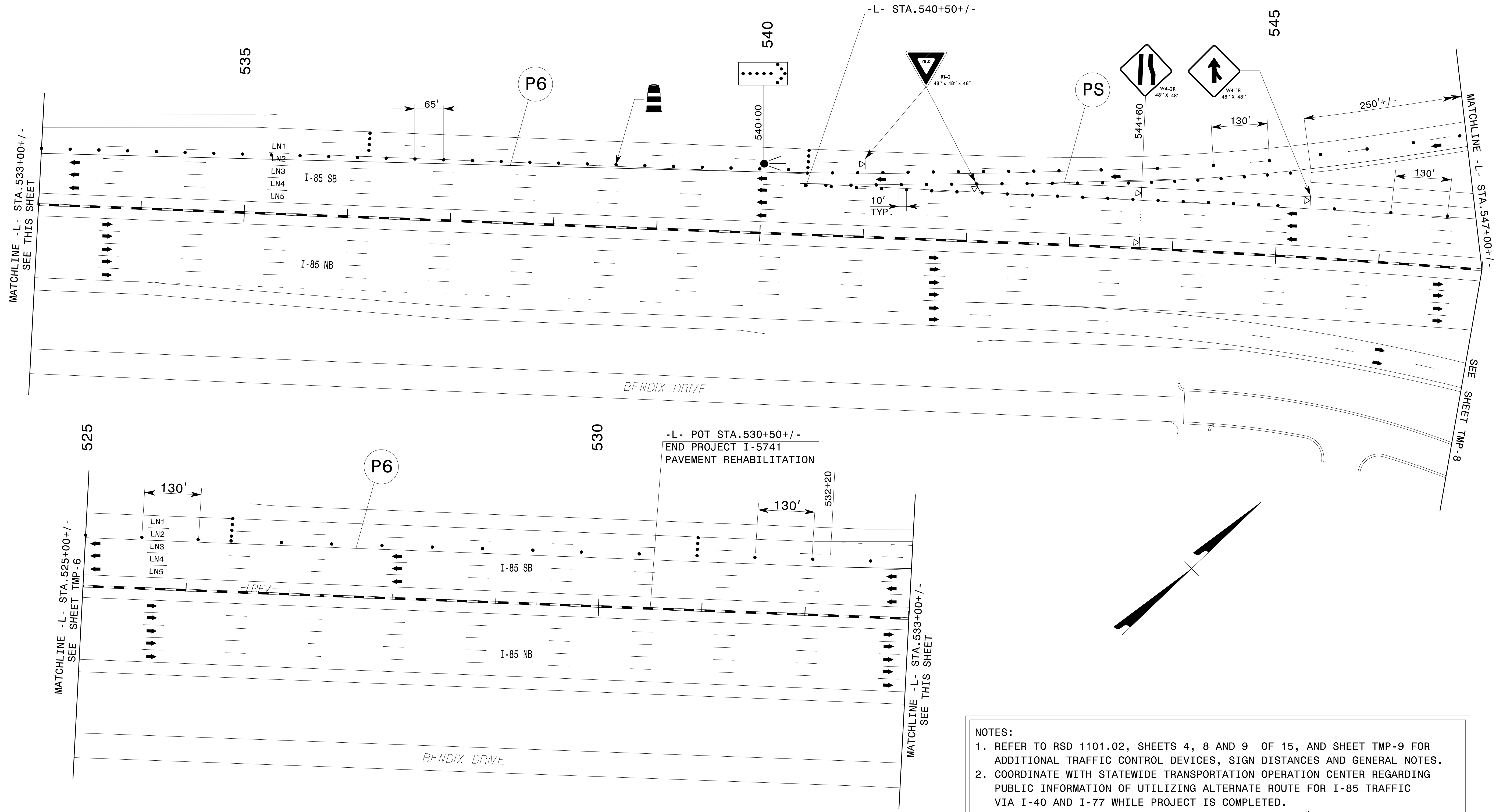

- NOTES:
1. REFER TO RSD 1101.02, SHEETS 4, 8 AND 9 OF 15, AND SHEET TMP-9 FOR ADDITIONAL TRAFFIC CONTROL DEVICES, SIGN DISTANCES AND GENERAL NOTES.
 2. COORDINATE WITH STATEWIDE TRANSPORTATION OPERATION CENTER REGARDING PUBLIC INFORMATION OF UTILIZING ALTERNATE ROUTE FOR I-85 TRAFFIC VIA I-40 AND I-77 WHILE PROJECT IS COMPLETED.
 3. COORDINATE WITH THE ENGINEER FOR LOCATION OF CMS's

12/16/2015
P:\TIP\Projects\N5741\TrafficControl\TCP\N5505_TC_TMP_7.dgn
User:slvudm1

APPROVED: *David Bisette*
ECDC080817548C.
DATE: 12/17/2015



**I-85 SB
TRIPLE LANE CLOSURES
DETAIL 2**

REFER TO SHEET TMP-10
FOR CMS LOCATION

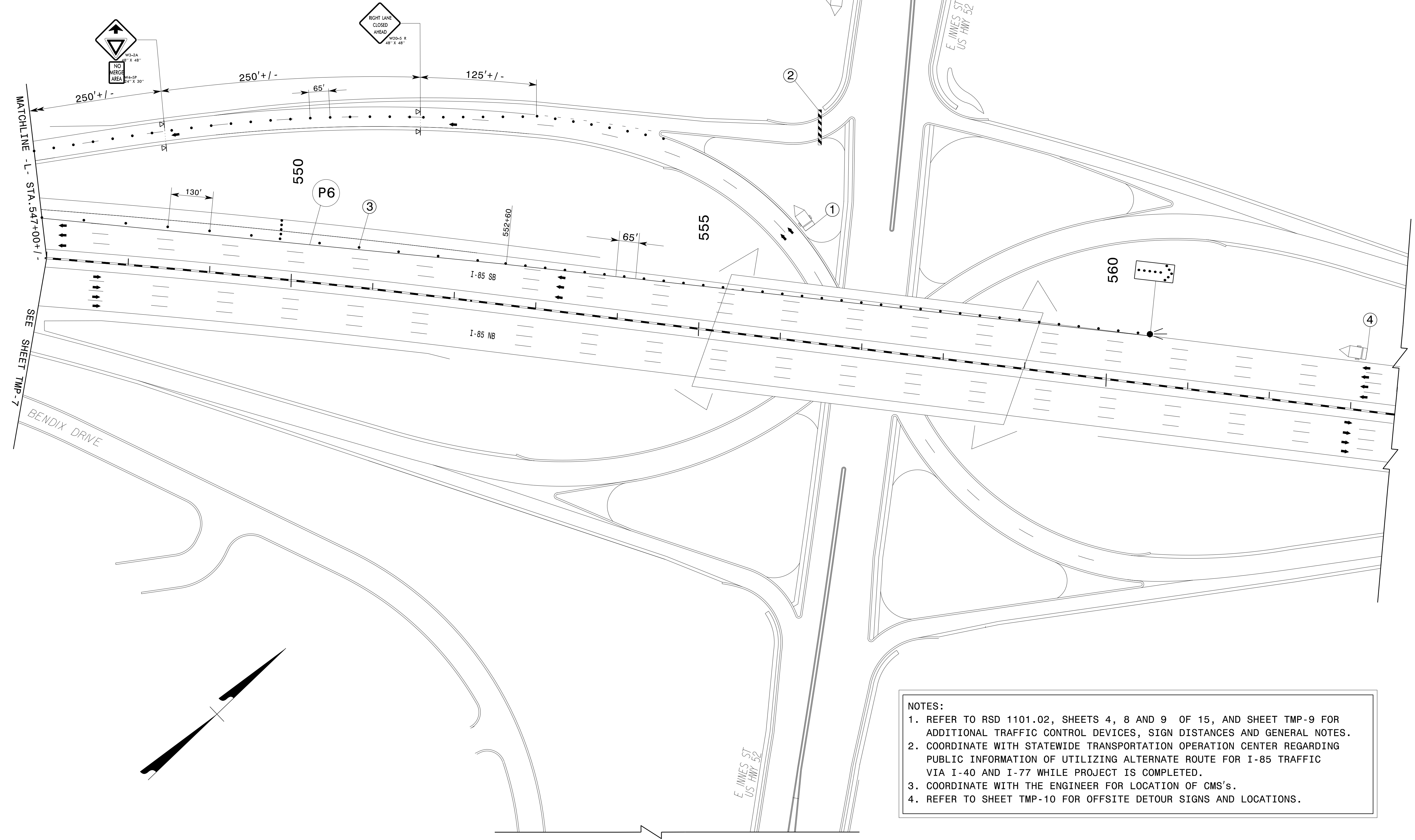

NOTES:

1. REFER TO RSD 1101.02, SHEETS 4, 8 AND 9 OF 15, AND SHEET TMP-9 FOR ADDITIONAL TRAFFIC CONTROL DEVICES, SIGN DISTANCES AND GENERAL NOTES.
2. COORDINATE WITH STATEWIDE TRANSPORTATION OPERATION CENTER REGARDING PUBLIC INFORMATION OF UTILIZING ALTERNATE ROUTE FOR I-85 TRAFFIC VIA I-40 AND I-77 WHILE PROJECT IS COMPLETED.
3. COORDINATE WITH THE ENGINEER FOR LOCATION OF CMS's.
4. REFER TO SHEET TMP-10 FOR OFFSITE DETOUR SIGNS AND LOCATIONS.

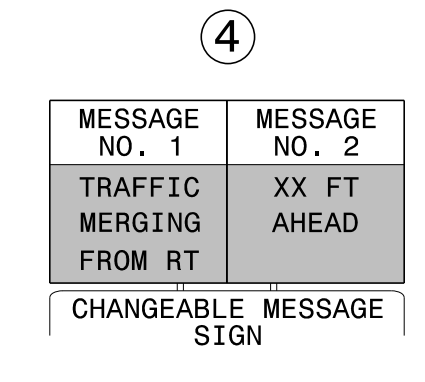
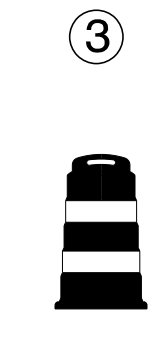
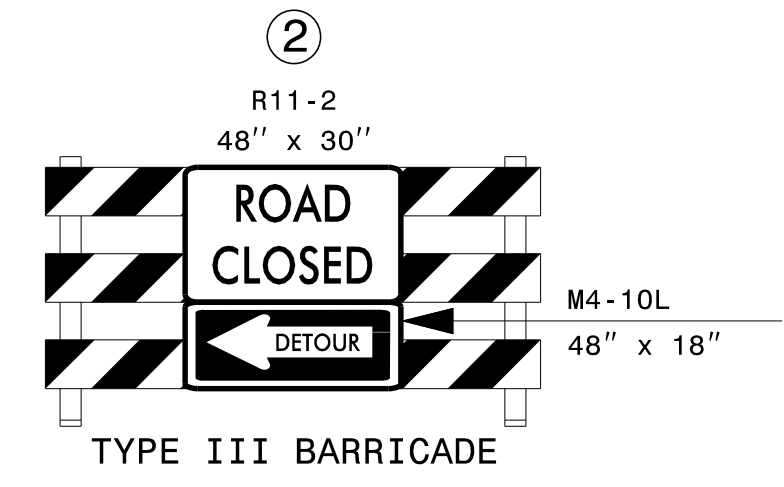
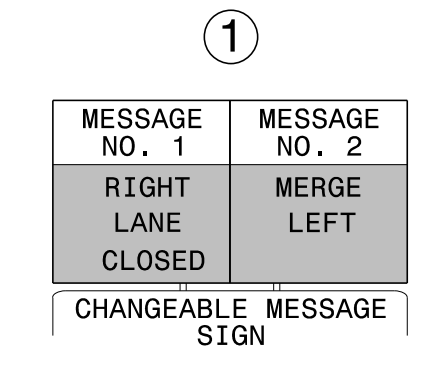

APPROVED: *David Bisette*

DATE: 12/17/2015

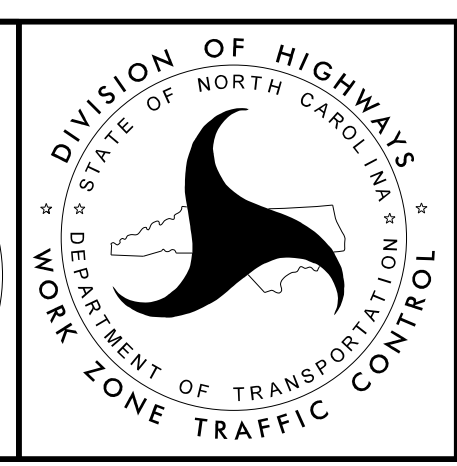

I-85 SB
TRIPLE LANE CLOSURES
DETAIL 3

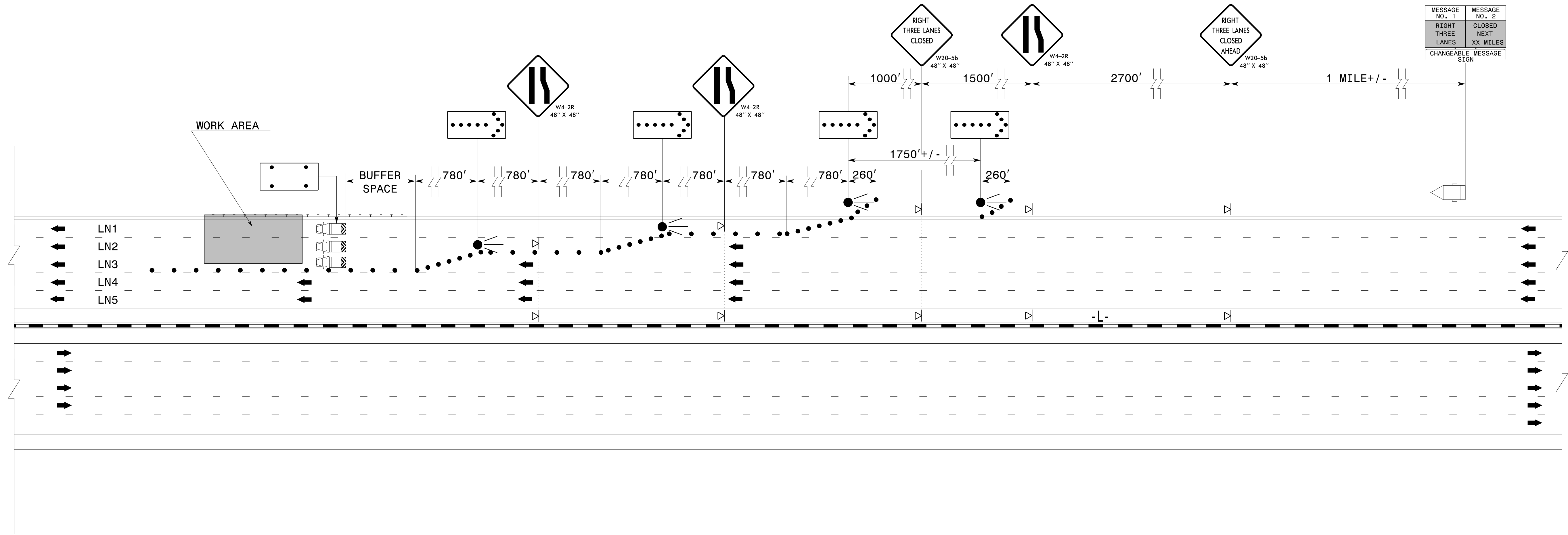

NOTE:
REFER TO RSD 1101.02, SHEET 4 OF 15, FOR GENERAL NOTES

1/7/2016
P:\TIP\Projects-N5741\TrafficControl\TCPV+5505_TC_TMP_9.dgn
User:slvudmi

APPROVED: <i>David Bisette</i> ECDC008C875348C... DATE: 1/7/2016			TEMPORARY LANE CLOSURES DIVIDED MULTI-LANE ROADWAY WITH 3 LANES CLOSED (FOR ROADWAYS 65 MPH)
--	--	--	---

ROWAN COUNTY

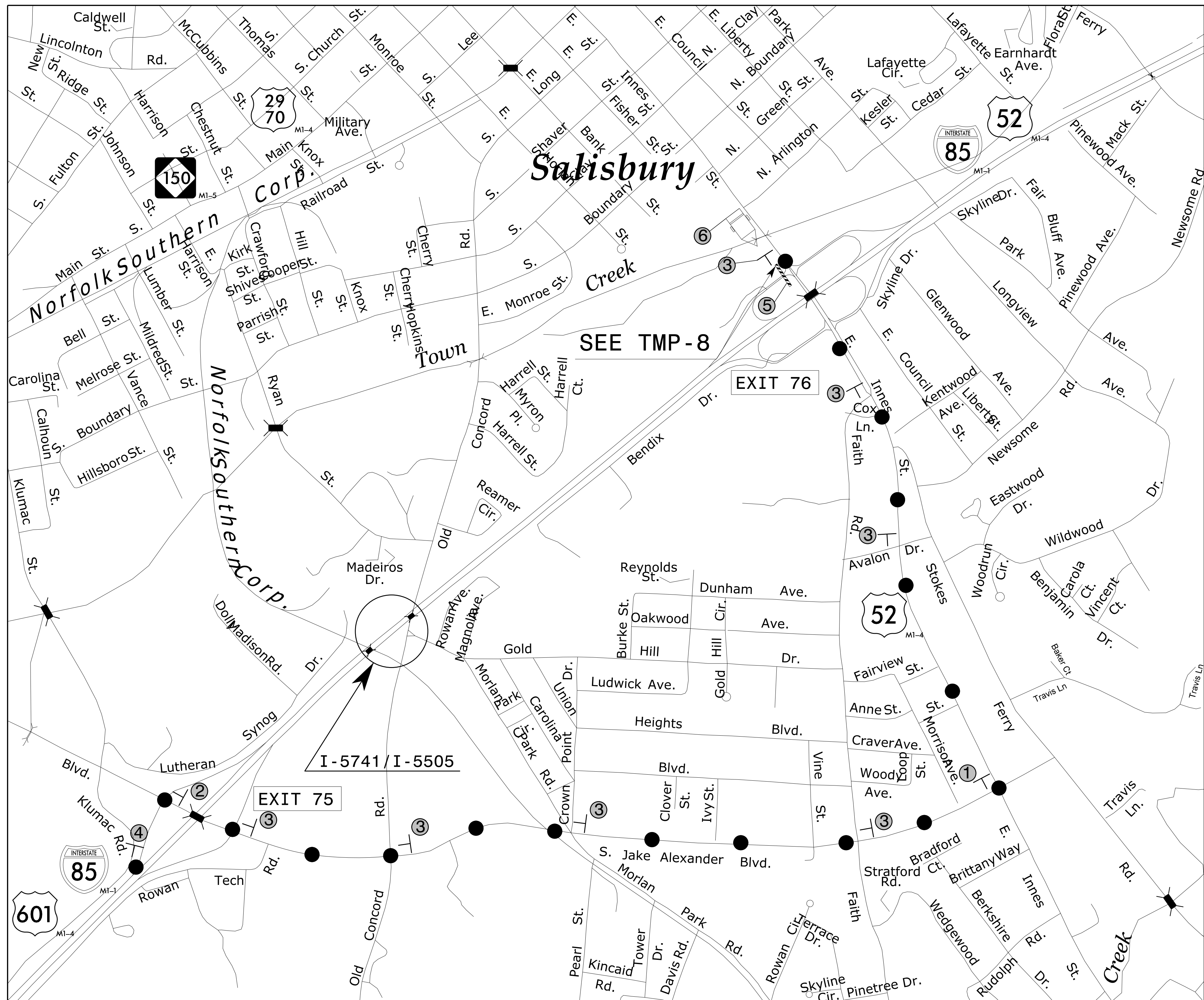

<p>①</p> <table border="1" style="margin: 0 auto;"> <tr><td style="padding: 2px;">DETOUR</td></tr> <tr><td style="padding: 2px;">TO</td></tr> <tr><td style="padding: 2px;">SOUTH</td></tr> </table> <p>M4-8 24" X 12"</p> <p>M4-5 24" X 12"</p> <p>M3-3 24" X 12"</p> <p>INTERSTATE 85 M1-1</p> <p>→ M6-1 21" X 15"</p>	DETOUR	TO	SOUTH	<p>②</p> <table border="1" style="margin: 0 auto;"> <tr><td style="padding: 2px;">DETOUR</td></tr> <tr><td style="padding: 2px;">TO</td></tr> <tr><td style="padding: 2px;">SOUTH</td></tr> </table> <p>M4-8 24" X 12"</p> <p>M4-5 24" X 12"</p> <p>M3-3 24" X 12"</p> <p>INTERSTATE 85 M1-1</p> <p>← M6-1 L 21" X 15"</p>	DETOUR	TO	SOUTH	<p>③</p> <table border="1" style="margin: 0 auto;"> <tr><td style="padding: 2px;">DETOUR</td></tr> <tr><td style="padding: 2px;">TO</td></tr> <tr><td style="padding: 2px;">SOUTH</td></tr> </table> <p>M4-8 24" X 12"</p> <p>M4-5 24" X 12"</p> <p>M3-3 24" X 12"</p> <p>INTERSTATE 85 M1-1</p> <p>↑ M6-3 21" X 15"</p>	DETOUR	TO	SOUTH
DETOUR											
TO											
SOUTH											
DETOUR											
TO											
SOUTH											
DETOUR											
TO											
SOUTH											
<p>④</p> <table border="1" style="margin: 0 auto;"> <tr><td style="padding: 2px;">END DETOUR</td></tr> <tr><td style="padding: 2px;">SOUTH</td></tr> </table> <p>M4-8 A 24" X 18"</p> <p>M3-3 24" X 12"</p> <p>INTERSTATE 85 M1-1</p>	END DETOUR	SOUTH	<p>⑤</p> <p>R11-2 48" X 30"</p> <table border="1" style="margin: 0 auto;"> <tr><td style="text-align: center;">ROAD CLOSED</td></tr> <tr><td style="text-align: center;">← DETOUR →</td></tr> </table> <p>M4-10L 48" X 18"</p> <p style="font-size: 8px;">TYPE III BARRICADE</p>	ROAD CLOSED	← DETOUR →						
END DETOUR											
SOUTH											
ROAD CLOSED											
← DETOUR →											
<p>⑥</p> <table border="1" style="margin: 0 auto;"> <tr> <td style="font-size: 8px;">MESSAGE NO. 1</td> <td style="font-size: 8px;">MESSAGE NO. 2</td> </tr> <tr> <td style="font-size: 8px;">I-85 SB RAMP CLOSED</td> <td style="font-size: 8px;">FOLLOW DETOUR SIGNS</td> </tr> </table> <p style="font-size: 8px;">CHANGEABLE MESSAGE SIGN</p>			MESSAGE NO. 1	MESSAGE NO. 2	I-85 SB RAMP CLOSED	FOLLOW DETOUR SIGNS					
MESSAGE NO. 1	MESSAGE NO. 2										
I-85 SB RAMP CLOSED	FOLLOW DETOUR SIGNS										

NOTES:

1. REFER TO RSD 1101.03 FOR ADDITIONAL WARNING SIGNS.
2. COORDINATE WITH THE ENGINEER FOR LOCATION OF CMS.



12/16/2015
P:\Projects\I-5741\TrafficControl\TCPV-5505_TC_TMP_10.dgn
User: slyudmi

<p style="font-size: 8px;">APPROVED: <i>David Bisette</i></p> <p style="font-size: 8px;">DATE: 12/17/2015</p>			<p style="text-align: center; font-weight: bold;">OFFSITE DETOUR ROUTE FOR E. INNES ST. SOUTH BOUND OFF RAMP TRAFFIC</p>
---	--	--	--