

MESSAGE NO. 1	MESSAGE NO. 2
LEFT THREE LANES	CLOSED NEXT XX MILES
CHANGEABLE MESSAGE SIGN	

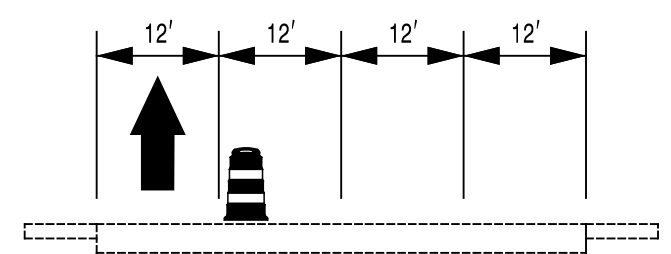

MESSAGE NO. 1	MESSAGE NO. 2
RIGHT THREE LANES	CLOSED NEXT XX MILES
CHANGEABLE MESSAGE SIGN	

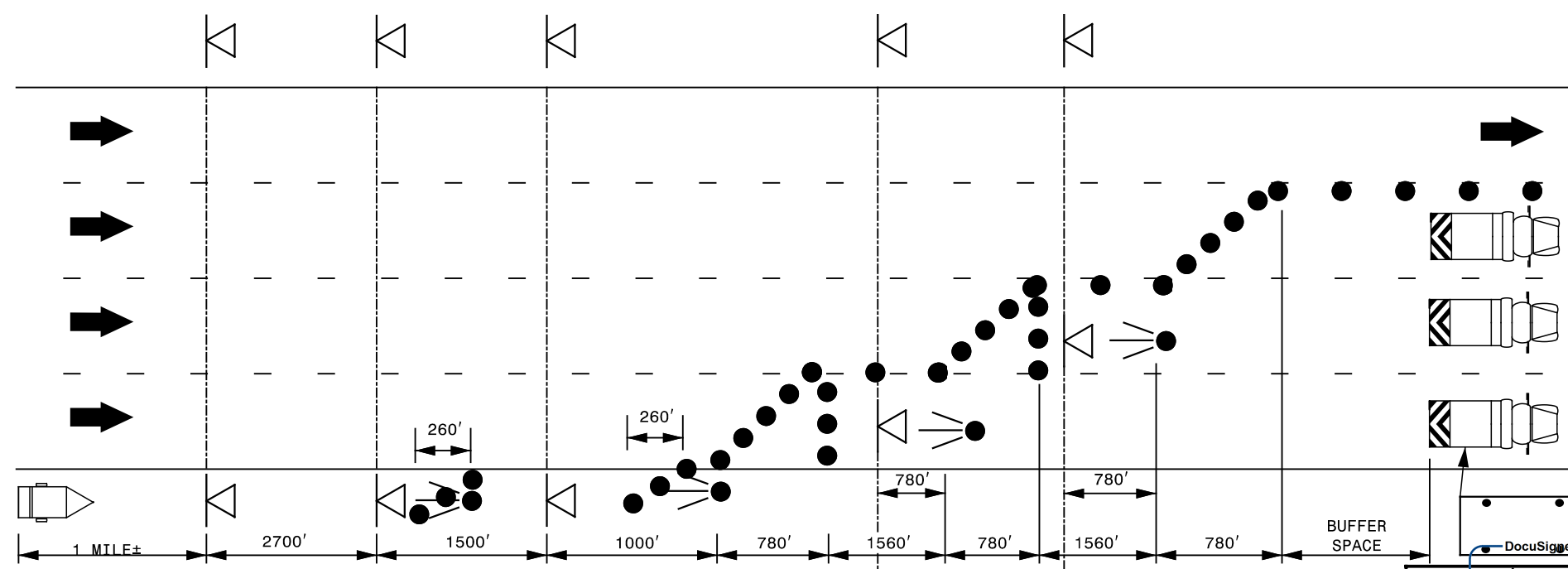
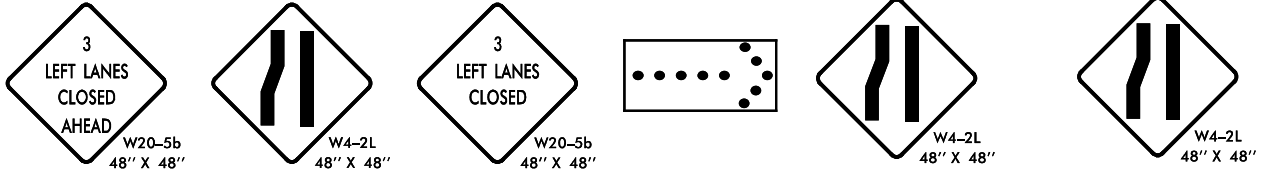
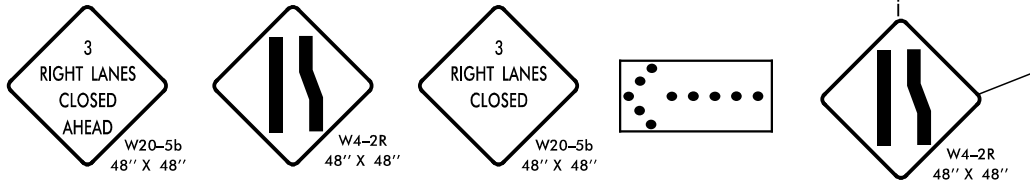

APPROVED: *Steve Miller*
 DATE: 12/4/2015
 SEAL
 DOCUMENT NOT CONSIDERED FINAL
 UNLESS ALL SIGNATURES COMPLETED



LANE CLOSURE TYPICAL

SEPI
 ENGINEERING & CONSTRUCTION
 1025 Wade Avenue
 Raleigh, NC 27605
 Tel: 919-789-9977
 Fax: 919-789-9591
 License: C-2197

11/30/2015
 G:\Tran\I-5790\I-5855 TMP\I-5790-I-5855 TMP-14.dgn
 wlfles