

# EXIT 132 RAMP TO MT. HOPE CHURCH RD - I-85

PROJ. REFERENCE NO. I-5790/I-5855	SHEET NO. TMP-13
--------------------------------------	---------------------

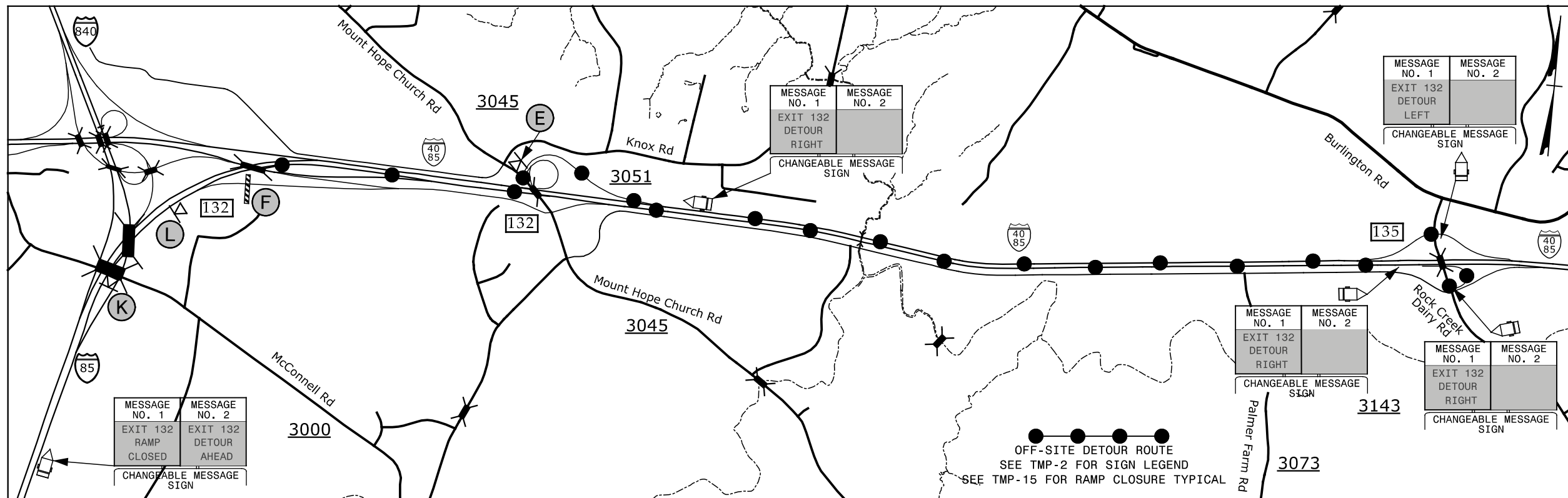

11/30/2015 10:51:00 AM G:\TracAff\I-5790\I-5855 TMP\TMP-13.dgn

**SEPI**  
ENGINEERING & CONSTRUCTION

1025 Wade Avenue  
Raleigh, NC 27605  
Tel: 919-789-9977  
Fax: 919-789-9591  
License: C-2197

DocuSigned by:  
*Steve Miller*

APPROVED: *Steve Miller*  
DATE: 12/4/2015

SEAL

**DOCUMENT NOT CONSIDERED FINAL  
UNLESS ALL SIGNATURES COMPLETED**

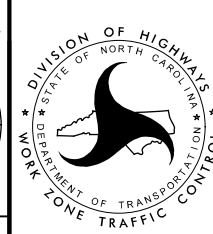
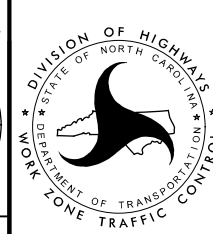

**EXIT 132  
MT HOPE CHURCH RD  
DETOUR**