

EXIT 128 RAMP C - I-85

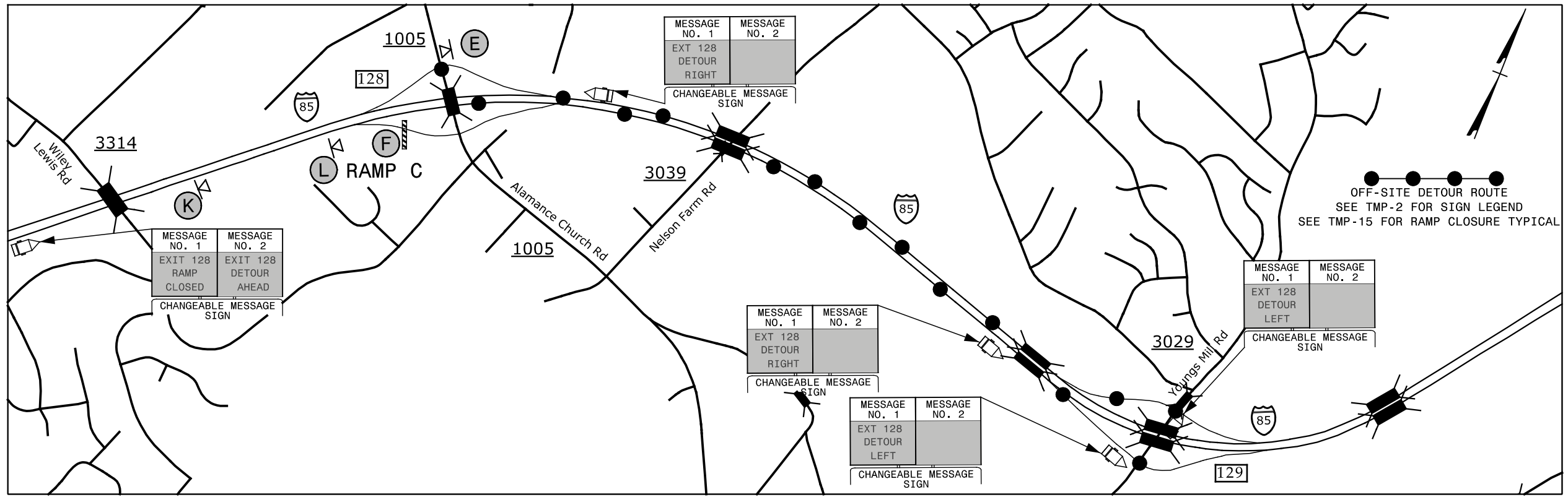

EXIT 128 RAMP D - I-85

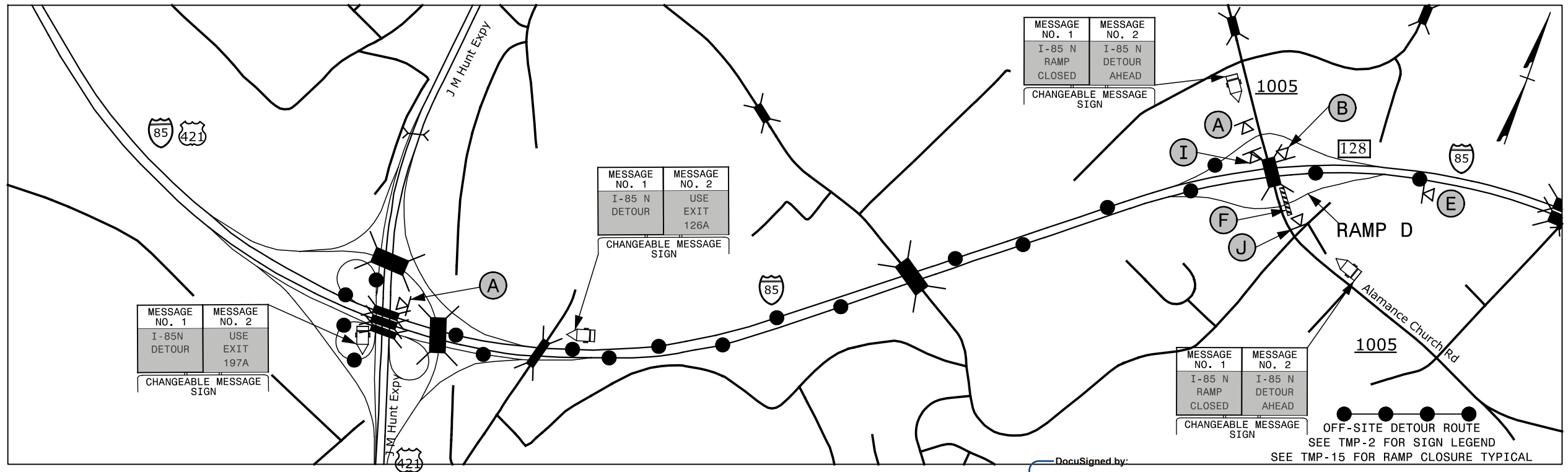

12/31/2015 10:41:10 AM G:\Tr\aff\I-5790-I-5855-TMP-9.dgn

SEPI
ENGINEERING & CONSTRUCTION

1025 Wade Avenue
Raleigh, NC 27605
Tel: 919-789-9977
Fax: 919-789-9591
License: C-2197

APPROVED: *Steve Miller*
DATE: 12/4/2015

SEAL

DOCUMENT NOT CONSIDERED FINAL
UNLESS ALL SIGNATURES COMPLETED

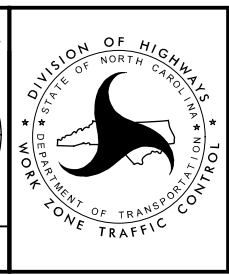

**EXIT 128
ALAMANCE CH RD
DETOUR**