

### EXIT 128 RAMP A - I-85

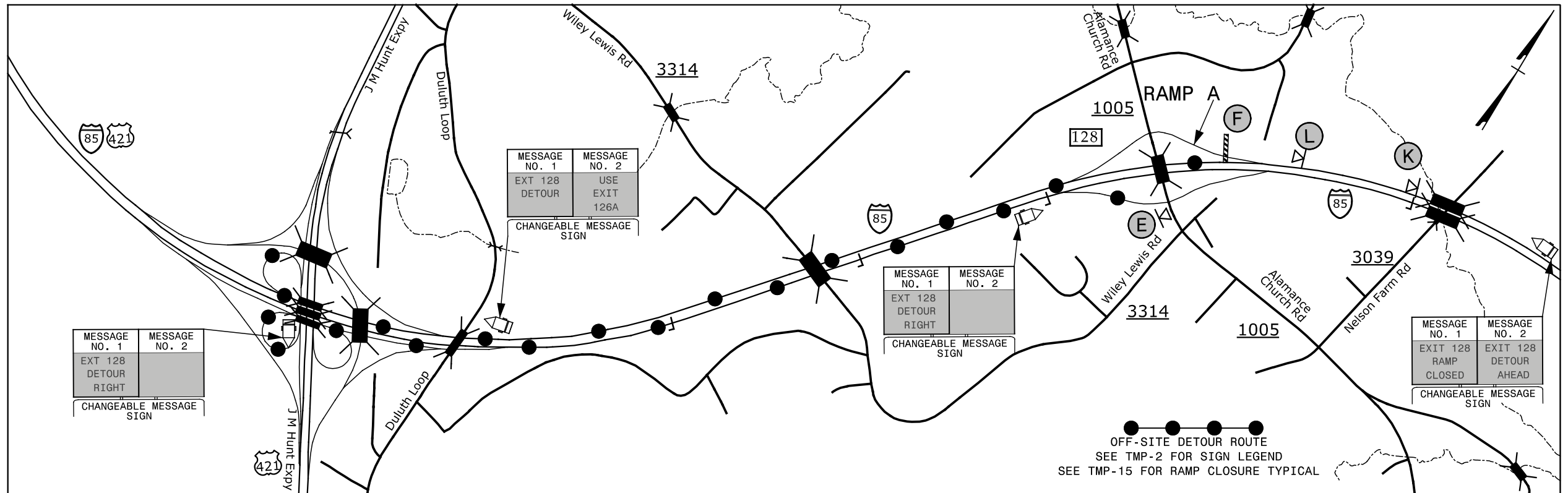

### EXIT 128 RAMP B - I-85

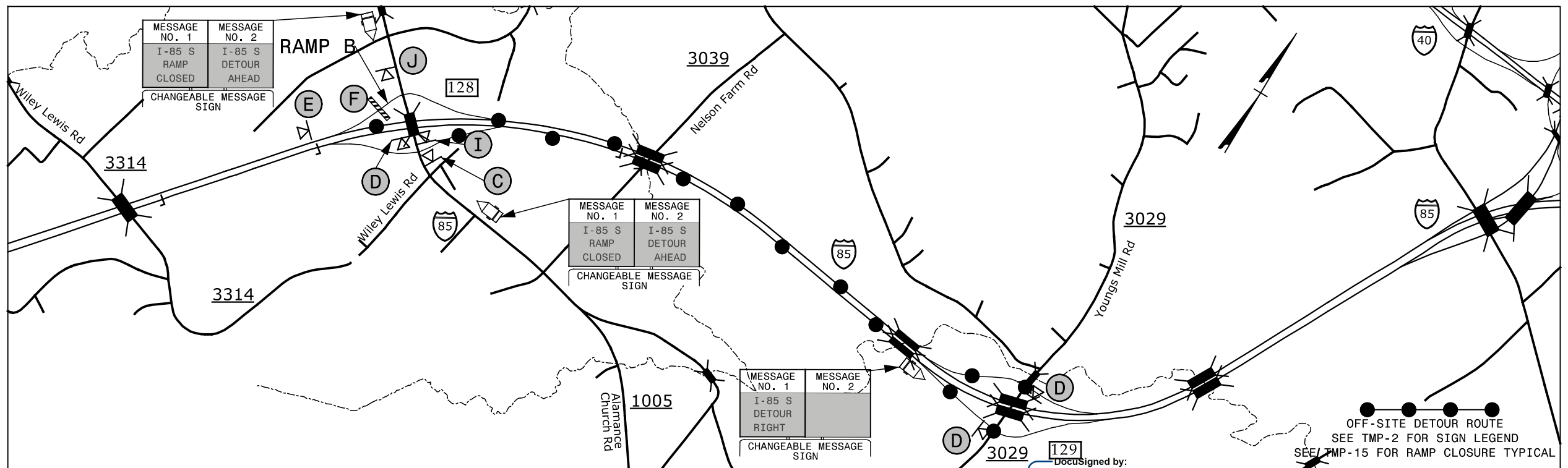

11/30/2015 G:\Traffic\I-5790-I-5855 TMP-8.dgn

<p><b>SEPI</b> ENGINEERING &amp; CONSTRUCTION</p> <p>1025 Wade Avenue Raleigh, NC 27605 Tel: 919-789-9977 Fax: 919-789-9591 License: C-2197</p>	<p>APPROVED: <i>Steve Miller</i></p> <p>DATE: 12/4/2015</p> <p>SEAL</p>			<p><b>EXIT 128 ALAMANCE CH RD DETOUR</b></p>
	<p>DOCUMENT NOT CONSIDERED FINAL UNLESS ALL SIGNATURES COMPLETED</p>			