

EXIT 126A RAMP C - I-85

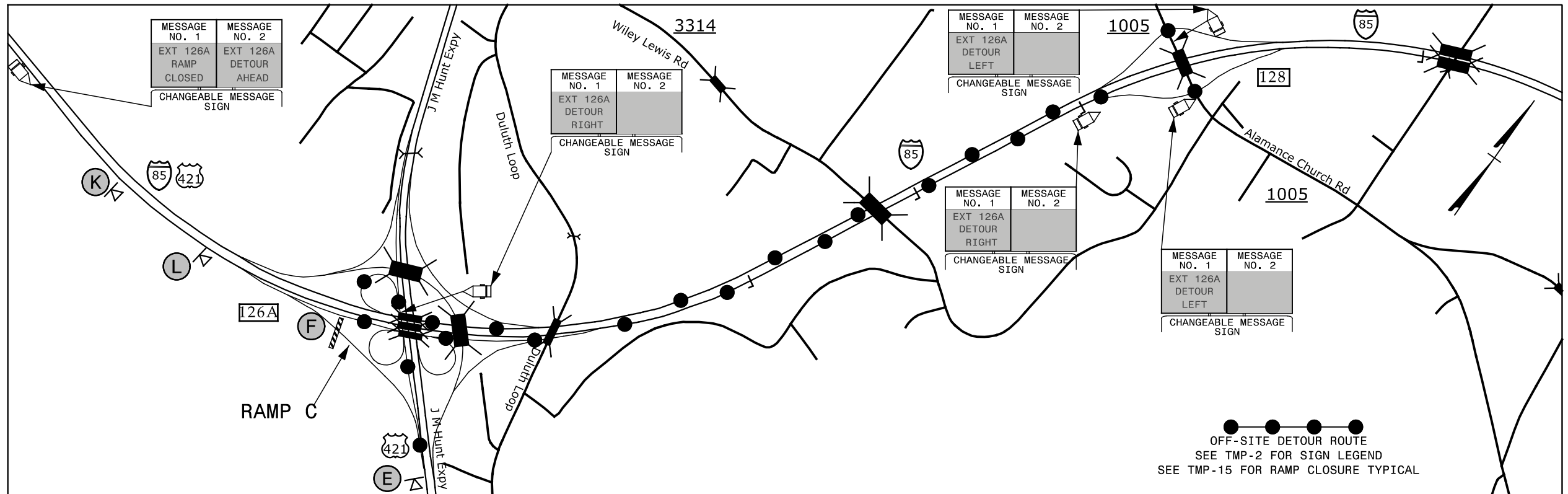

EXIT 197A LOOP C - US-421

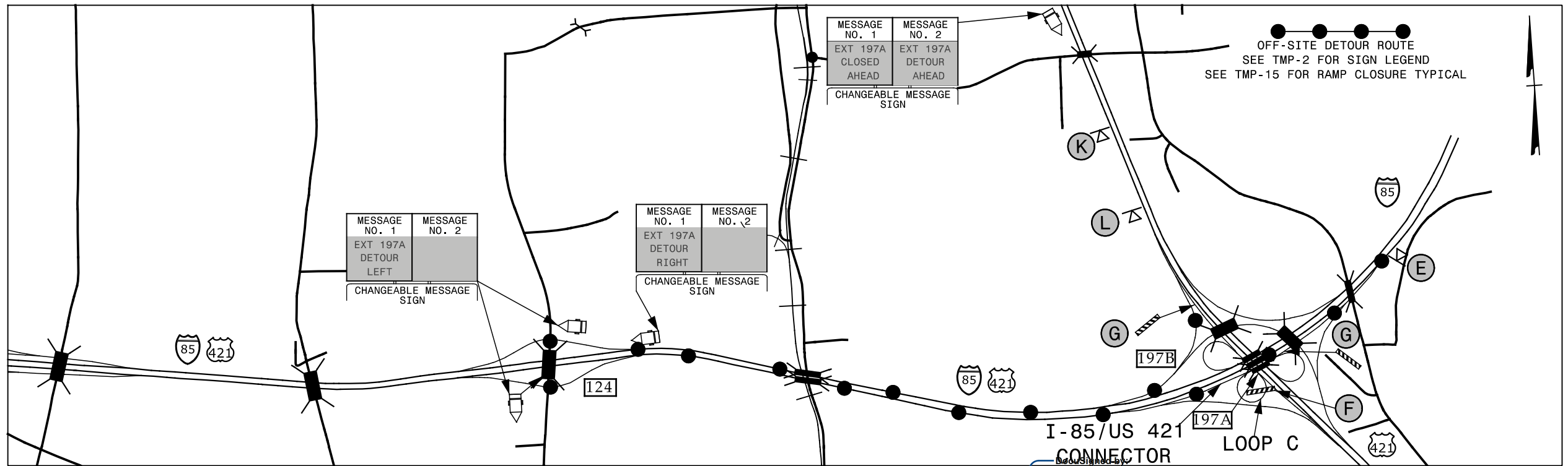

12/31/2015 10:11:00 AM G:\Tr\aff\I-5790\I-5855 TMP-6.dgn

<p>SEPI ENGINEERING & CONSTRUCTION</p> <p>1025 Wade Avenue Raleigh, NC 27605 Tel: 919-789-9977 Fax: 919-789-9591 License: C-2197</p>	<p>APPROVED: <i>Steve Miller</i></p> <p>DATE: 12/4/2015</p> <p>SEAL</p>			<p>I-85/JM HUNT EXPY DETOURS</p>
	<p>DOCUMENT NOT CONSIDERED FINAL UNLESS ALL SIGNATURES COMPLETED</p>			