

**This electronic collection of documents is provided  
for the convenience of the user  
and is Not a Certified Document –**

**The documents contained herein were originally issued  
and sealed by the individuals whose names and license  
numbers appear on each page, on the dates appearing  
with their signature on that page.**

**This file or an individual page  
shall not be considered a certified document.**

STATE OF NORTH CAROLINA  
DIVISION OF HIGHWAYS

**TRANSPORTATION MANAGEMENT PLAN**

**GASTON COUNTY**

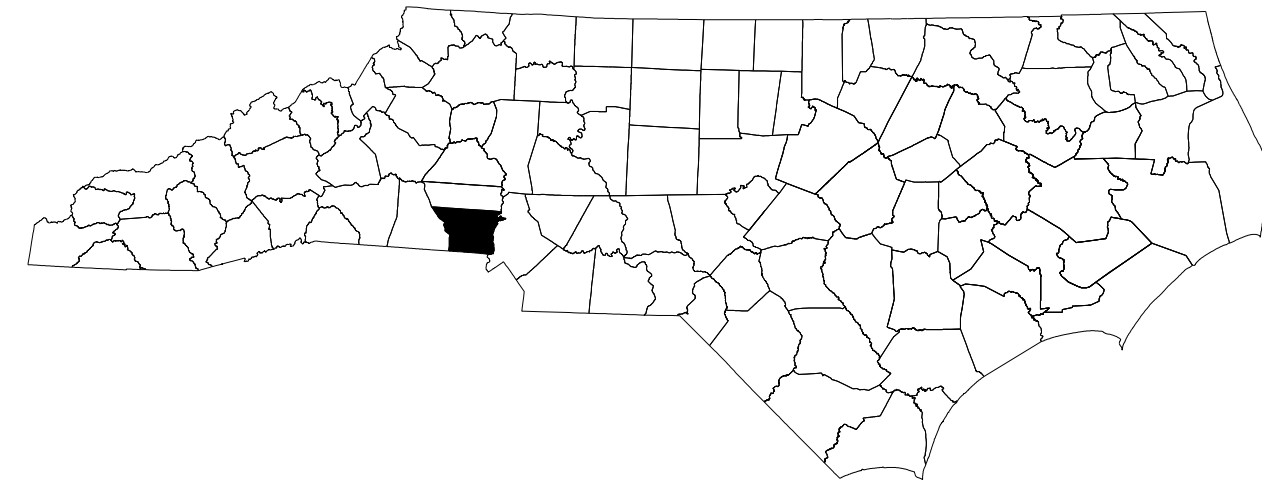

LOCATION: BRIDGE NO.203 OVER STANLEY CREEK ON SR 1935 (WILLOWSIDE DR.)

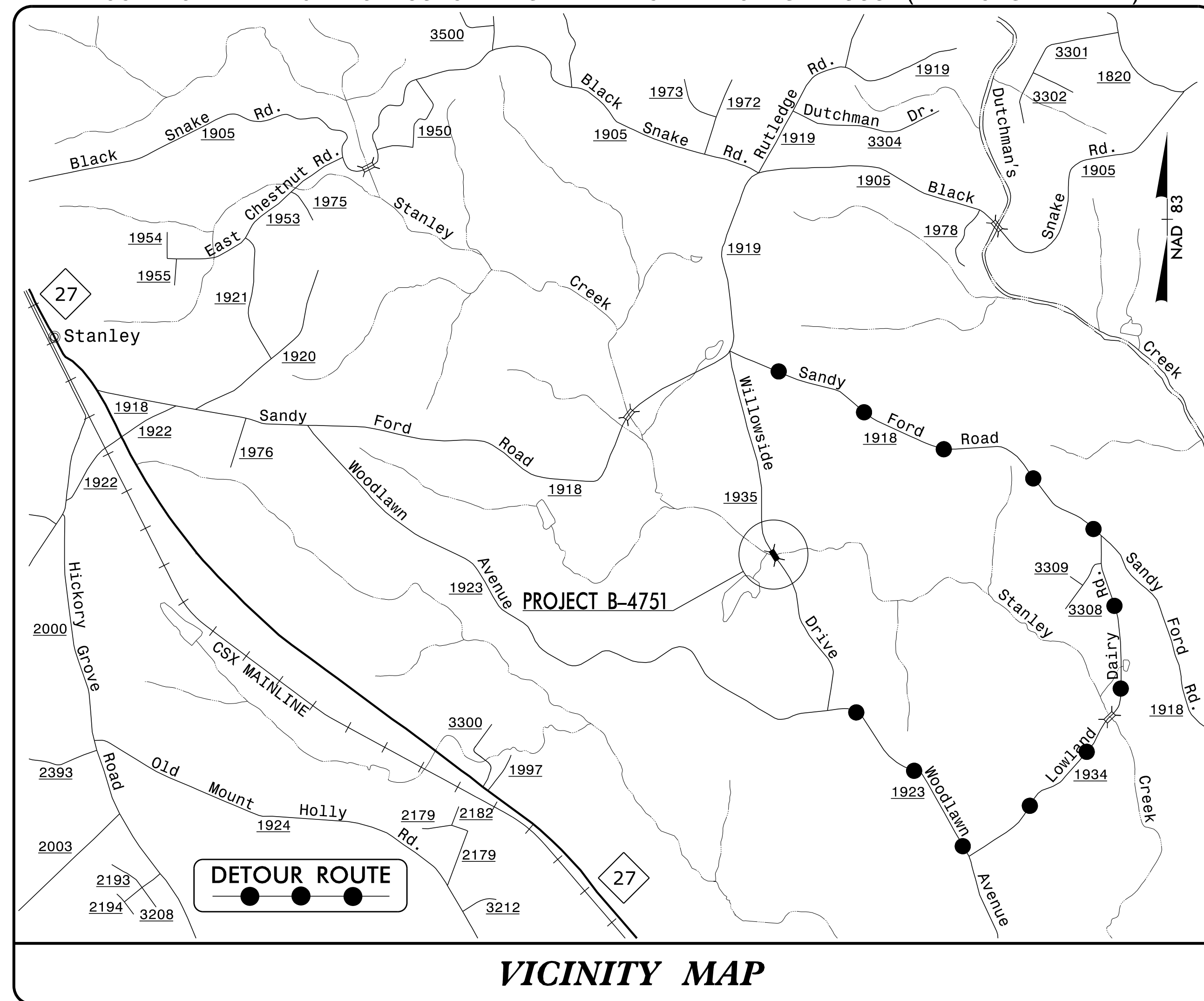

**VICINITY MAP**

<b>INDEX OF SHEETS</b>	
<u>SHEET NO.</u>	<u>TITLE</u>
TMP-1	TITLE SHEET, AND INDEX OF SHEETS
TMP-1A	LIST OF APPLICABLE ROADWAY STANDARD DRAWINGS, LEGEND, AND TEMPORARY PAVEMENT MARKINGS
TMP-1B	TRANSPORTATION OPERATIONS PLAN: (TRANSPORTATION OPERATIONS AND GENERAL NOTES)
TMP-2	SPECIAL SIGN DESIGN - WILLOWSIDE DRIVE
TMP-3	TEMPORARY TRAFFIC CONTROL PHASING AND OFF-SITE DETOUR - WILLOWSIDE DRIVE - SR 1935

SHEET NO.  
TMP-1

**B-4751**

**TIP PROJECT:**

11/9/2015  
p:\tip\projects-b\4751\traffic\trafficcontrol\tp\B4751.TC.TMP01.dgn  
User:tscoats

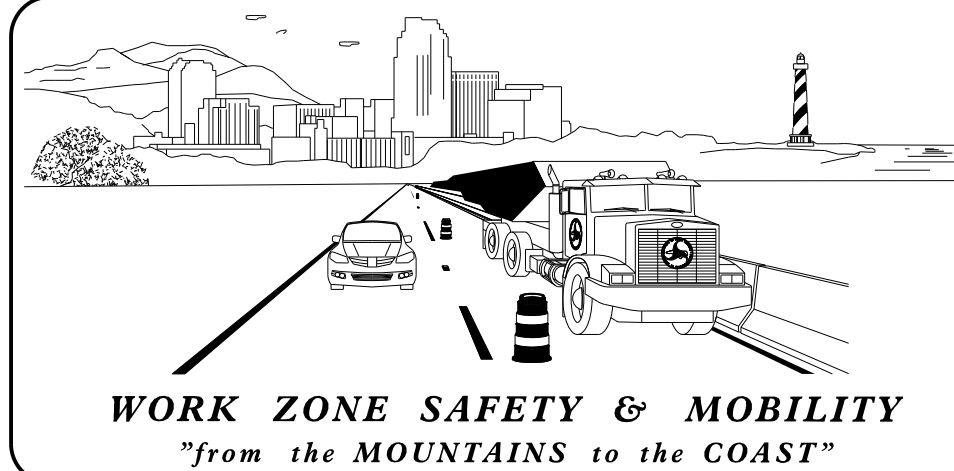

**N.C.D.O.T. WORK ZONE TRAFFIC CONTROL**  
1561 MAIL SERVICE CENTER (MSC) RALEIGH, NC 27699-1561  
750 N. GREENFIELD PARKWAY, GARNER, NC 27529 (DELIVERY)  
PHONE: (919) 773-2800 FAX: (919) 771-2745

J. S. BOURNE, P.E. STATE TRAFFIC MANAGEMENT ENGINEER  
J. W. WOOLARD, P.E. TRAFFIC CONTROL PROJECT ENGINEER  
L. D. STOUGHKO, P.E. TRAFFIC CONTROL PROJECT DESIGN ENGINEER  
S. B. COATS TRAFFIC CONTROL DESIGN ENGINEER

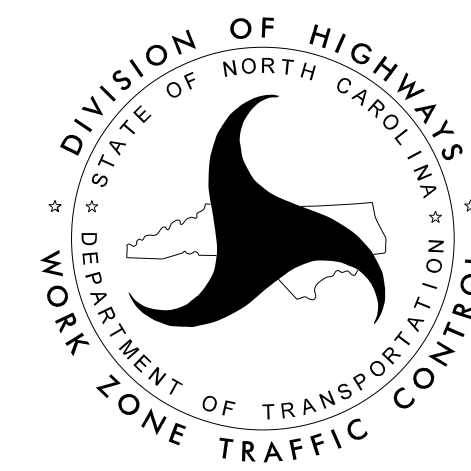

**DOCUMENT NOT CONSIDERED FINAL  
UNLESS ALL SIGNATURES COMPLETED**

APPROVED: *Lori D. Stouhko*  
DATE: 11/9/2015

SEAL



# ROADWAY STANDARD DRAWINGS

THE FOLLOWING ROADWAY STANDARDS AS SHOWN IN "ROADWAY STANDARD DRAWINGS" - PROJECT SERVICES UNIT - N.C. DEPARTMENT OF TRANSPORTATION - RALEIGH, N.C., DATED JANUARY 2012 ARE APPLICABLE TO THIS PROJECT AND BY REFERENCE HEREBY ARE CONSIDERED A PART OF THESE PLANS:

STD. NO.	TITLE
1101.02	TEMPORARY LANE CLOSURES
1101.03	TEMPORARY ROAD CLOSURES
1101.05	WORK ZONE VEHICLE ACCESSES
1101.11	TRAFFIC CONTROL DESIGN TABLES
1110.01	STATIONARY WORK ZONE SIGNS
1110.02	PORTABLE WORK ZONE SIGNS
1130.01	DRUM
1135.01	CONES
1145.01	BARRICADES
1150.01	FLAGGING DEVICES

# LEGEND

## GENERAL

- DIRECTION OF TRAFFIC FLOW
- DIRECTION OF PEDESTRIAN TRAFFIC FLOW
- EXIST. PVMT.
- NORTH ARROW
- PROPOSED PVMT.
- TEMP. SHORING (LOCATION PURPOSES ONLY)

WORK AREA

REMOVAL

USER DEFINED (IF NEEDED)

USER DEFINED (IF NEEDED)

## SIGNALS

- EXISTING
- PROPOSED
- TEMPORARY

## PAVEMENT MARKINGS

- EXISTING LINES
- TEMPORARY LINES

## TRAFFIC CONTROL DEVICES

- BARRICADE (TYPE III)
- CONE
- DRUM
- SKINNY DRUM
- TUBULAR MARKER
- TEMPORARY CRASH CUSHION
- FLASHING ARROW BOARD
- FLAGGER
- LAW ENFORCEMENT
- TRUCK MOUNTED ATTENUATOR (TMA)
- CHANGEABLE MESSAGE SIGN

## TEMPORARY SIGNING

- PORTABLE SIGN
- STATIONARY SIGN
- STATIONARY OR PORTABLE SIGN

## PAVEMENT MARKERS

- CRYSTAL/CRYSTAL
- CRYSTAL/RED
- YELLOW/YELLOW

## PAVEMENT MARKING SYMBOLS

- PAVEMENT MARKING SYMBOLS

TEMPORARY PAVEMENT MARKING  
N/A

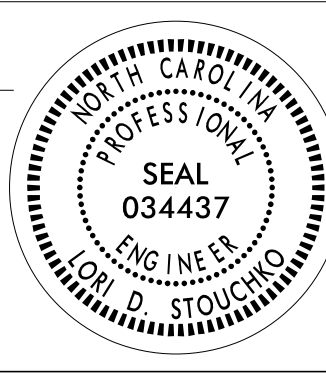
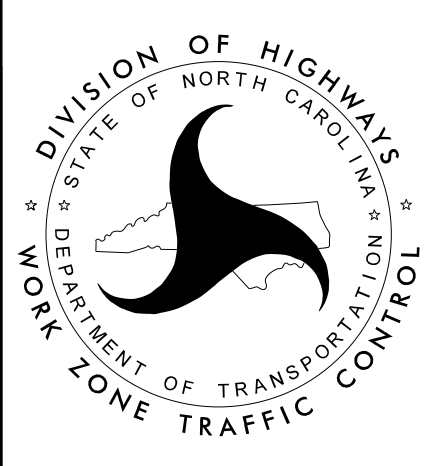
APPROVED: <i>Lori D. Stouchko</i> <small>902280189181460...</small> DATE: 11/9/2015 		ROADWAY STANDARD DRAWINGS & LEGEND
<b>DOCUMENT NOT CONSIDERED FINAL UNLESS ALL SIGNATURES COMPLETED</b>		

## TRANSPORTATION OPERATIONS

### CONSTRUCTION

REMOVE AND REPLACE EXISTING STRUCTURE AND ROADWAY APPROACHES ALONG EXISTING ROADWAY ALIGNMENT AS SHOWN IN THE CONSTRUCTION PLANS.

### TMP DESIGN PARAMETERS

TRAFFIC WILL BE DETOURED OFF-SITE DURING THE CONSTRUCTION PERIOD.

THE OFF-SITE DETOUR WILL INCLUDE WOODLAWN AVENUE (SR 1923), LOWLAND DAIRY ROAD (SR 1934), AND SANDY FORD ROAD (SR 1918).

## GENERAL NOTES

CHANGES MAY BE REQUIRED WHEN PHYSICAL DIMENSIONS IN THE DETAIL DRAWINGS, STANDARD DETAILS, AND ROADWAY DETAILS ARE NOT ATTAINABLE TO MEET FIELD CONDITIONS OR RESULT IN DUPLICATE OR UNDESIRE OVERLAPPING OF DEVICES. MODIFICATION MAY INCLUDE: MOVING, SUPPLEMENTING, COVERING, OR REMOVAL OF DEVICES AS DIRECTED BY THE ENGINEER.

THE FOLLOWING GENERAL NOTES APPLY AT ALL TIMES FOR THE DURATION OF THE CONSTRUCTION PROJECT EXCEPT WHEN OTHERWISE NOTED IN THE PLAN OR DIRECTED BY THE ENGINEER.

#### TRAFFIC PATTERN ALTERATIONS

A) NOTIFY THE ENGINEER TWENTY ONE (21) CALENDAR DAYS PRIOR TO ANY TRAFFIC PATTERN ALTERATION.

#### SIGNING

B) PROVIDE SIGNING AND DEVICES REQUIRED TO CLOSE THE ROAD ACCORDING TO THE ROADWAY STANDARD DRAWINGS AND TRAFFIC CONTROL PLANS.

PROVIDE SIGNING REQUIRED FOR THE OFF-SITE DETOUR ROUTE AS SHOWN IN THE TRAFFIC CONTROL PLANS.

C) COVER OR REMOVE ALL SIGNS AND DEVICES REQUIRED TO CLOSE THE ROAD WHEN ROAD CLOSURE IS NOT IN OPERATION.

COVER OR REMOVE ALL SIGNS REQUIRED FOR THE OFF-SITE DETOUR WHEN THE DETOUR IS NOT IN OPERATION.

D) ENSURE ALL NECESSARY SIGNING IS IN PLACE PRIOR TO ALTERING ANY TRAFFIC PATTERN.

#### TRAFFIC CONTROL DEVICES



E) PLACE TYPE III BARRICADES, WITH "ROAD CLOSED" SIGN R11-2 ATTACHED, OF SUFFICIENT LENGTH TO CLOSE ENTIRE ROADWAY.

#### PAVEMENT MARKINGS AND MARKERS

F) INSTALL PAVEMENT MARKINGS AND PAVEMENT MARKERS ON THE FINAL SURFACE AS SHOWN IN FINAL PAVEMENT MARKING PLAN.

G) TIE PROPOSED PAVEMENT MARKING LINES TO EXISTING PAVEMENT MARKING LINES.

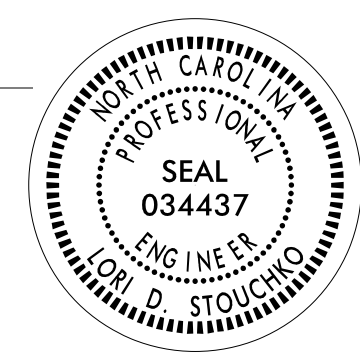
11/9/2015  
p:\tip\projects-b\4751\traffic\trafficcontrol\top\B4751.TC\_TMP01B.dgn  
User:scodts

APPROVED: <i>Lori D. Stoucho</i> <small>902CB1B1818148C...</small> DATE: 11/9/2015			<h1 style="margin: 0;">TRANSPORTATION OPERATIONS PLAN</h1>
<b>DOCUMENT NOT CONSIDERED FINAL UNLESS ALL SIGNATURES COMPLETED</b>			

<b>SIGN NUMBER:</b> SP15038 <b>TYPE:</b> STATIONARY <b>QUANTITY:</b> SEE PLANS <b>SIGN WIDTH:</b> 3'-0" <b>HEIGHT:</b> 1'-6" <b>TOTAL AREA:</b> 4.5 Sq.Ft. <b>BORDER TYPE:</b> INSET <b>RECESS:</b> 0.38" <b>WIDTH:</b> 0.5" <b>RADII:</b> 1.5" <b>NO. Z BARS:</b> <b>LENGTH:</b>	<b>BACKG COLOR:</b> Fluorescent Orange <b>COPY COLOR:</b> Black <table border="1"> <thead> <tr> <th>SYMBOL</th> <th>X</th> <th>Y</th> <th>WID</th> <th>HT</th> </tr> </thead> <tbody> <tr><td> </td><td> </td><td> </td><td> </td><td> </td></tr> <tr><td> </td><td> </td><td> </td><td> </td><td> </td></tr> <tr><td> </td><td> </td><td> </td><td> </td><td> </td></tr> <tr><td> </td><td> </td><td> </td><td> </td><td> </td></tr> <tr><td> </td><td> </td><td> </td><td> </td><td> </td></tr> <tr><td> </td><td> </td><td> </td><td> </td><td> </td></tr> <tr><td> </td><td> </td><td> </td><td> </td><td> </td></tr> <tr><td> </td><td> </td><td> </td><td> </td><td> </td></tr> <tr><td> </td><td> </td><td> </td><td> </td><td> </td></tr> <tr><td> </td><td> </td><td> </td><td> </td><td> </td></tr> </tbody> </table> <b>MAT'L:</b> 0.080" (2.0 mm) ALUMINUM	SYMBOL	X	Y	WID	HT																																																			<b>DESIGN BY:</b> W. Johnson <b>PROJECT ID:</b> Willowside Dr <b>CHECKED BY:</b> KLJ <b>DIV:</b> 10 <b>DATE:</b> Mar 11, 2015
SYMBOL	X	Y	WID	HT																																																					

**BORDER**  
R=1.5"  
TH=0.5"  
IN=0.38"

Spacing Factor is 1 unless specified otherwise

**LETTER POSITIONS**

Letter spacings are to start of next letter

	W	I	L	L	O	W	S	I	D	E												Series/Size Text Length
	1.9	4.5	1.8	3.2	3.1	3.5	4.2	3.6	1.8	3.8	2.6	1.9										C 2000 32.3
																						C 2000 15.2

FILENAME: SP15038\_Willowside Dr NORTH CAROLINA D.O.T. SIGN DETAIL

11/9/2015 p:\t\p\projects-b\4751\traffic\trafficcontrol\top\B4751\_TC\_TMP02.dgn User:scodts

APPROVED: <i>Ron King</i> DATE: 11/9/2015 		<b>SPECIAL SIGN DESIGN</b> <b>WILLOWSIDE DRIVE</b>
<b>DOCUMENT NOT CONSIDERED FINAL          UNLESS ALL SIGNATURES COMPLETED</b>		

# TEMPORARY TRAFFIC CONTROL PHASING

## PHASE I

- STEP 1. INSTALL ALL OFF-SITE DETOUR SIGNING (SEE TMP-3).
- USING RSD 1101.03 (SHEET 1 OF 9), CLOSE SR 1935 (WILLOWSIDE DRIVE) FROM STA. 13+50+/- -L- TO STA. 17+65+/- -L-.

## PHASE II

- STEP 1. AWAY FROM TRAFFIC, REMOVE EXISTING BRIDGE. CONSTRUCT NEW BRIDGE AND ROADWAY APPROACHES, DRAINAGE, GUARDRAIL, AND PAVE UP TO BUT NOT INCLUDING THE FINAL LAYER OF SURFACE COURSE AS FOLLOWS (SEE CONSTRUCTION PLANS):
- STA. 13+50+/- -L- TO STA. 17+65+/- -L-
- STEP 2. AWAY FROM TRAFFIC, PAVE THE FINAL LAYER OF SURFACE COURSE AS FOLLOWS (SEE CONSTRUCTION PLANS):
- STA. 13+50+/- -L- TO STA. 17+65+/- -L-
  - PLACE FINAL PAVEMENT MARKINGS AND MARKERS (SEE FINAL PAVEMENT MARKING PLAN).
- STEP 3. REMOVE ALL TYPE III BARRICADES AND DETOUR SIGNING. REOPEN SR 1935 (WILLOWSIDE DRIVE) TO A 2-LANE, 2-WAY TRAFFIC PATTERN.

\* SEE SHEET TMP-2 FOR SIGN DESIGN

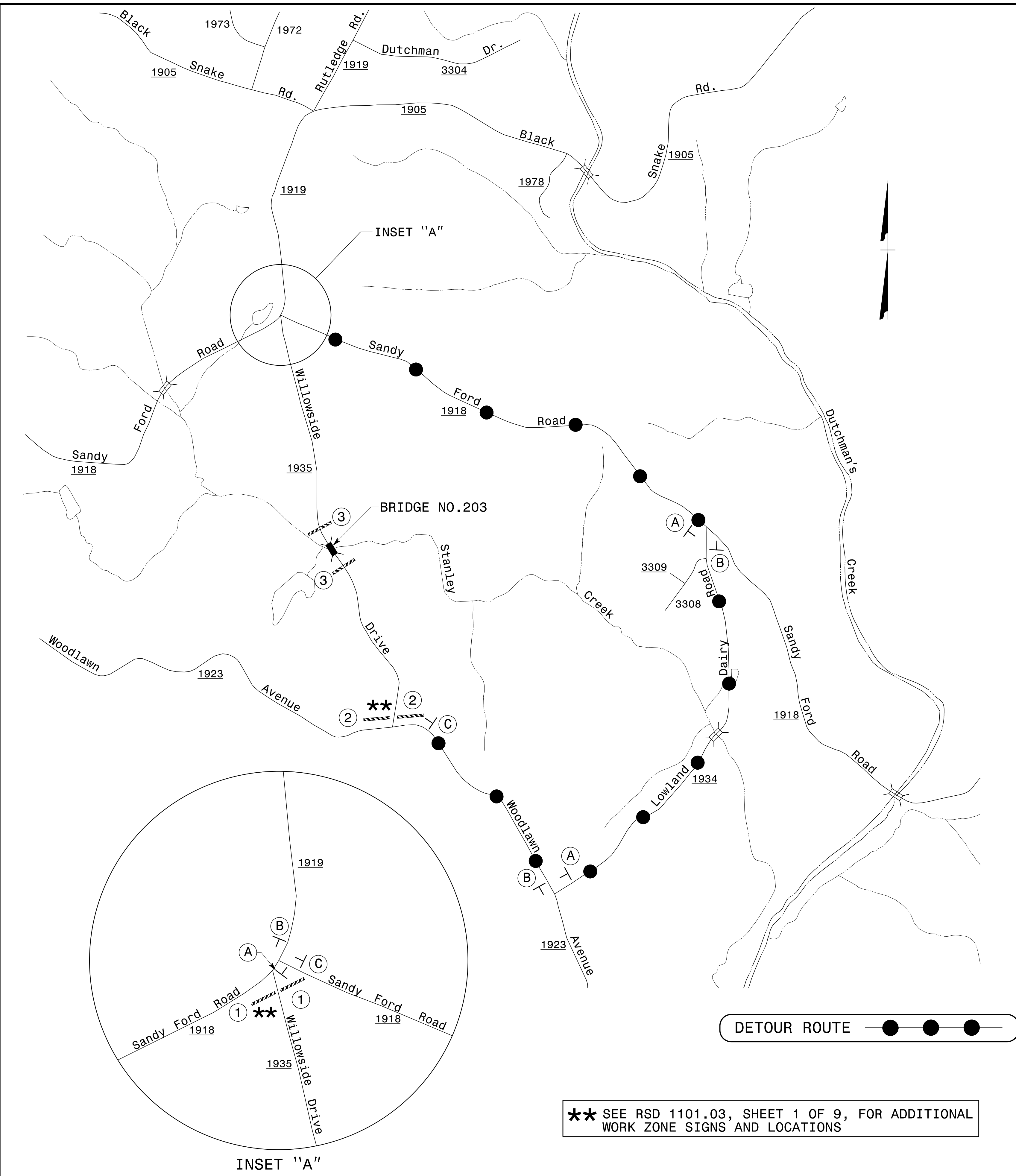
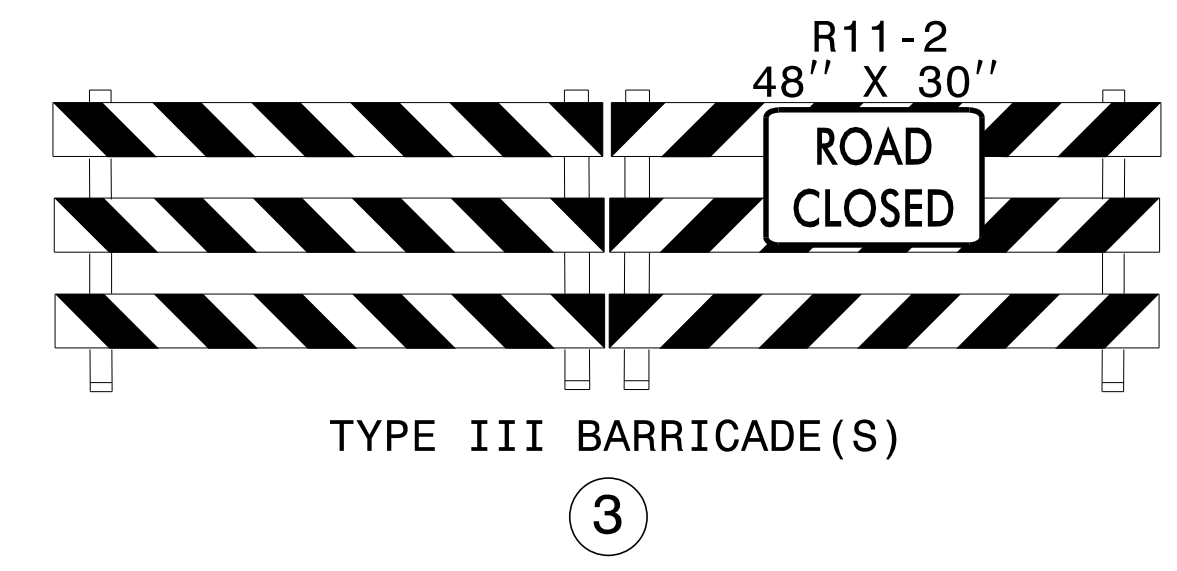
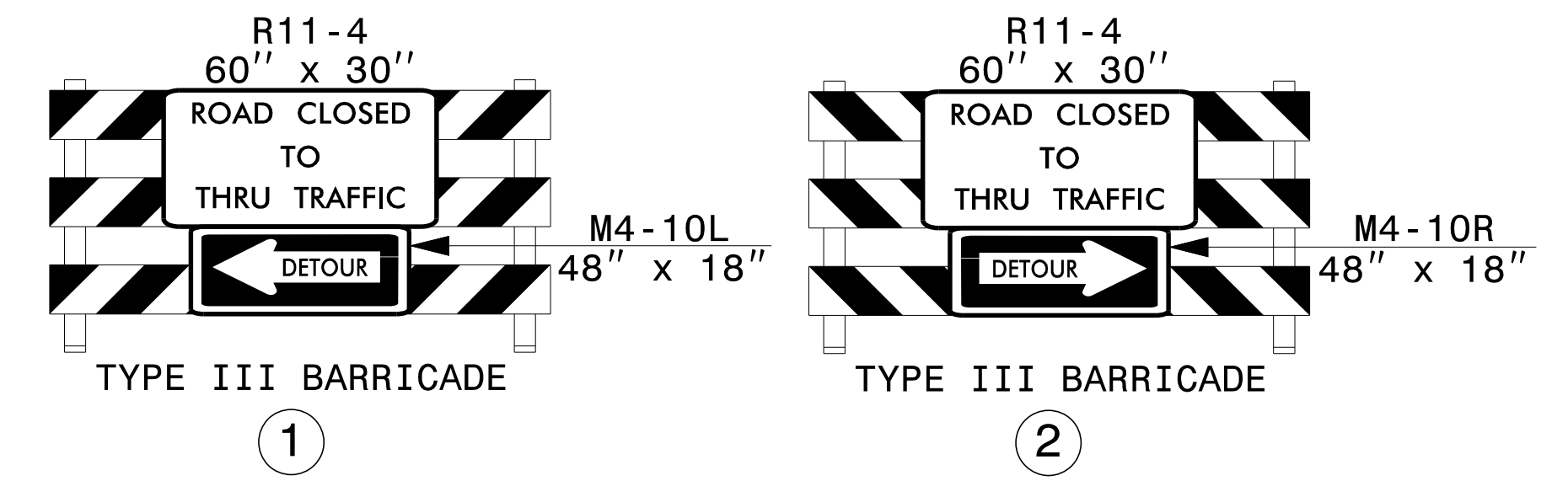
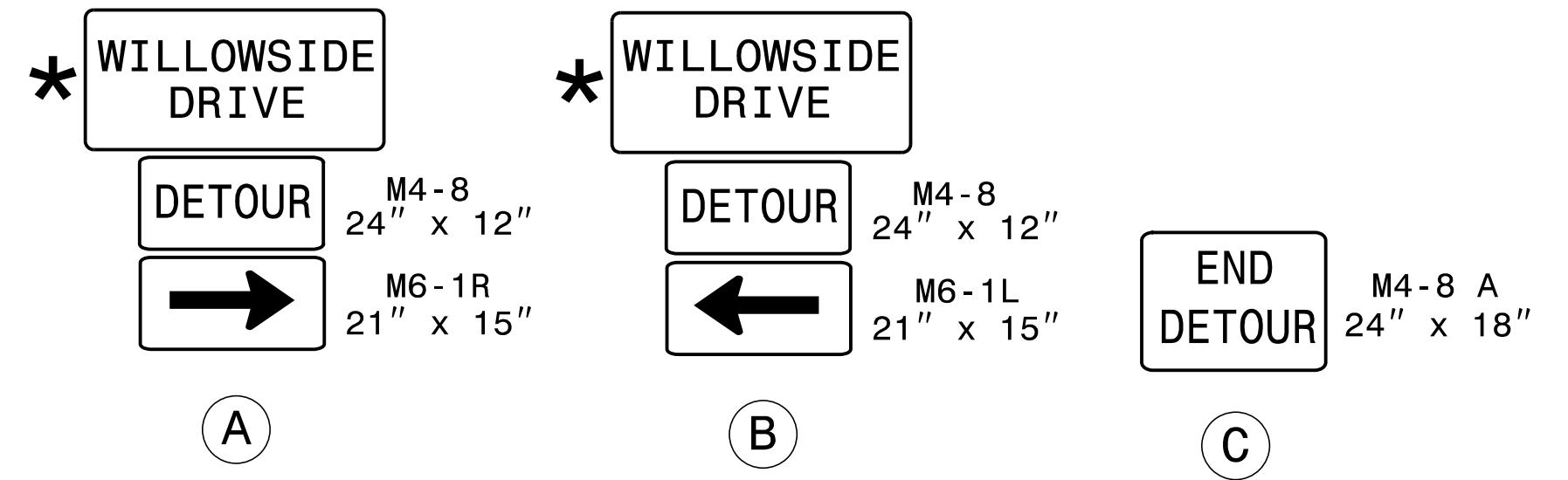

DETOUR ROUTE ●●●

\*\* SEE RSD 1101.03, SHEET 1 OF 9, FOR ADDITIONAL WORK ZONE SIGNS AND LOCATIONS

11/9/2015 p:\t\p\projects-b\4751\traffic\trafficcontrol\top\B4751.TC.TMP03.dgn User:scodts

APPROVED: *Lori D. Stoucho*  
902CB18918148C...  
 DATE: 11/9/2015

**DOCUMENT NOT CONSIDERED FINAL UNLESS ALL SIGNATURES COMPLETED**

**TEMPORARY TRAFFIC CONTROL PHASING AND OFF-SITE DETOUR WILLOWSIDE DRIVE SR 1935**