

**END OF CAP VIEW**  
(TYPICAL BOTH ENDS)

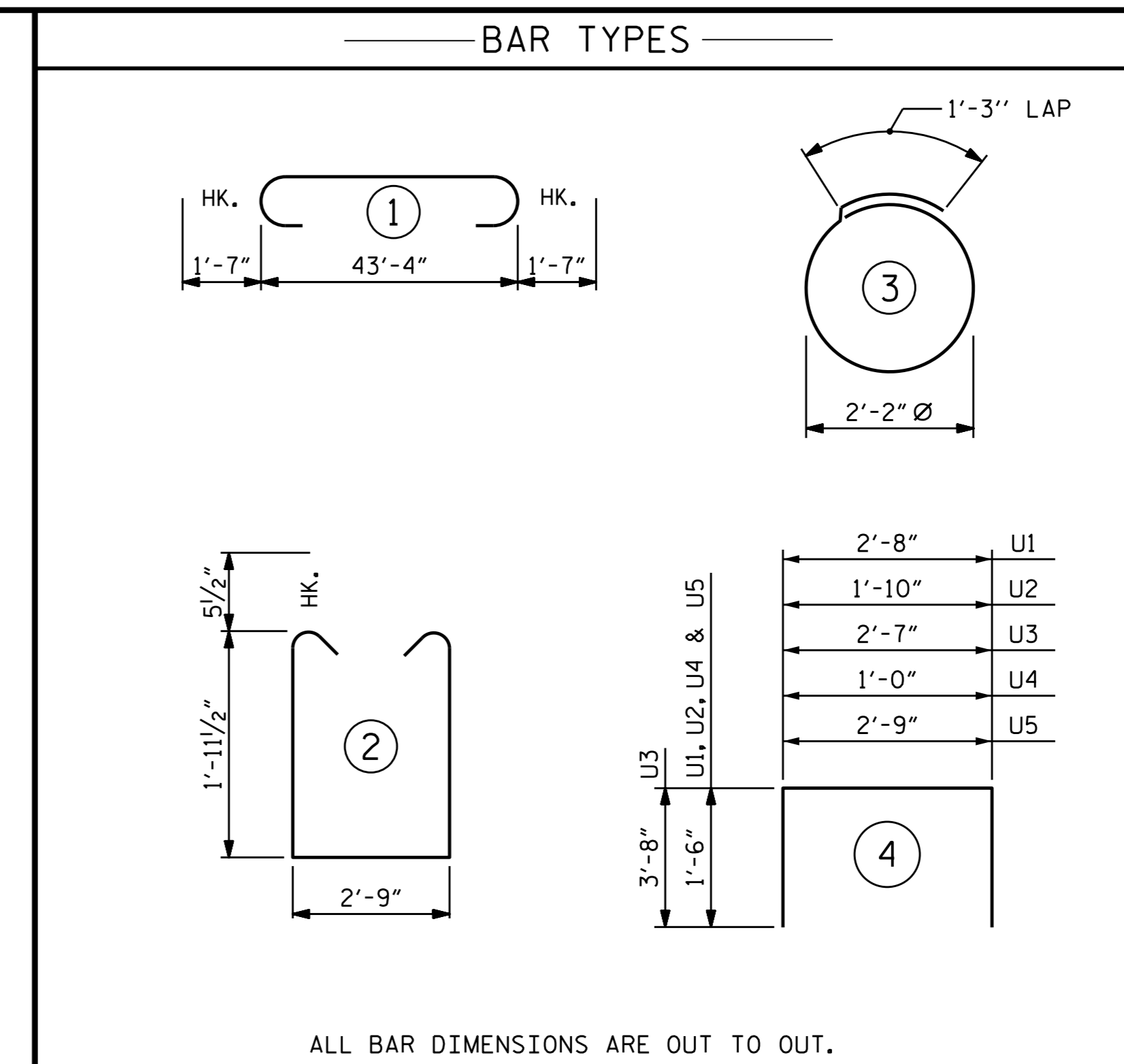

ALL BAR DIMENSIONS ARE OUT TO OUT.

**BILL OF MATERIAL**

**BENT 1**

BAR	NO.	SIZE	TYPE	LENGTH	WEIGHT
* B1	4	#11	1	46'-6"	988
* B2	4	#11	STR	43'-6"	924
* B3	4	#5	STR	43'-6"	181
* B4	12	#4	STR	23'-2"	186
* B5	4	#4	STR	30'-0"	80
* B6	11	#4	STR	2'-9"	20
* D1	56	#6	STR	1'-6"	126
* S1	52	#5	2	7'-7"	411
* S2	14	#4	3	8'-1"	76
* U1	4	#4	4	5'-8"	15
* U2	6	#4	4	4'-10"	19
* U3	2	#9	4	9'-11"	67
* U4	29	#4	4	4'-0"	77
* U5	20	#4	4	5'-9"	77

\* EPOXY CONCRETE REINFORCING STEEL 3247 LBS.

CLASS AA CONCRETE 14.3 C.Y. ▲

▲ CONCRETE DISPLACED BY THE 16" PRESTRESSED CONCRETE PILES HAS BEEN DEDUCTED FROM THE CONCRETE QUANTITY.

16" PRESTRESSED CONCRETE PILES

No. = 7 LIN. FT. = 490

PILE REDRIVES EA. NO. = 4

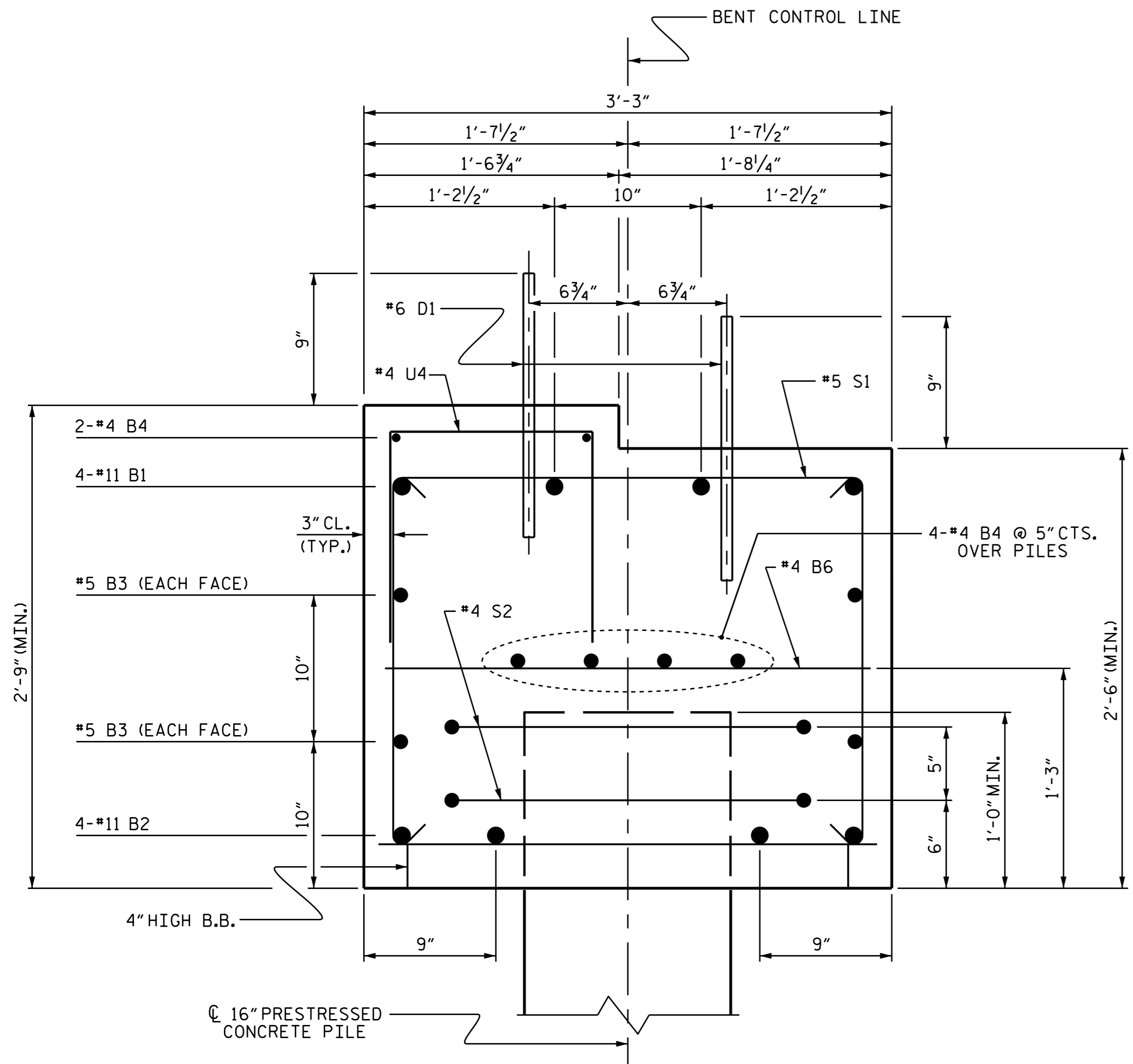

**SECTION A-A**

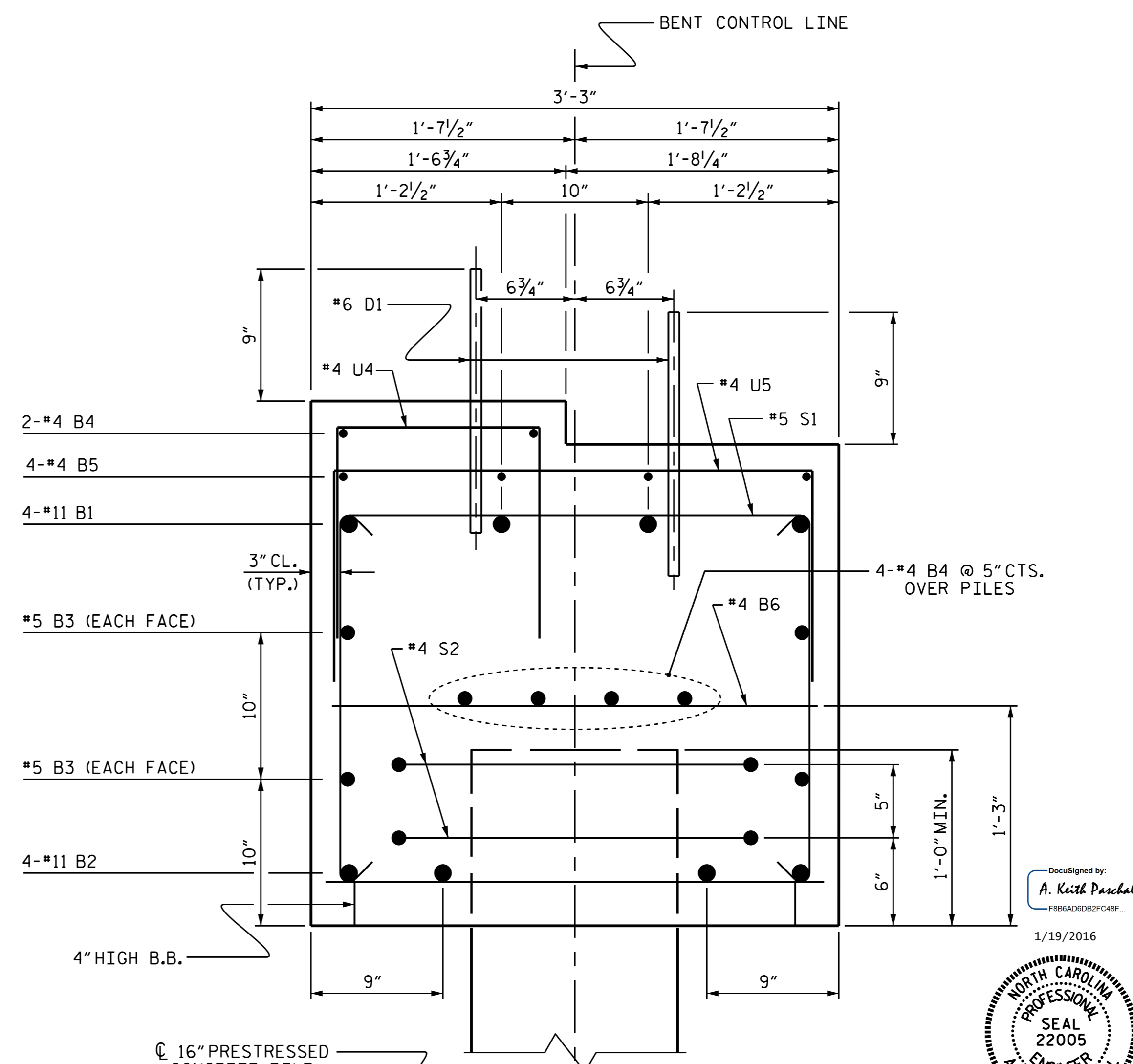

**SECTION B-B**

DRAWN BY : K. P. SEDAİ DATE : 7/14/15  
 CHECKED BY : P. N. HOLDER DATE : 9/8/15  
 DESIGN ENGINEER OF RECORD : P. N. HOLDER DATE : 9/8/15

19-JAN-2016 13:24  
 R:\Structures\Plans\Final Plans\B-5300\_SMU.BT1.dgn  
 kpaschal

DocuSigned by:  
**A. Keith Paschal**  
 F3B8A0D83FC48F...  
 1/19/2016

PROJECT NO. B-5300  
BEAUFORT COUNTY  
 STATION: 18+77.50 -L-

SHEET 2 OF 2

STATE OF NORTH CAROLINA  
 DEPARTMENT OF TRANSPORTATION  
 RALEIGH

**SUBSTRUCTURE**  
**BENT 1**

REVISIONS						SHEET NO. S-22
NO.	BY:	DATE:	NO.	BY:	DATE:	
1			3			TOTAL SHEETS 30
2			4			

DOCUMENT NOT CONSIDERED FINAL UNLESS ALL SIGNATURES COMPLETED