

**This electronic collection of documents is provided
for the convenience of the user
and is Not a Certified Document –**

**The documents contained herein were originally issued
and sealed by the individuals whose names and license
numbers appear on each page, on the dates appearing
with their signature on that page.**

**This file or an individual page
shall not be considered a certified document.**

STATE OF NORTH CAROLINA
DIVISION OF HIGHWAYS

**UTILITIES BY OTHERS PLANS
TRANSYLVANIA COUNTY**

**LOCATION: DAVIDSON RIVER VILLAGE CONNECTOR FROM
US US64/276 TO US 64, CITY OF BREVARD**

TYPE OF WORK: UTILITIES BY OTHERS

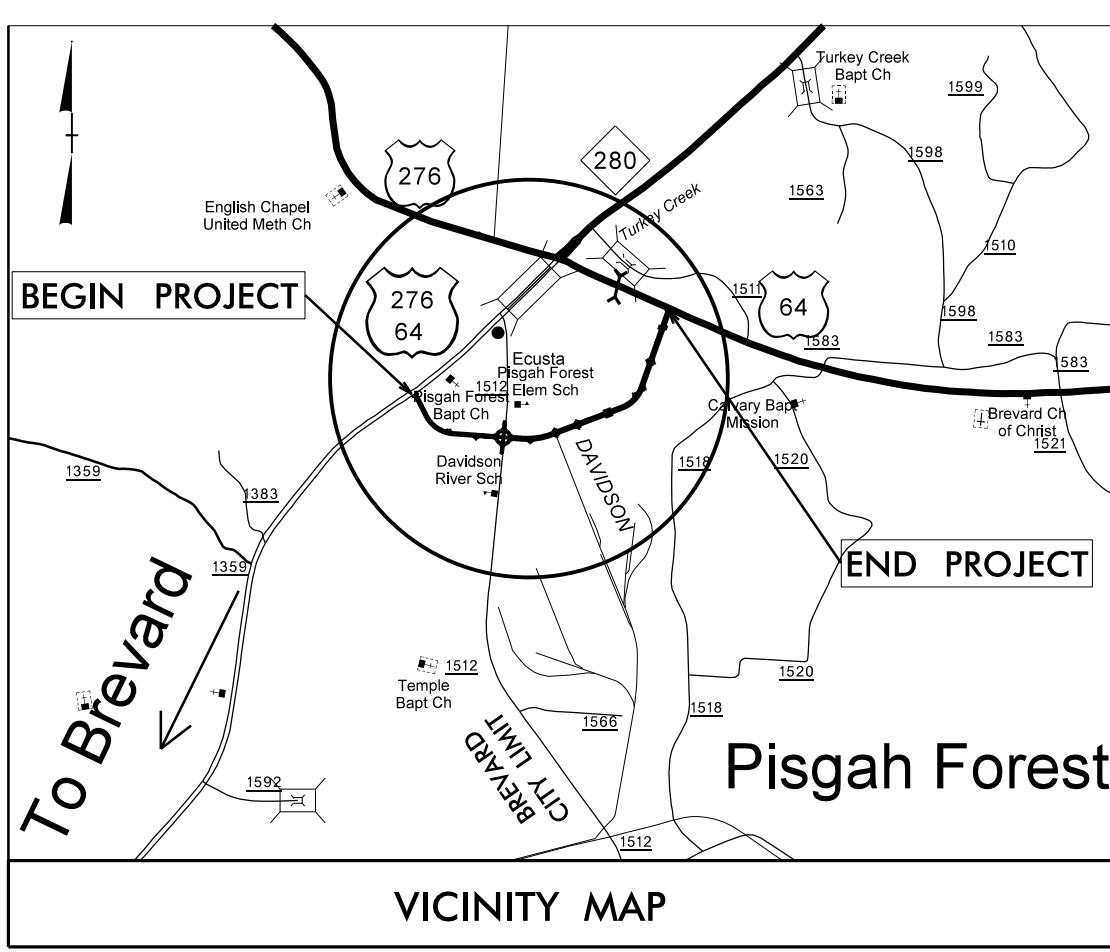

TIP PROJECT: R-5605

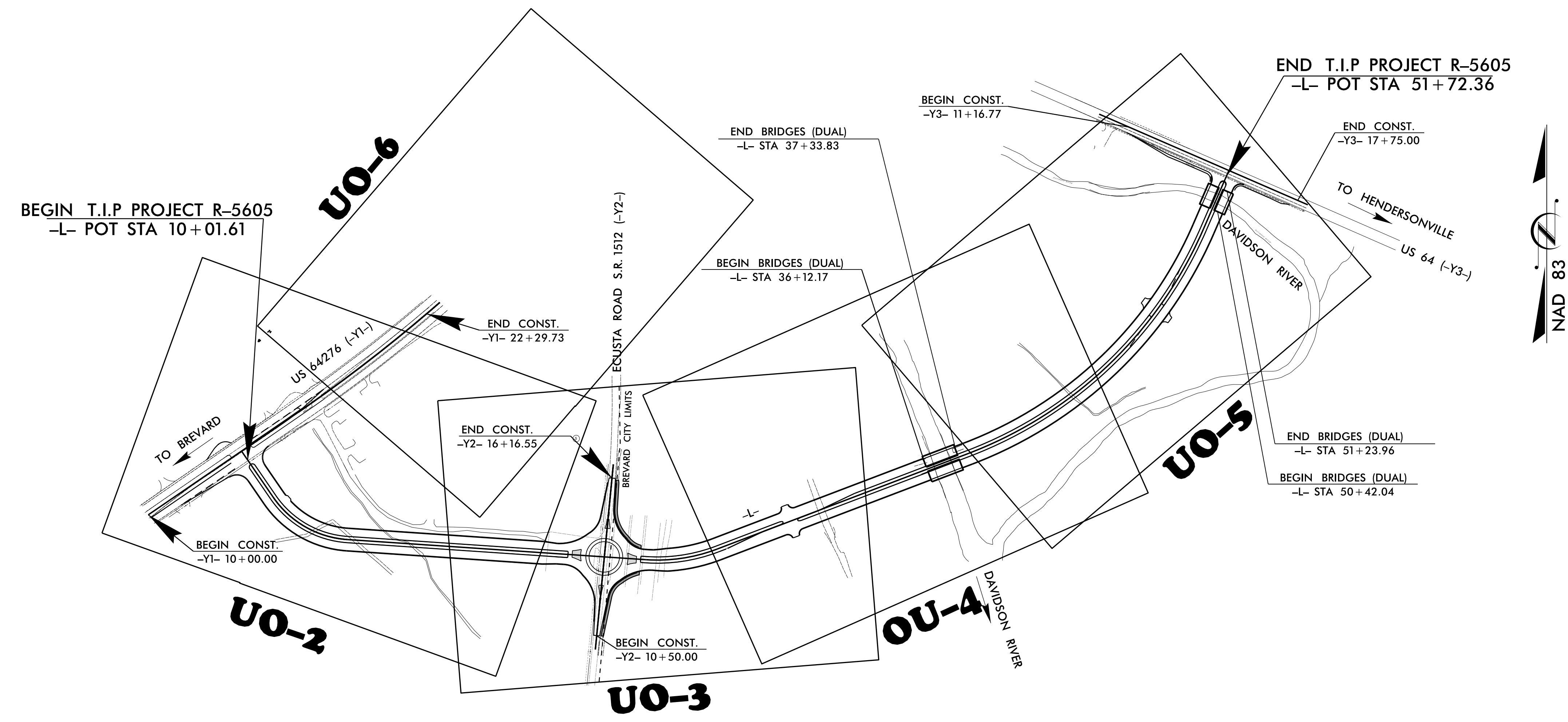

PLANS PREPARED BY :

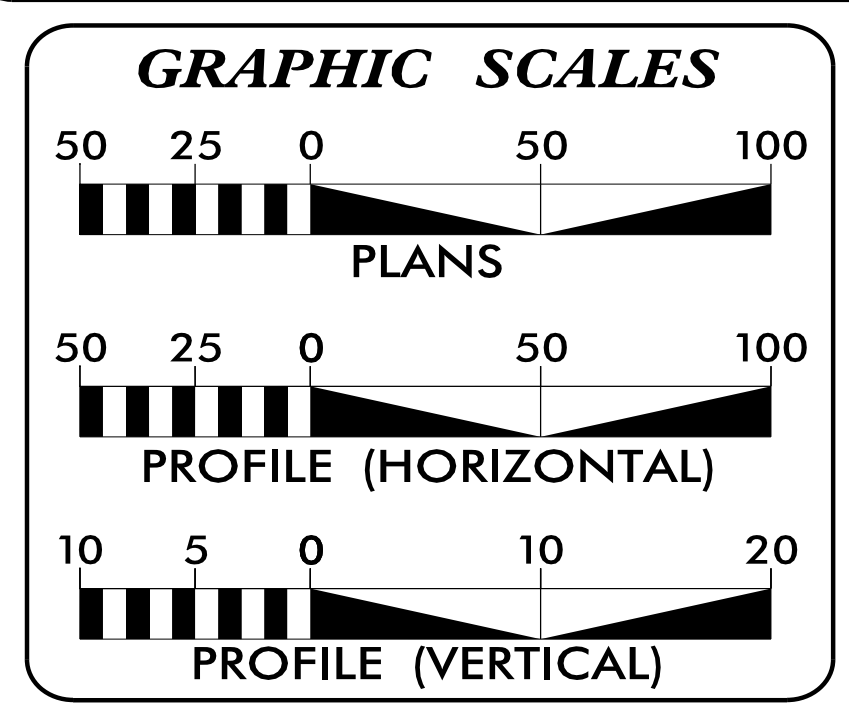
WGIA Engineering, PLLC
 214 N. King Street
 Hendersonville, NC 28792
 (828) 687-7177
 wgia.com
FOR
DIVISION OF HIGHWAYS



INDEX OF SHEETS

SHEET NO.	DESCRIPTION
UO-1	TITLE SHEET
UO-2 THRU UO-6	UTILITY BY OTHERS PLAN SHEETS

UTILITY OWNERS ON PROJECT

(A) POWER.....	DUKE ENERGY
(B) COMMUNICATIONS.....	COMPORIUM COMMUNICATIONS
(C) COMMUNICATIONS.....	NCDOT ITS
(D) NATURAL GAS.....	PSNC ENERGY
(E) WATER & SEWAGE.....	CITY OF BREVARD

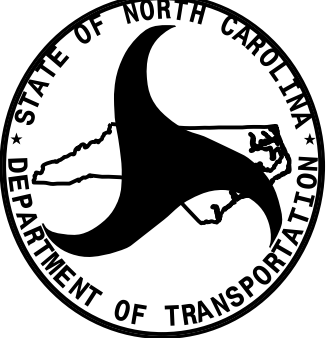
 **PREPARED IN THE OFFICE OF:**
DIVISION OF HIGHWAYS
UTILITIES UNIT
UTILITIES ENGINEERING
 1555 MAIL SERVICES CENTER
 RALEIGH, NC 27699-1555
 PHONE (919) 707-6690
 FAX (919) 250-4151

Roger Worthington, P.E. UTILITIES SECTION ENGINEER
Carl Barclay, P.E. UTILITIES SQUAD LEADER PROJECT ENGINEER
G. Thomas Jones III UTILITIES PROJECT DESIGNER

UTILITIES BY OTHERS

NOTE:
 ALL PROPOSED UTILITY WORK SHOWN ON THIS SHEET WILL BE DONE BY OTHERS. NO PAYMENT WILL BE MADE TO THE CONTRACTOR FOR PROPOSED UTILITY WORK SHOWN ON THIS SHEET.

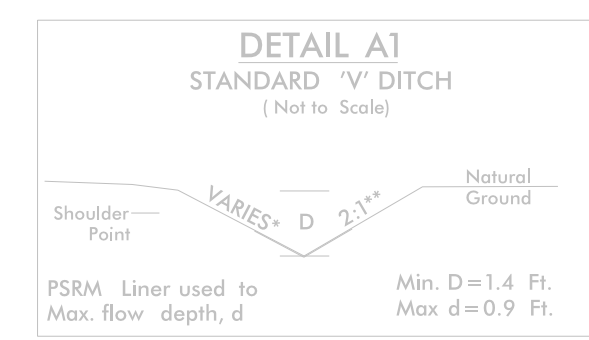
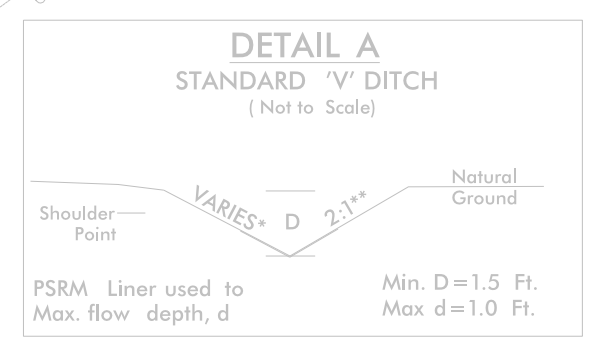
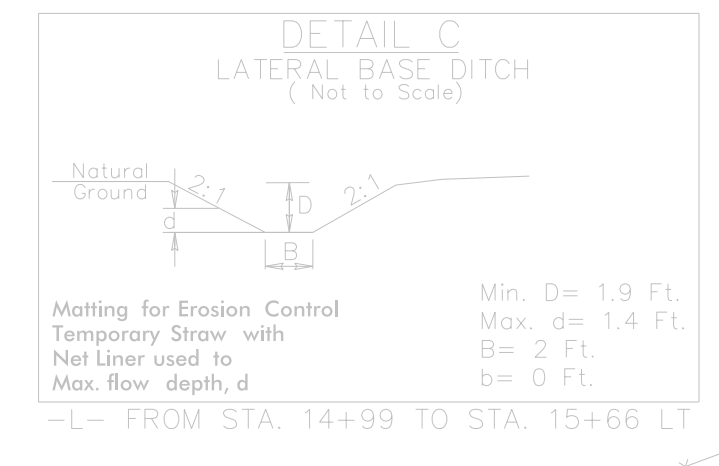
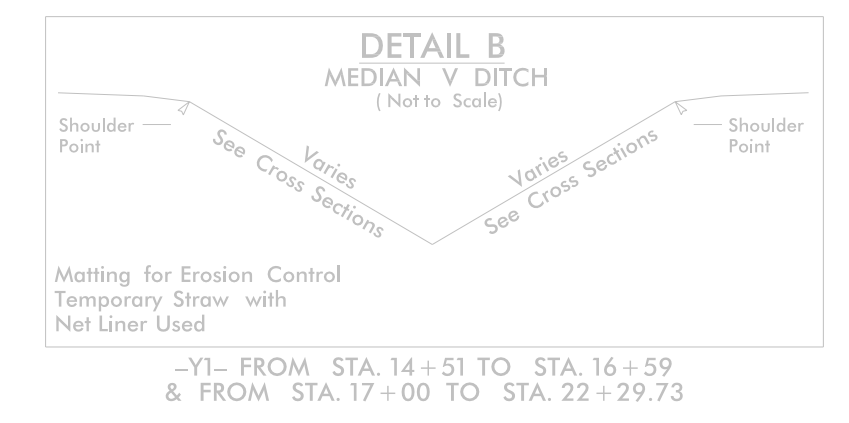
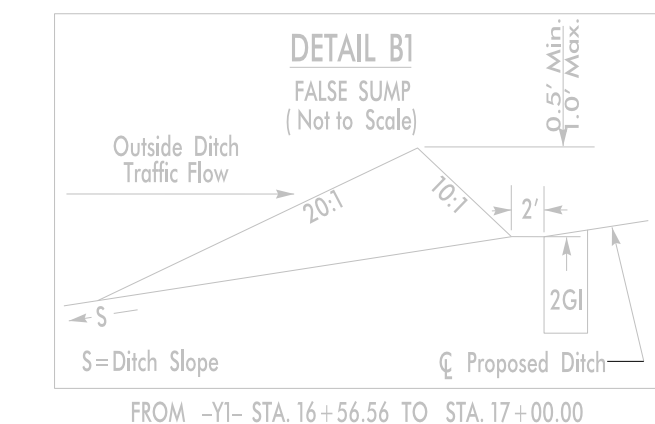
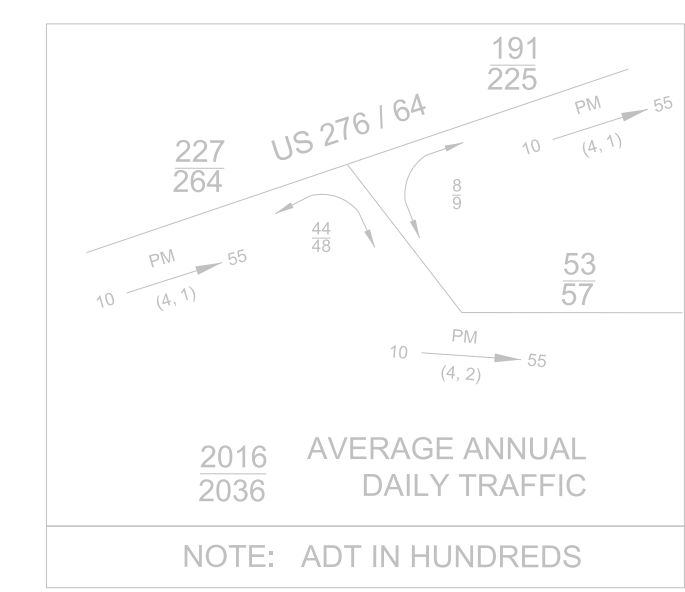

REMOVAL OF EXISTING PAVEMENT

SEE SHEET 9 FOR PROFILE
 PLANS PREPARED BY :
WGLA Engineering, PLLC
 214 N. King Street
 Hendersonville, NC 28792
 (828) 687-7177
 wglac.com
 FOR
DIVISION OF HIGHWAYS

5/14/99

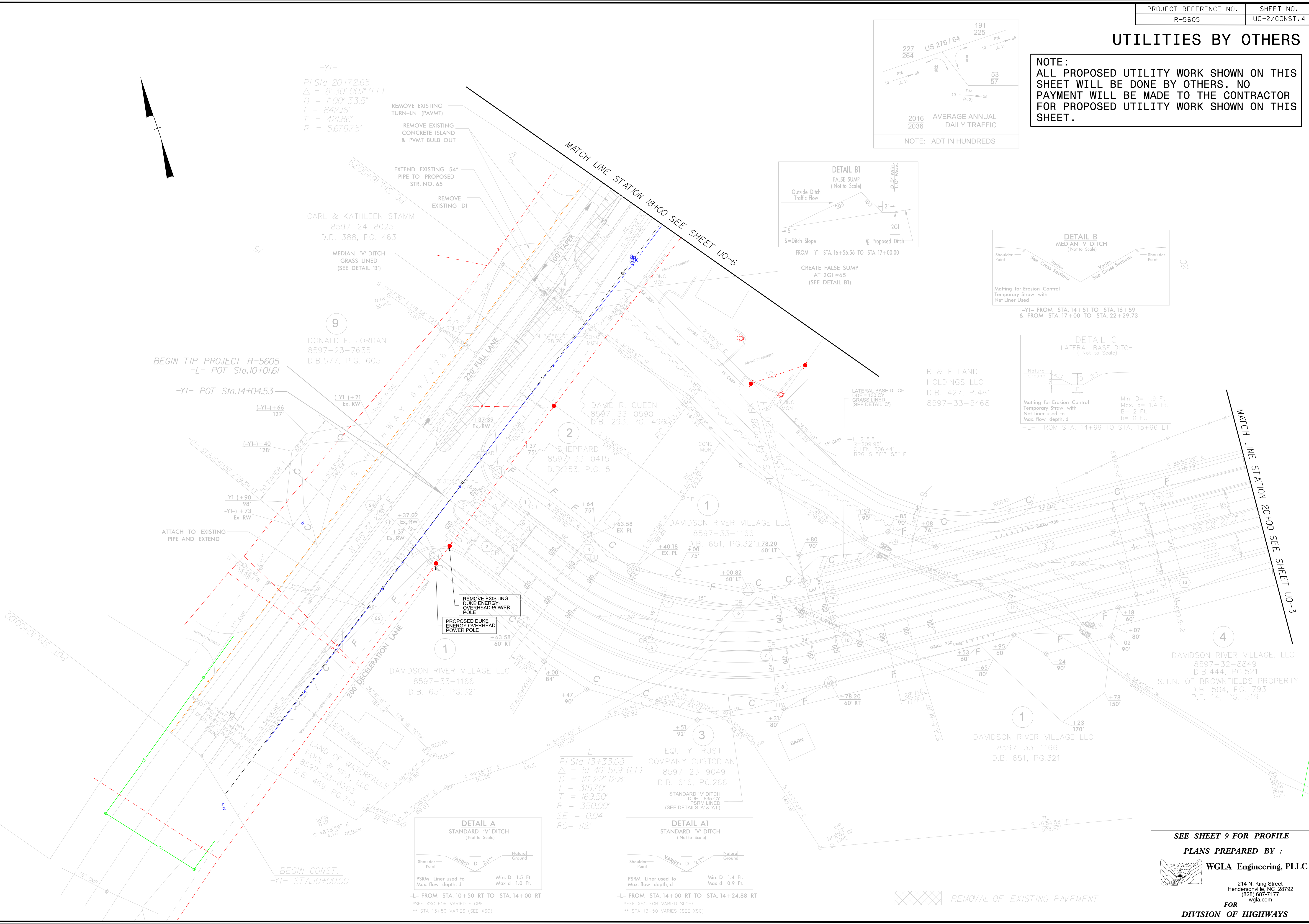

UTILITIES BY OTHERS

NOTE:
ALL PROPOSED UTILITY WORK SHOWN ON THIS SHEET WILL BE DONE BY OTHERS. NO PAYMENT WILL BE MADE TO THE CONTRACTOR FOR PROPOSED UTILITY WORK SHOWN ON THIS SHEET.

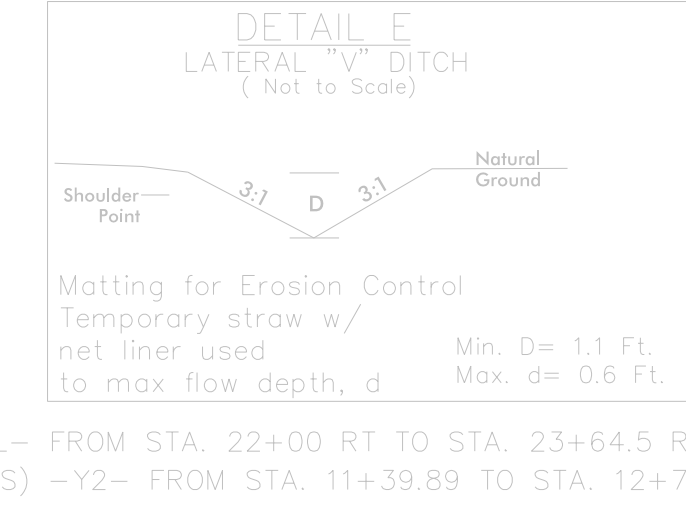
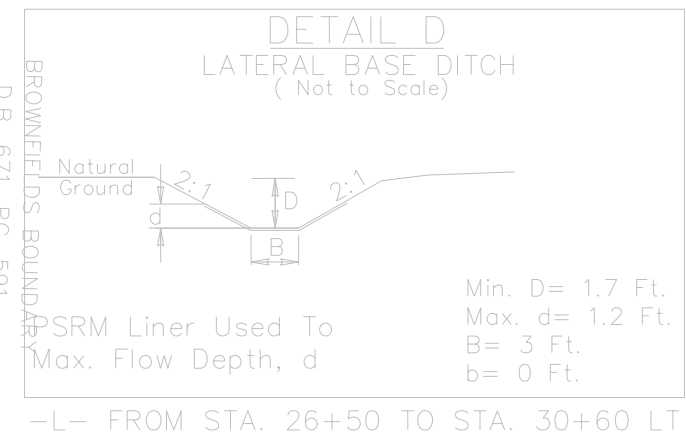

5/14/99
 65
64
63
62
61
60
59
58
57
56
55
54
53
52
51
50
49
48
47
46
45
44
43
42
41
40
39
38
37
36
35
34
33
32
31
30
29
28
27
26
25
24
23
22
21
20
19
18
17
16
15
14
13
12
11
10
9
8
7
6
5
4
3
2
1

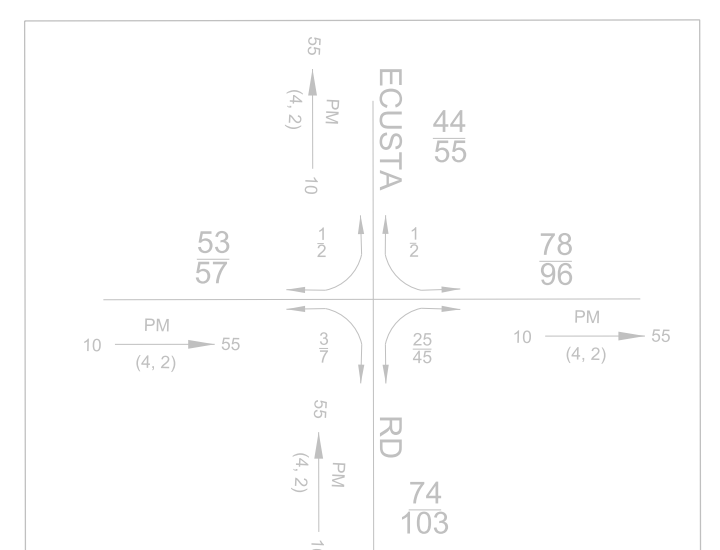
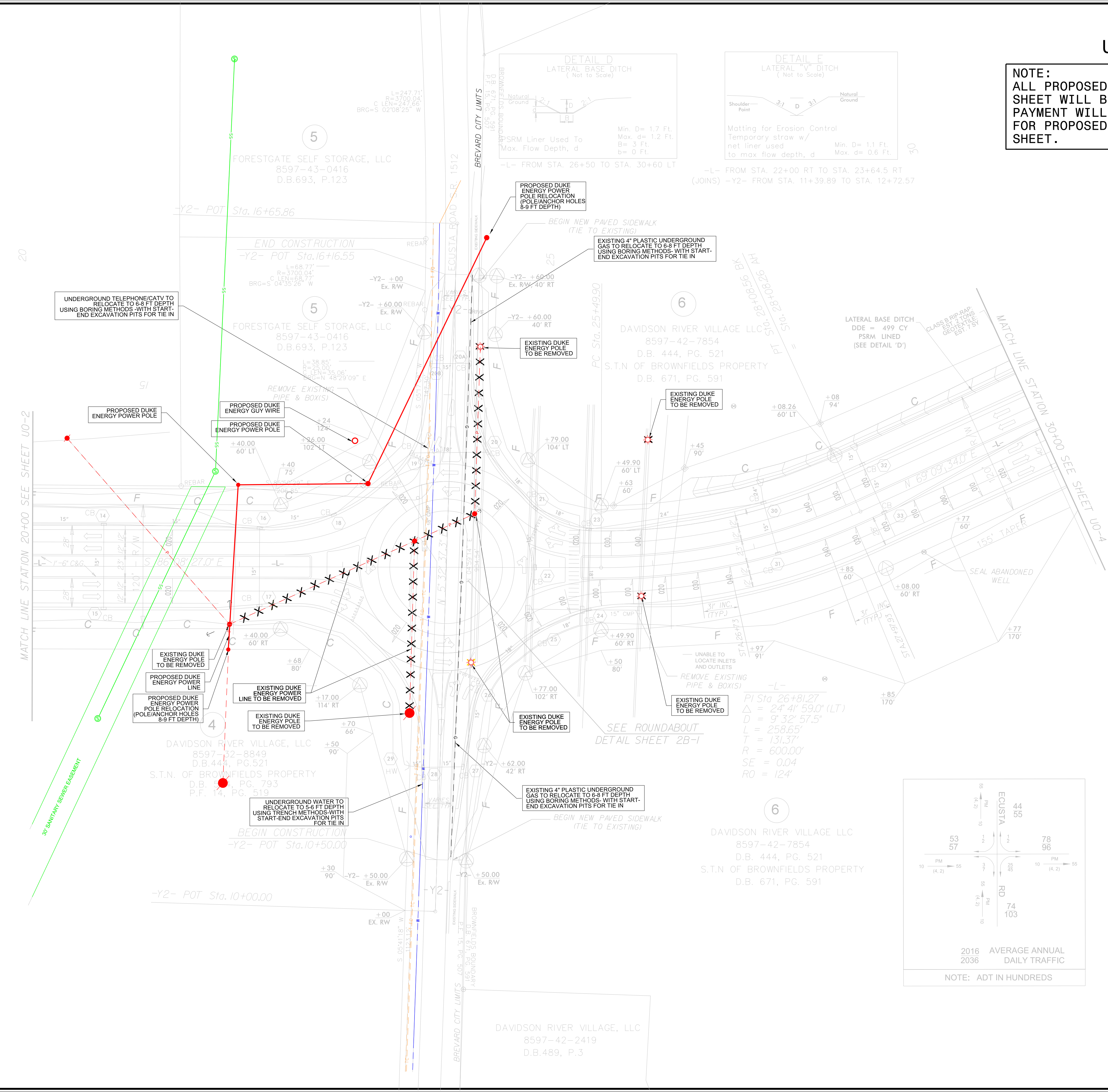
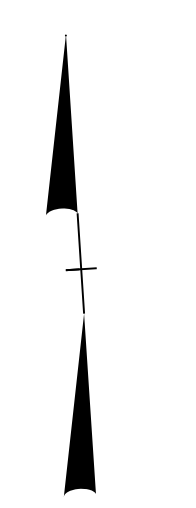

2016 AVERAGE ANNUAL
 2036 DAILY TRAFFIC

NOTE: ADT IN HUNDREDS

PLANS PREPARED BY :
WGLA Engineering, PLLC

214 N. King Street
 Hendersonville, NC 28792
 (828) 687-7177
 wglac.com

FOR
DIVISION OF HIGHWAYS

UTILITIES BY OTHERS

NOTE:
ALL PROPOSED UTILITY WORK SHOWN ON THIS SHEET WILL BE DONE BY OTHERS. NO PAYMENT WILL BE MADE TO THE CONTRACTOR FOR PROPOSED UTILITY WORK SHOWN ON THIS SHEET.

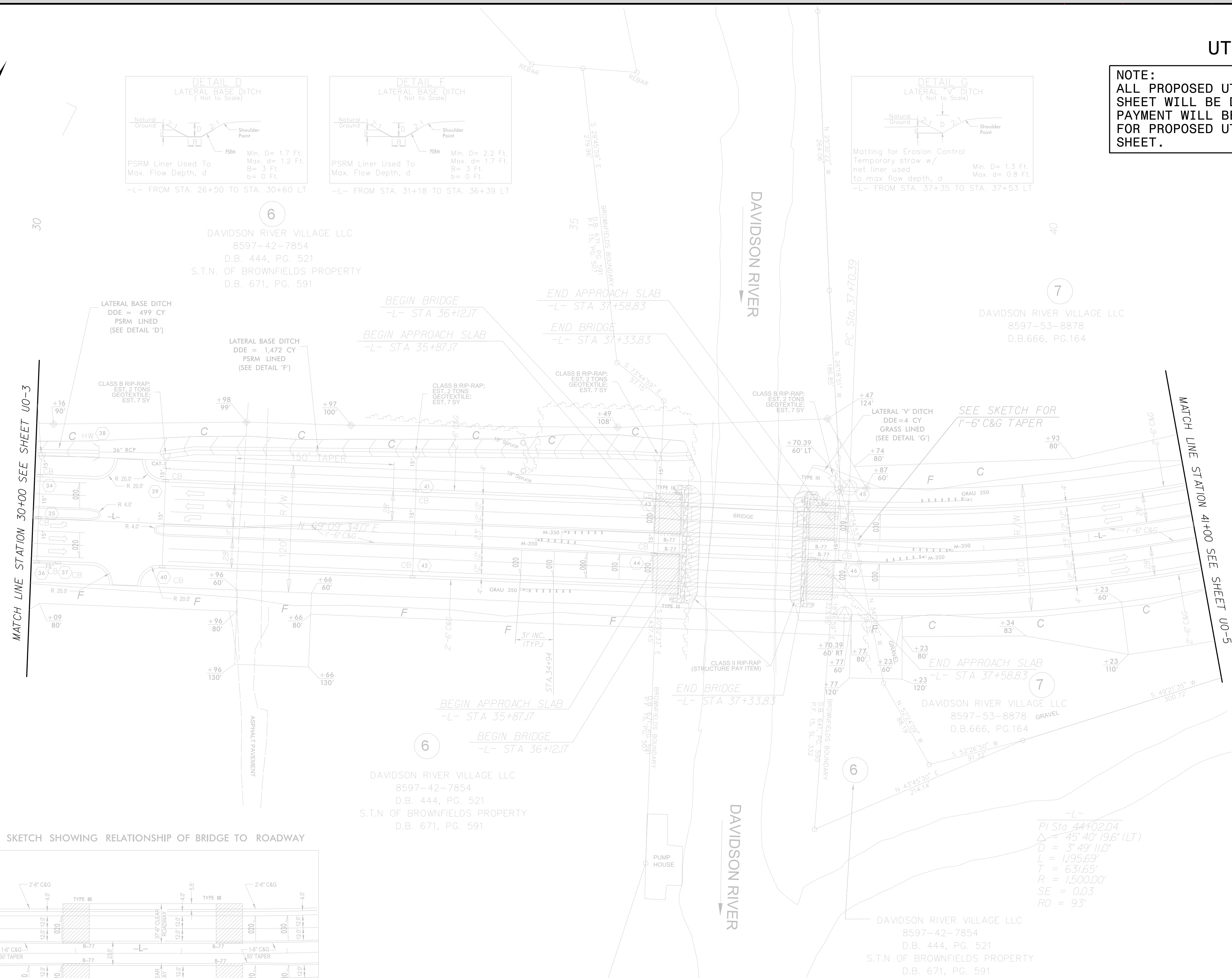
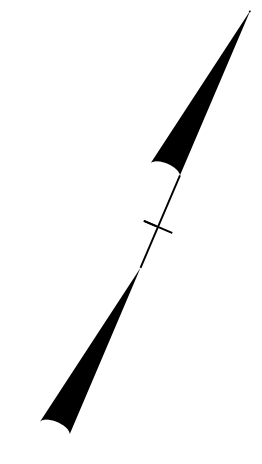
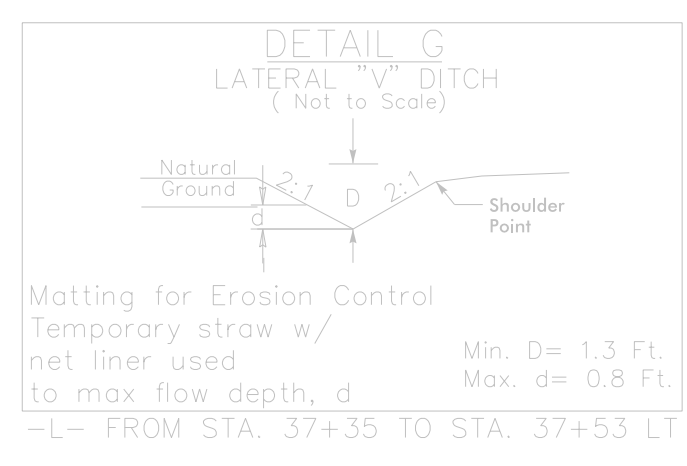
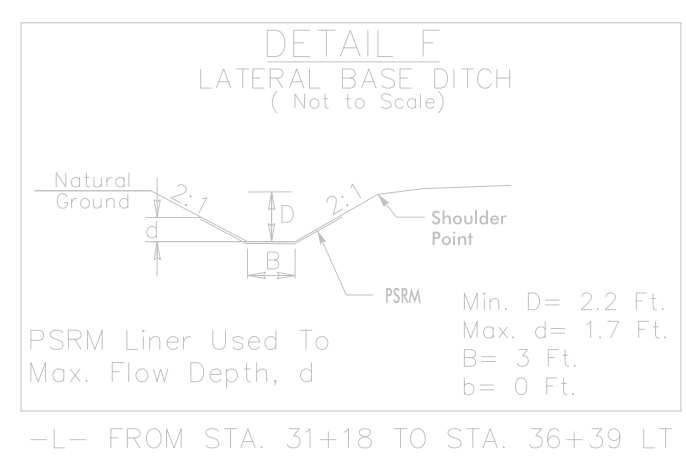
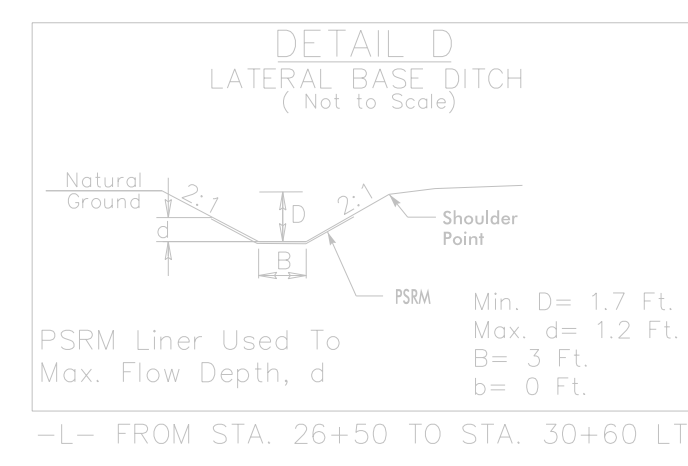

SKETCH SHOWING RELATIONSHIP OF BRIDGE TO ROADWAY

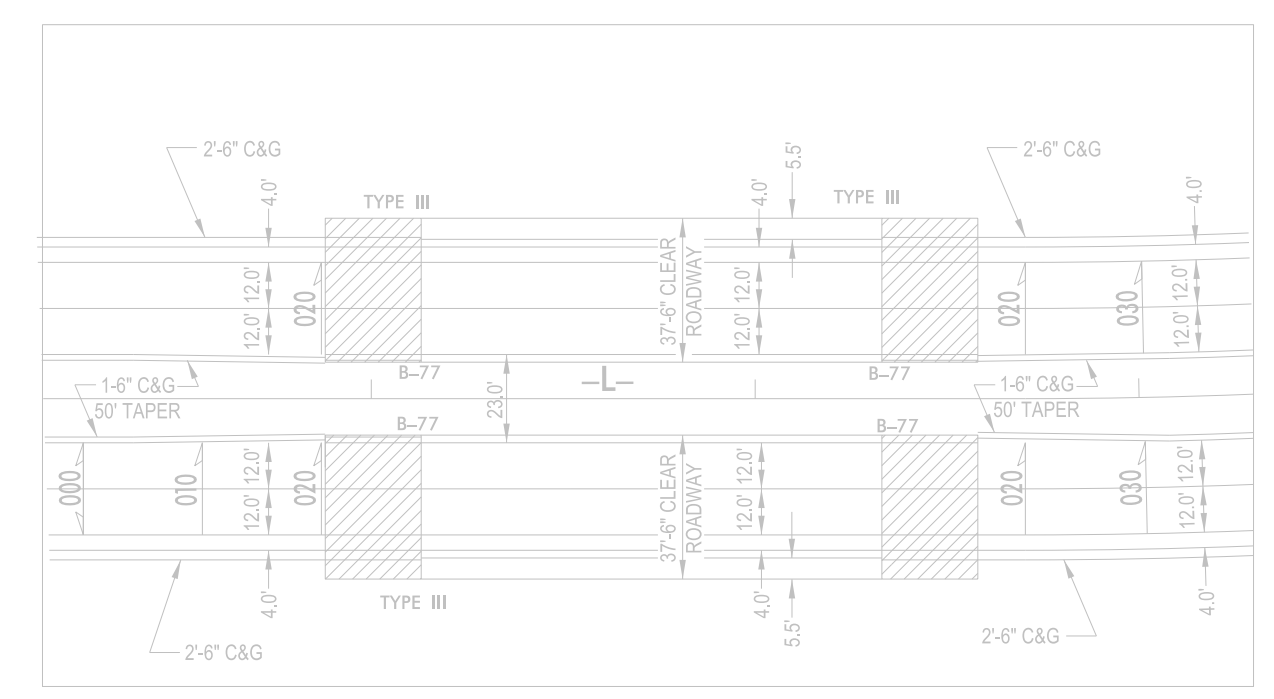

DAVIDSON RIVER VILLAGE LLC
8597-42-7854
D.B. 444, PG. 521
S.T.N OF BROWNFIELDS PROPERTY
D.B. 671, PG. 591

DAVIDSON RIVER VILLAGE LLC
8597-42-7854
D.B. 444, PG. 521
S.T.N OF BROWNFIELDS PROPERTY
D.B. 671, PG. 591

-L-
PI Sta. 44+02.04
 $\Delta = 45^{\circ} 40' 19.6''$ (LT)
D = 3' 49' 11.0"
L = 1,195.69'
T = 631.65'
R = 1,500.00'
SE = 0.03
RO = 93'

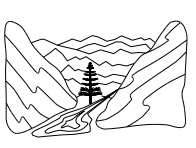
PLANS PREPARED BY :

WGLA Engineering, PLLC
 214 N. King Street
 Hendersonville, NC 28792
 (828) 687-7177
 wgl.com
FOR
DIVISION OF HIGHWAYS

5/14/99

UTILITIES BY OTHERS

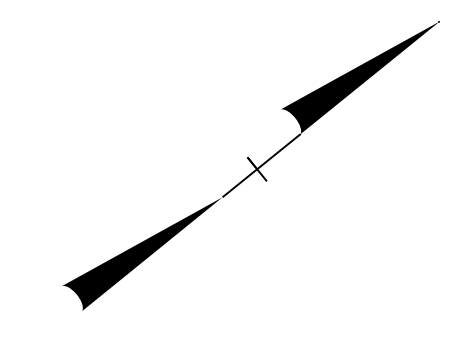
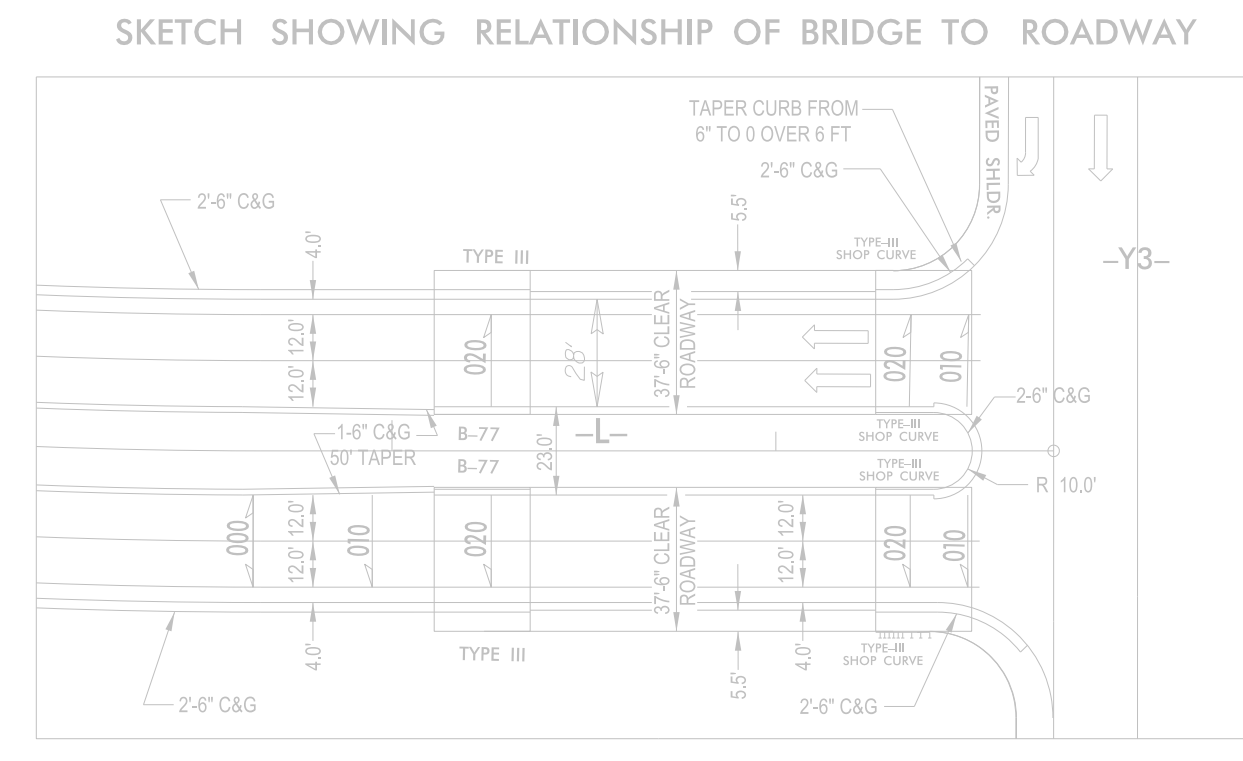
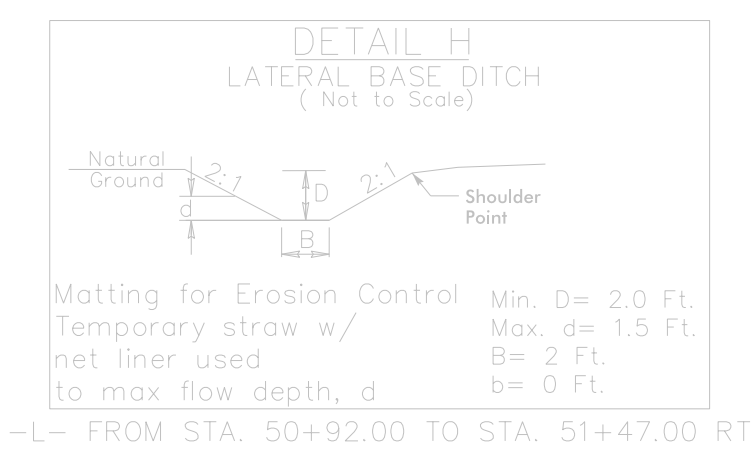
NOTE:
 ALL PROPOSED UTILITY WORK SHOWN ON THIS SHEET WILL BE DONE BY OTHERS. NO PAYMENT WILL BE MADE TO THE CONTRACTOR FOR PROPOSED UTILITY WORK SHOWN ON THIS SHEET.



MATCH LINE STATION 4+00 SEE SHEET UD-4

5/14/99

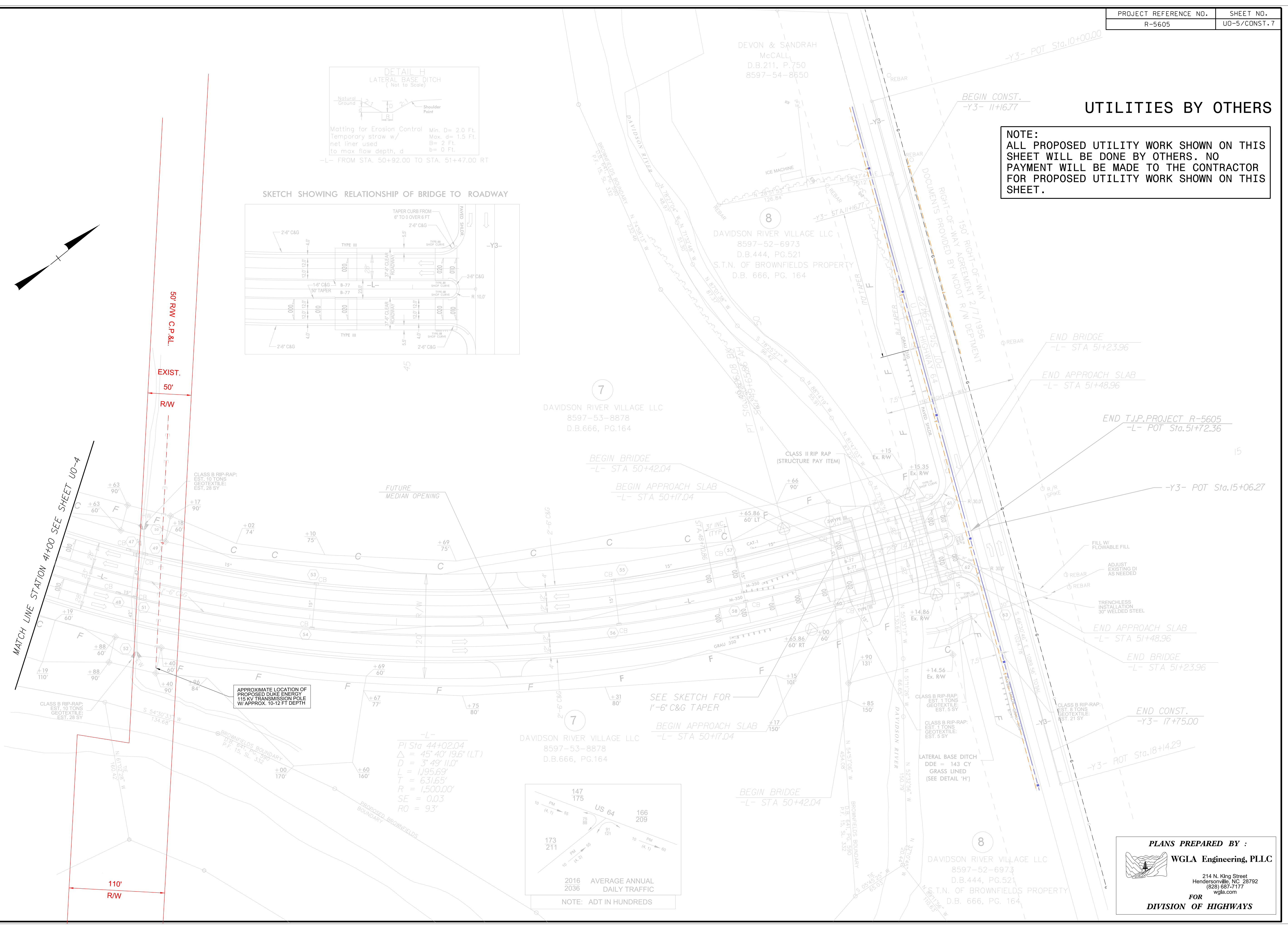

APPROXIMATE LOCATION OF PROPOSED DUKE ENERGY 115 KV TRANSMISSION POLE W/ APPROX. 10-12 FT DEPTH

-L-
 PI Sta 44+02.04
 $\Delta = 45^{\circ} 40' 19.6''$ (LT)
 $D = 3^{\circ} 49' 11.0''$
 $L = 1195.69'$
 $T = 631.65'$
 $R = 1,500.00'$
 $SE = 0.03$
 $RO = 93'$

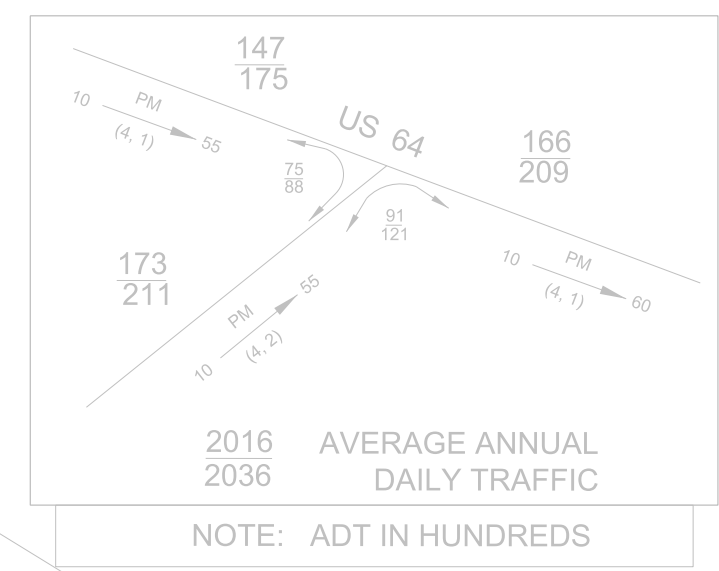

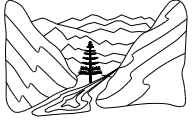
PLANS PREPARED BY :

WGJA Engineering, PLLC
 214 N. King Street
 Hendersonville, NC 28792
 (828) 687-7177
 wgja.com
FOR
DIVISION OF HIGHWAYS

UTILITIES BY OTHERS

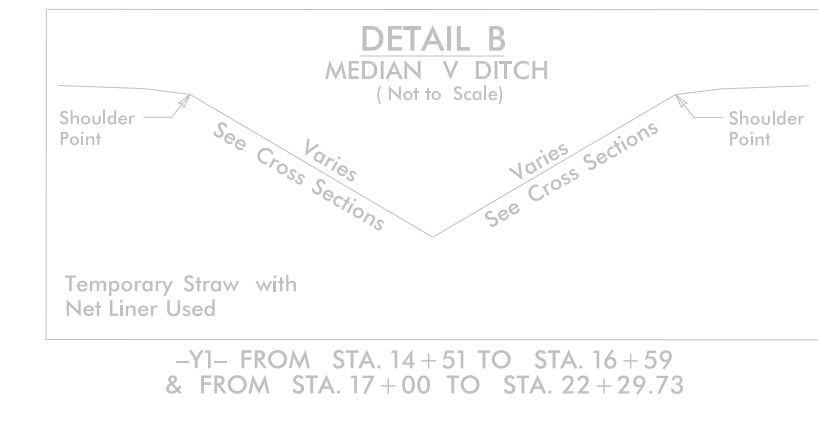
NOTE:
ALL PROPOSED UTILITY WORK SHOWN ON THIS SHEET WILL BE DONE BY OTHERS. NO PAYMENT WILL BE MADE TO THE CONTRACTOR FOR PROPOSED UTILITY WORK SHOWN ON THIS SHEET.



MATCH LINE STATION 18+00 SEE SHEET UO-2

-Y1-
PI Sta 20+72.65
 $\Delta = 8' 30' 00.1''$ (LT)
D = 1'00' 33.5"
L = 842.17'
T = 421.86'
R = 5,676.75'

-Y1-
PI Sta 25+85.21
 $\Delta = 1' 57' 17.9''$ (LT)
D = 1'03' 34.6"
L = 184.50'
T = 92.26'
R = 5,407.22'

PLANS PREPARED BY :

WGLA Engineering, PLLC
 214 N. King Street
 Hendersonville, NC 28792
 (828) 687-7177
 wglac.com
FOR
DIVISION OF HIGHWAYS

5/14/99