

PLAN

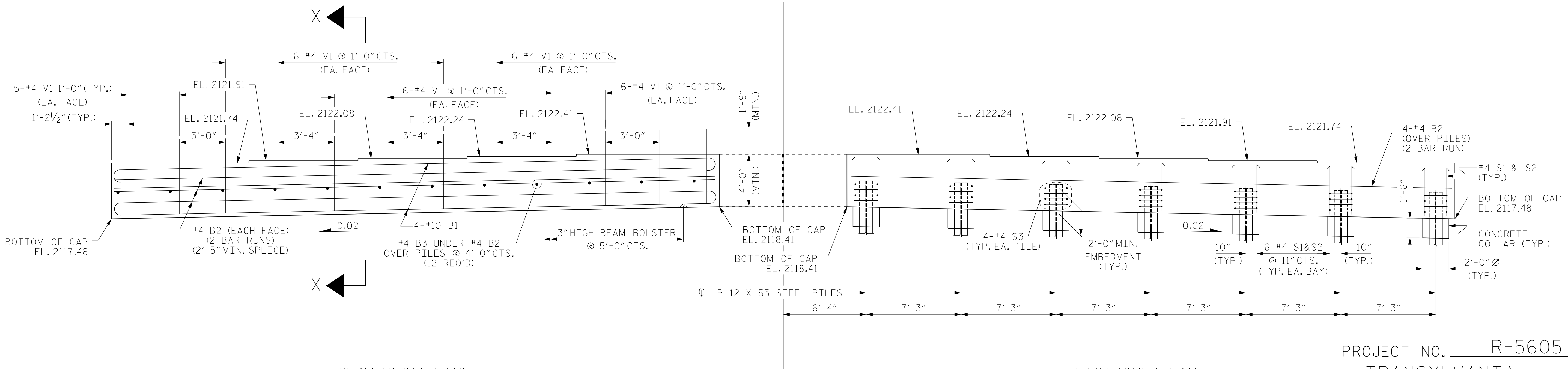

ELEVATION

PROJECT NO. R-5605  
 TRANSYLVANIA COUNTY  
 STATION: 50+83.00 -L-

NOTES

- STIRRUPS IN CAP MAY BE SHIFTED AS NECESSARY TO CLEAR V1 BARS.
- FOR PILE SPLICE DETAILS, SEE SHEET 4 OF 4.
- FOR WING DETAILS, SEE SHEET 3 OF 4.
- THE TOP OF THE END BENT CAP, EXCEPT THE BEARING AREA, SHALL BE RAKED TO A DEPTH OF 1/4".

FOR WINGS SEE SHEET 3 OF 4.  
 FOR SECTION X-X, SEE SHEET 4 OF 4.  
 CONCRETE COLLARS FOR STEEL PILES NOT SHOWN IN PLAN AND ELEVATION VIEWS FOR CLARITY.  
 SEE "CORROSION PROTECTION FOR STEEL PILES DETAIL", SHEET 4 OF 4.

DRAWN BY : PEC DATE : 8/15  
 CHECKED BY : CMT DATE : 8/15

Prepared in the Office of:  
  
**Mattern & Craig**  
 CONSULTING ENGINEERS & SURVEYORS  
 FIRM LICENSE NO. C-1154  
 12 BROAD STREET  
 ASHEVILLE, NORTH CAROLINA 28801  
 (828) 254-2201 - FAX (828) 254-4582

DocuSigned by:  
  
 Steven A. Campbell  
 12/21/2015

SHEET 2 OF 4

REVISIONS						SHEET NO.
NO.	BY:	DATE:	NO.	BY:	DATE:	S-45
1			3			TOTAL SHEETS
2			4			51

STATE OF NORTH CAROLINA  
 DEPARTMENT OF TRANSPORTATION  
 RALEIGH  
 SUBSTRUCTURE  
 END BENT No. 2  
 (INTEGRAL)