

SUPERSTRUCTURE REINFORCING STEEL LENGTHS ARE BASED ON THE FOLLOWING MINIMUM SPLICE LENGTHS

BAR SIZE	SUPERSTRUCTURE EXCEPT APPROACH SLABS, PARAPET, AND BARRIER RAIL		APPROACH SLABS		PARAPET AND BARRIER RAIL
	EPOXY COATED	UNCOATED	EPOXY COATED	UNCOATED	
#4	2'-0"	1'-9"	2'-0"	1'-9"	2'-9"
#5	2'-6"	2'-2"	2'-6"	2'-2"	3'-5"
#6	3'-0"	2'-7"	3'-10"	2'-7"	4'-4"
#7	5'-3"	3'-6"			
#8	6'-10"	4'-7"			

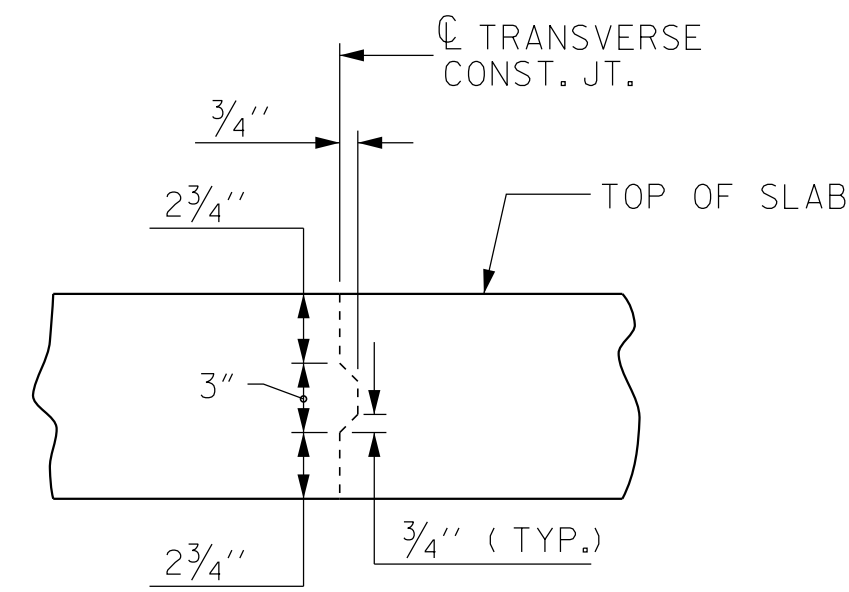

TRANSVERSE CONSTRUCTION JOINT DETAIL

NOTE: REINFORCING STEEL IN SLAB NOT SHOWN. LONGITUDINAL REINFORCING STEEL SHALL BE CONTINUOUS THRU JOINT

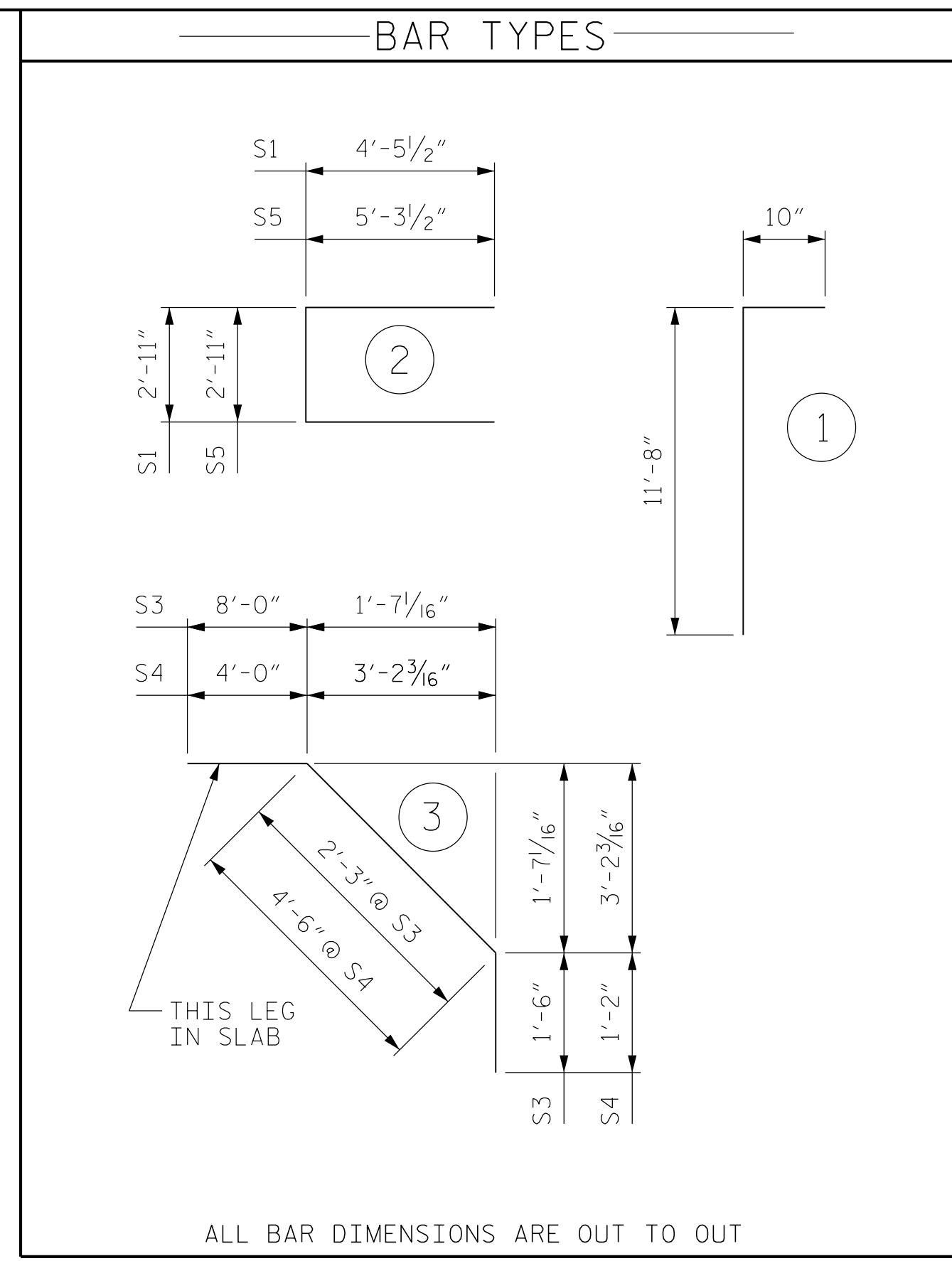

BILL OF MATERIAL

BAR	NO.	SIZE	TYPE	LENGTH	WEIGHT
* A3	296	#5	STR	40'-0"	12358
A4	296	#5	STR	40'-0"	12358
* B3	174	#4	STR	28'-7"	3323
* B4	112	#8	STR	16'-6"	4938
B5	32	#5	STR	41'-10"	1398
B6	144	#5	STR	41'-10"	6288
* B7	24	#4	STR	28'-7"	459
* D1	104	#4	STR	0'-10"	58
* G1	162	#4	STR	6'-2"	668
H1	88	#5	1	12'-6"	1149
H2	88	#6	STR	9'-0"	1191
K1	40	#4	STR	24'-0"	642
K2	32	#4	STR	5'-10"	125
K3	48	#4	STR	7'-4"	236
K5	16	#4	STR	5'-1"	55
K6	24	#4	STR	5'-10"	94
K8	16	#4	STR	2'-8"	29
S1	120	#4	2	11'-10"	949
* S3	120	#4	3	11'-9"	942
* S4	96	#4	3	9'-8"	620
S5	24	#4	2	13'-6"	217

* DENOTES EPOXY COATED REINF. STEEL

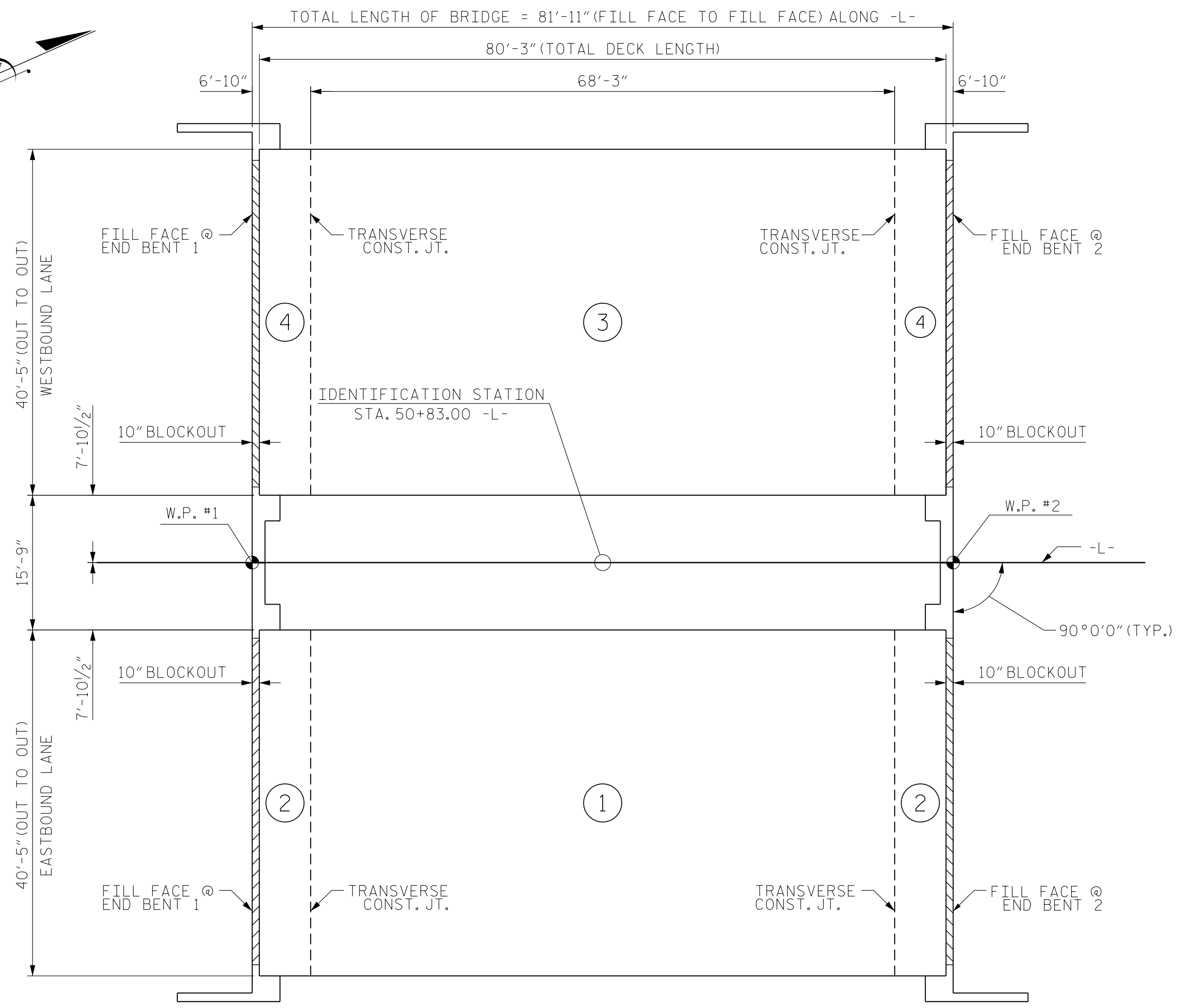
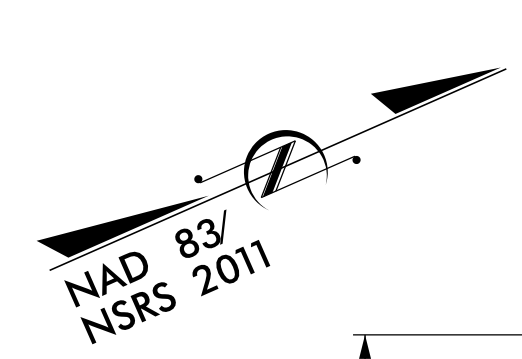

POURING SEQUENCE AND LAYOUT FOR COMPUTING AREA REINFORCED CONCRETE DECK SLAB (SQ. FT. = 6,622)

—SUPERSTRUCTURE BILL OF MATERIAL—

	CLASS AA CONCRETE (CU. YDS.)	REINFORCING STEEL (LBS.)	EPOXY COATED REINFORCING STEEL (LBS.)
POUR 1	79.7		
POUR 2	69.6		
POUR 3	79.7		
POUR 4	69.6		
POUR 5 *	14.4		
POUR 6 *	14.4		
TOTALS**	327.4	24,731	23,366

* QUANTITIES FOR POUR 5 AND POUR 6 ARE FOR THE SIDEWALKS ON EACH SIDE OF THE STRUCTURE.
 ** QUANTITIES FOR BARRIER RAIL AND THE END POSTS FOR THE METAL RAILS ARE NOT INCLUDED.

NOTE: THE UPPER PORTION OF THE END BENT WINGS SHALL BE POURED WITH THE SUPERSTRUCTURE.

GROOVING BRIDGE FLOORS

APPROACH SLABS	2,900 SQ.FT.
BRIDGE DECK	4,655 SQ.FT.
TOTAL	7,555 SQ.FT.

PROJECT NO. R-5605
 TRANSYLVANIA COUNTY
 STATION: 50+83.00 -L-

STATE OF NORTH CAROLINA
 DEPARTMENT OF TRANSPORTATION
 RALEIGH
 SUPERSTRUCTURE
 BILL OF MATERIAL
 & POUR SEQUENCE

ASSEMBLED BY :	PFC	DATE :	8/15
CHECKED BY :	CMT	DATE :	8/15
DRAWN BY :	JMB 5/87	REV. 8/16/99	RWW/LES
CHECKED BY :	SJD 9/87	REV. 5/1/06	TLA/GM
		REV. 10/1/11	MAA/GM

Prepared in the Office of:

Mattern & Craig
 CONSULTING ENGINEERS & SURVEYORS
 FIRM LICENSE NO. C-1154
 12 BROAD STREET
 ASHEVILLE, NORTH CAROLINA 28801
 (828) 254-2201 - FAX (828) 254-4582

DocuSigned by:
Steven A. Campbell 12/21/2015

REVISIONS						SHEET NO.
NO.	BY:	DATE:	NO.	BY:	DATE:	S-43
1			3			TOTAL SHEETS
2			4			51