

PLAN

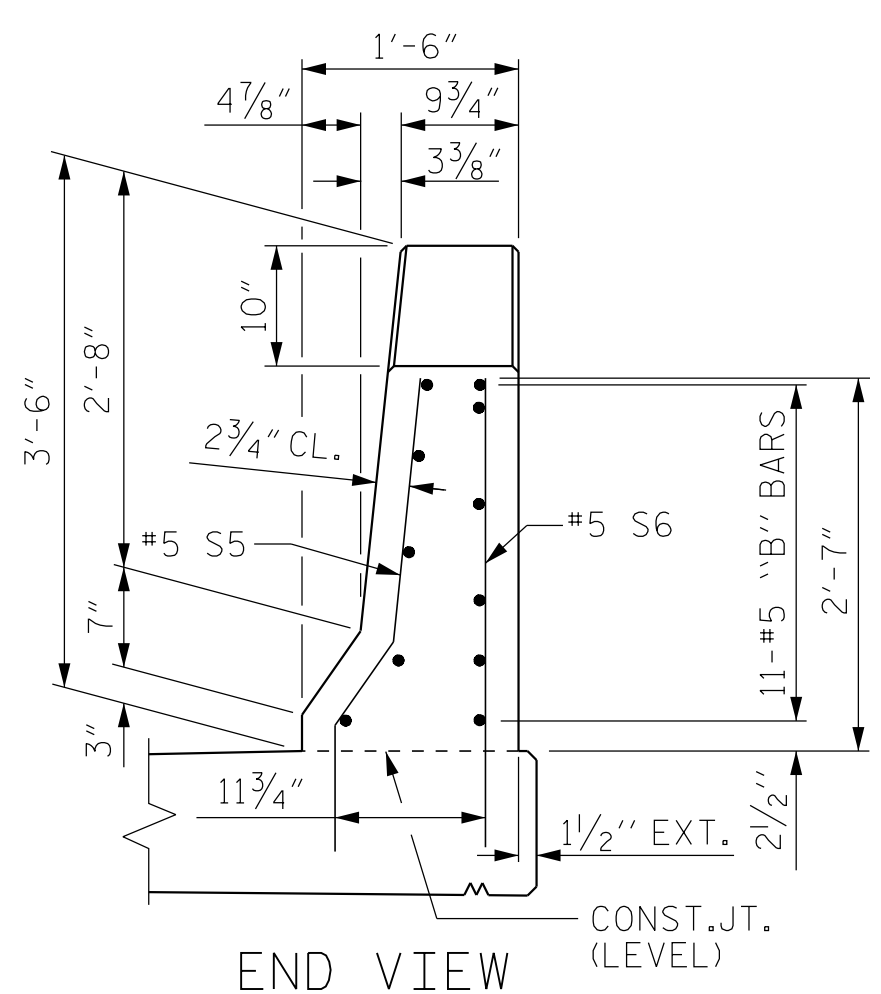

END VIEW

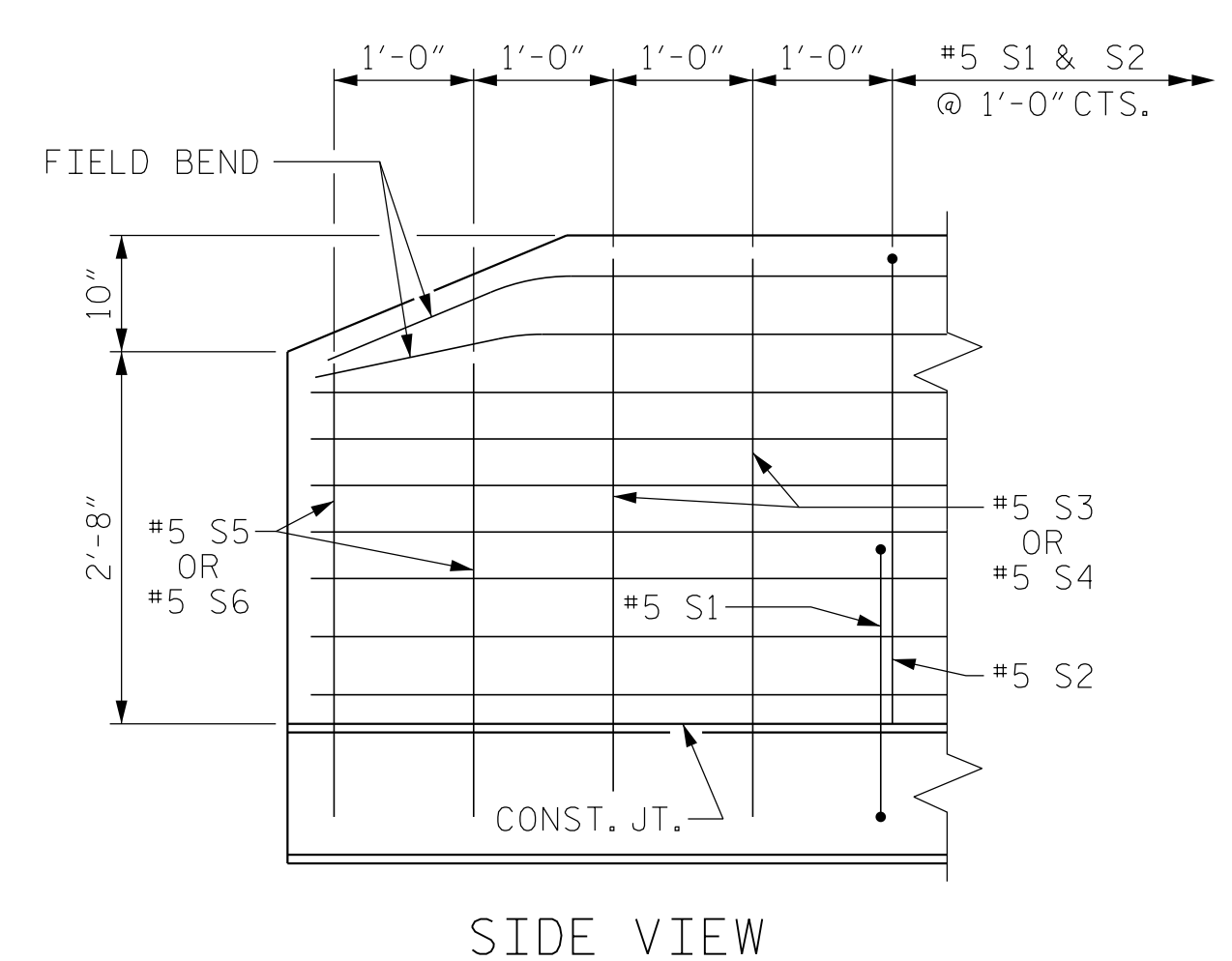

SIDE VIEW

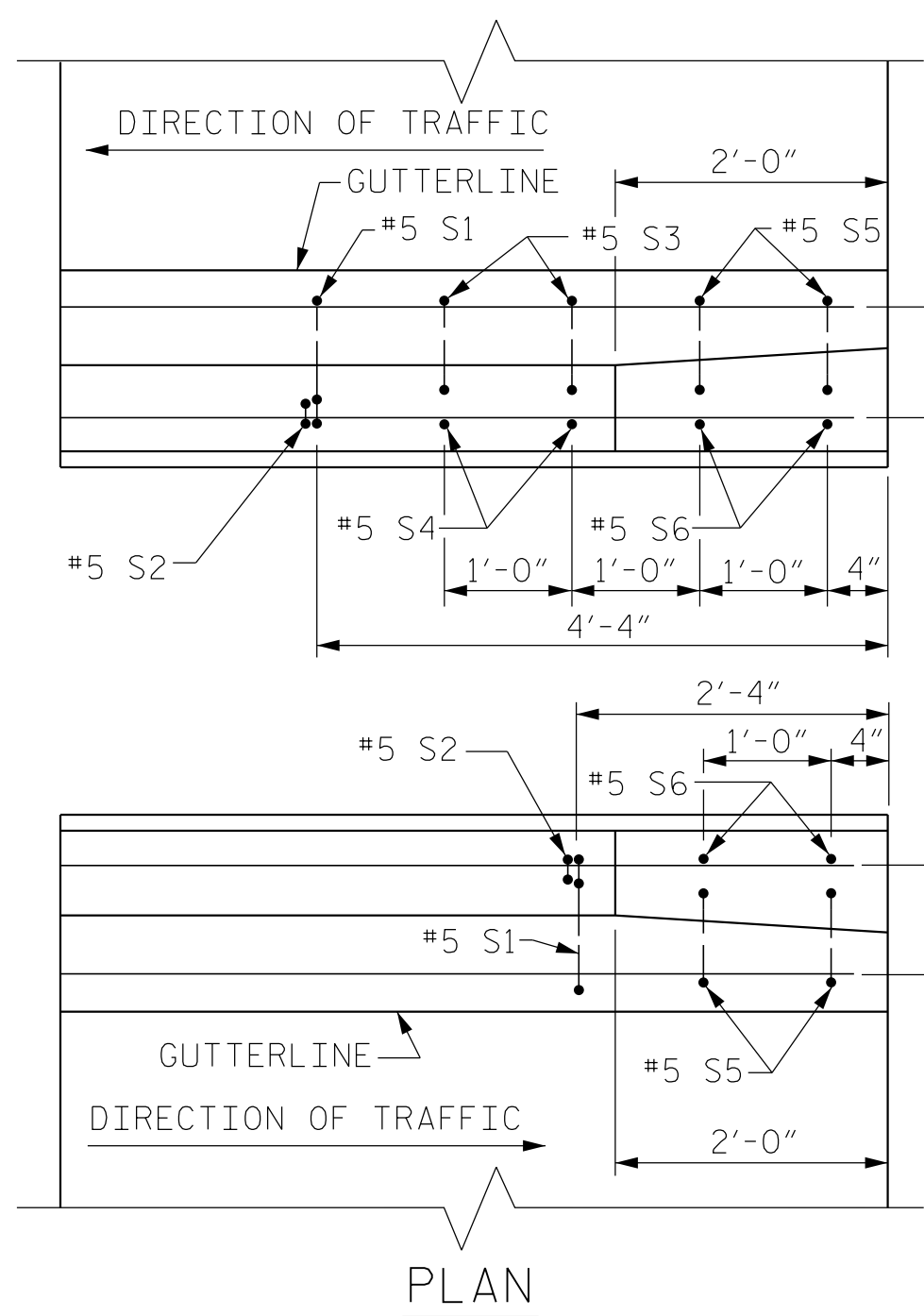

PLAN

NOTES

THE BARRIER RAIL IN THE SPAN SHALL NOT BE CAST UNTIL ALL SLAB CONCRETE IN THAT SPAN HAS BEEN CAST AND HAS REACHED A MINIMUM COMPRESSIVE STRENGTH OF 3,000 PSI.

ALL REINFORCING STEEL IN BARRIER RAILS SHALL BE EPOXY COATED.

GROOVED CONTRACTION JOINTS, 1/2" IN DEPTH, SHALL BE TOOLED IN ALL EXPOSED FACES OF THE BARRIER RAIL AND IN ACCORDANCE WITH ARTICLE 825-10(B) OF THE STANDARD SPECIFICATIONS. THE CONTRACTION JOINT SHALL BE LOCATED AT EACH THIRD POINT BETWEEN BARRIER RAIL EXPANSION JOINTS. ONLY ONE CONTRACTION JOINT IS REQUIRED AT MIDPOINT OF BARRIER RAIL SEGMENTS LESS THAN 20 FEET IN LENGTH AND NO CONTRACTION JOINTS ARE REQUIRED FOR THOSE SEGMENTS LESS THAN 10 FEET IN LENGTH.

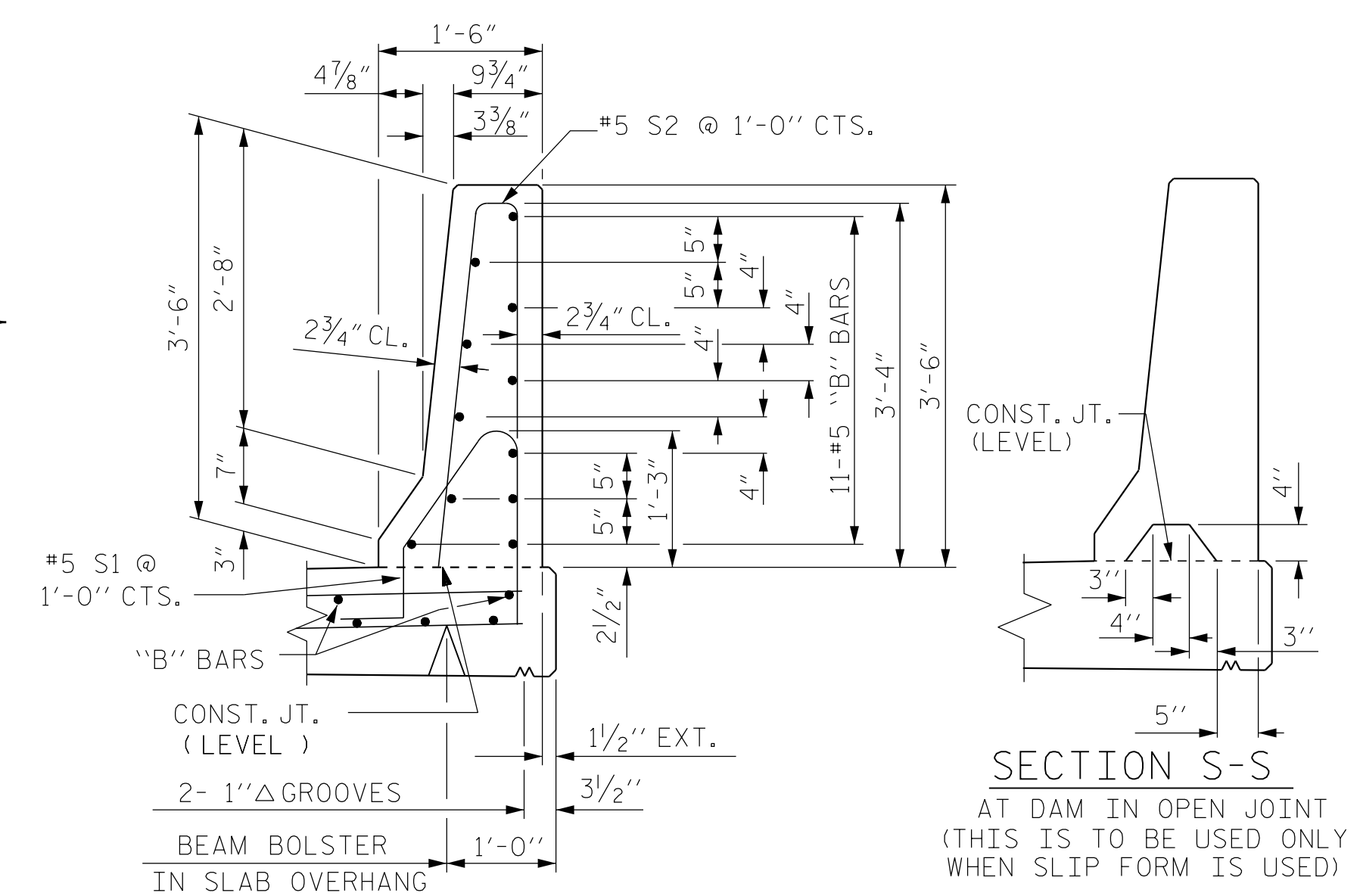

SECTION THRU RAIL

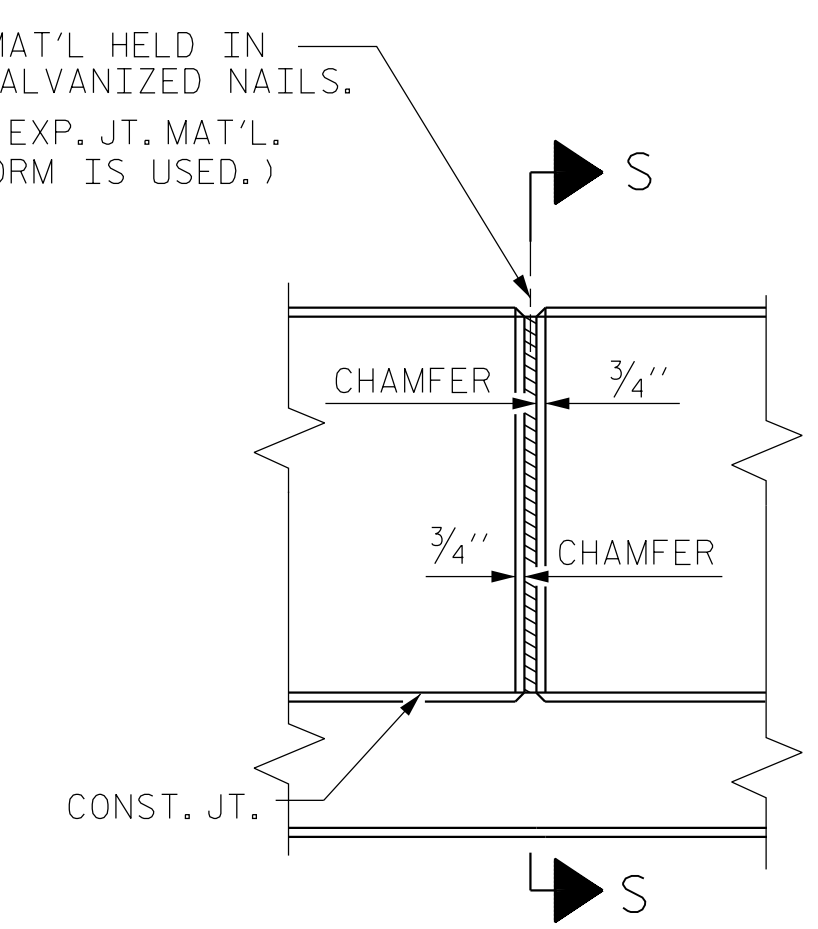

ELEVATION AT EXPANSION JOINTS  
BARRIER RAIL DETAILS

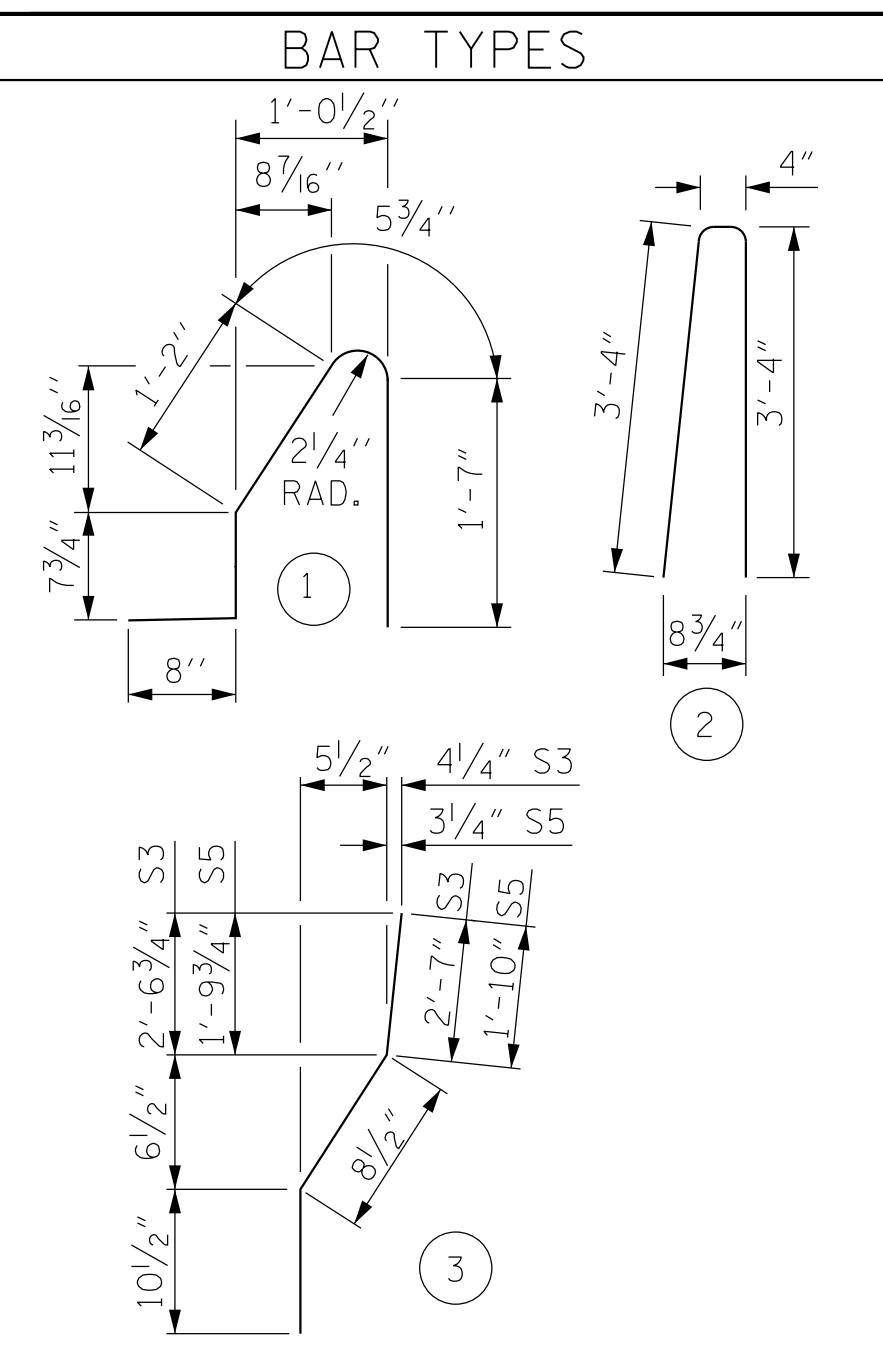

ALL BAR DIMENSIONS ARE OUT TO OUT

BILL OF MATERIAL					
FOR CONCRETE BARRIER RAIL ONLY					
BAR	NO.	SIZE	TYPE	LENGTH	WEIGHT
* S1	150	#5	1	4'-7"	718
* S2	150	#5	2	7'-0"	1096
* S3	4	#5	3	4'-2"	18
* S4	4	#5	STR	4'-0"	17
* S5	8	#5	3	3'-5"	29
* S6	8	#5	STR	3'-3"	28
* B1	66	#5	STR	26'-3"	1809
* EPOXY COATED REINFORCING STEEL				3,715	LBS.
CLASS AA CONCRETE				22	CU. YDS.
CONCRETE BARRIER RAIL				160.5	LIN. FT.

ASSEMBLED BY :	PFC	DATE :	8/15
CHECKED BY :	CMT	DATE :	8/15
DRAWN BY :	ARB 5/87	REV. 10/11/11	MAA/GM
CHECKED BY :	SJD 9/87	REV. 7/12	MAA/GM
		REV. 6/13	MAA/GM

\*\*\*\*\*SYSTEM\*\*\*\*\*  
\*\*\*\*\*DON\*\*\*\*\*  
\*\*\*\*\*USERNAME\*\*\*\*\*

Prepared in the Office of:

**Mattern & Craig**  
CONSULTING ENGINEERS & SURVEYORS  
FIRM LICENSE NO. C-1154  
12 BROAD STREET  
ASHEVILLE, NORTH CAROLINA 28801  
(828) 254-2201 • FAX (828) 254-4562

DocuSigned by:  
**Steven A. Campbell** 12/21/2015  
SBCPSB0006342E

PROJECT NO. R-5605  
TRANSYLVANIA COUNTY  
STATION: 50+83.00 -L-

REVISIONS					
NO.	BY:	DATE:	NO.	BY:	DATE:
1			3		
2			4		

SHEET NO.	S-36
TOTAL SHEETS	51