

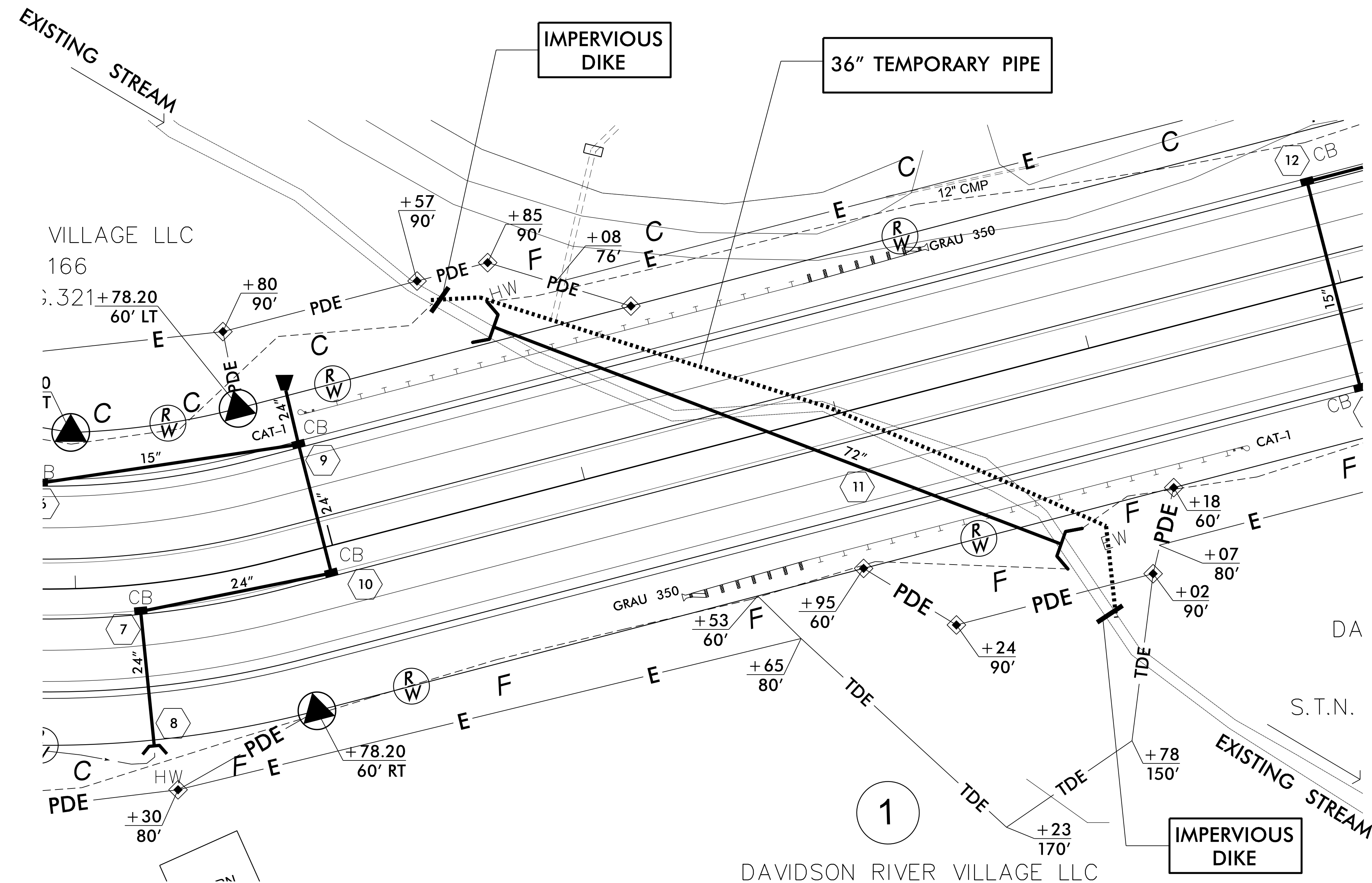

PROJECT REFERENCE NO. <i>R-5605</i>	SHEET NO. <i>EC-4A/CONST.4</i>
RW SHEET NO.	
ROADWAY DESIGN ENGINEER	HYDRAULICS ENGINEER

PIPE INSTALLATION SEQUENCE STA. -L- 44 + 05

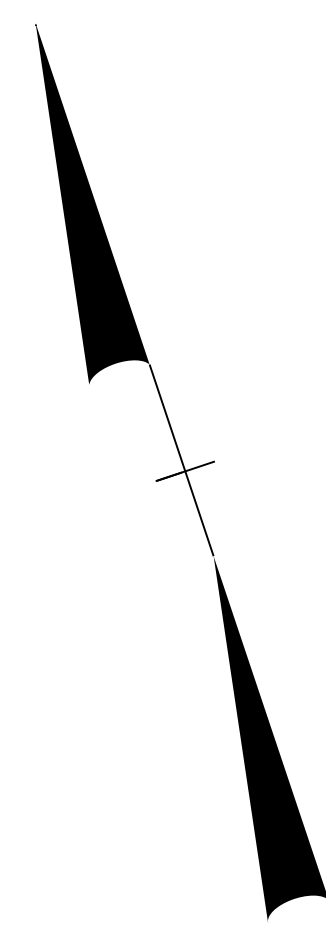

- SEQUENCE OF CONSTRUCTION FOR TYPICAL WORK AREA:
1. UTILIZE SPECIAL STILLING BASIN(S) DURING PIPE INSTALLATION AS NEEDED.
 2. CONSTRUCT IMPERVIOUS DIKES AND INSTALL 36 INCH TEMPORARY PIPE, DIVERTING FLOW THROUGH THE PIPE.
 3. INSTALL 72" PIPE AND CONSTRUCT ANY NECESSARY CHANNEL IMPROVEMENTS.
 4. REMOVE IMPERVIOUS DIKES AND TEMPORARY PIPE AND DIVERT FLOW INTO 72" PIPE.
 5. COMPLETE ROADWAY.



PLANS PREPARED BY :

WGLA Engineering, PLLC
 214 N. King Street
 Hendersonville, NC 28792
 (828) 687-7177
 wglac.com
 FOR
DIVISION OF HIGHWAYS