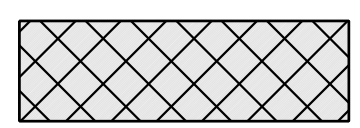
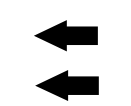

LEGEND

 WORK AREA

 PAVEMENT REMOVAL

 TRAFFIC FLOW

MATCH LINE STATION 41+00 SEE SHEET TMP-6 & TMP-7

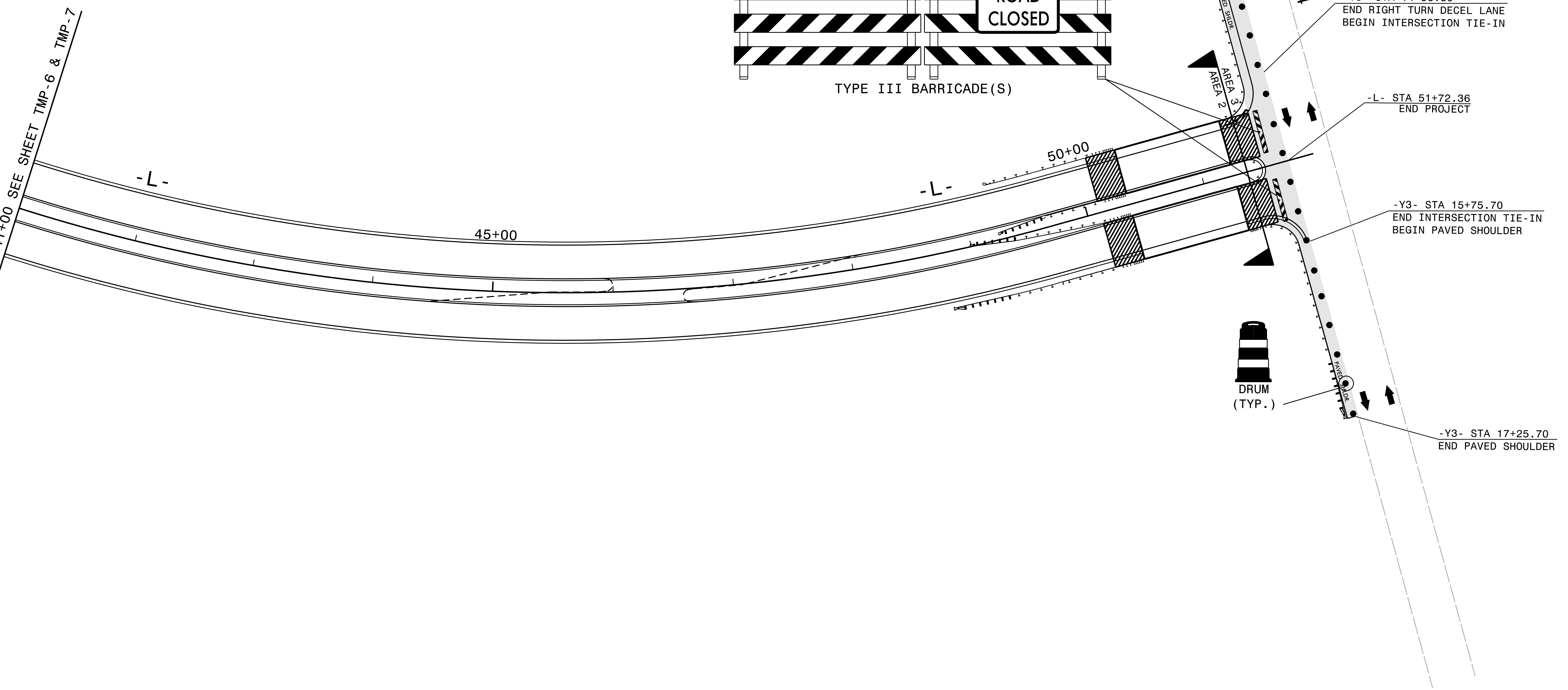

12/24/15 3:53 PM
 R:\3380 DRV Connector Road\Davidson River Village\Traffic\TrafficControl\TCP\R-5605.tc.tmp8.dgn
 boross

Mattern & Craig
 CONSULTING ENGINEERS • SURVEYORS
 FIRM LICENSE No. C-1154
 12 BROAD STREET
 ASHEVILLE, NORTH CAROLINA 28801
 (828) 254-2201
 FAX (828) 254-4562

APPROVED: _____ DATE: 12/21/2015

DocuSigned by:
 James Voso
 143FD60379E041F...

SEAL

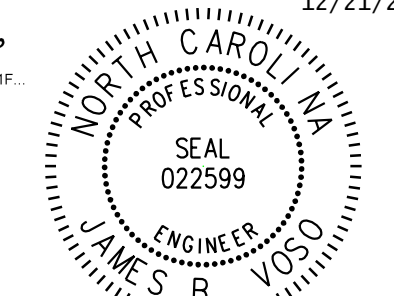

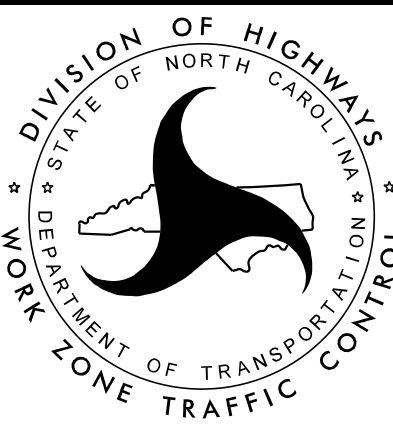

DIVISION OF HIGHWAYS
 STATE OF NORTH CAROLINA
 DEPARTMENT OF TRANSPORTATION
 WORK ZONE TRAFFIC CONTROL

**AREA 3
 PHASE 1
 STEP 2**

