

**This electronic collection of documents is provided  
for the convenience of the user  
and is Not a Certified Document –**

**The documents contained herein were originally issued  
and sealed by the individuals whose names and license  
numbers appear on each page, on the dates appearing  
with their signature on that page.**

**This file or an individual page  
shall not be considered a certified document.**

STATE OF NORTH CAROLINA  
DIVISION OF HIGHWAYS

**TRANSPORTATION MANAGEMENT PLAN**

**SURRY COUNTY**

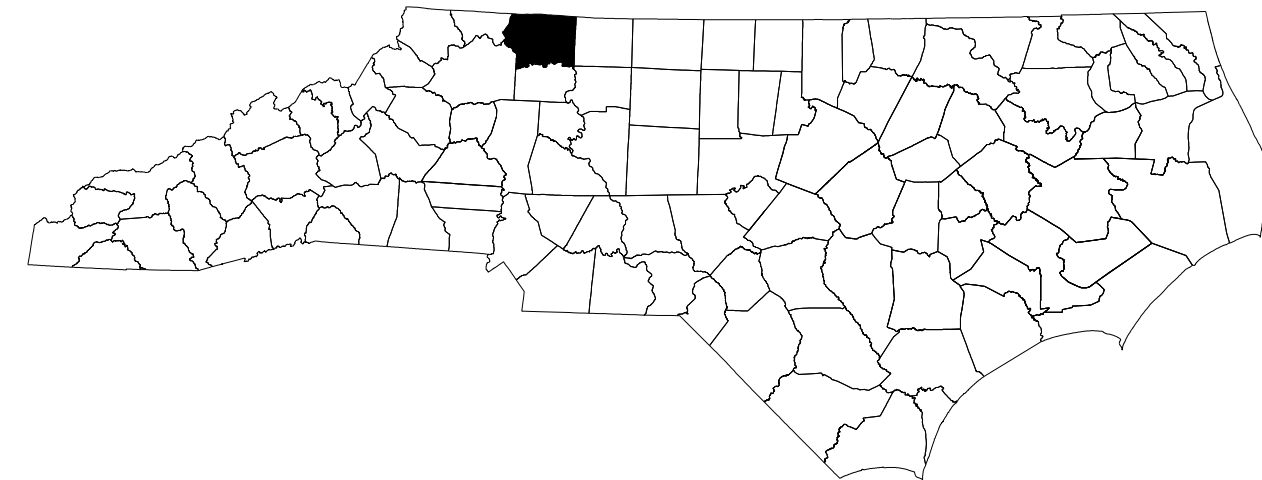

LOCATION: BRIDGE NO.39 ON SR 1328 (HAYSTACK RD.) OVER MITCHELL RIVER

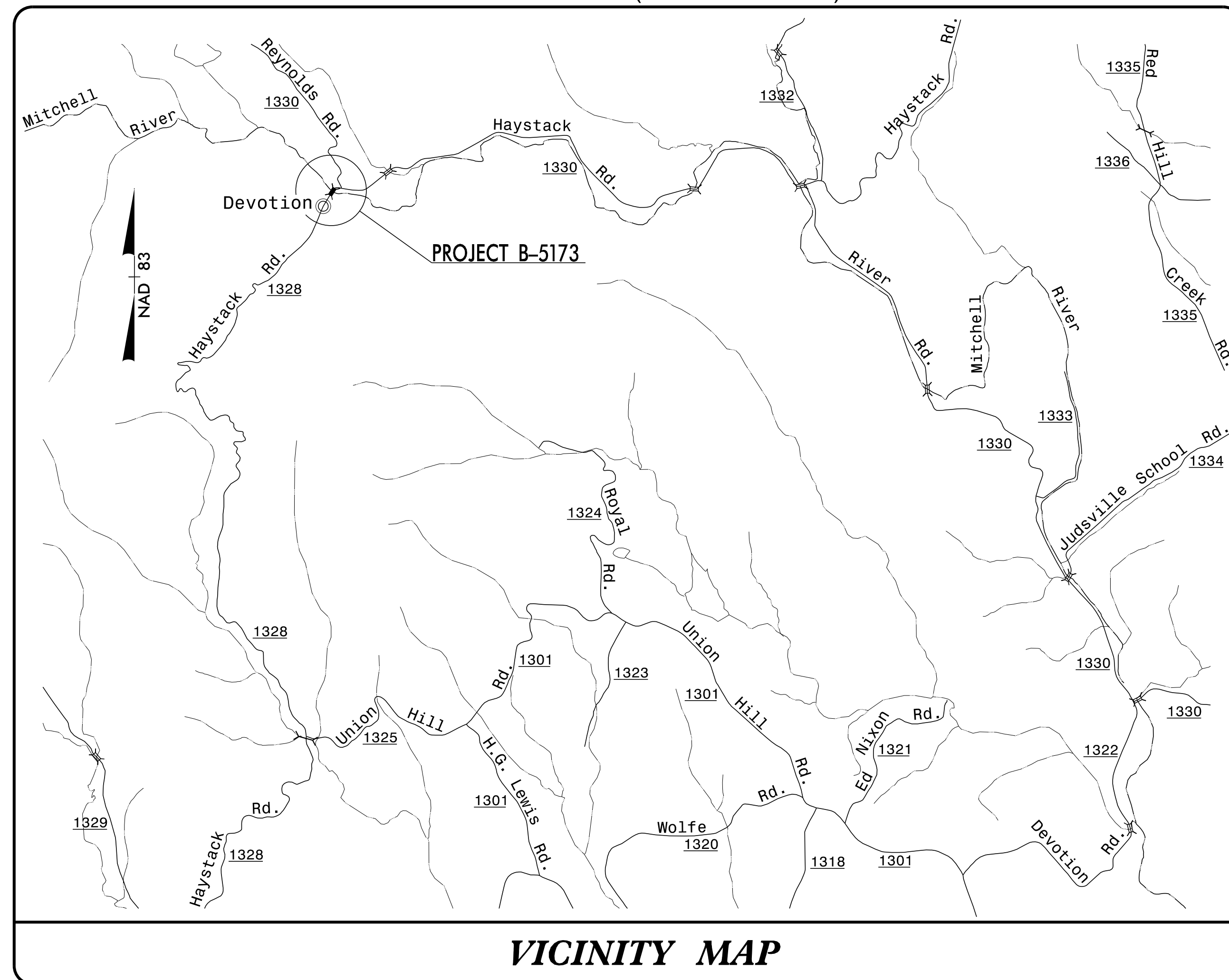

**VICINITY MAP**

**INDEX OF SHEETS**

SHEET NO.	TITLE
TMP-1	TITLE SHEET, AND INDEX OF SHEETS
TMP-1A	LIST OF APPLICABLE ROADWAY STANDARD DRAWINGS, LEGEND, AND TEMPORARY PAVEMENT MARKINGS
TMP-1B	TRANSPORTATION OPERATIONS PLAN: (TRANSPORTATION OPERATIONS AND GENERAL NOTES)
TMP-2	TEMPORARY TRAFFIC CONTROL PHASING AND PHASE I DETAILS
TMP-3	PHASE II DETAILS
TMP-4	PHASE II CROSS-SECTIONS
TMP-5	PHASE III DETAILS
TMP-6	PHASE III CROSS-SECTIONS

SHEET NO.

TMP-1

**B-5173**

**TIP PROJECT:**

11/3/2015 p:\tip\projects-b\5173\traffic\trafficcontrol\top\B5173.TC.TMP01.dgn User:scodts

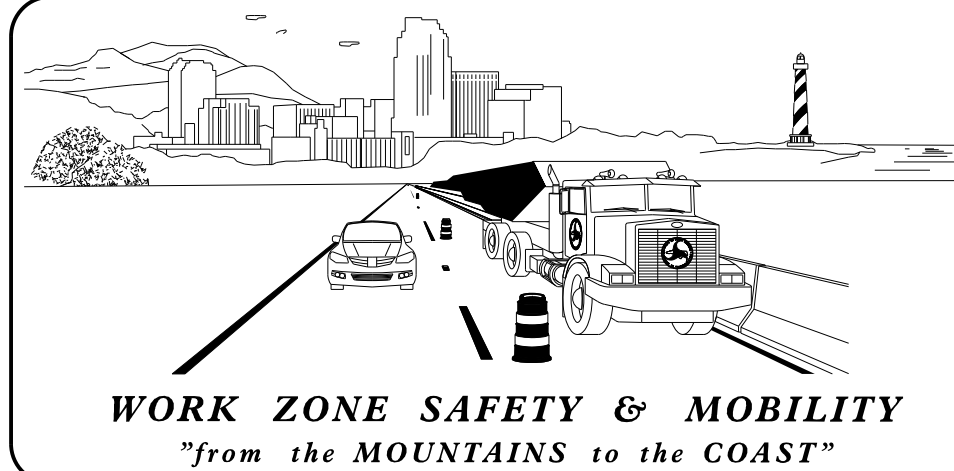

**N.C.D.O.T. WORK ZONE TRAFFIC CONTROL**  
1561 MAIL SERVICE CENTER (MSC) RALEIGH, NC 27699-1561  
750 N. GREENFIELD PARKWAY, GARNER, NC 27529 (DELIVERY)  
PHONE: (919) 773-2800 FAX: (919) 771-2745

J. S. BOURNE, P.E. STATE TRAFFIC MANAGEMENT ENGINEER  
J. W. WOOLARD, P.E. TRAFFIC CONTROL PROJECT ENGINEER  
L. D. STOUCHKO, P.E. TRAFFIC CONTROL PROJECT DESIGN ENGINEER  
S. B. COATS TRAFFIC CONTROL DESIGN ENGINEER

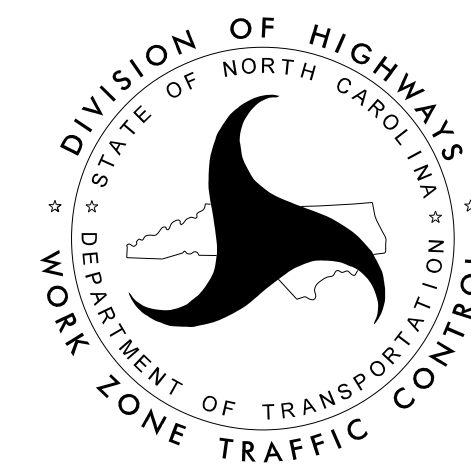

**DOCUMENT NOT CONSIDERED FINAL  
UNLESS ALL SIGNATURES COMPLETED**

APPROVED: *Lori D. Stouhko*

DATE: 11/3/2015

SEAL



# ROADWAY STANDARD DRAWINGS

THE FOLLOWING ROADWAY STANDARDS AS SHOWN IN "ROADWAY STANDARD DRAWINGS" - PROJECT SERVICES UNIT - N.C. DEPARTMENT OF TRANSPORTATION - RALEIGH, N.C., DATED JANUARY 2012 ARE APPLICABLE TO THIS PROJECT AND BY REFERENCE HEREBY ARE CONSIDERED A PART OF THESE PLANS:

STD. NO.	TITLE
1101.01	WORK ZONE ADVANCE WARNING SIGNS
1101.02	TEMPORARY LANE CLOSURES
1101.04	TEMPORARY SHOULDER CLOSURES
1101.05	WORK ZONE VEHICLE ACCESSES
1101.06	WARNING SIGNS FOR BLASTING ZONES
1101.11	TRAFFIC CONTROL DESIGN TABLES
1110.01	STATIONARY WORK ZONE SIGNS
1110.02	PORTABLE WORK ZONE SIGNS
1130.01	DRUM
1135.01	CONES
1145.01	BARRICADES
1150.01	FLAGGING DEVICES
1180.01	SKINNY-DRUM
1205.01	PAVEMENT MARKINGS - LINE TYPES AND OFFSETS
1205.02	PAVEMENT MARKINGS - TWO-LANE AND MULTI-LANE ROADWAYS
1250.01	RAISED PAVEMENT MARKERS - INSTALLATION SPACING
1251.01	RAISED PAVEMENT MARKERS - PERMANENT AND TEMPORARY

# LEGEND

## GENERAL

- DIRECTION OF TRAFFIC FLOW
- DIRECTION OF PEDESTRIAN TRAFFIC FLOW
- EXIST. PVMT.
- NORTH ARROW
- PROPOSED PVMT.
- TEMP. SHORING (LOCATION PURPOSES ONLY)

WORK AREA

REMOVAL

USER DEFINED (IF NEEDED)

USER DEFINED (IF NEEDED)

## SIGNALS

- EXISTING
- PROPOSED
- TEMPORARY

## PAVEMENT MARKINGS

- EXISTING LINES
- TEMPORARY LINES

## TRAFFIC CONTROL DEVICES

- BARRICADE (TYPE III)
- CONE
- DRUM
- SKINNY DRUM
- TUBULAR MARKER
- TEMPORARY CRASH CUSHION
- FLASHING ARROW BOARD
- FLAGGER
- LAW ENFORCEMENT
- TRUCK MOUNTED ATTENUATOR (TMA)
- CHANGEABLE MESSAGE SIGN

## TEMPORARY SIGNING

- PORTABLE SIGN
- STATIONARY SIGN
- STATIONARY OR PORTABLE SIGN

## PAVEMENT MARKERS

- CRYSTAL/CRYSTAL
- CRYSTAL/RED
- YELLOW/YELLOW

## PAVEMENT MARKING SYMBOLS

- PAVEMENT MARKING SYMBOLS

## TEMPORARY PAVEMENT MARKING

- PA - WHITE EDGELINE (PAINT) - 4"
- PB - YELLOW EDGELINE (PAINT) - 4"
- PI - YELLOW DOUBLE CENTER (PAINT) - 4"
- P2 - WHITE STOP BAR (PAINT) - 24"

11/3/2015 p:\t\p\p\projects-b\5173\traffic\trafficcontrol\top\B5173.TC\_TMP01A.dgn User:scodts

APPROVED: <i>Lois B. Stouchko</i> DATE: 11/3/2015 		ROADWAY STANDARD DRAWINGS & LEGEND
<b>DOCUMENT NOT CONSIDERED FINAL UNLESS ALL SIGNATURES COMPLETED</b>		

## TRANSPORTATION OPERATIONS

### CONSTRUCTION

REALIGNMENT OF SR 1328 (HAYSTACK RD.) INCLUDING NEW BRIDGE AND ROADWAY APPROACHES. REMOVAL OF EXISTING STRUCTURE AND PAVEMENT.

### TMP DESIGN PARAMETERS

UTILIZE FLAGGERS, SIGNAGE, TRAFFIC CONTROL DEVICES, AND TEMPORARY SIGNALS FOR REALIGNMENT OF SR 1328. TRAFFIC WILL BE SHIFTED TO A ONE-LANE, TWO-WAY TRAFFIC PATTERN DURING CONSTRUCTION.

### GENERAL NOTES

CHANGES MAY BE REQUIRED WHEN PHYSICAL DIMENSIONS IN THE DETAIL DRAWINGS, STANDARD DETAILS, AND ROADWAY DETAILS ARE NOT ATTAINABLE TO MEET FIELD CONDITIONS OR RESULT IN DUPLICATE OR UNDESIRED OVERLAPPING OF DEVICES. MODIFICATION MAY INCLUDE: MOVING, SUPPLEMENTING, COVERING, OR REMOVAL OF DEVICES AS DIRECTED BY THE ENGINEER.

THE FOLLOWING GENERAL NOTES APPLY AT ALL TIMES FOR THE DURATION OF THE CONSTRUCTION PROJECT EXCEPT WHEN OTHERWISE NOTED IN THE PLAN OR DIRECTED BY THE ENGINEER.

#### LANE AND SHOULDER CLOSURE REQUIREMENTS

- A) REMOVE LANE CLOSURE DEVICES FROM THE LANE WHEN WORK IS NOT BEING PERFORMED BEHIND THE LANE CLOSURE OR WHEN A LANE CLOSURE IS NO LONGER NEEDED, OR AS DIRECTED BY THE ENGINEER.
- B) WHEN PERSONNEL AND/OR EQUIPMENT ARE WORKING WITHIN 15 FT OF AN OPEN TRAVEL LANE, CLOSE THE NEAREST OPEN SHOULDER USING ROADWAY STANDARD DRAWING NO. 1101.04 UNLESS THE WORK AREA IS PROTECTED BY BARRIER OR GUARDRAIL OR A LANE CLOSURE IS INSTALLED.
- C) WHEN PERSONNEL AND/OR EQUIPMENT ARE WORKING ON THE SHOULDER ADJACENT TO AN UNDIVIDED FACILITY AND WITHIN 5 FT OF AN OPEN TRAVEL LANE, CLOSE THE NEAREST OPEN TRAVEL LANE USING ROADWAY STANDARD DRAWING NO. 1101.02 UNLESS THE WORK AREA IS PROTECTED BY BARRIER OR GUARDRAIL.
- D) WHEN PERSONNEL AND/OR EQUIPMENT ARE WORKING WITHIN A LANE OF TRAVEL OF AN UNDIVIDED OR DIVIDED FACILITY, CLOSE THE LANE ACCORDING TO THE TRAFFIC CONTROL PLANS, ROADWAY STANDARD DRAWINGS OR AS DIRECTED BY THE ENGINEER. CONDUCT THE WORK SO THAT ALL PERSONNEL AND/OR EQUIPMENT REMAIN WITHIN THE CLOSED TRAVEL LANE.
- E) DO NOT WORK SIMULTANEOUSLY WITHIN 15 FT ON BOTH SIDES OF AN OPEN TRAVELWAY, RAMP OR LOOP WITHIN THE SAME LOCATION UNLESS PROTECTED WITH GUARDRAIL OR BARRIER.

#### PAVEMENT EDGE DROP OFF REQUIREMENTS

- F) BACKFILL AT A 6:1 SLOPE UP TO THE EDGE AND ELEVATION OF EXISTING PAVEMENT IN AREAS ADJACENT TO AN OPENED TRAVEL LANE THAT HAS AN EDGE OF PAVEMENT DROP-OFF AS FOLLOWS:

BACKFILL DROP-OFFS THAT EXCEED 2 INCHES ON ROADWAYS WITH POSTED SPEED LIMITS OF 45 MPH OR GREATER.

BACKFILL DROP-OFFS THAT EXCEED 3 INCHES ON ROADWAYS WITH POSTED SPEED LIMITS LESS THAN 45 MPH.

BACKFILL WITH SUITABLE COMPACTED MATERIAL, AS APPROVED BY THE ENGINEER, AT NO EXPENSE TO THE DEPARTMENT.

- G) DO NOT EXCEED A DIFFERENCE OF 2 INCHES IN ELEVATION BETWEEN OPEN LANES TRAFFIC FOR NOMINAL LIFTS OF 1.5 INCHES. INSTALL ADVANCE WARNING "UNEVEN LANES" SIGNS (W8-11) 350 FT. IN ADVANCE AND A MINIMUM OF EVERY HALF MILE THROUGHOUT THE UNEVEN AREA.

#### TRAFFIC PATTERN ALTERATIONS

- H) NOTIFY THE ENGINEER TWENTY ONE (21) CALENDAR DAYS PRIOR TO ANY TRAFFIC PATTERN ALTERATION.

#### SIGNING

- I) INSTALL ADVANCE WORK ZONE WARNING SIGNS WHEN WORK IS WITHIN 40 FT FROM THE EDGE OF TRAVEL LANE AND NO MORE THAN THREE (3) DAYS PRIOR TO THE BEGINNING OF CONSTRUCTION.
- J) ENSURE ALL NECESSARY SIGNING IS IN PLACE PRIOR TO ALTERING ANY TRAFFIC PATTERN.

#### TRAFFIC CONTROL DEVICES

- K) PLACE TYPE III BARRICADES, WITH "ROAD CLOSED" SIGN R11-2 ATTACHED, OF SUFFICIENT LENGTH TO CLOSE ENTIRE ROADWAY.

#### PAVEMENT MARKINGS AND MARKERS

- L) INSTALL TEMPORARY PAVEMENT MARKINGS AND TEMPORARY PAVEMENT MARKERS ON INTERIM LAYERS OF PAVEMENT AS FOLLOWS:

ROAD NAME	MARKING	MARKER
SR 1328	PAINT	TEMPORARY

- M) PLACE ONE APPLICATION OF PAINT FOR TEMPORARY TRAFFIC PATTERNS. PLACE A SECOND APPLICATION OF PAINT SIX (6) MONTHS AFTER THE INITIAL APPLICATION AND EVERY SIX MONTHS AS DIRECTED BY THE ENGINEER.
- N) TIE PROPOSED PAVEMENT MARKING LINES TO EXISTING PAVEMENT MARKING LINES.
- O) REMOVE/REPLACE ANY CONFLICTING/DAMAGED PAVEMENT MARKINGS AND MARKERS BY THE END OF EACH DAY'S OPERATION.
- P) INSTALL PAVEMENT MARKINGS AND PAVEMENT MARKERS ON THE FINAL SURFACE AS SHOWN IN FINAL PAVEMENT MARKING PLAN.

11/3/2015 p:\t\p\proj\cts-b\5173\traffic\trafficcontrol\top\B5173.TC.TMP01B.dgn User:scodts

APPROVED: Lori D. Stouchko  
902CB018918146C

DATE: 11/3/2015



**DOCUMENT NOT CONSIDERED FINAL  
UNLESS ALL SIGNATURES COMPLETED**

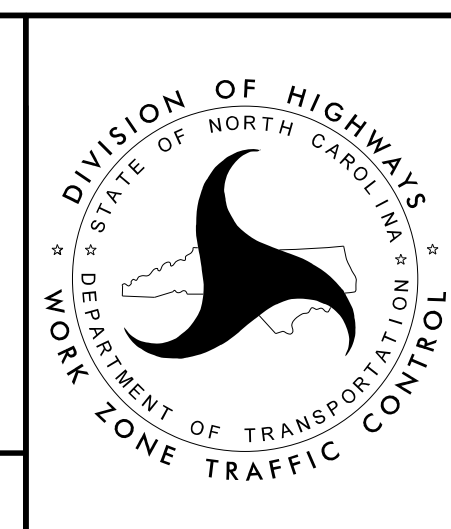

**TRANSPORTATION  
OPERATIONS  
PLAN**

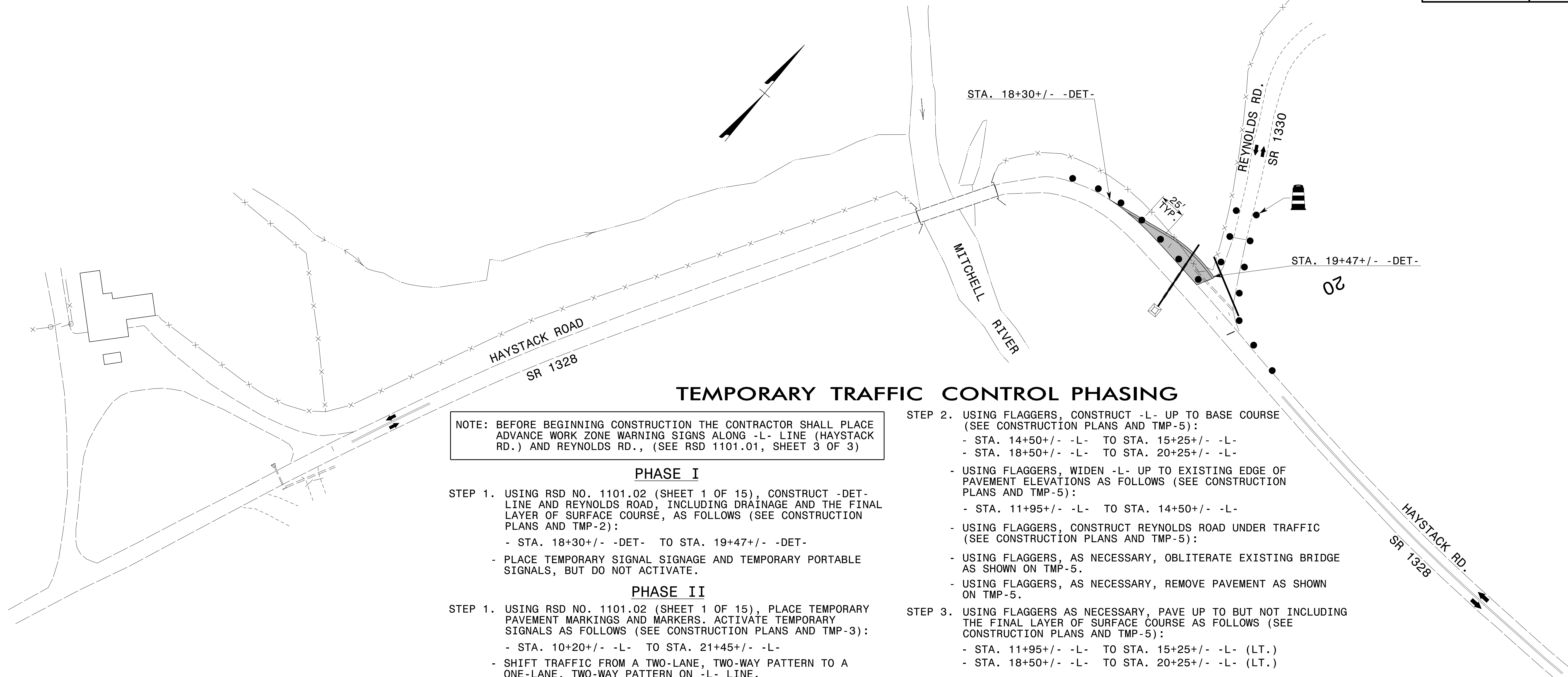

### TEMPORARY TRAFFIC CONTROL PHASING

NOTE: BEFORE BEGINNING CONSTRUCTION THE CONTRACTOR SHALL PLACE ADVANCE WORK ZONE WARNING SIGNS ALONG -L- LINE (HAYSTACK RD.) AND REYNOLDS RD., (SEE RSD 1101.01, SHEET 3 OF 3)

#### PHASE I

- STEP 1. USING RSD NO. 1101.02 (SHEET 1 OF 15), CONSTRUCT -DET- LINE AND REYNOLDS ROAD, INCLUDING DRAINAGE AND THE FINAL LAYER OF SURFACE COURSE, AS FOLLOWS (SEE CONSTRUCTION PLANS AND TMP-2):
- STA. 18+30+/- -DET- TO STA. 19+47+/- -DET-
  - PLACE TEMPORARY SIGNAL SIGNAGE AND TEMPORARY PORTABLE SIGNALS, BUT DO NOT ACTIVATE.

#### PHASE II

- STEP 1. USING RSD NO. 1101.02 (SHEET 1 OF 15), PLACE TEMPORARY PAVEMENT MARKINGS AND MARKERS. ACTIVATE TEMPORARY SIGNALS AS FOLLOWS (SEE CONSTRUCTION PLANS AND TMP-3):
- STA. 10+20+/- -L- TO STA. 21+45+/- -L-
  - SHIFT TRAFFIC FROM A TWO-LANE, TWO-WAY PATTERN TO A ONE-LANE, TWO-WAY PATTERN ON -L- LINE.
- STEP 2. AWAY FROM TRAFFIC, CONSTRUCT NEW BRIDGE AND ROADWAY APPROACHES, DRAINAGE, GUARDRAIL, AND PAVE UP TO BUT NOT INCLUDING THE FINAL LAYER OF SURFACE COURSE AS FOLLOWS (SEE CONSTRUCTION PLANS AND TMP-3):
- STA. 15+25+/- -L- TO STA. 18+50+/- -L-
  - USING FLAGGERS AS NECESSARY, CONSTRUCT -L- UP TO BASE COURSE (SEE CONSTRUCTION PLANS AND TMP-3):
  - STA. 14+50+/- -L- TO STA. 15+25+/- -L-
  - STA. 18+50+/- -L- TO STA. 19+37+/- -L-
  - USING FLAGGERS AS NECESSARY, WIDEN -L- UP TO EXISTING EDGE OF PAVEMENT ELEVATIONS AS FOLLOWS (SEE CONSTRUCTION PLANS AND TMP-3):
  - STA. 11+95+/- -L- TO STA. 14+50+/- -L-
  - STA. 19+37+/- -L- TO STA. 20+25+/- -L-

#### PHASE III

- STEP 1. USING FLAGGERS AS NECESSARY, PAVE UP TO BUT NOT INCLUDING THE FINAL LAYER OF SURFACE COURSE AS FOLLOWS (SEE CONSTRUCTION PLANS AND TMP-5):
- STA. 11+95+/- -L- TO STA. 15+25+/- -L- (RT.)
  - STA. 18+50+/- -L- TO STA. 20+25+/- -L- (RT.)
  - USING FLAGGERS, PLACE TEMPORARY PAVEMENT MARKINGS AND MARKERS AS FOLLOWS (SEE CONSTRUCTION PLANS AND TMP-5):
  - STA. 11+45+/- -L- TO STA. 20+95+/- -L-
  - SHIFT TRAFFIC FROM A ONE-LANE, TWO-WAY PATTERN TO A NEW ONE-LANE, TWO-WAY PATTERN ON -L- LINE.

- STEP 2. USING FLAGGERS, CONSTRUCT -L- UP TO BASE COURSE (SEE CONSTRUCTION PLANS AND TMP-5):
- STA. 14+50+/- -L- TO STA. 15+25+/- -L-
  - STA. 18+50+/- -L- TO STA. 20+25+/- -L-

- USING FLAGGERS, WIDEN -L- UP TO EXISTING EDGE OF PAVEMENT ELEVATIONS AS FOLLOWS (SEE CONSTRUCTION PLANS AND TMP-5):
- STA. 11+95+/- -L- TO STA. 14+50+/- -L-

- USING FLAGGERS, CONSTRUCT REYNOLDS ROAD UNDER TRAFFIC (SEE CONSTRUCTION PLANS AND TMP-5):

- USING FLAGGERS, AS NECESSARY, OBLITERATE EXISTING BRIDGE AS SHOWN ON TMP-5.
- USING FLAGGERS, AS NECESSARY, REMOVE PAVEMENT AS SHOWN ON TMP-5.

- STEP 3. USING FLAGGERS AS NECESSARY, PAVE UP TO BUT NOT INCLUDING THE FINAL LAYER OF SURFACE COURSE AS FOLLOWS (SEE CONSTRUCTION PLANS AND TMP-5):

- STA. 11+95+/- -L- TO STA. 15+25+/- -L- (LT.)
- STA. 18+50+/- -L- TO STA. 20+25+/- -L- (LT.)

#### PHASE IV

- STEP 1. USING RSD NO. 1101.02 (SHEET 1 OF 15), DEACTIVATE AND REMOVE TEMPORARY SIGNALS. REMOVE STOP BARS. PAVE THE FINAL LAYER OF SURFACE COURSE FOR -L- AND REYNOLDS ROAD AS FOLLOWS (SEE CONSTRUCTION PLANS AND TMP-5):
- STA. 11+95+/- -L- TO STA. 20+25+/- -L-

- STEP 2. USING RSD NO. 1101.02 (SHEET 1 OF 15), PLACE FINAL PAVEMENT MARKINGS AND MARKERS FOR -L- (SEE FINAL PAVEMENT MARKING PLANS).

- USING RSD NO. 1101.02 (SHEET 1 OF 15), REMOVE TYPE III BARRICADES AND STATIONARY SIGNING.
- SHIFT TRAFFIC FROM A ONE-LANE, TWO-WAY PATTERN TO A TWO-LANE, TWO-WAY PATTERN ON -L- LINE.

APPROVED: *Lori D. Stouchko*  
902CB0189181462

DATE: 11/3/2015

SEAL  
 034437  
 ENGINEER  
 LORI D. STOUCHKO

DOCUMENT NOT CONSIDERED FINAL  
 UNLESS ALL SIGNATURES COMPLETED

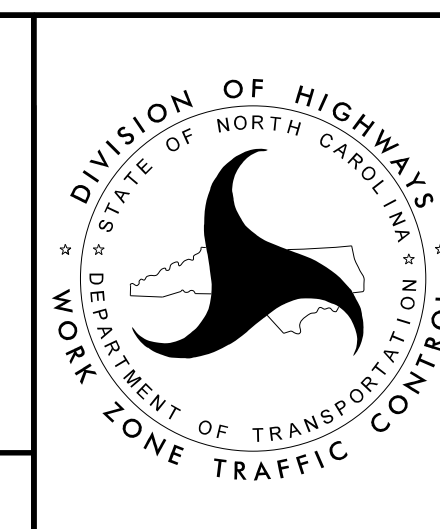

TEMPORARY TRAFFIC CONTROL PHASING AND PHASE I DETAILS

TEMPORARY PAVEMENT MARKING LEGEND	
(PA)	PAINT - WHITE EDGELINE - (4")
(PB)	PAINT - YELLOW EDGELINE - (4")
(PI)	PAINT - YELLOW DOUBLE CENTER - (4")
(P2)	PAINT - WHITE STOP BAR - (24")

REFER TO RSD NOS. 1205.01, 1205.02, 1250.01, AND 1251.01 FOR PLACEMENT OF TEMPORARY PAVEMENT MARKINGS AND MARKERS UNLESS NOTED OTHERWISE.

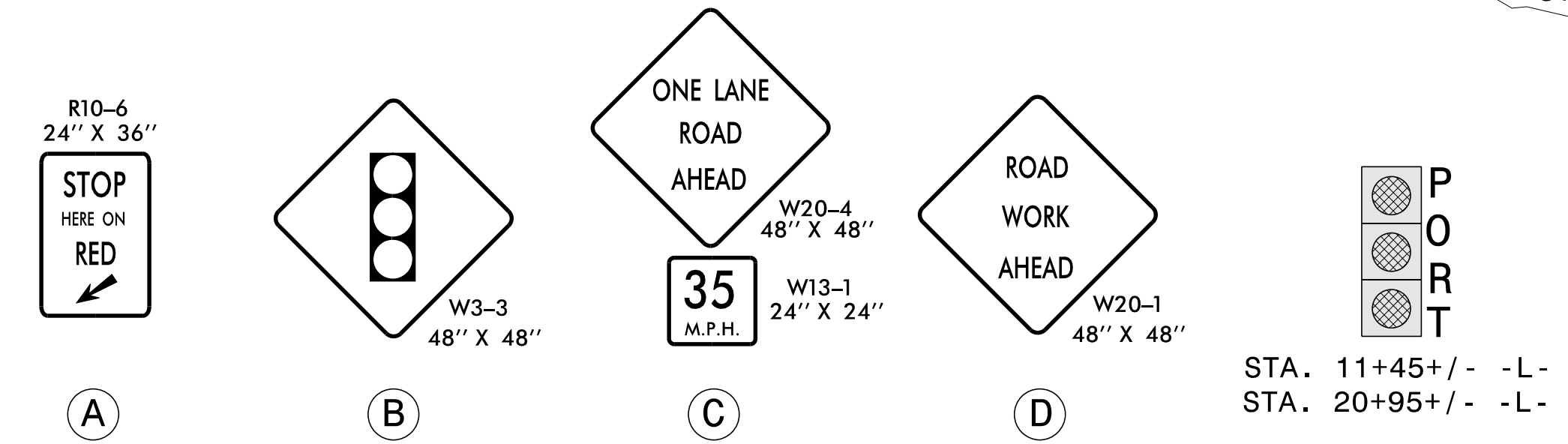
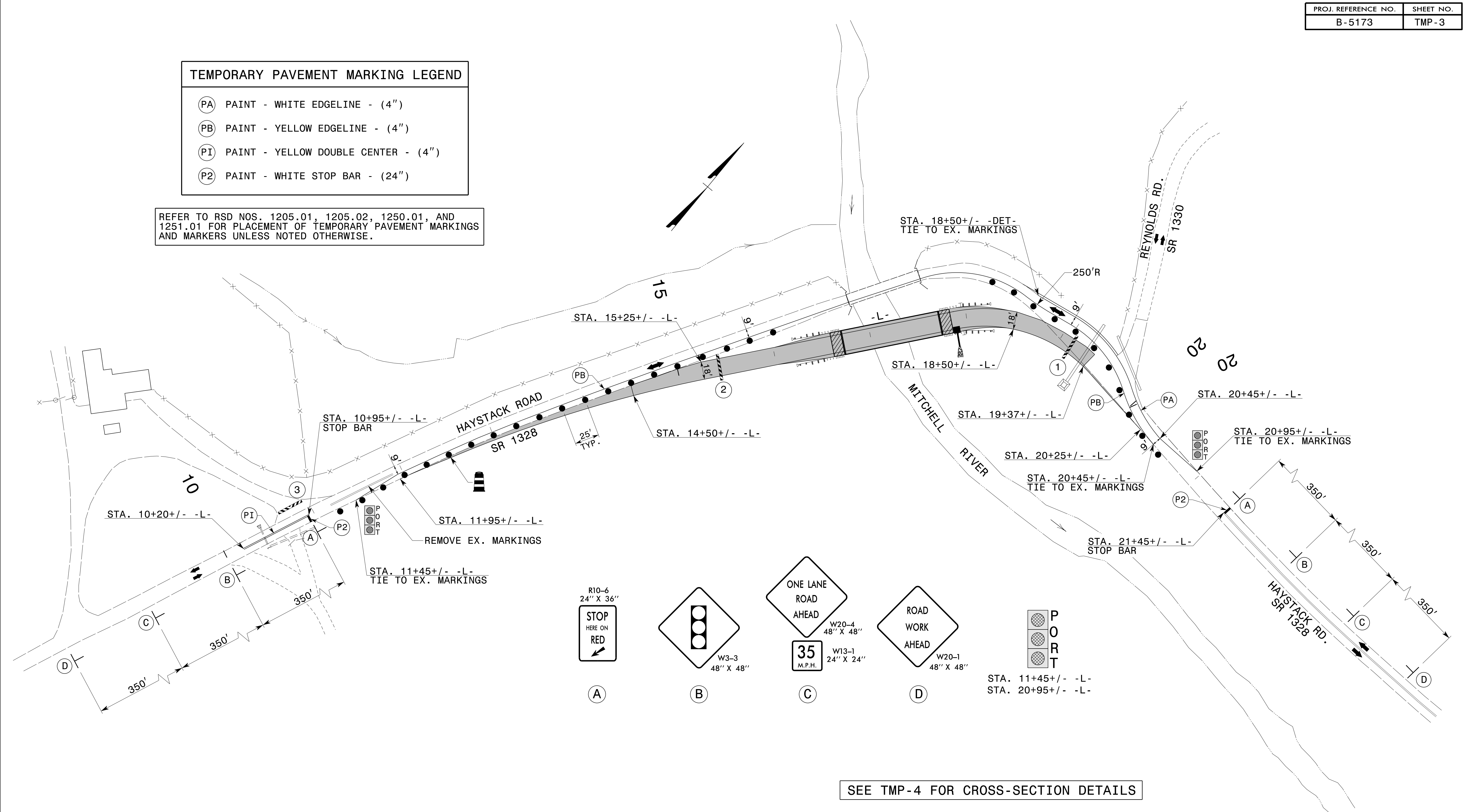

SEE TMP-4 FOR CROSS-SECTION DETAILS

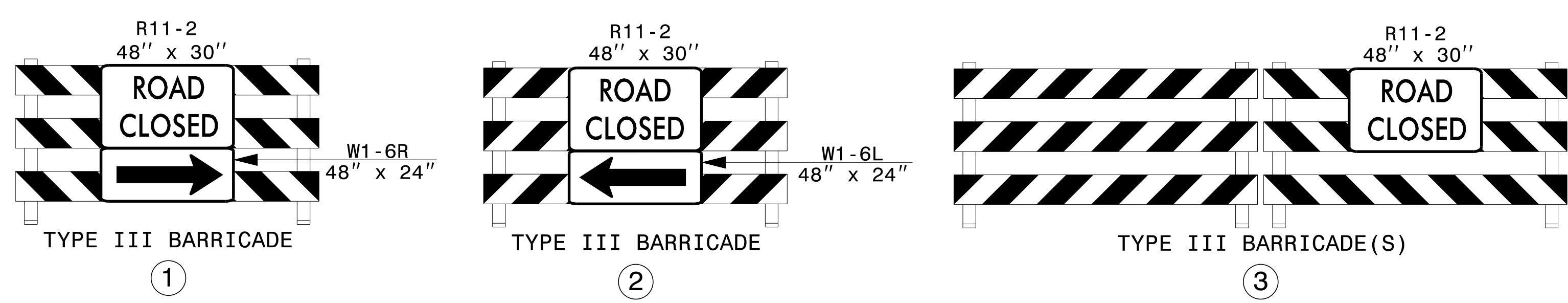

APPROVED: *Lois D. Stouchko*  
902C8018918146C  
 DATE: 11/3/2015

**DOCUMENT NOT CONSIDERED FINAL  
UNLESS ALL SIGNATURES COMPLETED**

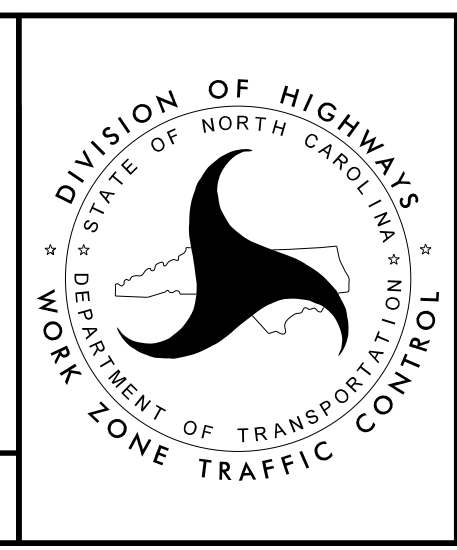

**PHASE II DETAILS**

11/3/2015 p:\tip\projects-b\5173\traffic\trafficcontrol\top\B5173.TC\_TMP03.dgn User:scodts

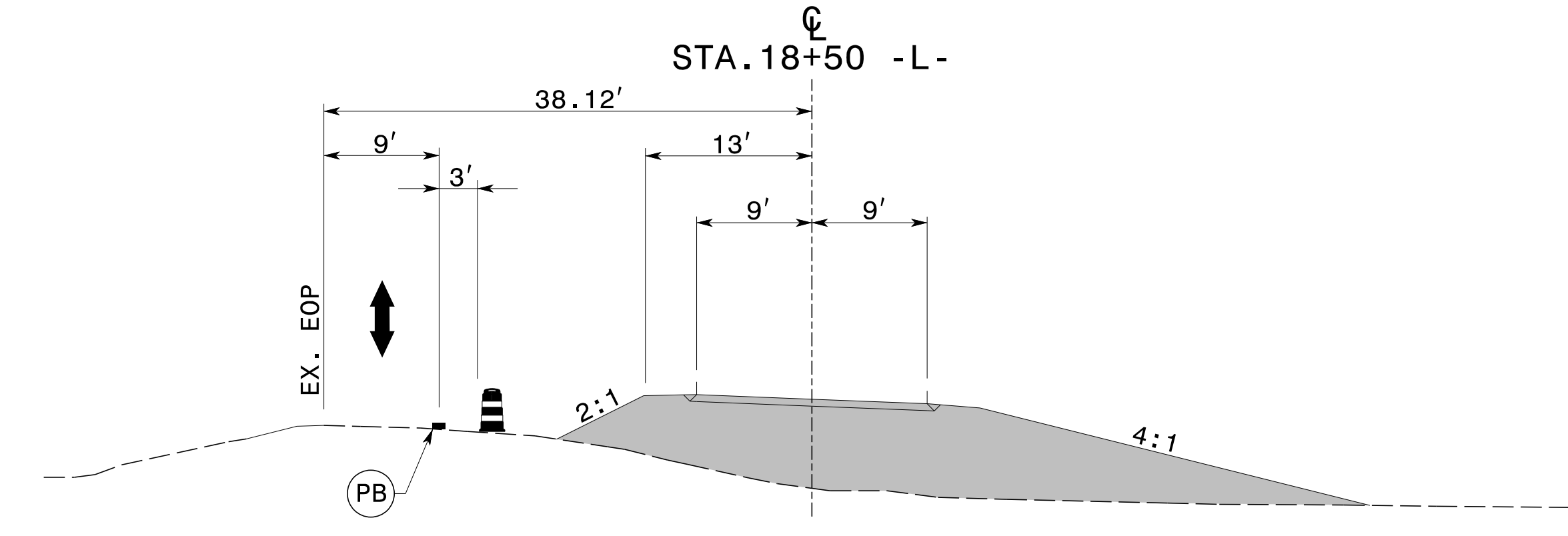
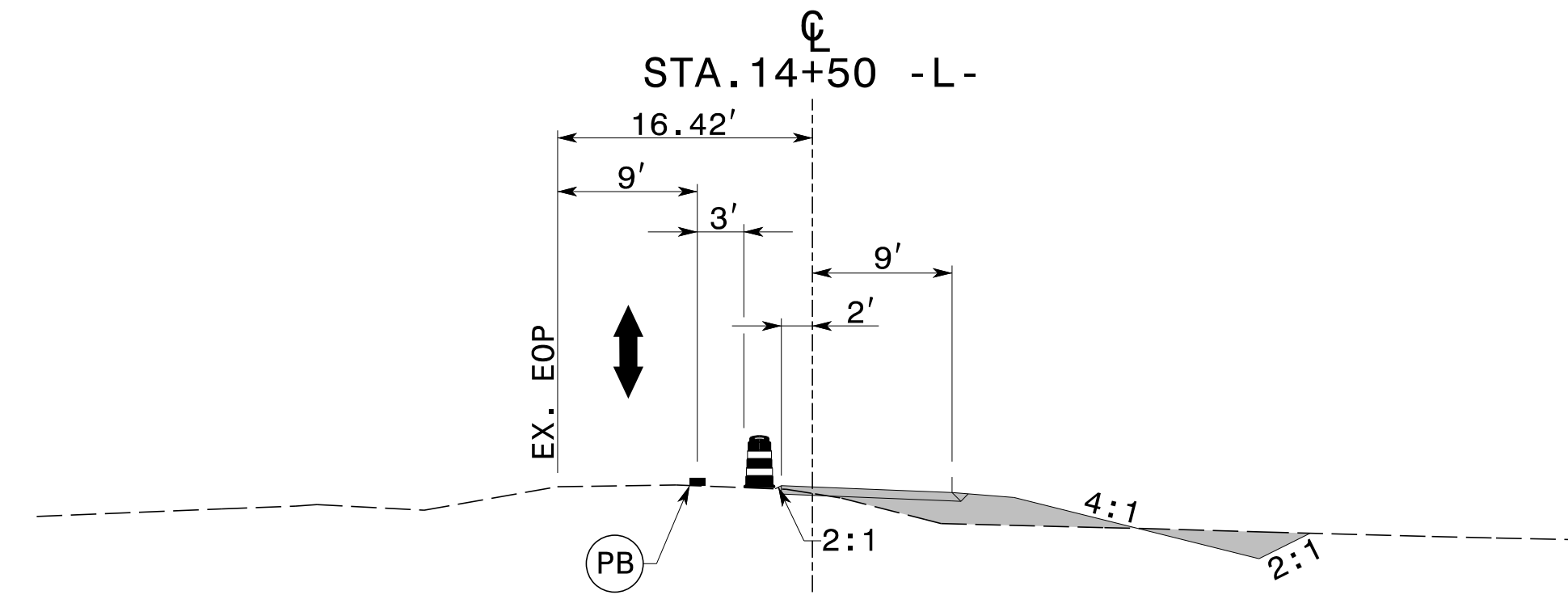
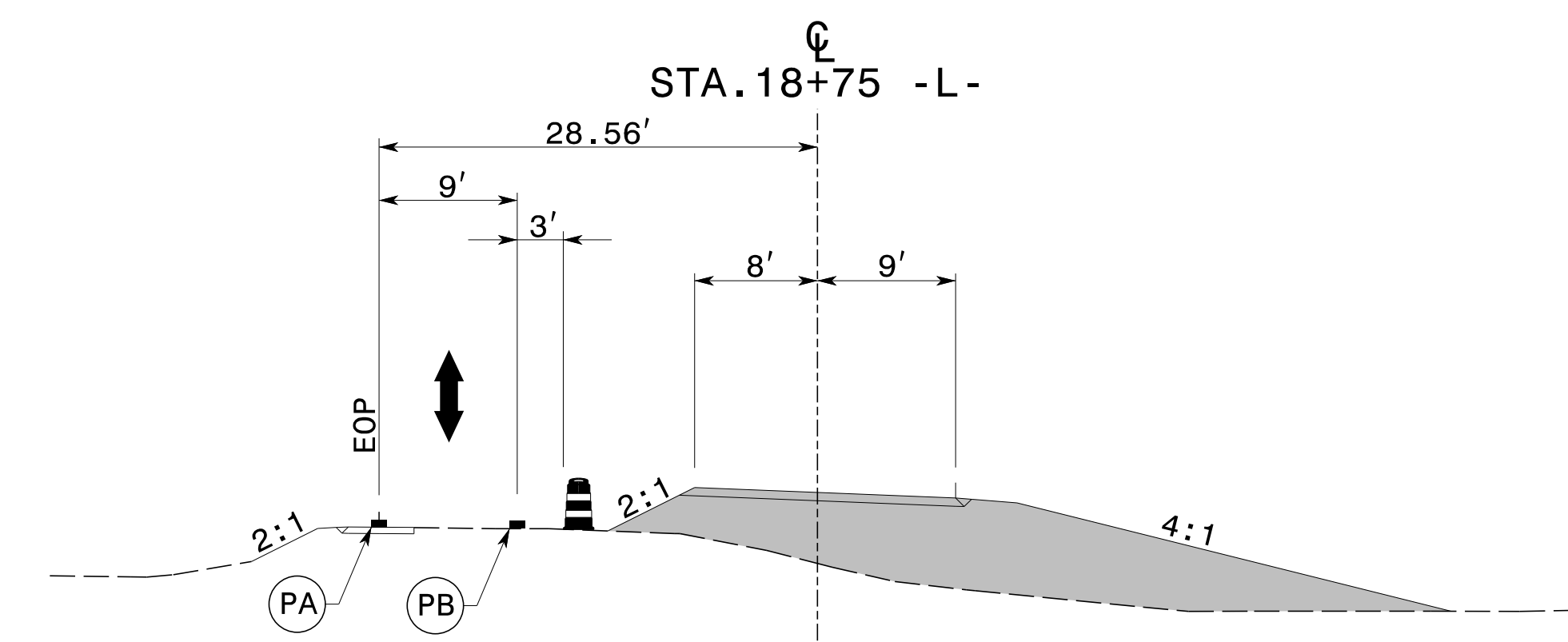
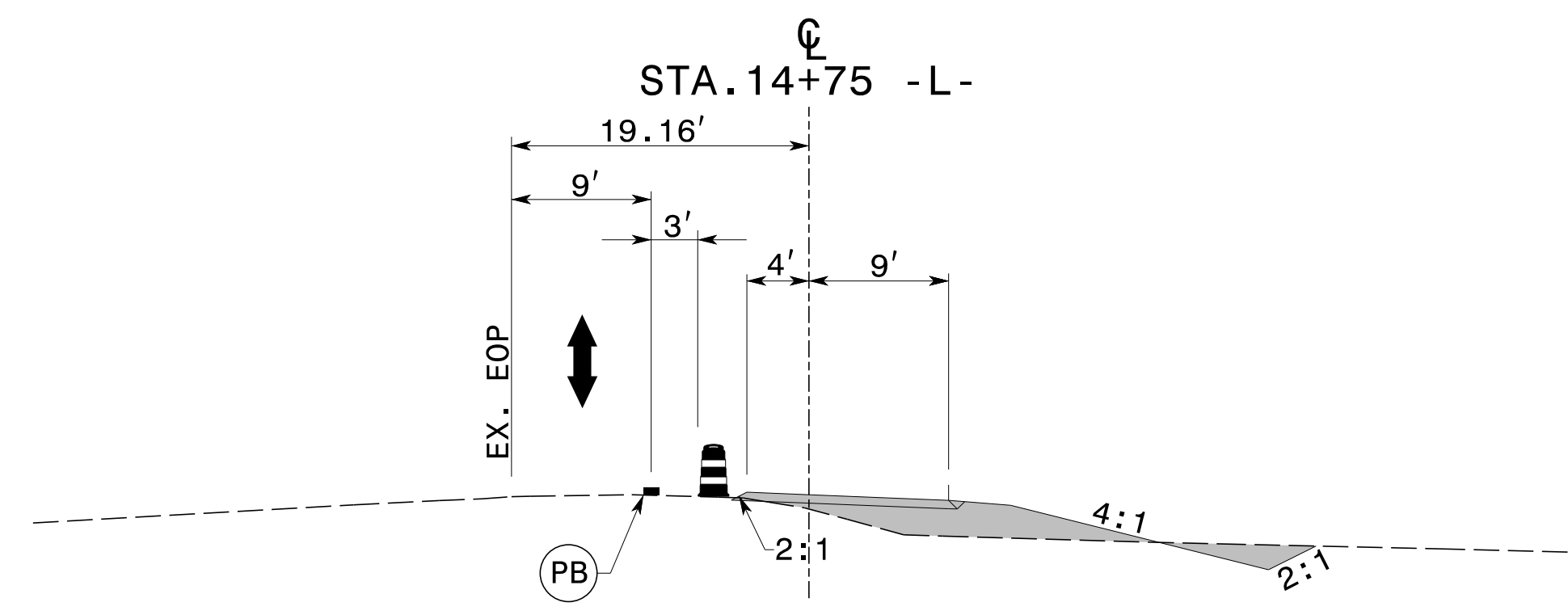
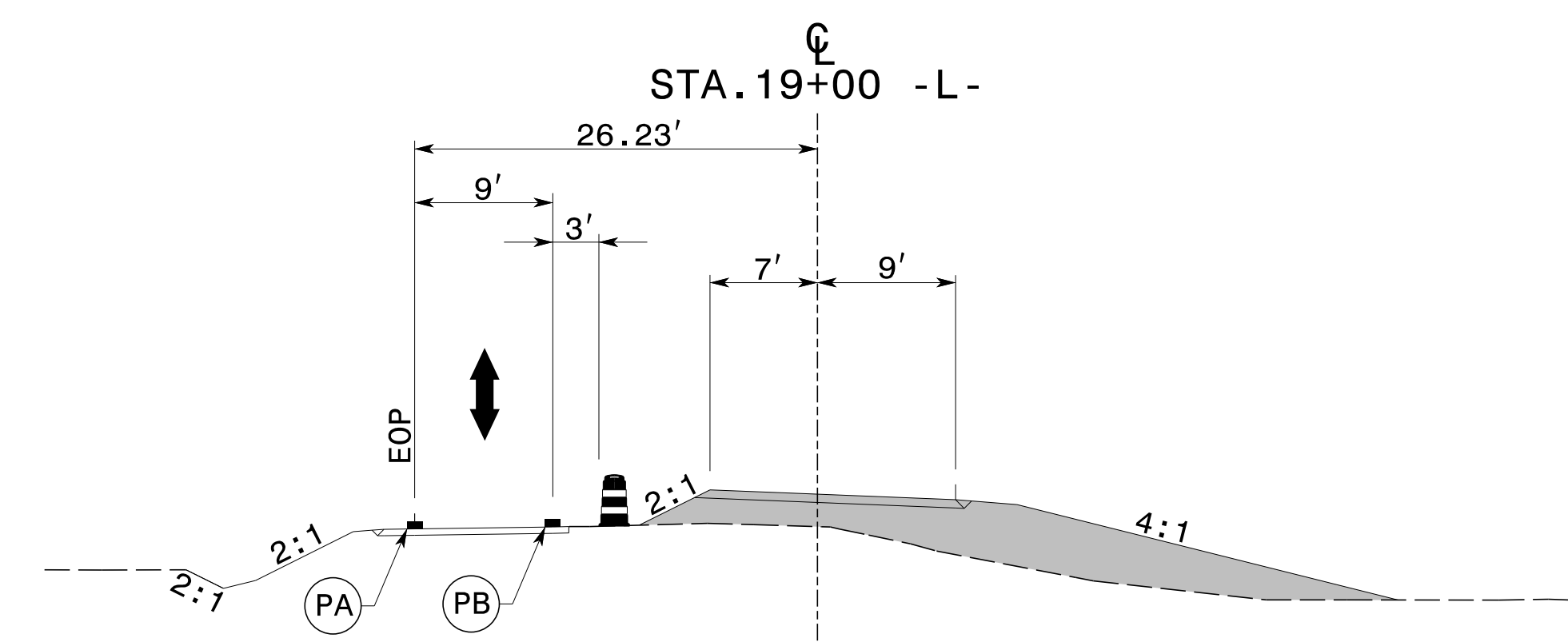
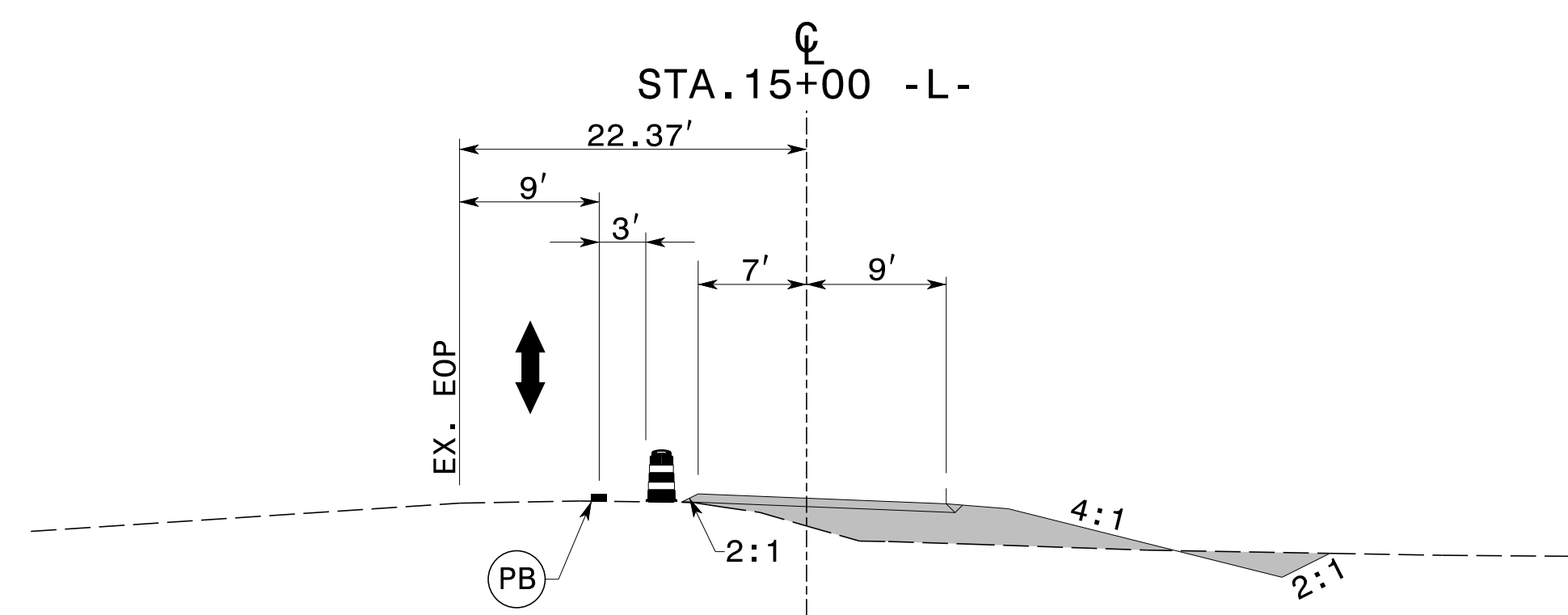
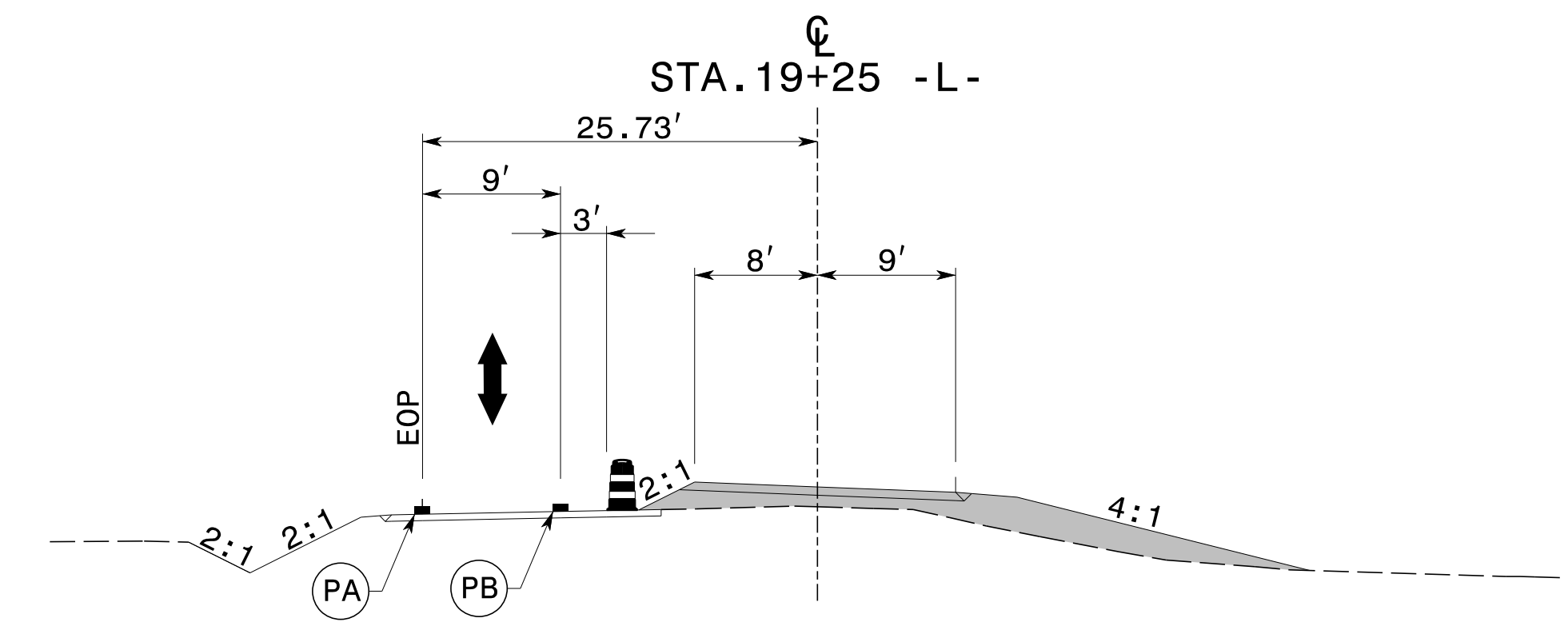
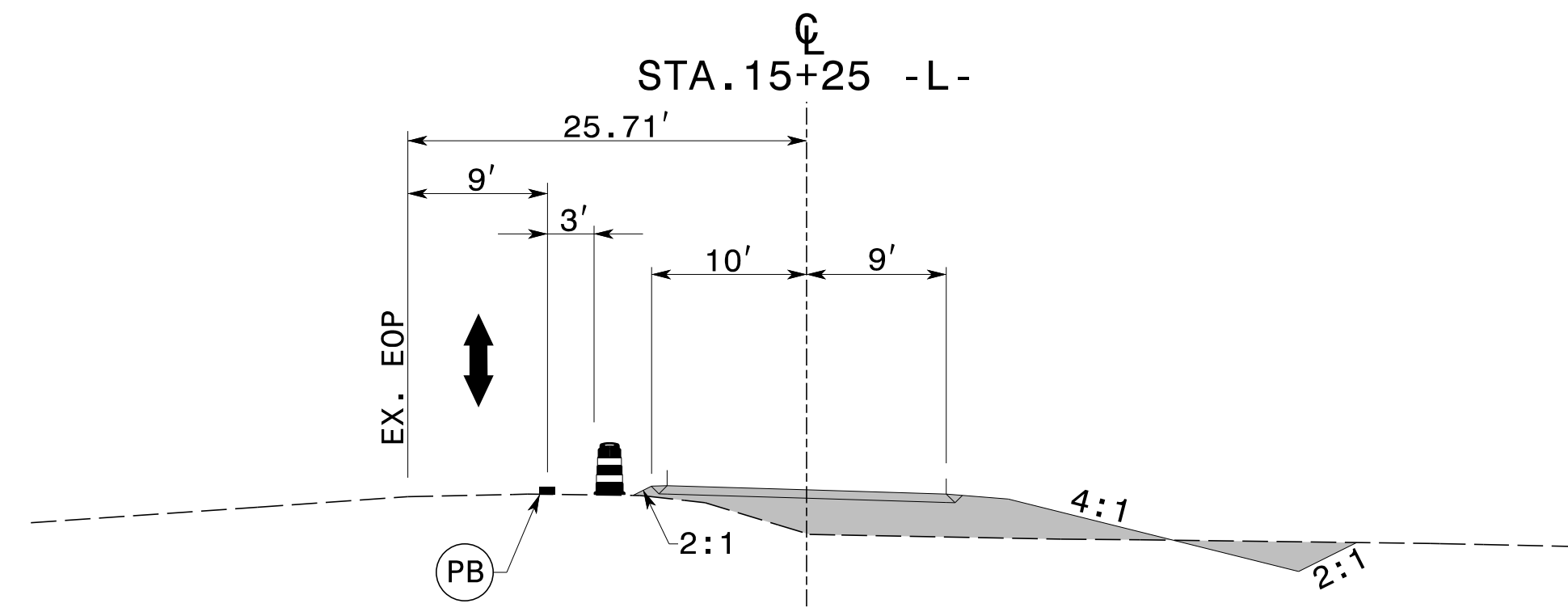

11/3/2015  
 p:\tip\projects-b\5173\traffic\trafficcontrol\top\B5173.TC\_TMP04.dgn  
 User:scodts

APPROVED: Lori D. Stouchko  
902CB018918146C

DATE: 11/3/2015

**DOCUMENT NOT CONSIDERED FINAL  
UNLESS ALL SIGNATURES COMPLETED**

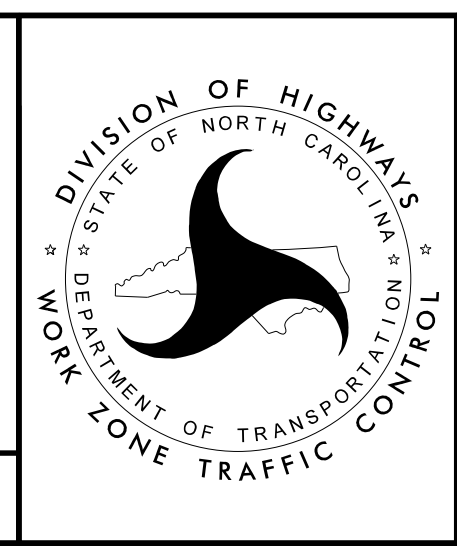

**PHASE II  
CROSS-SECTIONS**

TEMPORARY PAVEMENT MARKING LEGEND	
(PA)	PAINT - WHITE EDGELINE - (4")
(PB)	PAINT - YELLOW EDGELINE - (4")

REFER TO RSD NOS. 1205.01, 1205.02, 1250.01, AND 1251.01 FOR PLACEMENT OF TEMPORARY PAVEMENT MARKINGS AND MARKERS UNLESS NOTED OTHERWISE.

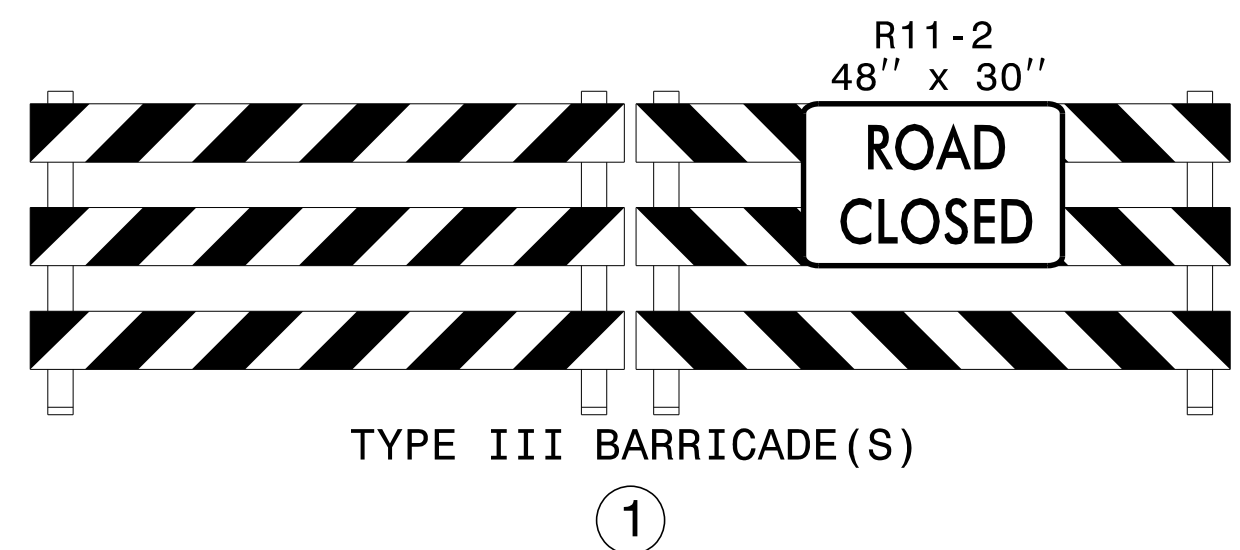
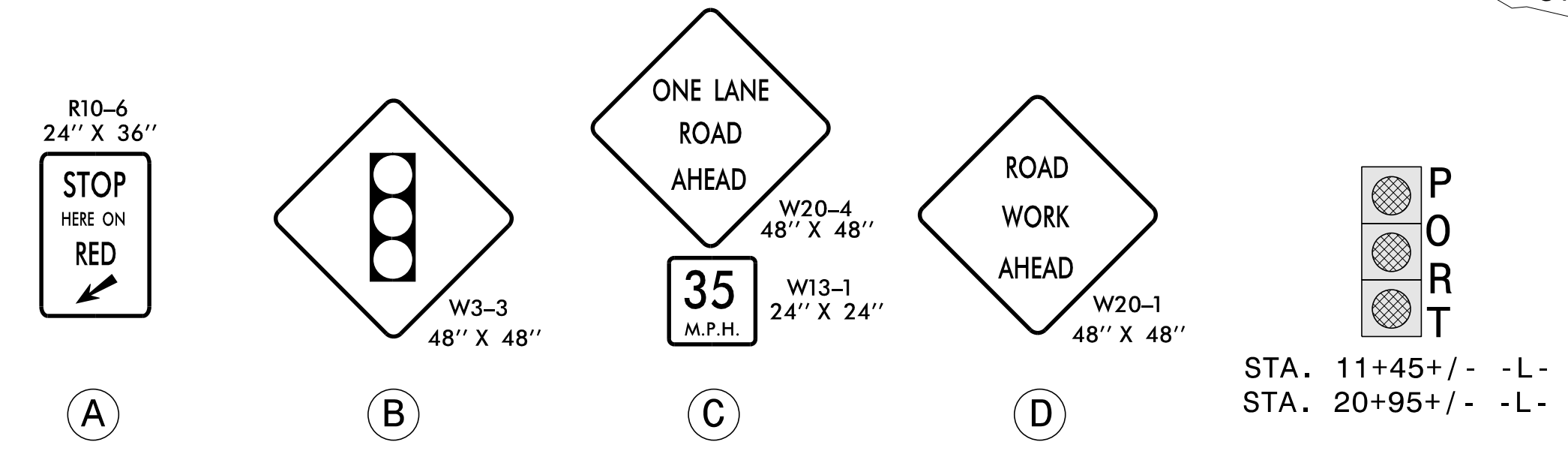
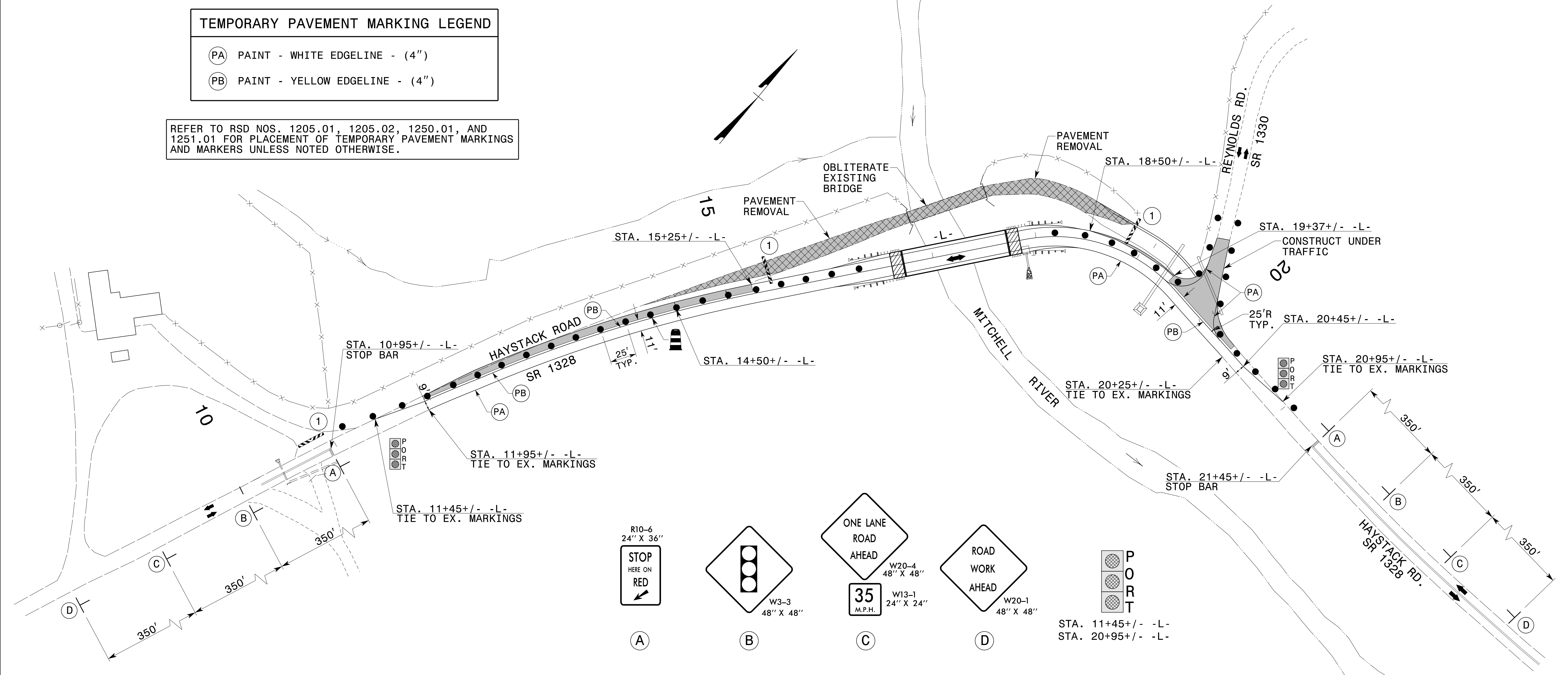

SEE TMP-6 FOR CROSS-SECTION DETAILS

11/3/2015 p:\t\p\projects-b\5173\traffic\trafficcontrol\top\B5173.TC\_TMP05.dgn User:scodts

APPROVED: Lori D. Stouchko  
902CB018918146C

DATE: 11/3/2015

**DOCUMENT NOT CONSIDERED FINAL  
UNLESS ALL SIGNATURES COMPLETED**

**PHASE III DETAILS**



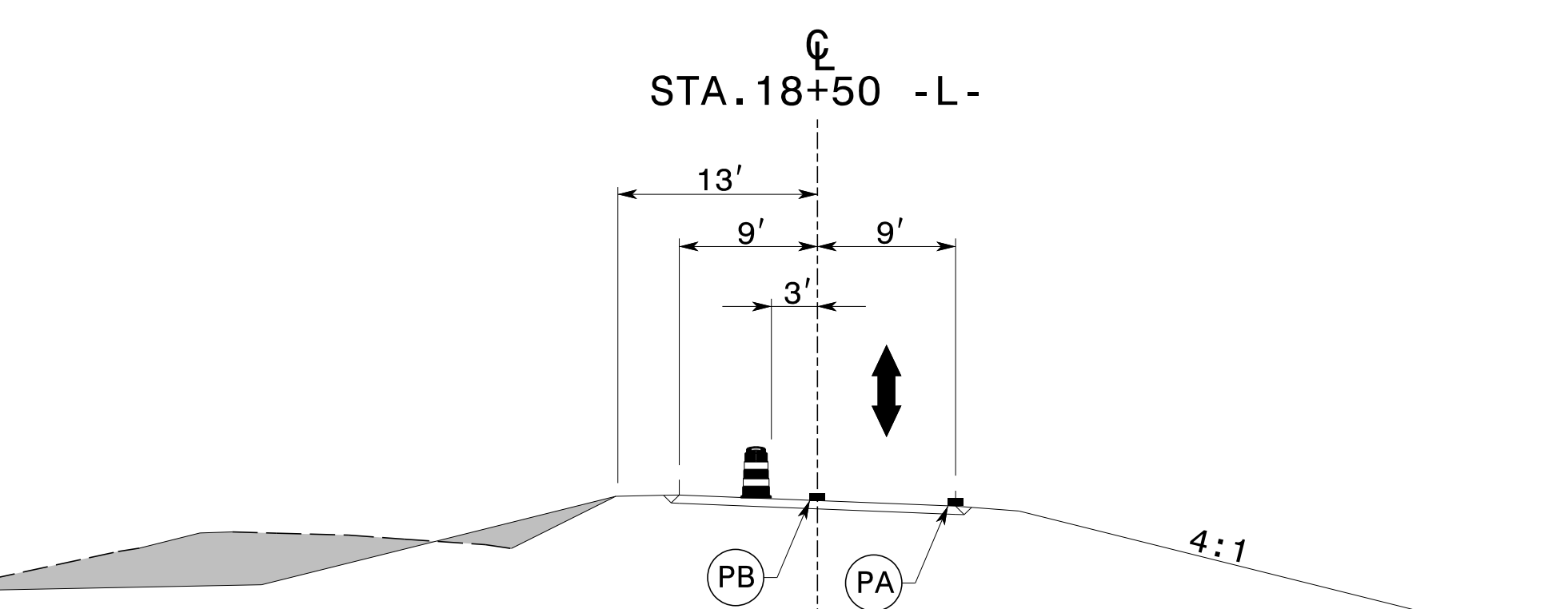
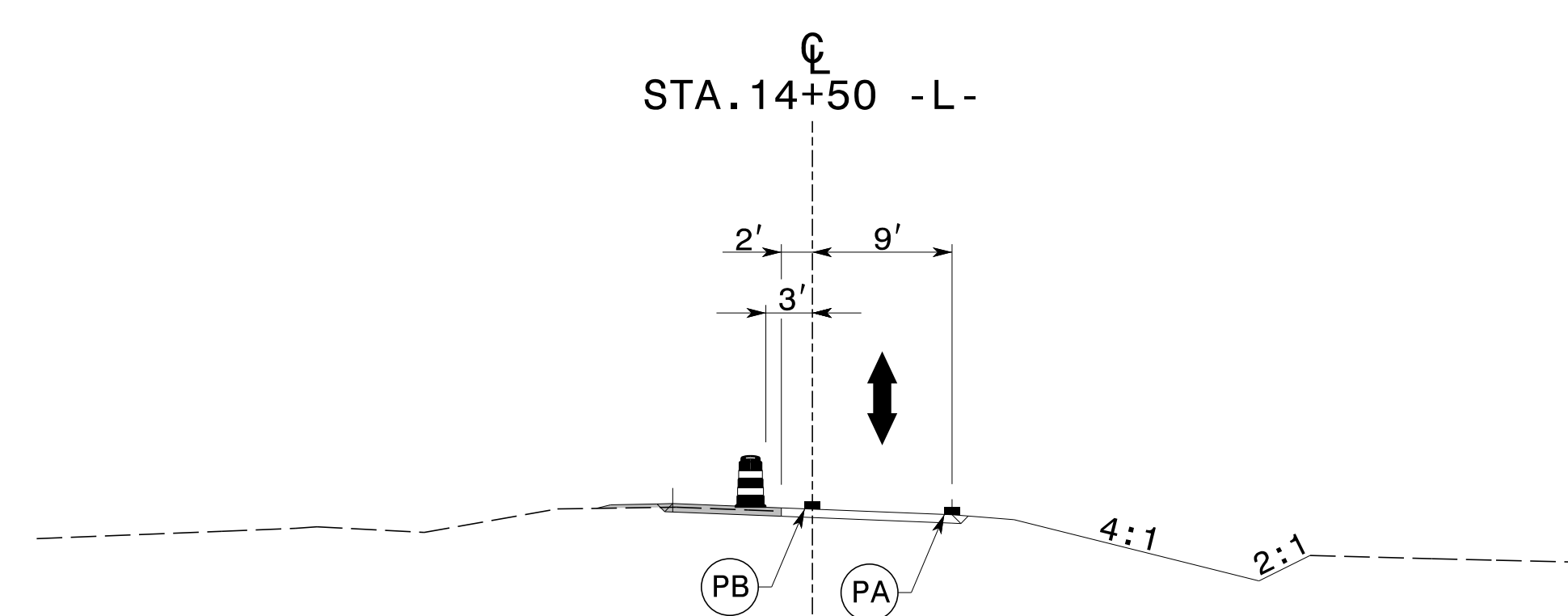
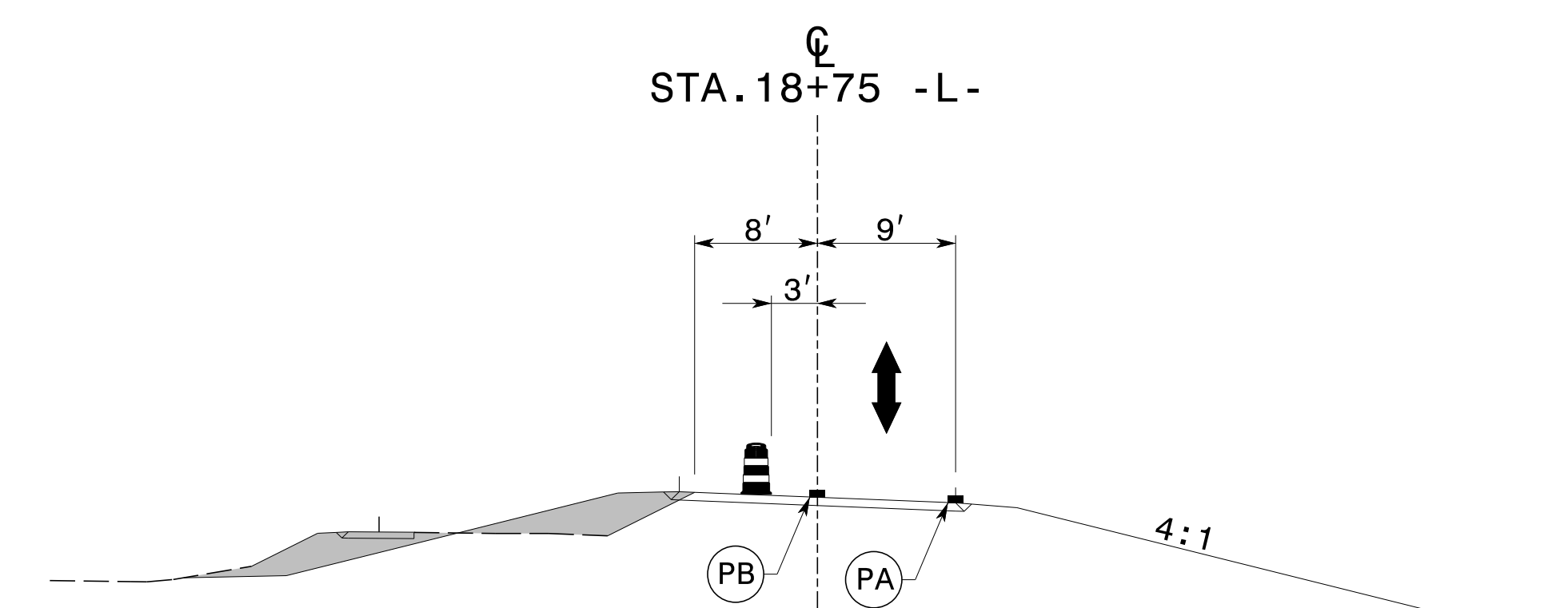
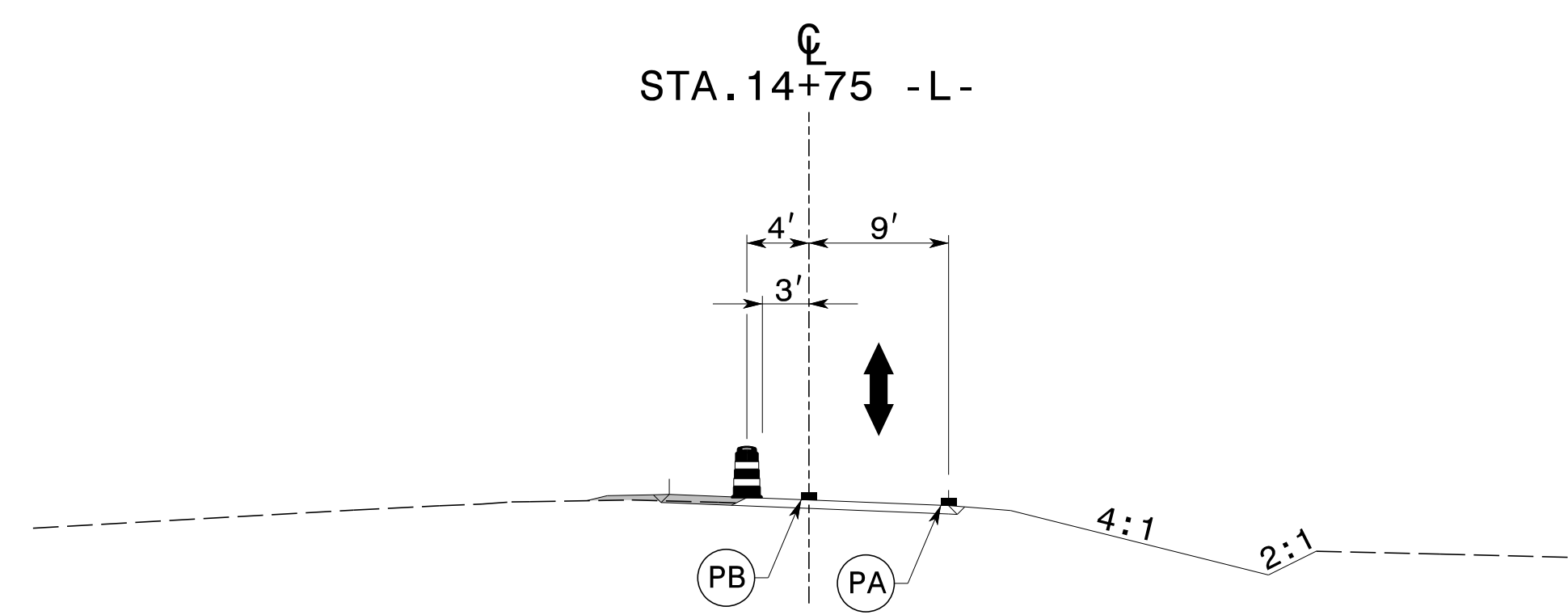
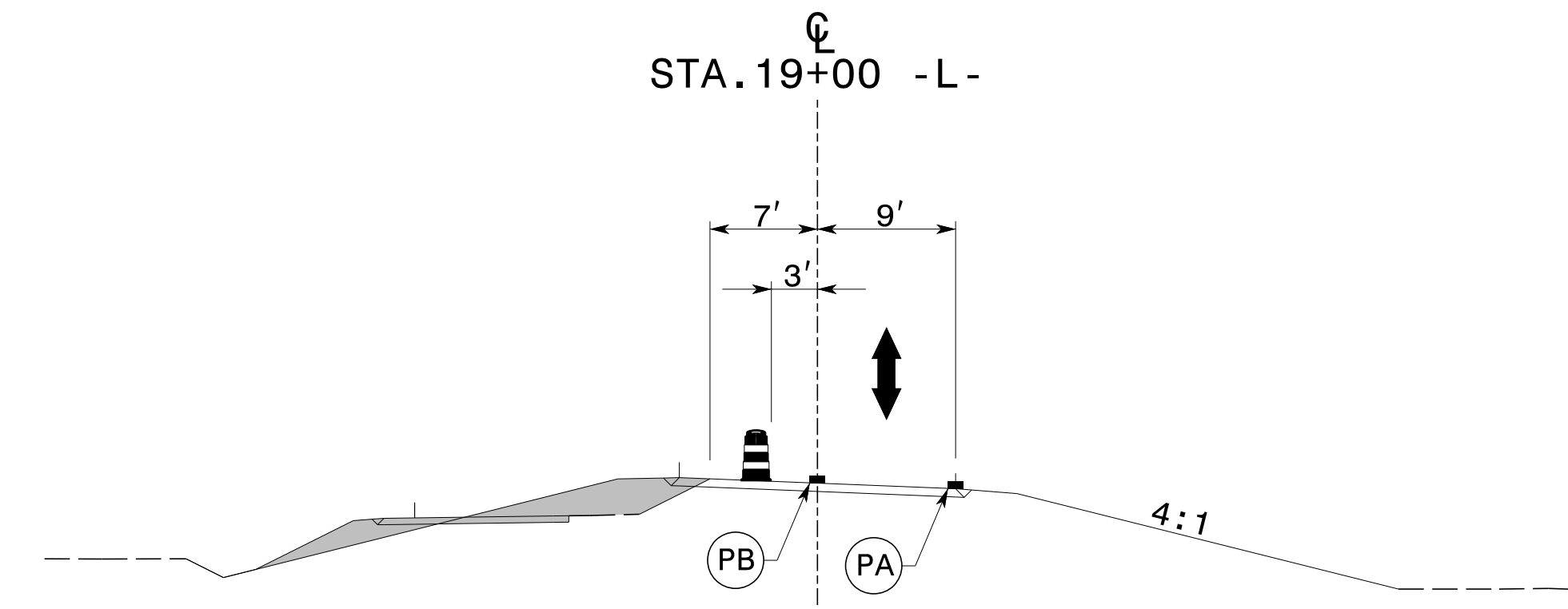
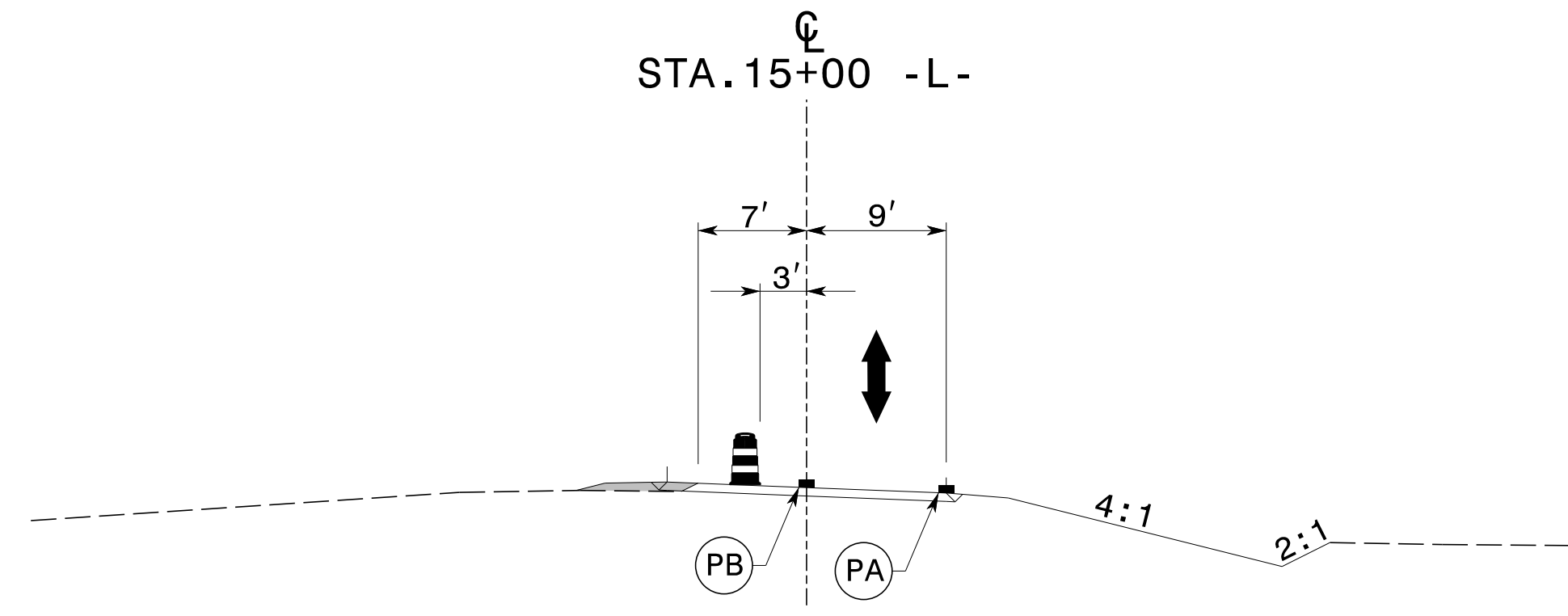
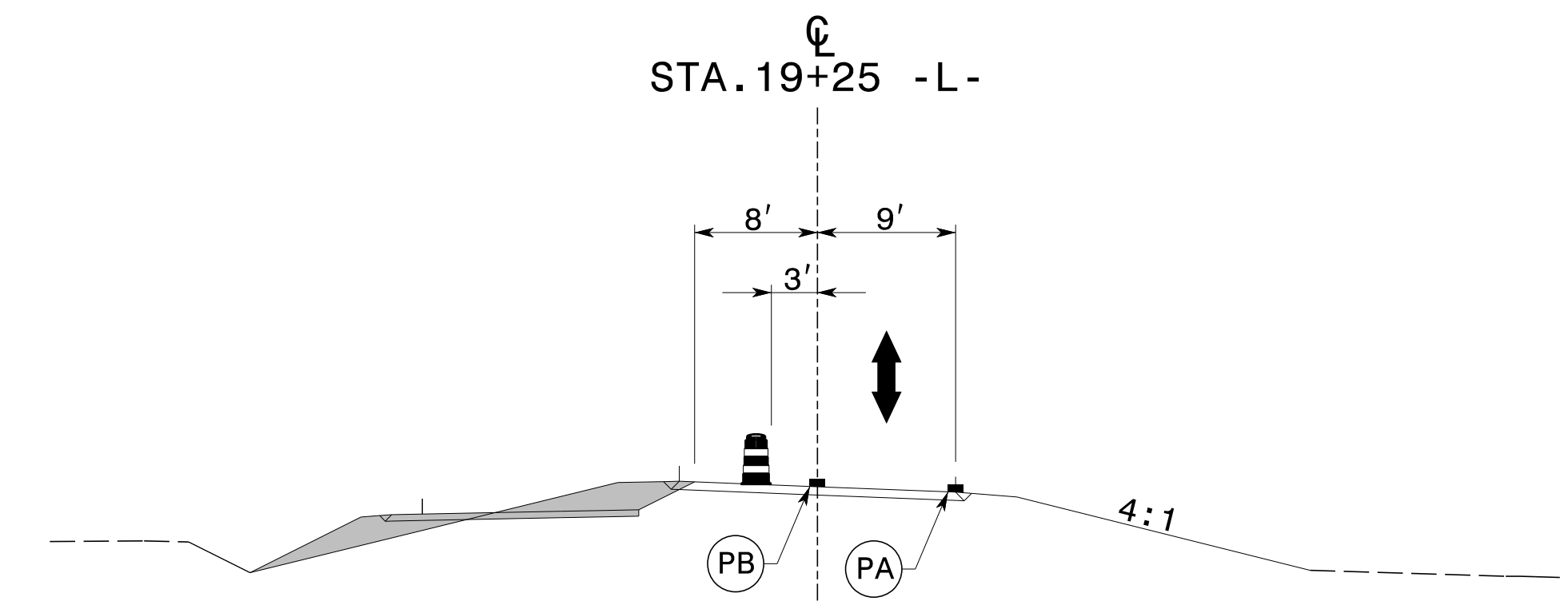
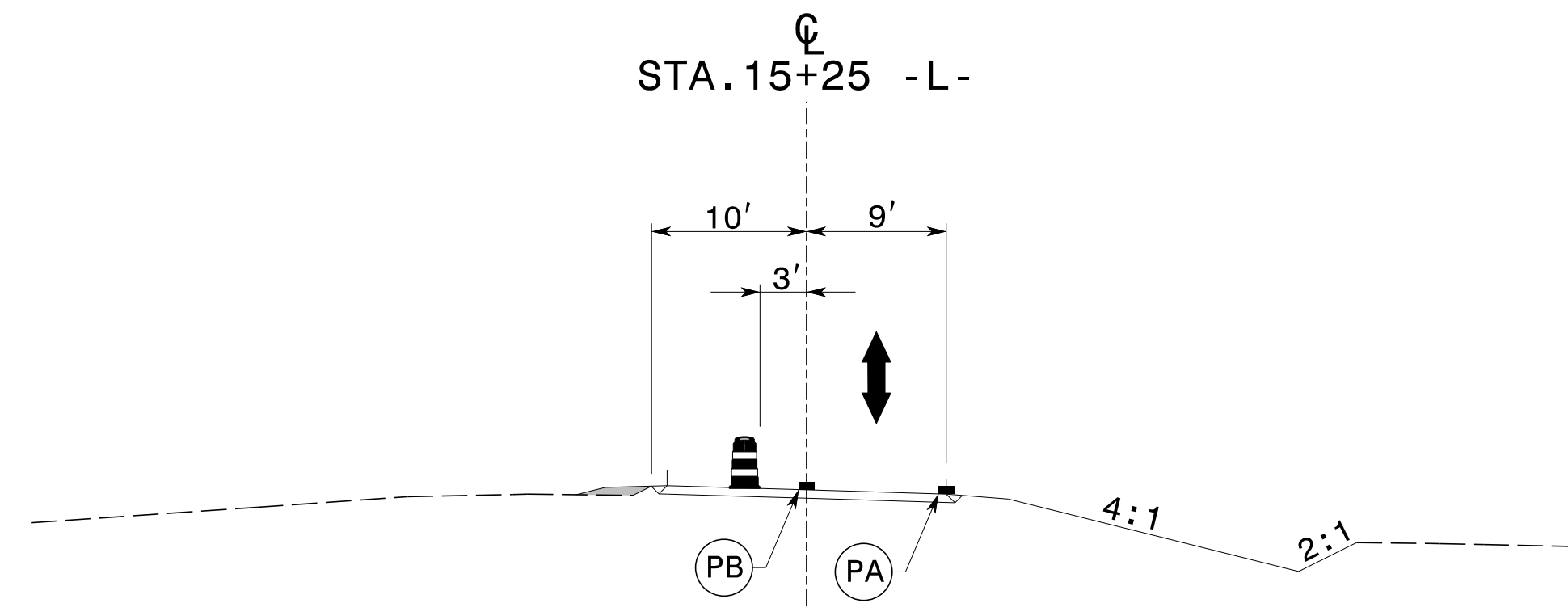

11/3/2015 p:\tip\projects-b\5173\traffic\trafficcontrol\top\B5173.TC\_TMP06.dgn User:scodts

APPROVED: *Lori D. Stouchko*  
902CB018918146C  
 DATE: 11/3/2015

**DOCUMENT NOT CONSIDERED FINAL  
UNLESS ALL SIGNATURES COMPLETED**

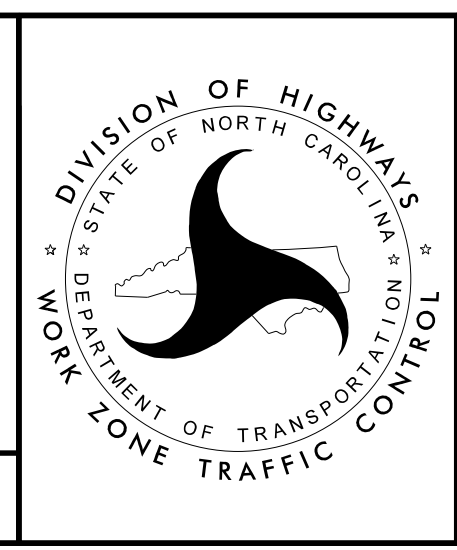

**PHASE III  
CROSS-SECTIONS**