

TEMPORARY PAVEMENT MARKING LEGEND	
(PA)	PAINT - WHITE EDGELINE - (4")
(PB)	PAINT - YELLOW EDGELINE - (4")
(PI)	PAINT - YELLOW DOUBLE CENTER - (4")
(P2)	PAINT - WHITE STOP BAR - (24")

REFER TO RSD NOS. 1205.01, 1205.02, 1250.01, AND 1251.01 FOR PLACEMENT OF TEMPORARY PAVEMENT MARKINGS AND MARKERS UNLESS NOTED OTHERWISE.

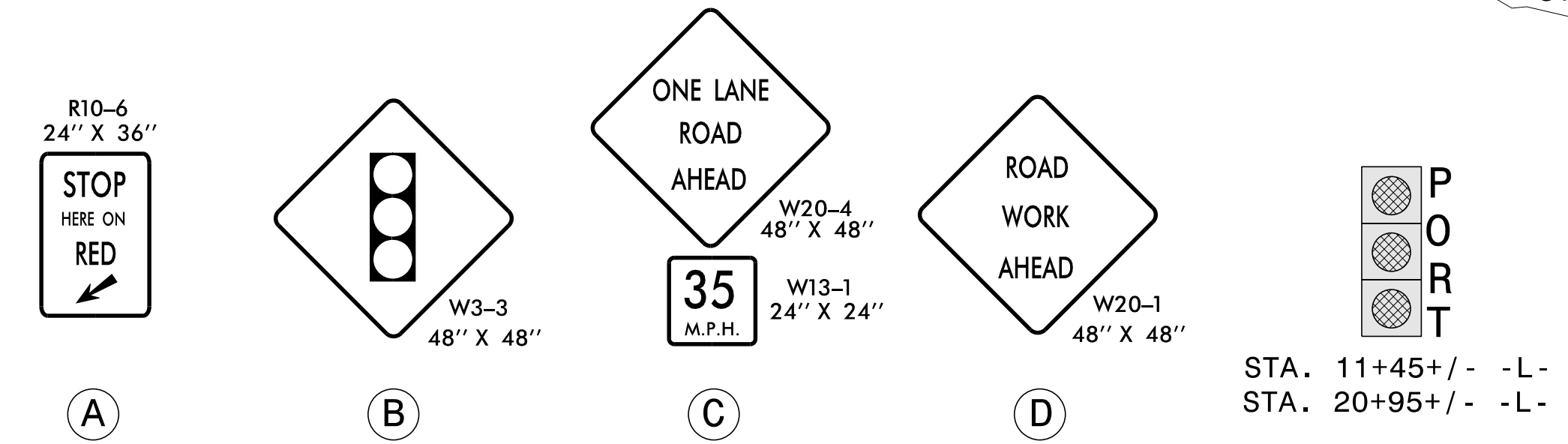

SEE TMP-4 FOR CROSS-SECTION DETAILS

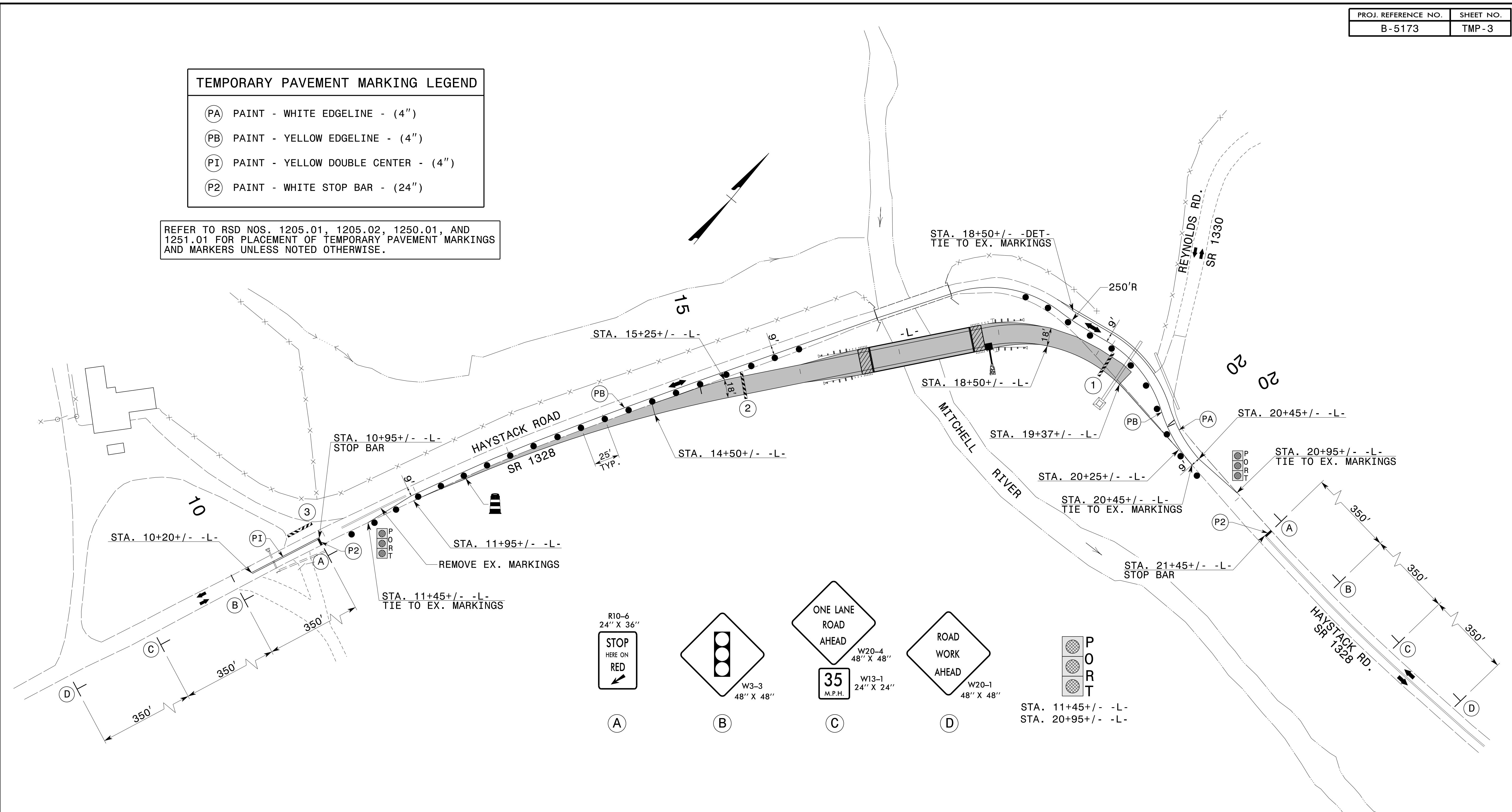
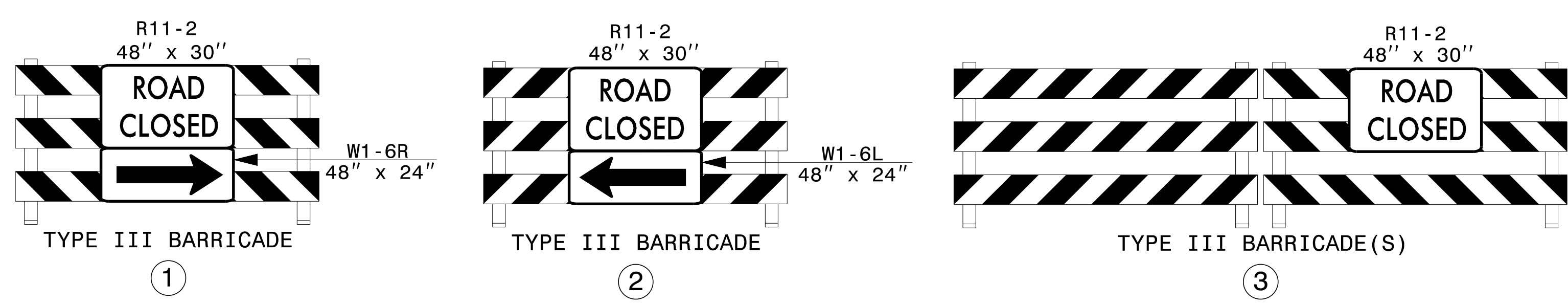

APPROVED: *Lois D. Stouchko*  
902C8018918146C  
 DATE: 11/3/2015

**DOCUMENT NOT CONSIDERED FINAL  
UNLESS ALL SIGNATURES COMPLETED**

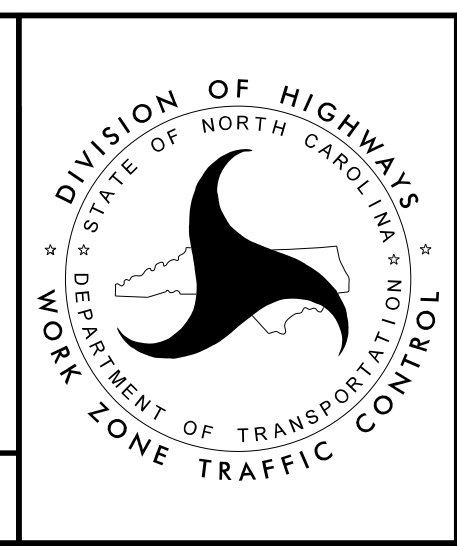

**PHASE II DETAILS**

11/3/2015 p:\tip\projects-b\5173\traffic\trafficcontrol\top\B5173.TC\_TMP03.dgn User:scodts