

PROJECT REFERENCE NO. 1-5741	SHEET NO. 6
RW SHEET NO.	
ROADWAY DESIGN ENGINEER WILLIAM A. BLANTON SEAL 025499 1/5/2016	HYDRAULICS ENGINEER GLEN LAIL SEAL 022000 1/7/2016
DocuSigned by: William A. Blanton	DocuSigned by: Glen Lail

DOCUMENT NOT CONSIDERED FINAL
UNLESS ALL SIGNATURES COMPLETED

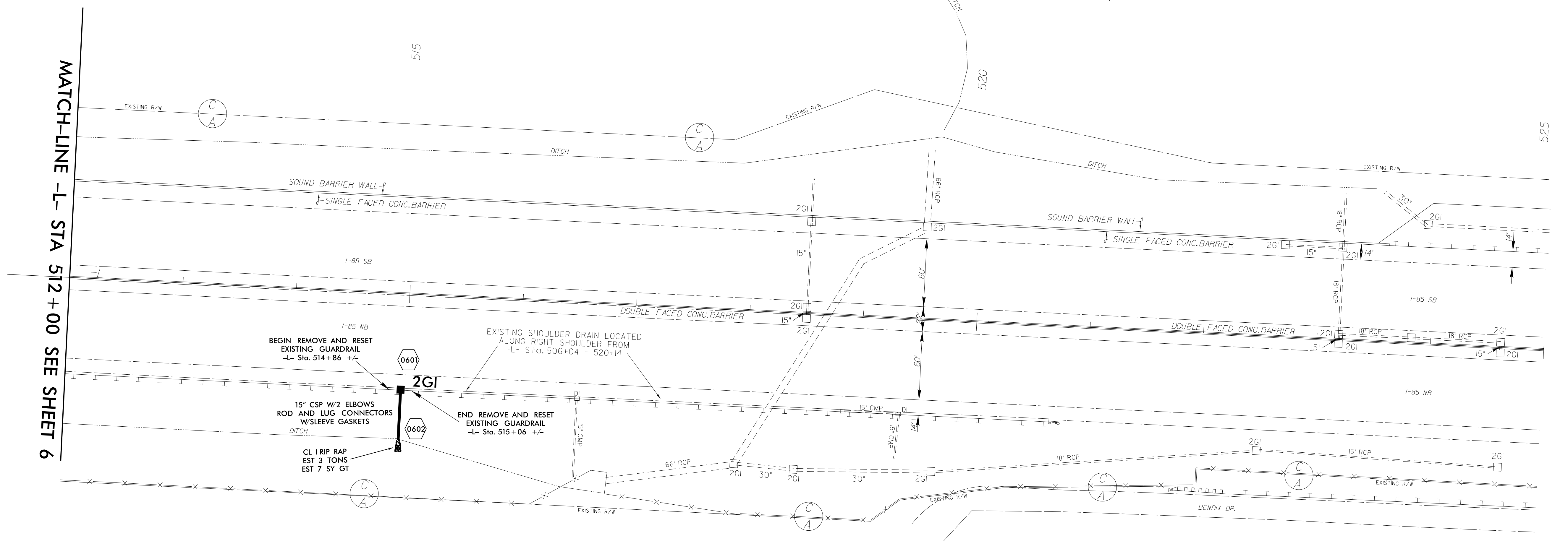
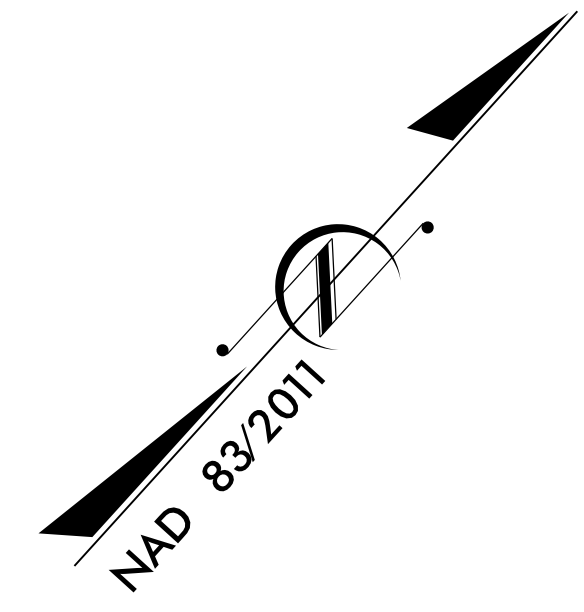

MATCH-LINE -L- STA 512+00 SEE SHEET 6

BEGIN REMOVE AND RESET EXISTING GUARDRAIL
-L- Sta. 514+86 +/-

15" CSP W/2 ELBOWS ROD AND LUG CONNECTORS W/SLEEVE GASKETS

CL 1 RIP RAP EST 3 TONS EST 7 SY GT

EXISTING SHOULDER DRAIN LOCATED ALONG RIGHT SHOULDER FROM
-L- Sta. 506+04 - 520+14

END REMOVE AND RESET EXISTING GUARDRAIL
-L- Sta. 515+06 +/-

-L-

PI Sta 498+63.61
 $\Delta = 5^\circ 32' 16.4" (RT)$
 $D = 0' 15' 00.0"$
 $L = 2,215.16'$
 $T = 1,108.44'$
 $R = 22,918.31'$

REVISIONS

8/17/99

23-DEC-2016 14:57 I:\5505-1 85-Rovam\Plansheets\15505-dbc-ps16.dgn