

EXIT 63 RAMP A - I-74/US 311

PROJ. REFERENCE NO.	SHEET NO.
I-5736/I-5767	TMP-8

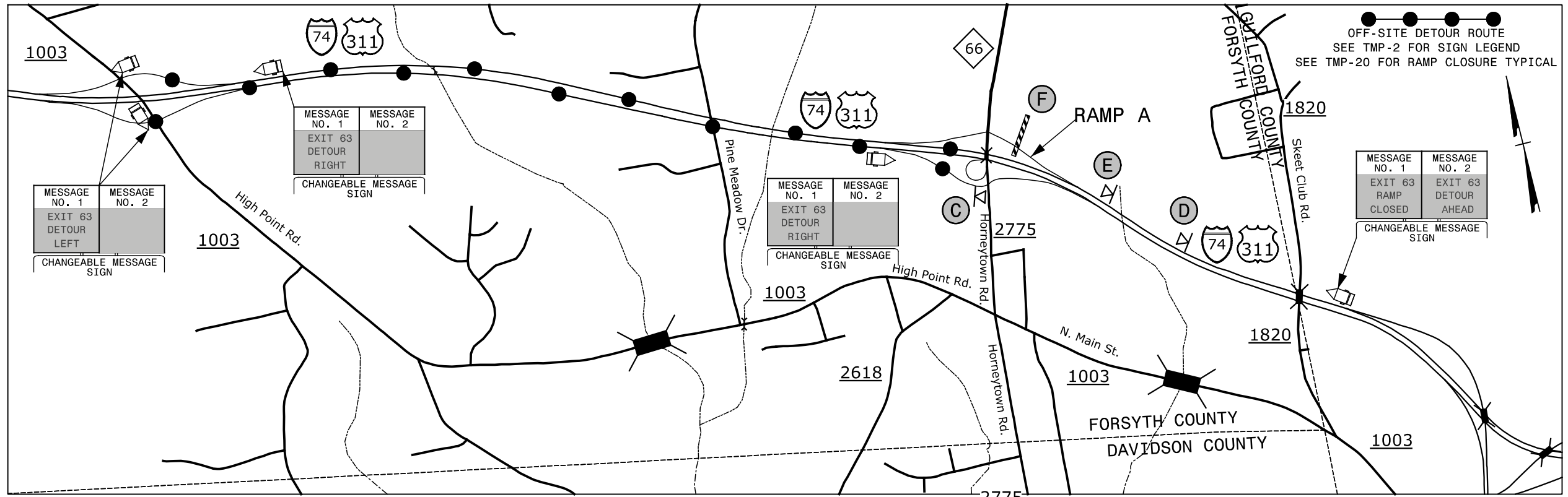

EXIT 63 RAMP B - I-74/US 311

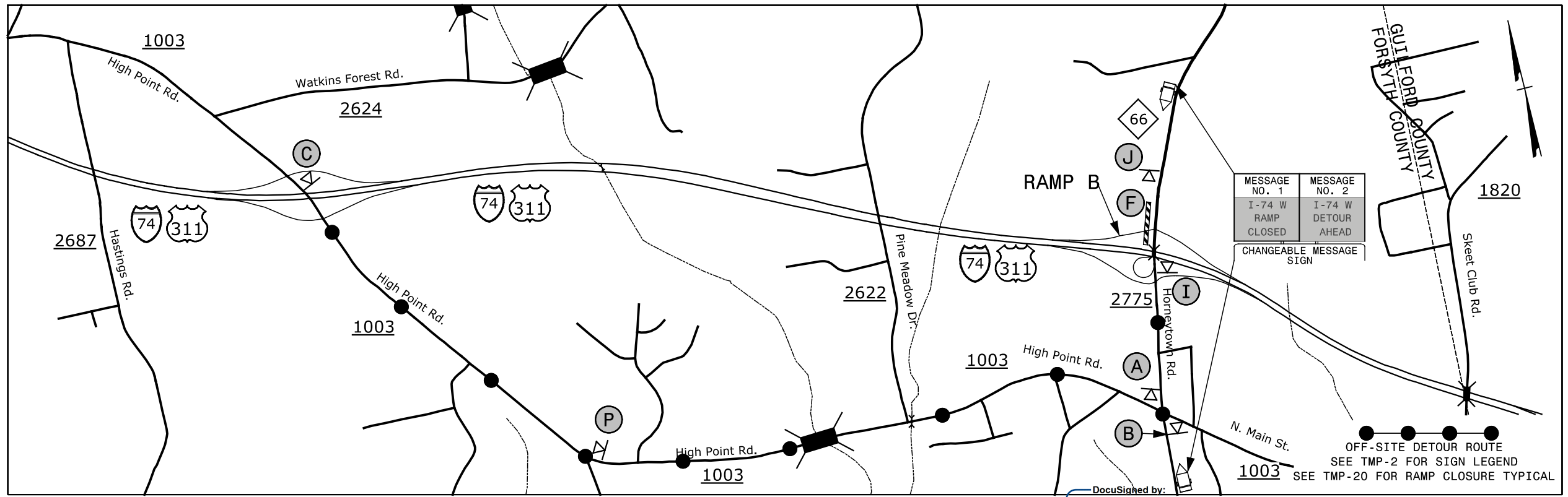

11/9/2015 G:\Traf\I-5736 TMP\I-5767 & I-5736 TMP\I-5767_5736 TMP-8.dgn

<p>SEPI ENGINEERING & CONSTRUCTION</p> <p>1025 Wade Avenue Raleigh, NC 27605 Tel: 919-789-9977 Fax: 919-789-9591 License: C-2197</p>	<p>APPROVED: <i>Steve Miller</i></p> <p>DATE: 11/9/2015</p> <p>SEAL</p>			<p>EXIT 63 NC 66 DETOUR</p>
	<p>DocuSigned by: [Signature]</p>			