

**This electronic collection of documents is provided
for the convenience of the user
and is Not a Certified Document –**

**The documents contained herein were originally issued
and sealed by the individuals whose names and license
numbers appear on each page, on the dates appearing
with their signature on that page.**

**This file or an individual page
shall not be considered a certified document.**

TIP PROJECT: W-5518

STATE OF NORTH CAROLINA
DIVISION OF HIGHWAYS

T.I.P. NO.	SHEET NO.
W-5518	UO-1

**UTILITIES BY OTHERS PLANS
COLUMBUS COUNTY**

LOCATION: CONSTRUCT OVERPASS OF SR 1574 (OLD US 74) OVER US 74
TYPE OF WORK: ELECTRIC POWER & COMMUNICATIONS

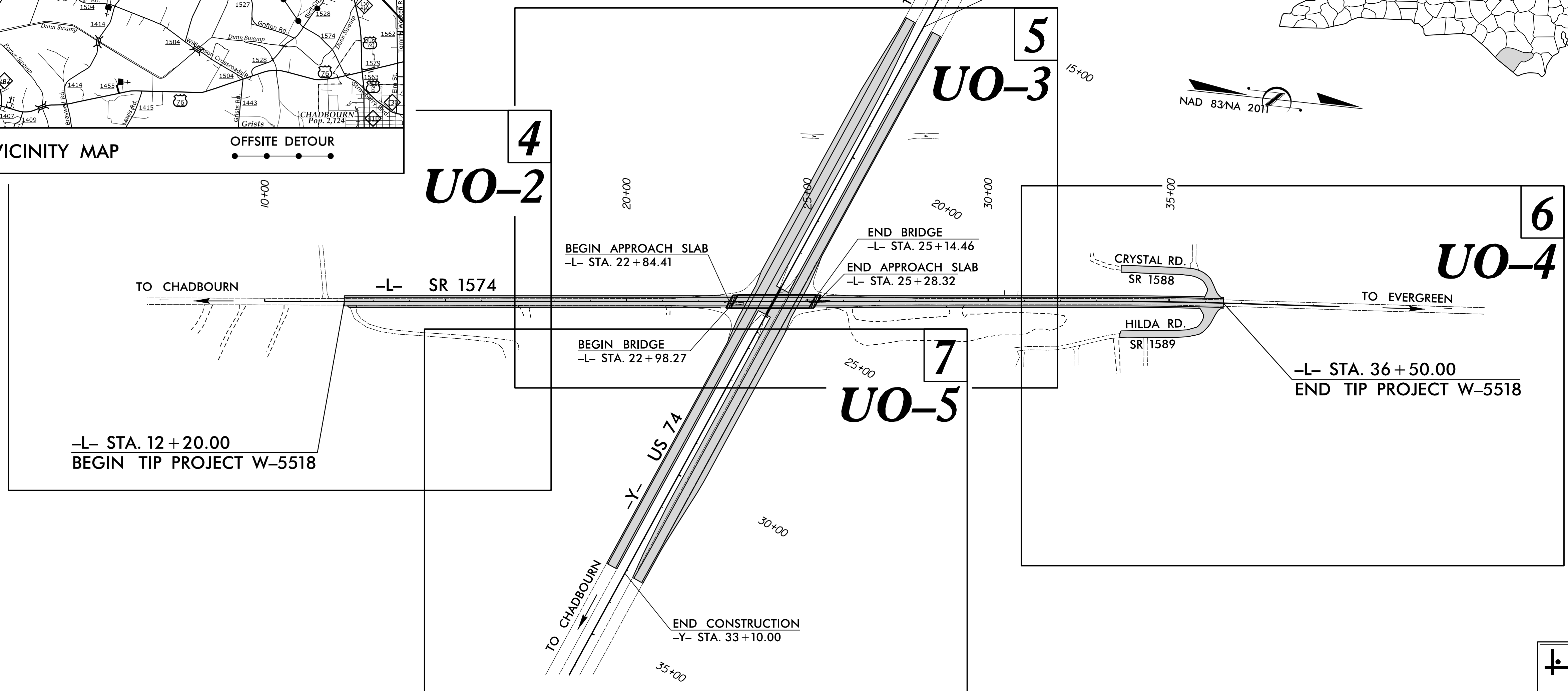
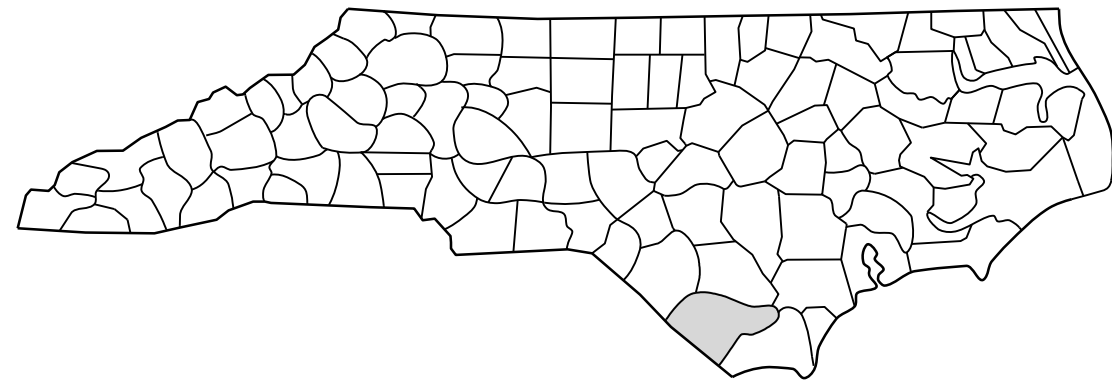
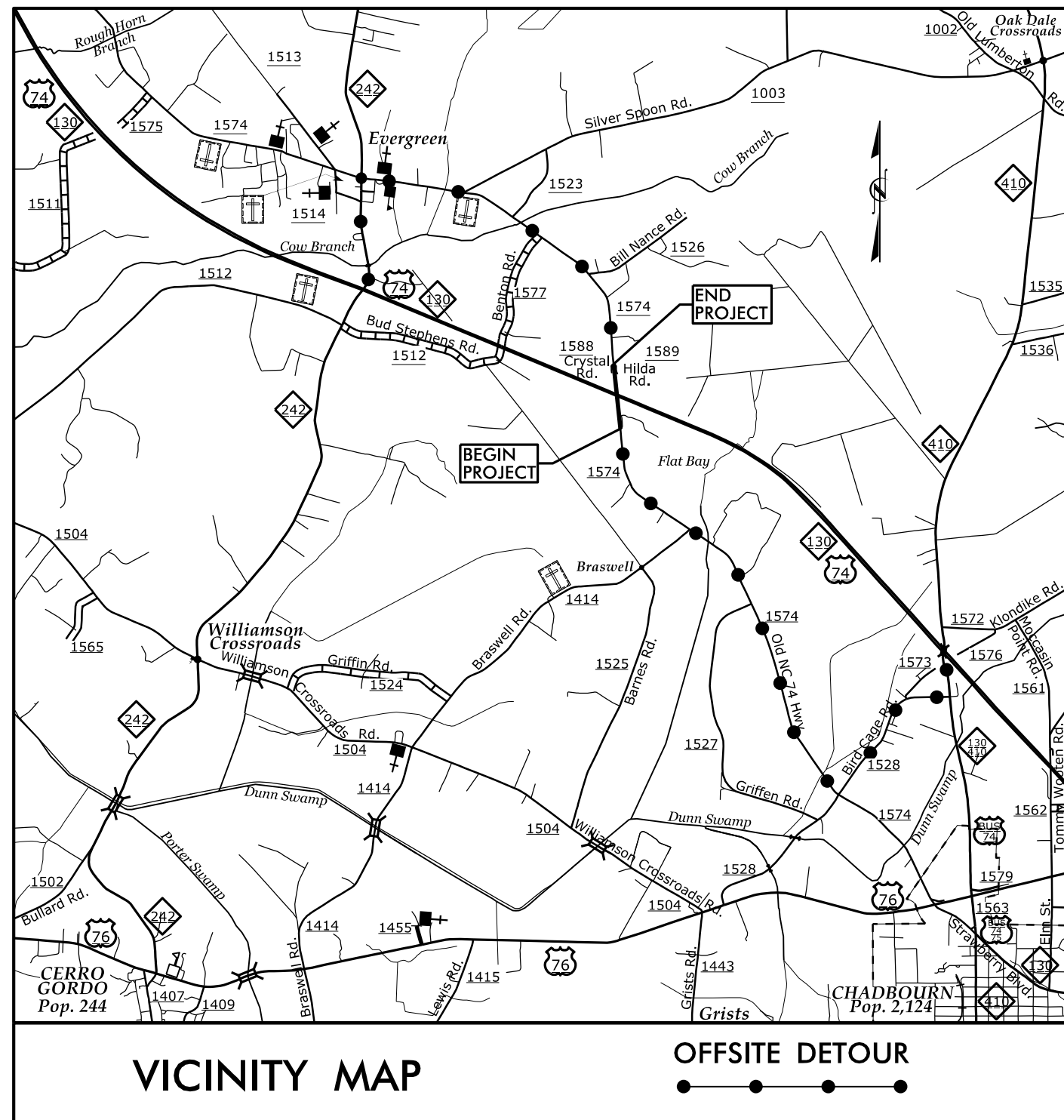

THIS IS A CONTROLLED-ACCESS PROJECT WITH ACCESS BEING LIMITED TO INTERCHANGES.

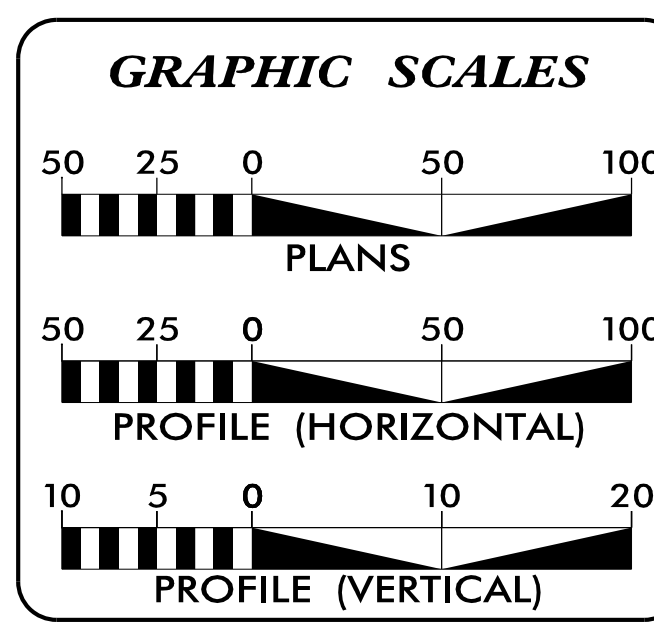

INDEX OF SHEETS

SHEET NO.	DESCRIPTION
UO-1	TITLE SHEET
UO-2 THRU UO-5	UBO PLAN SHEETS

UTILITY OWNERS ON PROJECT

- (A) DUKE ENERGY - POWER (DISTRIBUTION)
- (B) CENTURYLINK - COMMUNICATIONS
- (C) MCNC - COMMUNICATIONS

PREPARED IN THE OFFICE OF:

Michael E. Davis UTILITY COORDINATION PROJECT MANAGER
Todd E. Butner PROJECT UTILITY COORDINATOR
James N. Arnold PROJECT UTILITY DESIGNER

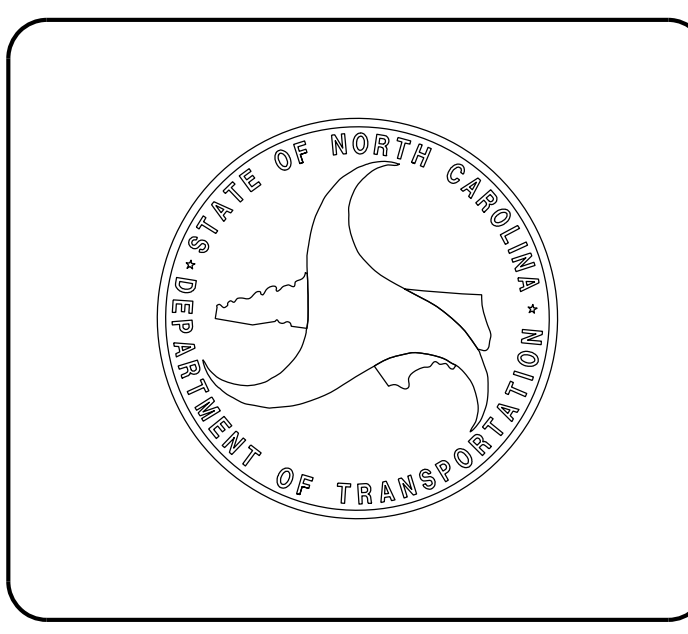

I5-DEC-2015 11:04 C:\Users\jmulkey\Documents\Projects\2014\A20141202.00 Mulkey - Chadbourne-W-5518\Design\Utilities\Engineering\UBO\Proj\W5518_ut_1.tsh_U001.psh.dgn

UTILITIES BY OTHERS

NOTE:
 ALL PROPOSED UTILITY WORK SHOWN ON THIS SHEET WILL BE DONE BY OTHERS. NO PAYMENT WILL BE MADE TO THE CONTRACTOR FOR PROPOSED UTILITY WORK SHOWN ON THIS SHEET.

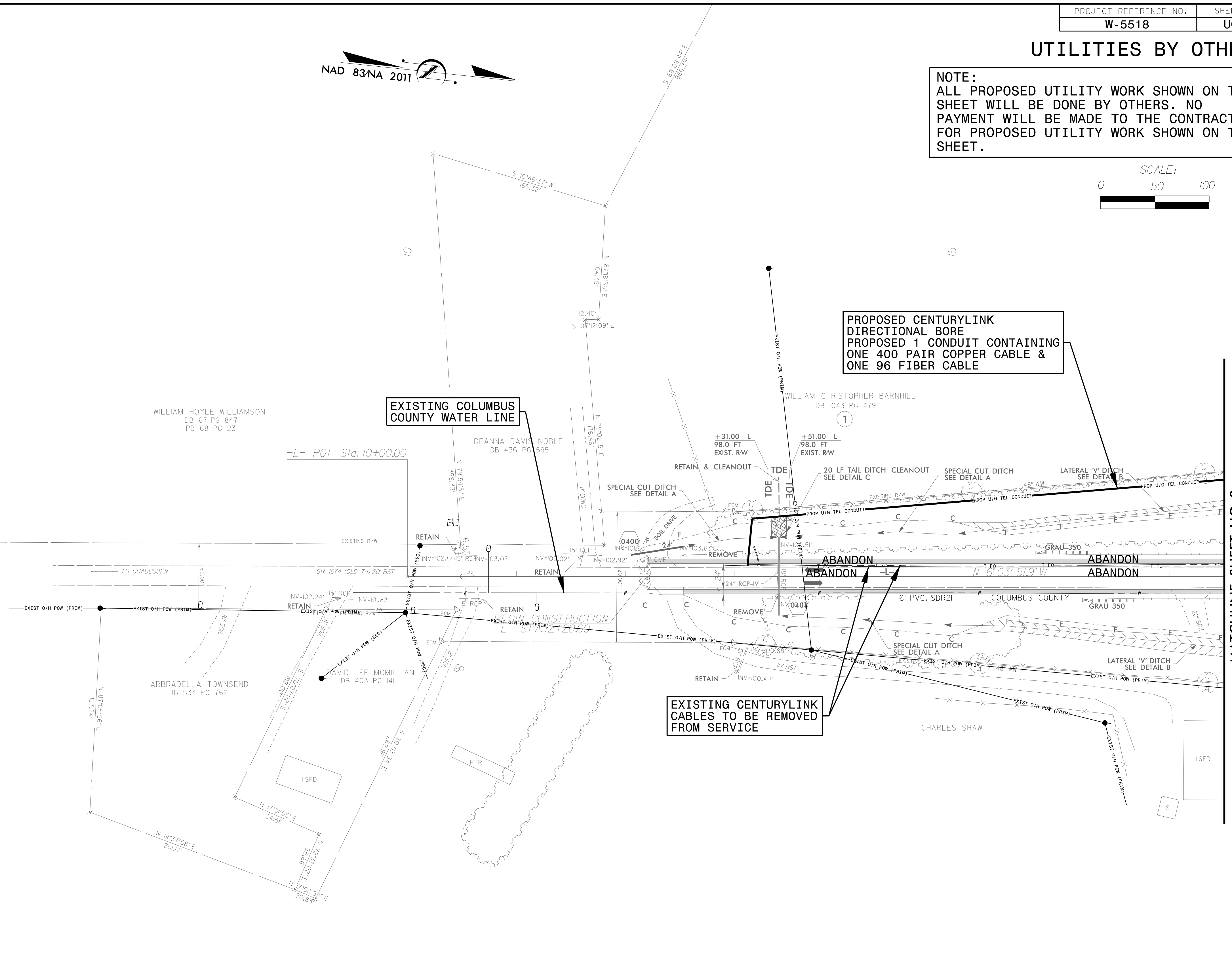

MATCHLINE SHEET U0-3
-L- STA. 17+50.00

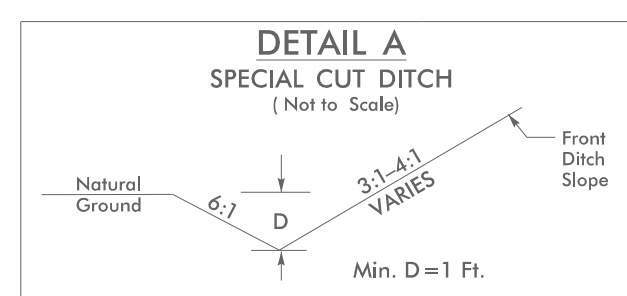

-L- STA. 12+53.00 TO STA. 15+50.00 LT
 -L- STA. 13+41.00 TO STA. 15+50.00 RT

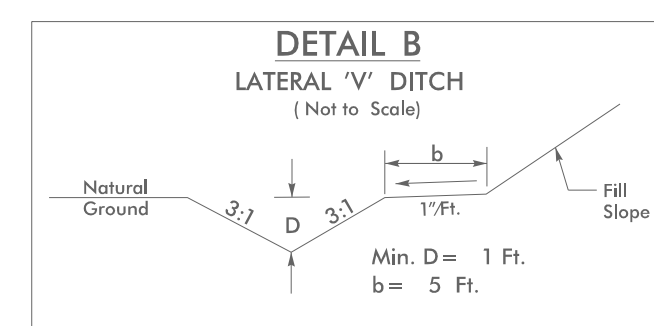

FROM STA. 15+50.00 TO STA. 23+00.00 LT; DDE=227 CY
 FROM STA. 15+50.00 TO STA. 22+55.00 RT; DDE=370 CY

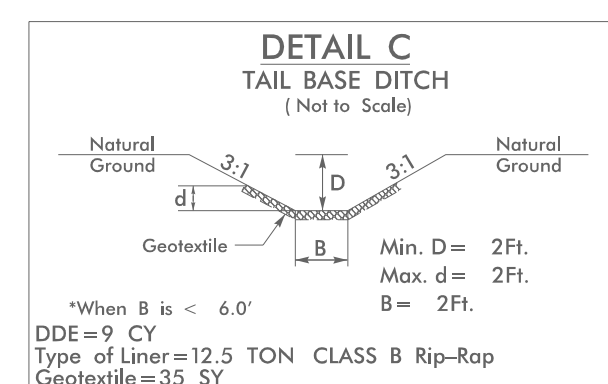

-L- STA. 13+41 LT

I:\DEC-2015\PROJECTS\2014\A20141202\00_Mulkey - Chadbourn-W-5518\Design\Utilities\Engineering\UB01\ProJ\W5518-ut-rcdy4_U002_psh.dgn

UTILITIES BY OTHERS

NOTE:
ALL PROPOSED UTILITY WORK SHOWN ON THIS SHEET WILL BE DONE BY OTHERS. NO PAYMENT WILL BE MADE TO THE CONTRACTOR FOR PROPOSED UTILITY WORK SHOWN ON THIS SHEET.



-L-
PI Sta. 35+09.29
 $\Delta = 1'43''16.7''(RT)$
 $D = 0'35''13.4''$
 $L = 293.21'$
 $T = 146.62'$
 $R = 9760.00'$

EXISTING COLUMBUS COUNTY WATER LINE

DUKE ENERGY TO REPLACE EXISTING 35/5 POLE WITH PROPOSED 50/3 POLE

DUKE ENERGY TO REPLACE EXISTING 35/5 POLE WITH PROPOSED 50/3 POLE

PROPOSED CENTURYLINK DIRECTIONAL BORE PROPOSED 1 CONDUIT CONTAINING ONE 400 PAIR COPPER CABLE & ONE 96 FIBER CABLE

EXISTING CENTURYLINK CABLES TO BE REMOVED FROM SERVICE

DUKE ENERGY TO REPLACE EXISTING 35/5 POLE WITH PROPOSED 50/3 POLE

MATCHLINE SHEET UO-3
-L- STA. 31 + 50.00

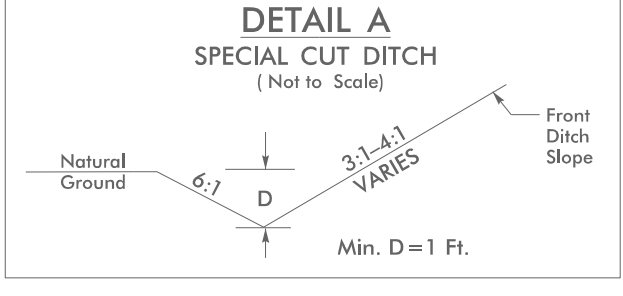
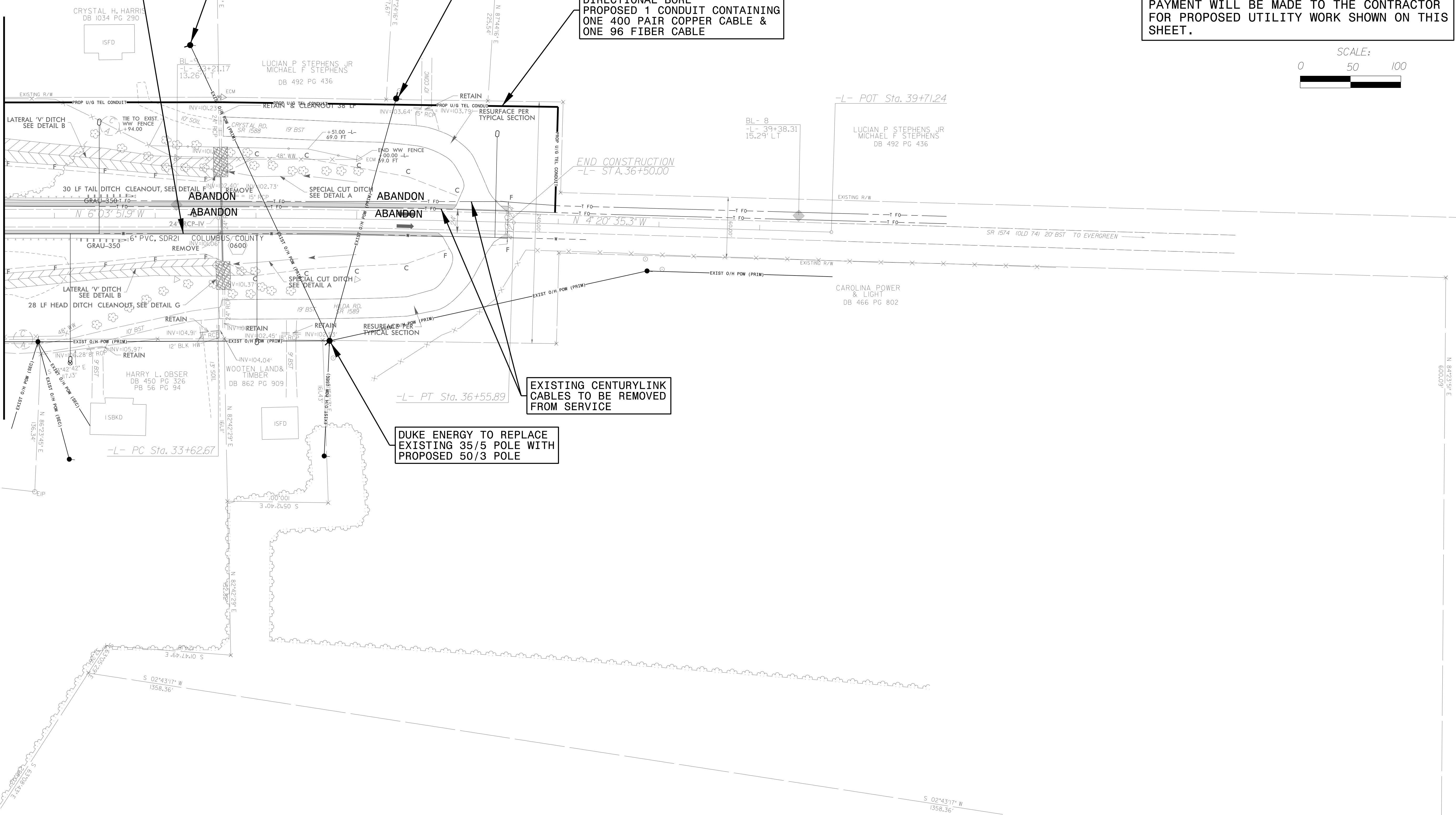

-L- STA. 33+65.00 TO STA. 35+00.00 LT
-L- STA. 33+67.00 TO STA. 35+00.00 RT

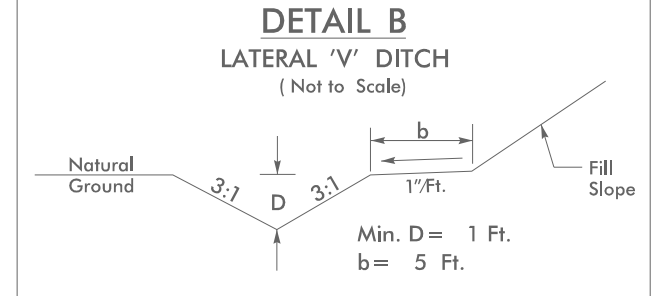

FROM STA. 25+50.00 TO STA. 33+67.00 RT; DDE=740 CY
FROM STA. 26+05.00 TO STA. 28+00.00 LT; DDE=150 CY
FROM STA. 29+50.00 TO STA. 33+65.00 LT; DDE=550 CY

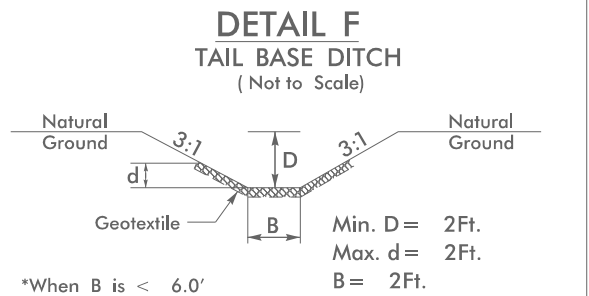

*When B is < 6.0'
DDE=14 CY
Type of Liner=19 TON CLASS B Rip-Rap
Geotextile=53 SY
-L- STA. 33+65 LT

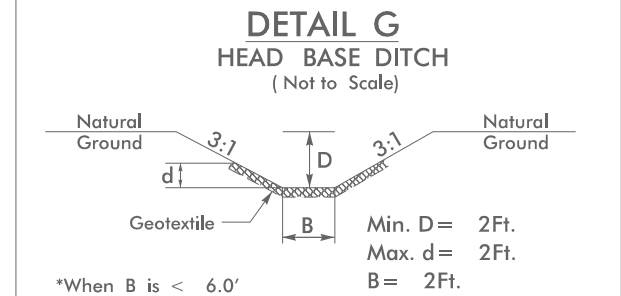

*When B is < 6.0'
DDE=13 CY
Type of Liner=17.5 TON CLASS B Rip-Rap
Geotextile=49 SY
-L- STA. 33+67 RT

I:\DEC-2015-08-47\PROJECTS\2014\A20141202\00_Mulkey - Chadbourn-W-5518\Design\Utilities\Engineering\UB01\Proj\W5518-ut-rd\j6_U004_psh.dgn

UTILITIES BY OTHERS

NOTE:
 ALL PROPOSED UTILITY WORK SHOWN ON THIS SHEET WILL BE DONE BY OTHERS. NO PAYMENT WILL BE MADE TO THE CONTRACTOR FOR PROPOSED UTILITY WORK SHOWN ON THIS SHEET.



MATCHLINE SHEET UO-3
 -Y- STA. 26+50.00
 MATCHLINE SHEET UO-3
 -Y- STA. 26+50.00

EXISTING MCNC FIBER OPTIC CABLE

END CONSTRUCTION
 -Y- STA. 33+10.00

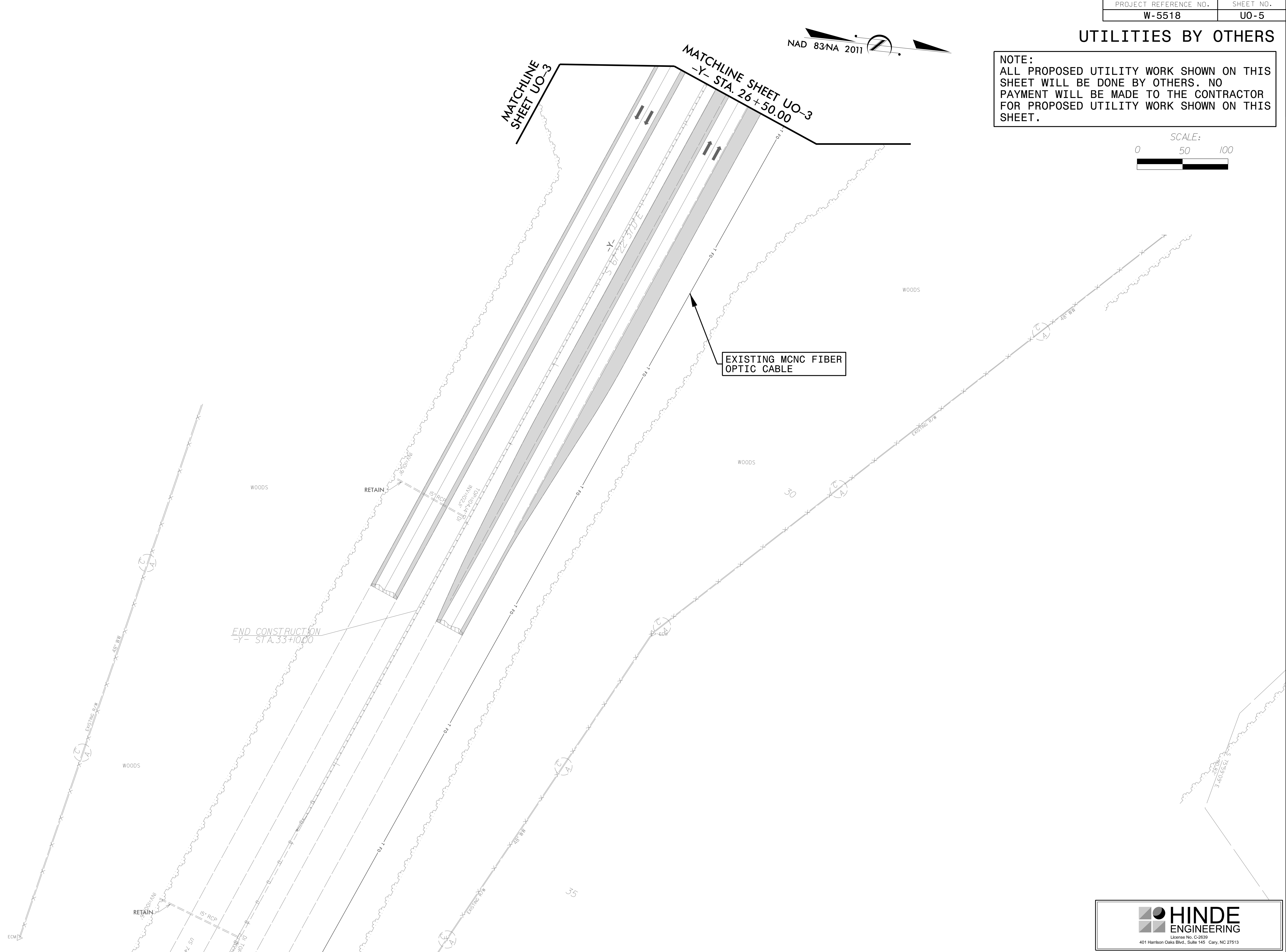

I:\DEC-2015_0848\PROJECTS\2014\A20141202\00_Mulkey - Chadbourn-W-5518\Design\Utilities\Engineering\UB0\Proj\W5518-ut.rdy7_U005_psh.dgn
 8:58:51 AM 12/15/2015