

SURVEY CONTROL SHEET B-5244

PROJECT REFERENCE NO.	SHEET NO.
B-5244	1C-1
Location and Surveys	

BL	POINT	DESC.	NORTH	EAST	ELEVATION	L STATION	OFFSET
	2	BL-2	640300.3422	963469.6980	2124.60	11+41.42	15.54 LT
	1	BL-1	640487.4932	963622.1611	2125.07	13+80.45	11.45 LT
	GPS2	B5244-2	640770.6660	963975.4760	2129.70	OUTSIDE PROJECT LIMITS	

.....
 BM1 ELEVATION = 2123.63
 N 640432 E 963641
 L STATION 13+52.09 39.80' RIGHT
 RR SPIKE SET IN BASE OF A 18"
 CHERRY TREE ACROSS FROM BL-2

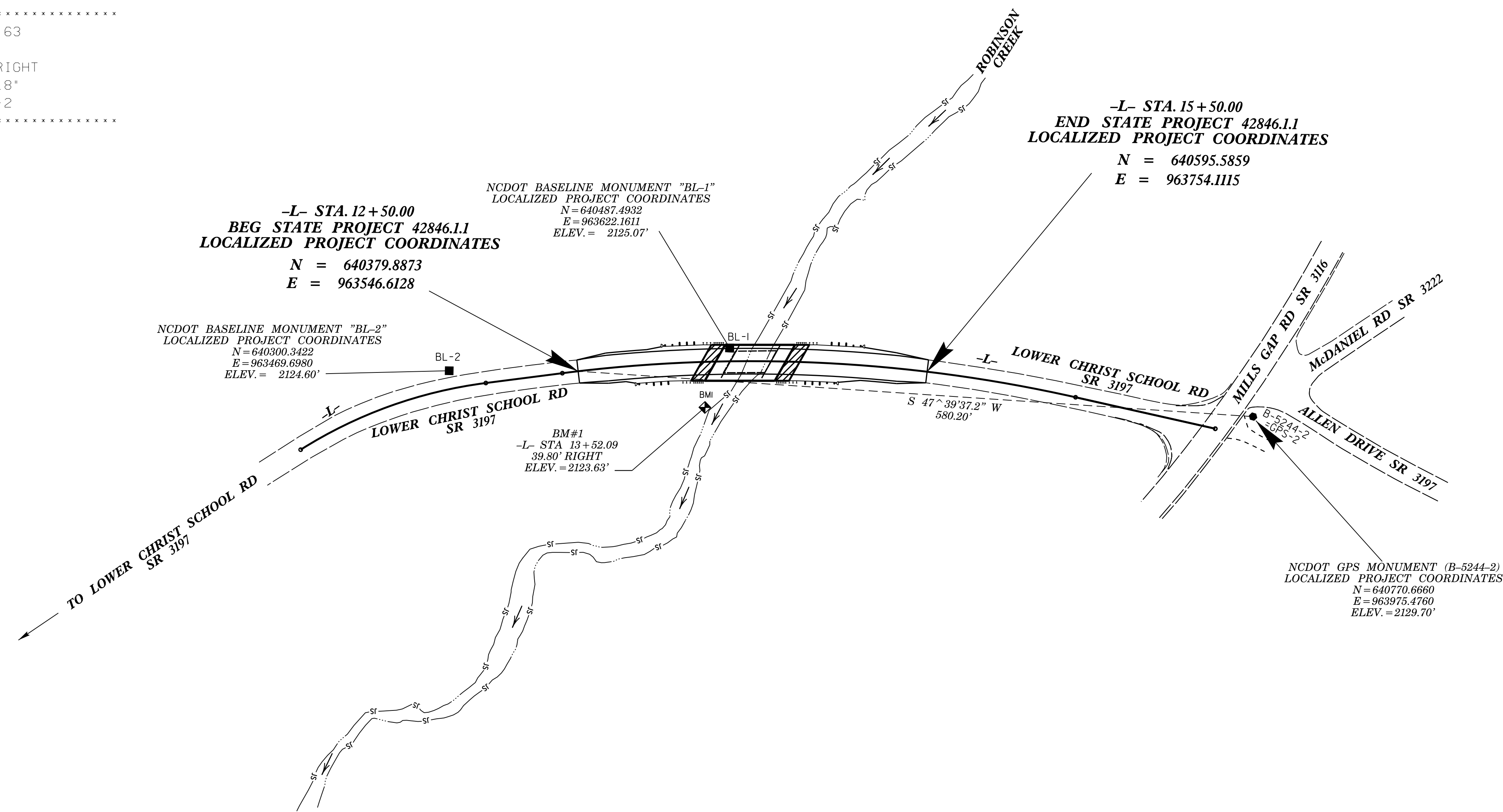
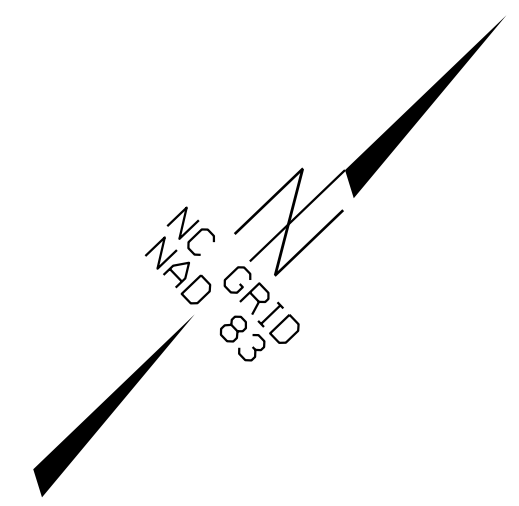

NOTES:

1. THE CONTROL DATA FOR THIS PROJECT CAN BE FOUND ELECTRONICALLY BY SELECTING PROJECT CONTROL DATA AT:
[HTTP://WWW.DOH.DOT.STATE.NC.US/PRECONSTRUCT/HIGHWAY/LOCATION/PROJECT/](http://www.doh.dot.state.nc.us/preconstruct/highway/location/project/)
 THE FILES TO BE FOUND ARE AS FOLLOWS:
 B5422_LS_CONTROL.TXT
 SITE CALIBRATION INFORMATION HAS NOT BEEN PROVIDED FOR THIS PROJECT. IF FURTHER INFORMATION IS NEEDED, PLEASE CONTACT THE LOCATION AND SURVEYS UNIT.
- INDICATES GEODETIC CONTROL MONUMENTS USED OR SET FOR HORIZONTAL PROJECT CONTROL BY THE NCDOT LOCATION AND SURVEYS UNIT.
 PROJECT CONTROL ESTABLISHED USING GLOBAL POSITIONING SYSTEM.
 NETWORK ESTABLISHED FROM NGS ONLINE POSITIONING SERVICE (OPUS)

DATUM DESCRIPTION

THE LOCALIZED COORDINATE SYSTEM DEVELOPED FOR THIS PROJECT IS BASED ON THE STATE PLANE COORDINATES ESTABLISHED BY NCGS FOR MONUMENT "B-5244-2 = GPS-2" WITH NAD 83 STATE PLANE GRID COORDINATES OF NORTHING: 640770.6660(ft) EASTING: 963975.4760(ft) ELEVATION: 2129.70(ft)
 THE AVERAGE COMBINED GRID FACTOR USED ON THIS PROJECT (GROUND TO GRID) IS: 0.99963296
 THE N.C. LAMBERT GRID BEARING AND LOCALIZED HORIZONTAL GROUND DISTANCE FROM "B-5244-2 = GPS-2" TO -L- STATION 12+50.00 IS S 47°39'37.2" W 580.20'
 ALL LINEAR DIMENSIONS ARE LOCALIZED HORIZONTAL DISTANCES
 VERTICAL DATUM USED IS NAVD 88

NOTE: DRAWING NOT TO SCALE

REVISIONS

8/17/99

19-NOV-2015 09:05 B5244_1s_1c.dgn
 963975.4760 640770.6660