

NAD 83/NSRS 2007

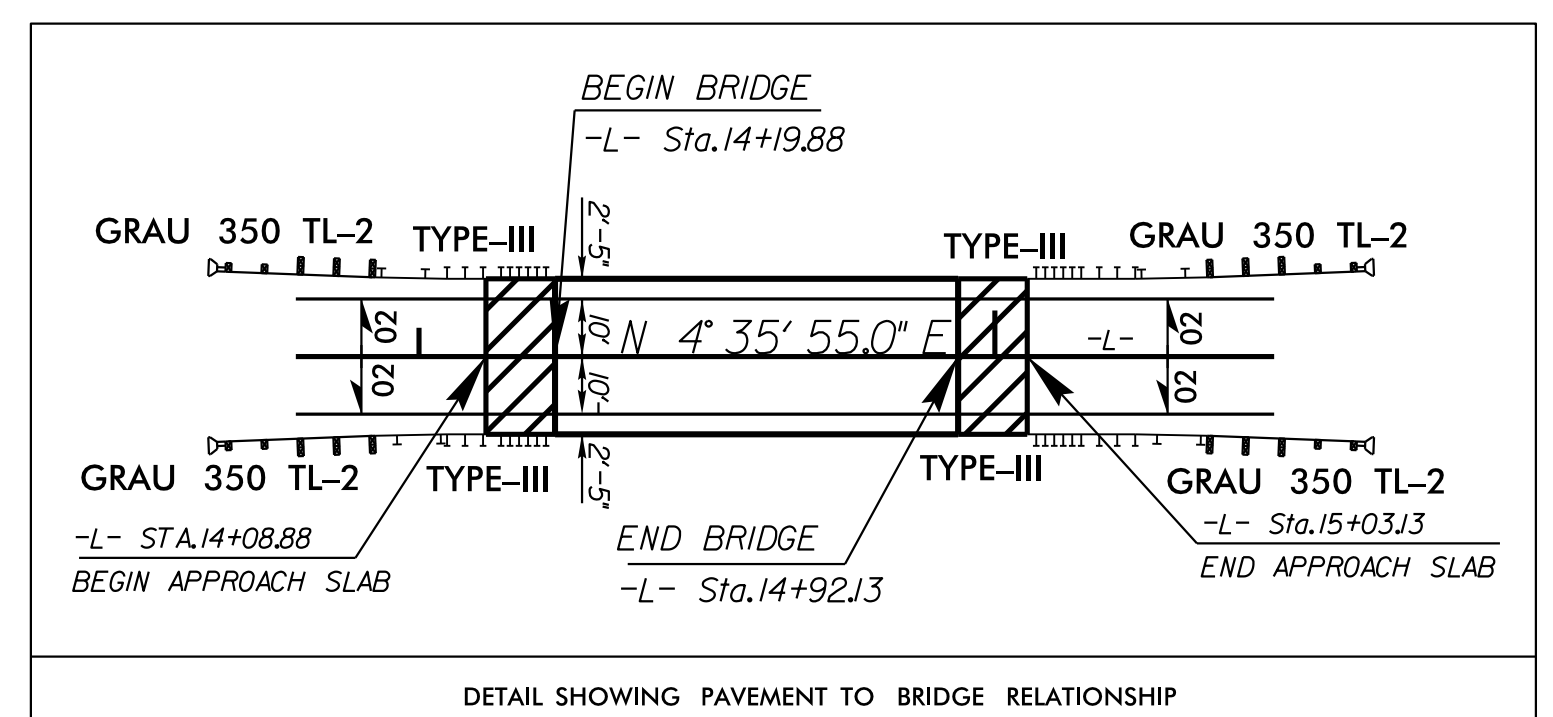

APPROACH SLAB

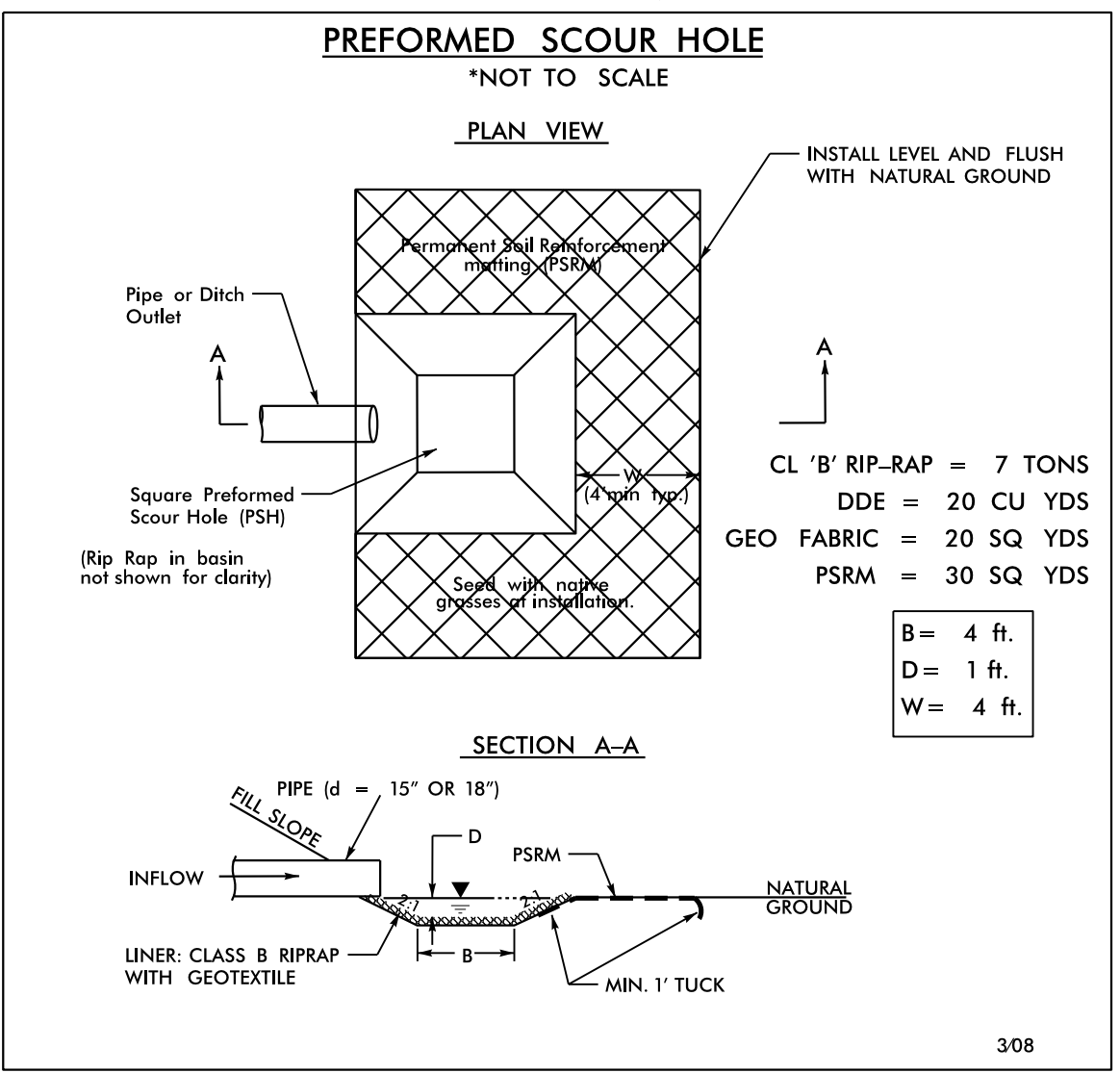
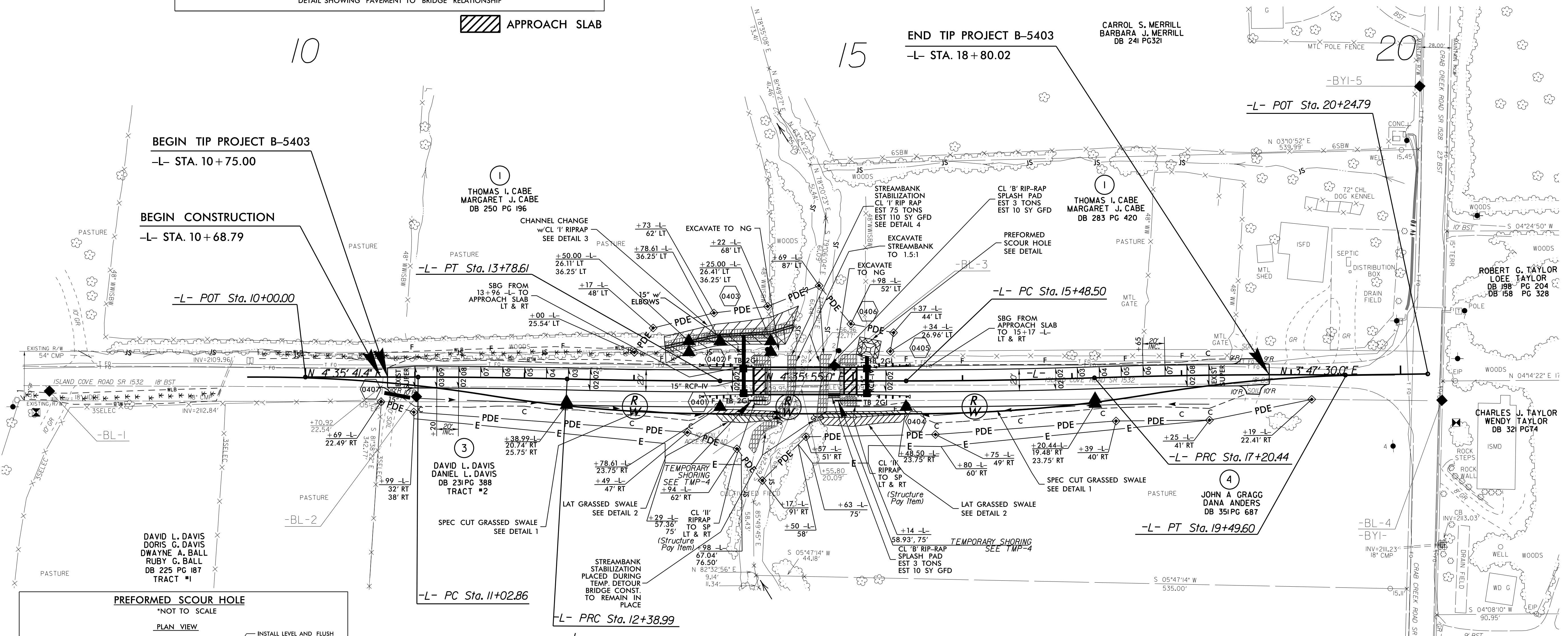

PI Sta 11+70.93
 $\Delta = 1' 29' 08.5" (RT)$
 $D = 1' 05' 28.9"$
 $L = 136.13'$
 $T = 68.07'$
 $R = 5,250.00'$
 $SE = SEE PLAN$

PI Sta 13+08.81
 $\Delta = 1' 31' 25.5" (LT)$
 $D = 1' 05' 28.9"$
 $L = 139.62'$
 $T = 69.81'$
 $R = 5,250.00'$
 $SE = SEE PLAN$

PI Sta 18+35.04
 $\Delta = 2' 30' 03.2" (RT)$
 $D = 1' 05' 28.9"$
 $L = 229.16'$
 $T = 114.60'$
 $R = 5,250.00'$
 $SE = SEE PLAN$

PI Sta 16+34.48
 $\Delta = 1' 52' 35.3" (LT)$
 $D = 1' 05' 28.9"$
 $L = 171.94'$
 $T = 85.98'$
 $R = 5,250.00'$
 $SE = SEE PLAN$

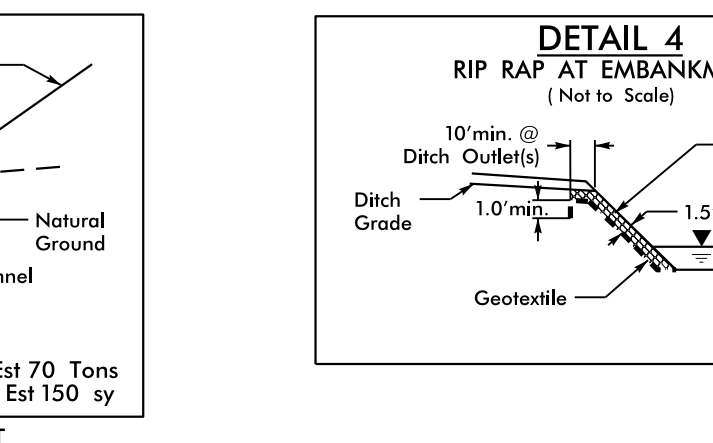
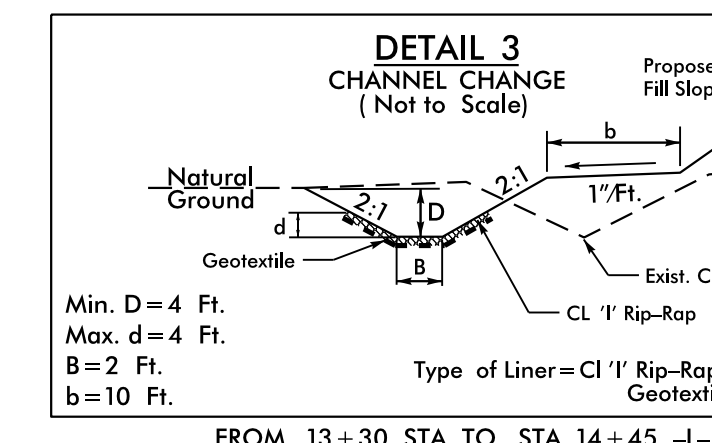
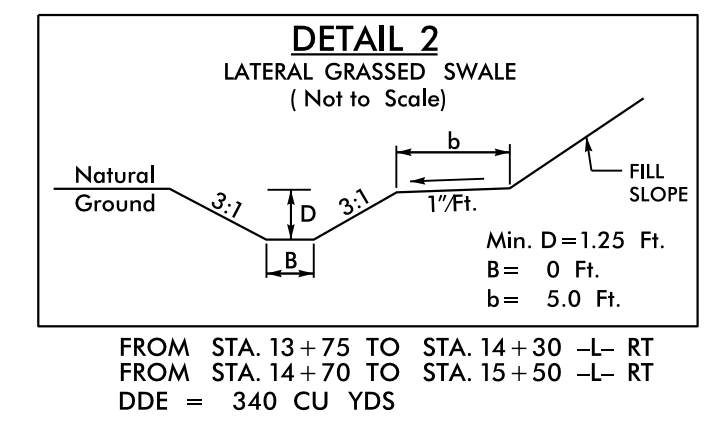
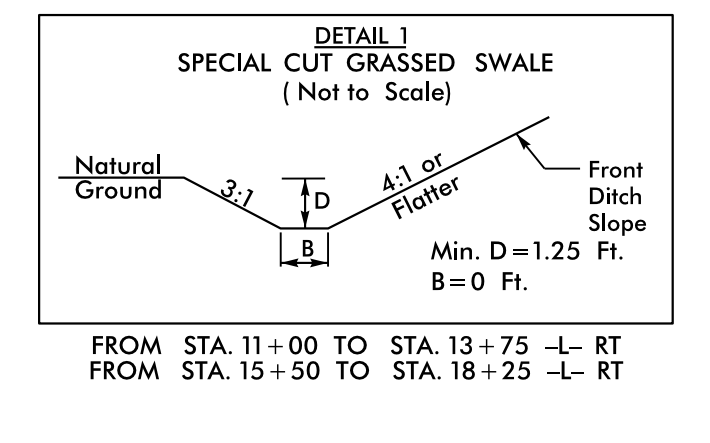

SEE SHEET 5 FOR PROFILES
 SEE SHEET S1 THRU S14 FOR STRUCTURE PLANS

8/17/99
 REVISIONS
 11-NOV-2015 09:53 B5403.Rdy.psh4.dgn
 308