

PAVEMENT SCHEDULE	
C1	PROP. APPROX. 2.5" ASPHALT CONCRETE SURFACE COURSE, TYPE SF9.5A, AT AN AVERAGE RATE OF 137.5 LBS. PER SQ. YD. IN EACH OF TWO LAYERS.
C2	PROP. VAR. DEPTH ASPHALT CONCRETE SURFACE COURSE, TYPE SF9.5A, AT AN AVERAGE RATE OF 110 LBS. PER SQ. YD. PER 1" DEPTH. TO BE PLACED IN LAYERS NOT TO EXCEED 1 1/2" IN DEPTH.
E1	PROP. APPROX. 4" ASPHALT CONCRETE BASE COURSE, TYPE B25.0B, AT AN AVERAGE RATE OF 456 LBS. PER SQ. YD.
E2	PROP. VAR. DEPTH ASPHALT CONCRETE BASE COURSE, TYPE B25.0B, AT AN AVERAGE RATE OF 114 LBS. PER SQ. YD. PER 1" DEPTH. TO BE PLACED IN LAYERS NOT LESS THAN 3" IN DEPTH OR GREATER THAN 5 1/2" IN DEPTH.
J1	PROP. 6" AGGREGATE BASE COURSE
P	PRIME COAT AT THE RATE OF 0.35 GALLONS PER SQ. YARD
R1	SHOULDER BERM GUTTER
T	EARTH MATERIAL
U	EXISTING PAVEMENT TO BE RETAINED.
W1	VAR. DEPTH ASPHALT WEDGING (SEE DETAIL)
W2	VAR. DEPTH ASPHALT WEDGING FOR WEARING SURFACE (SEE DETAIL)

NOTE: PAVEMENT EDGE SLOPES ARE 1:1 UNLESS SHOWN OTHERWISE.

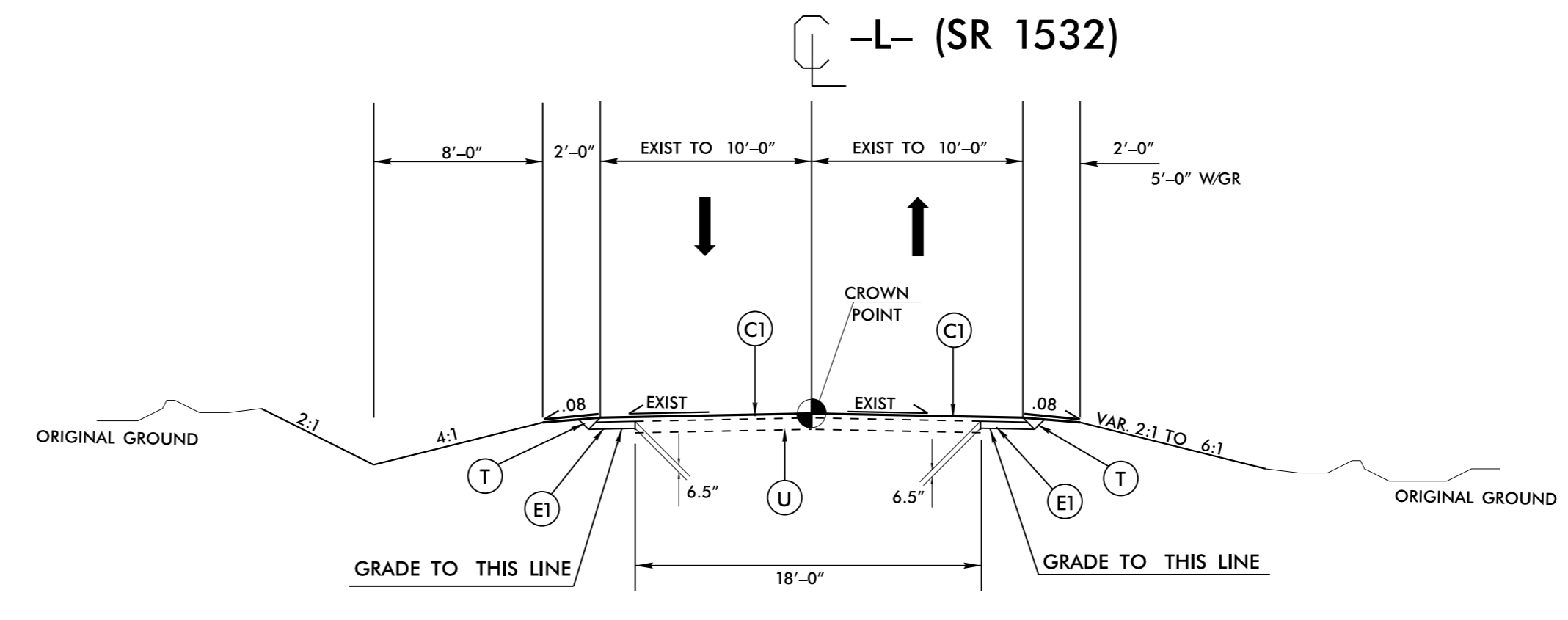

TYPICAL SECTION NO. 1

USE TYPICAL SECTION NO. 1  
 -L- STA. 10+75 TO STA. 11+00  
 -L- STA. 18+25 TO STA. 18+80.02

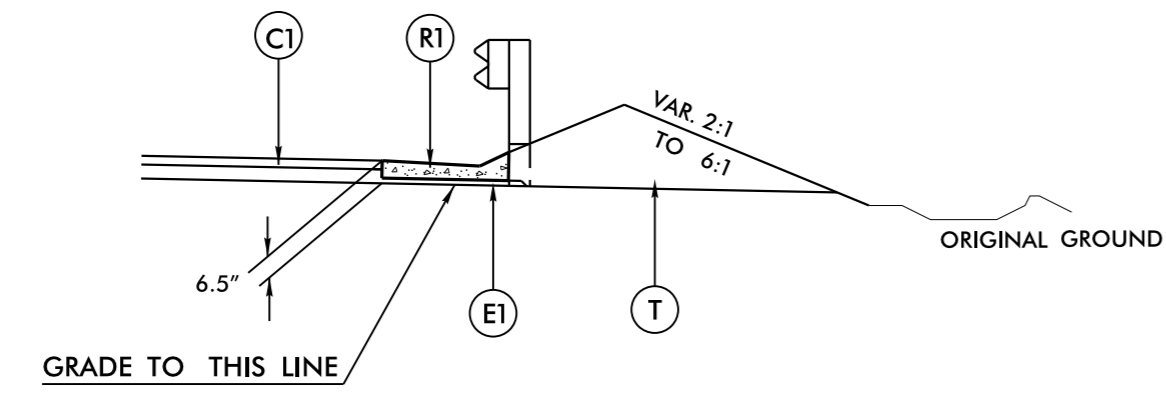
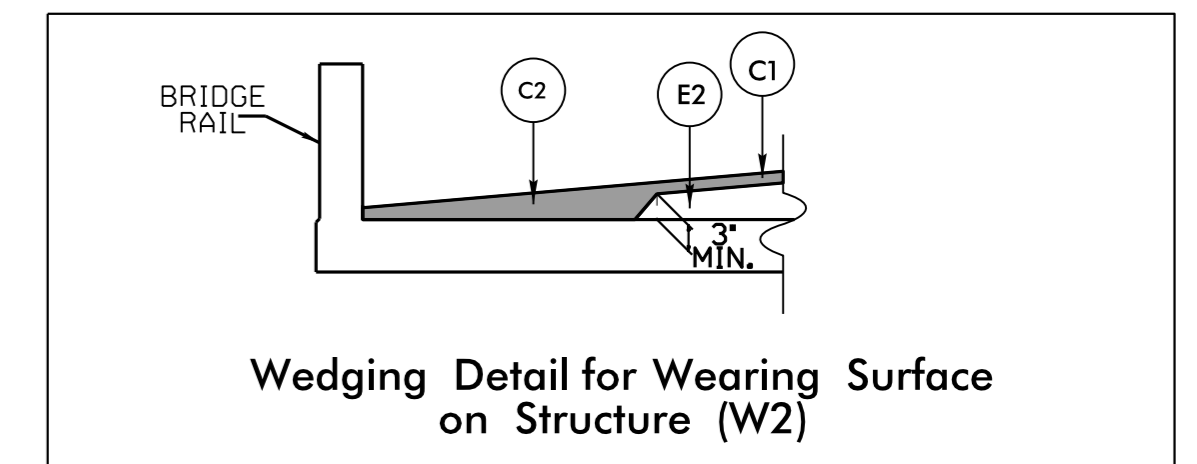

SHOULDER BERM GUTTER DETAIL:  
 -L- STA. 13+96.00 TO STA. 14+09.49 (Begin Approach Slab) LT & RT.  
 -L- STA. 15+03.49 (End Approach Slab) TO STA. 15+17.00 LT & RT.

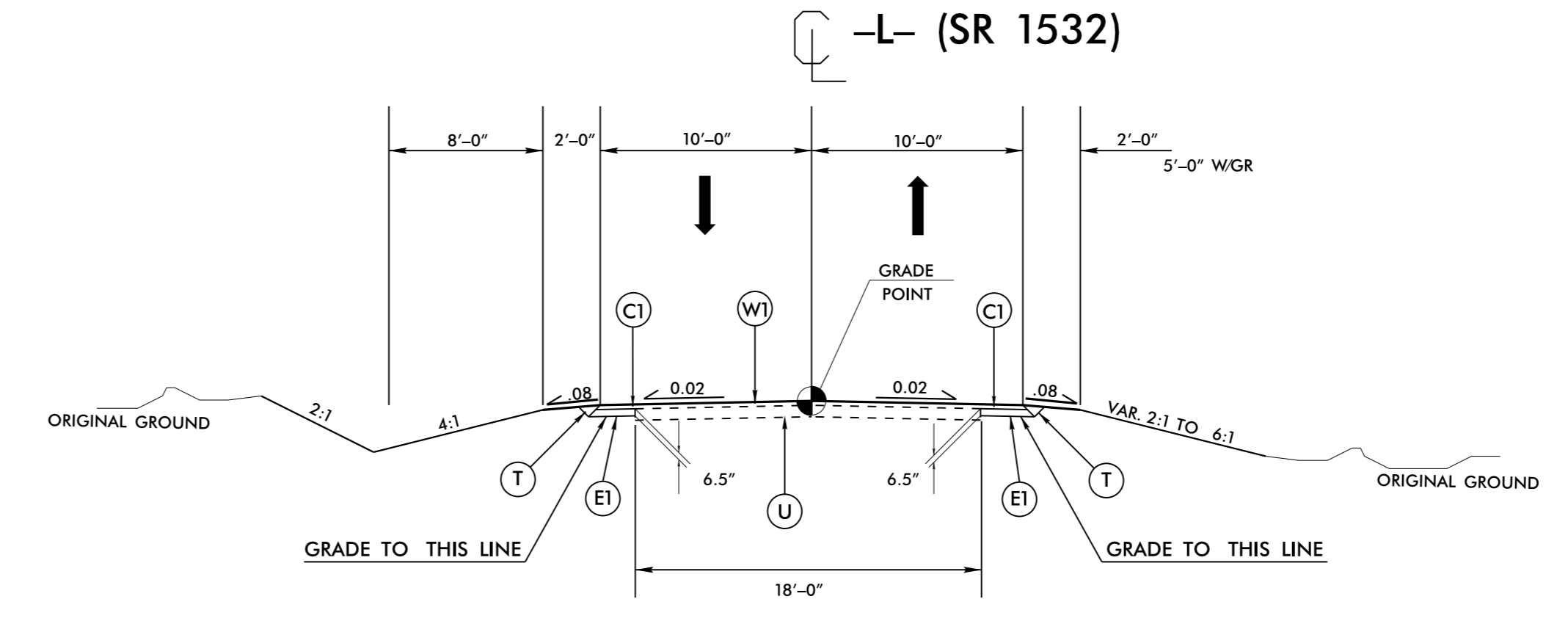

TYPICAL SECTION NO. 2

USE TYPICAL SECTION NO. 2  
 -L- STA. 11+00 TO STA. 13+69.88  
 -L- STA. 15+42.13 TO STA. 18+25

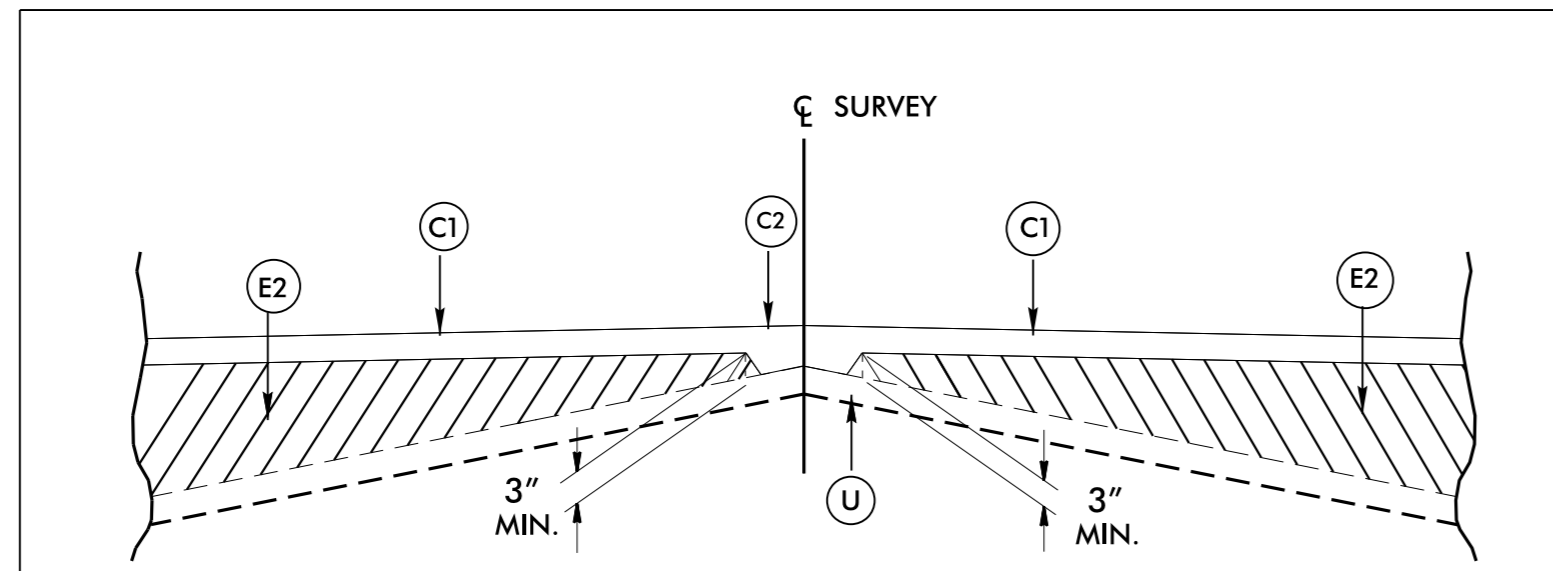

Detail Showing Method of Wedging (W1)  
 -L- STA. 11+00.00 TO STA. 13+71.49  
 -L- STA. 15+41.49 TO STA. 18+25.00

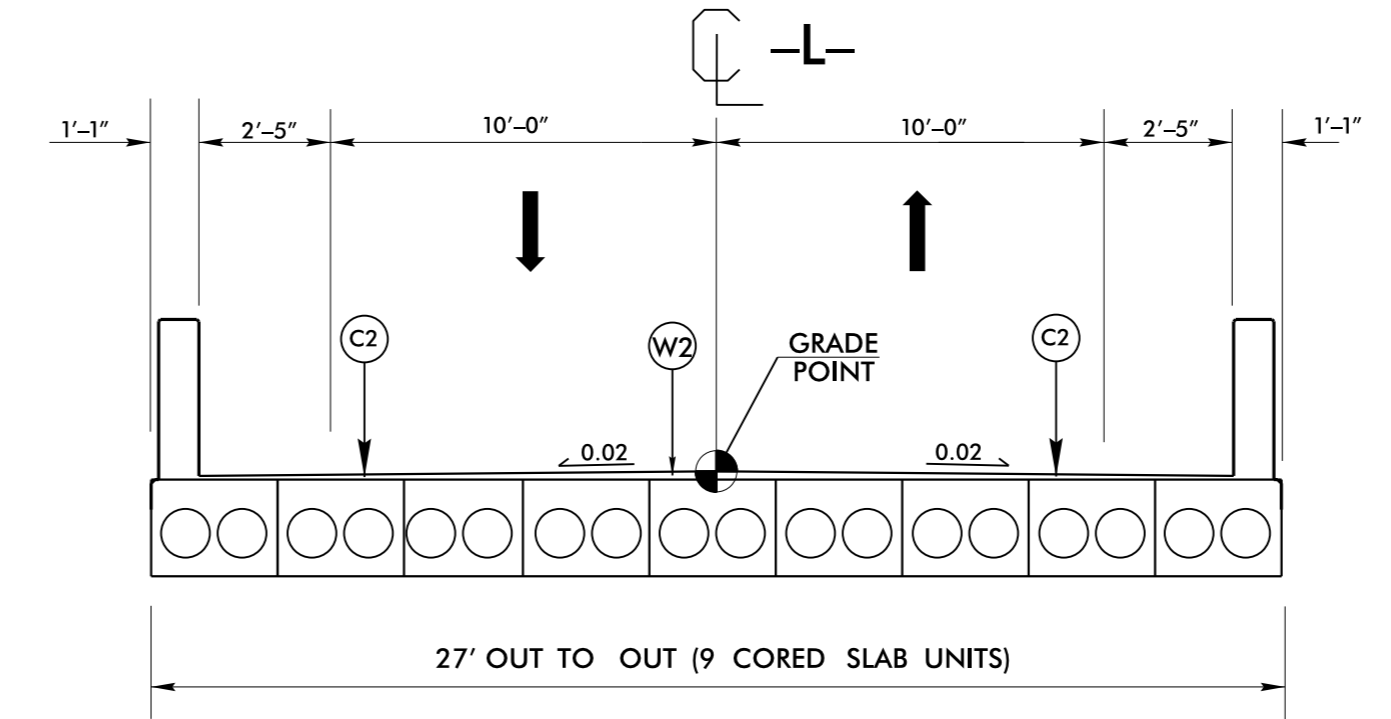

TYPICAL SECTION OF CORED SLAB BRIDGE

-L- STA. 14+19.88 (BEGIN BRIDGE)  
 TO -L- STA. 14+92.13 (END BRIDGE)