

PROJECT REFERENCE NO. B-5395	SHEET NO. EC-5/CONST.4
RW SHEET NO.	
ROADWAY DESIGN ENGINEER	HYDRAULICS ENGINEER

CULVERT CONSTRUCTION SEQUENCE STA. 21+66 -L-

PHASE I

1. CONSTRUCT STILLING BASIN (125 CY).
2. REMOVE EXISTING BRIDGE.
3. CONSTRUCT IMPERVIOUS DIKE A, DIVERTING FLOW.
4. CONSTRUCT BARREL 1 OF PROPOSED CULVERT.
5. REMOVE IMPERVIOUS DIKE A.

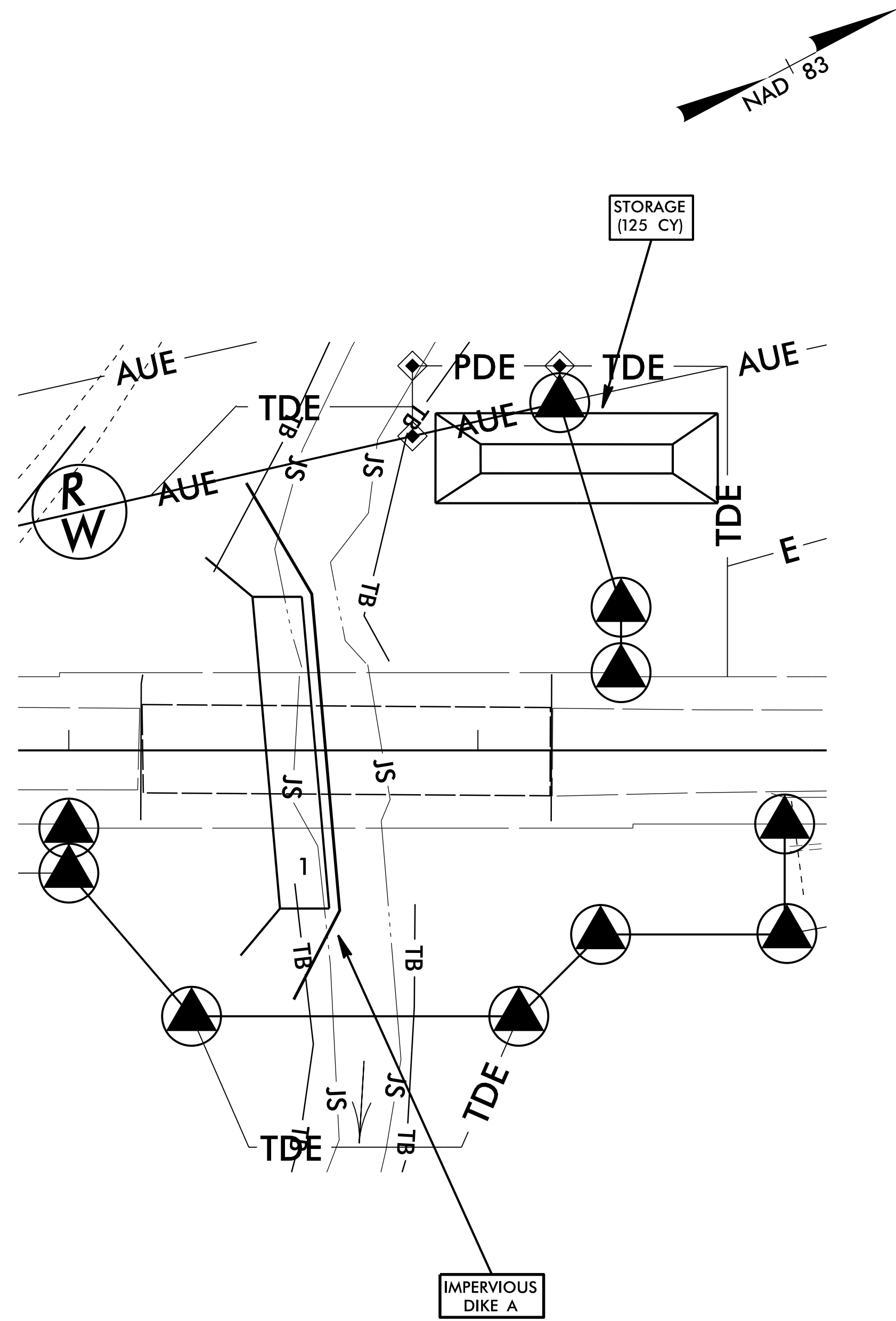

PHASE II

6. CONSTRUCT IMPERVIOUS DIKES B AND C, DIVERTING FLOW THROUGH COMPLETED BARREL 1 OF PROPOSED CULVERT.
7. CONSTRUCT BARRELS 2 AND 3 OF PROPOSED CULVERT, INCLUDING INLET/OUTLET CHANNEL IMPROVEMENTS AND LOW FLOW BENCH FOR BARREL 3.
8. REMOVE IMPERVIOUS DIKES B AND C.

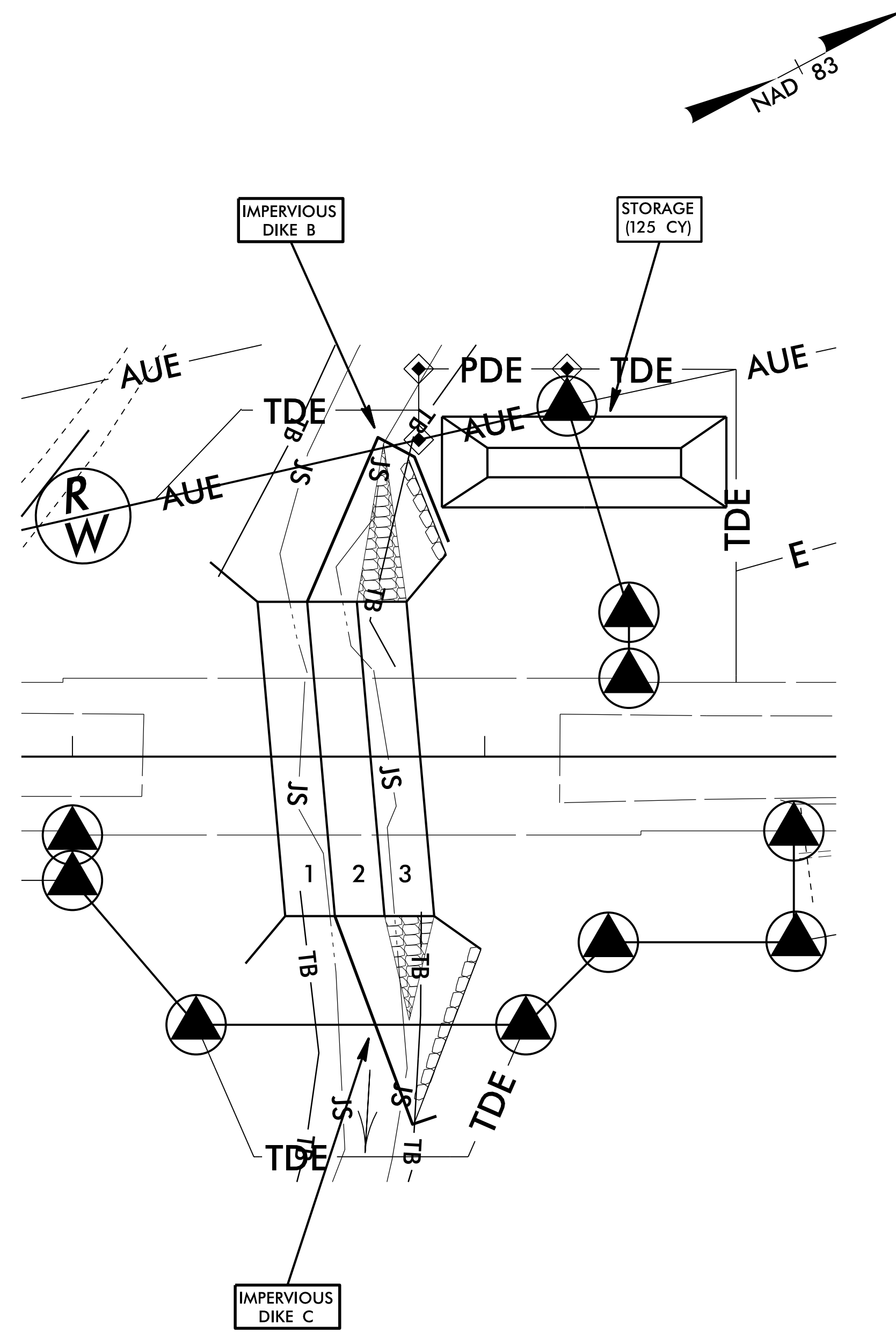

PHASE III

9. CONSTRUCT IMPERVIOUS DIKES D AND E, DIVERTING FLOW THROUGH BARREL 2.
10. CONSTRUCT INLET/OUTLET CHANNEL IMPROVEMENTS AND LOW FLOW BENCH FOR BARREL 1.
11. REMOVE IMPERVIOUS DIKES D AND E, AND REMOVE STILLING BASIN.
12. COMPLETE ROADWAY.

