

**This electronic collection of documents is provided  
for the convenience of the user  
and is Not a Certified Document –**

**The documents contained herein were originally issued  
and sealed by the individuals whose names and license  
numbers appear on each page, on the dates appearing  
with their signature on that page.**

**This file or an individual page  
shall not be considered a certified document.**

09/08/99

TIP PROJECT: B-5341

See Sheet 1A For Index of Sheets  
See Sheet 1B For Conventional Plan Sheet Symbols  
See Sheet 1C-1 For Survey Control Sheet

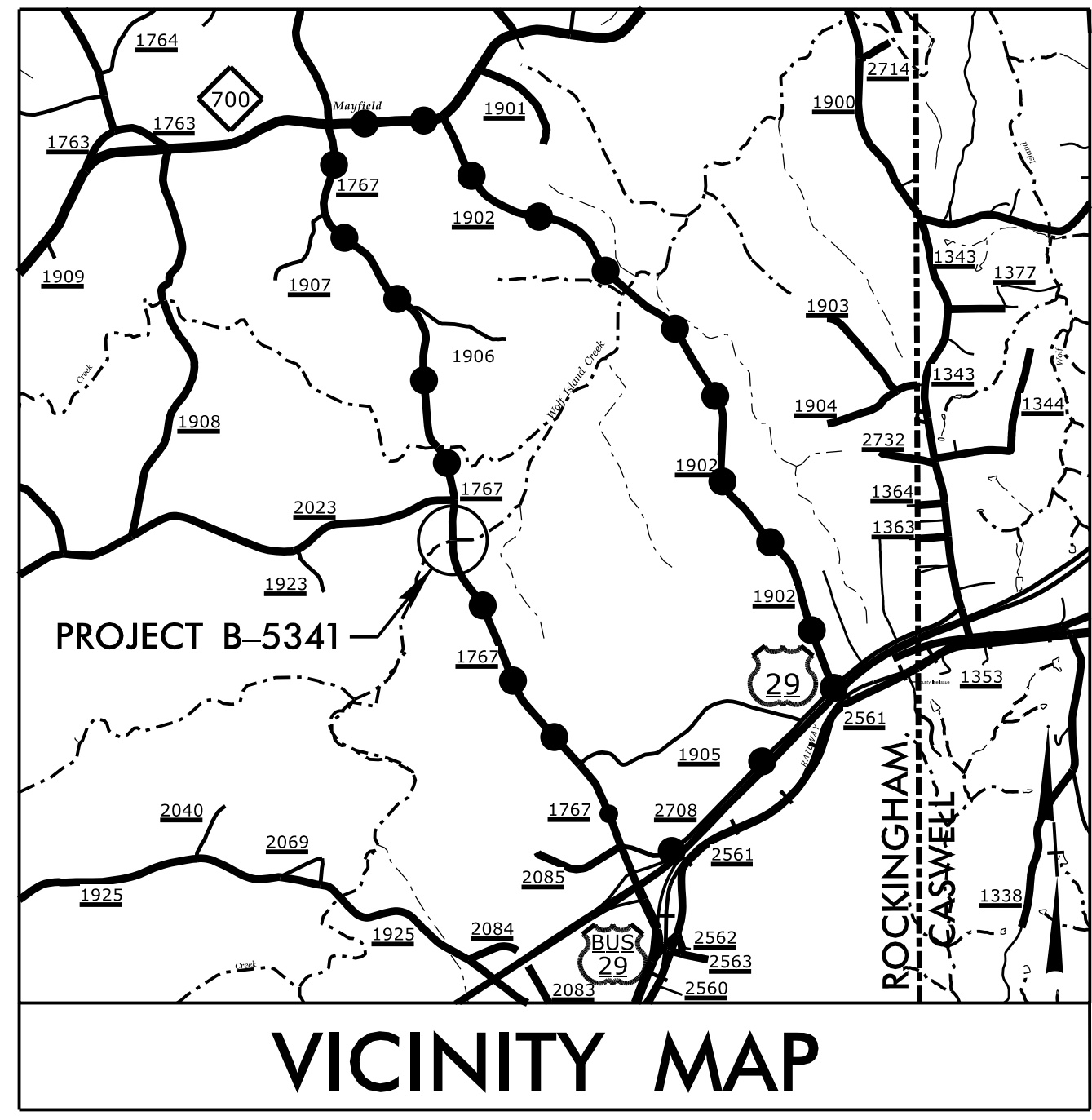

VICINITY MAP

DETOUR ROUTE

STATE OF NORTH CAROLINA  
DIVISION OF HIGHWAYS

UTILITIES BY OTHERS PLANS  
ROCKINGHAM COUNTY

LOCATION: BRIDGE NO. 110 OVER WOLF ISLAND CREEK  
ON SR 1767 (MAYFIELD ROAD)

TYPE OF WORK: UTILITY WORK

T.I.P. NO.	SHEET NO.
B-5341	UO-1

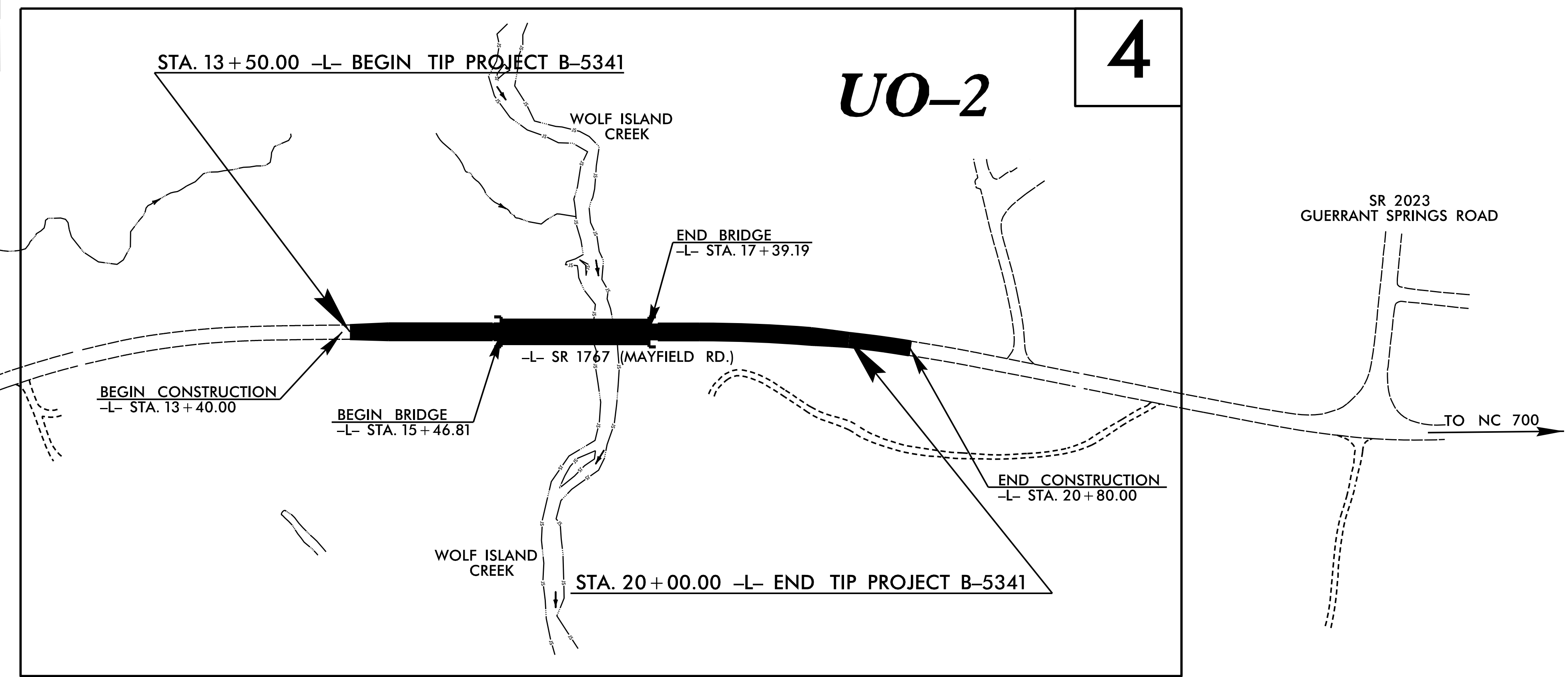

UO-2

4

INDEX OF SHEETS

SHEET NO.	DESCRIPTION
UO-1	TITLE SHEET
UO-2	UTILITY BY OTHERS PLAN SHEET

UTILITY OWNERS ON PROJECT

- (A) DUKE ENERGY, POWER
- (B) AT&T, TELEPHONE

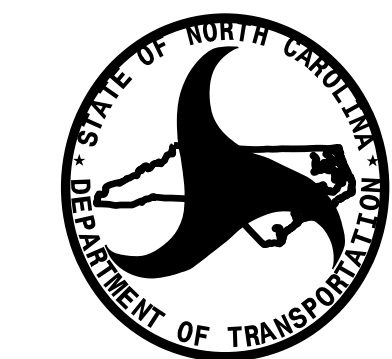

PREPARED IN THE OFFICE OF:  
DIVISION OF HIGHWAYS  
UTILITIES UNIT  
UTILITIES ENGINEERING  
1555 MAIL SERVICES CENTER  
RALEIGH, NC 27699-1555  
PHONE (919) 707-6690  
FAX (919) 250-4151

Roger Worthington, P.E. UTILITIES SECTION ENGINEER  
 Steve McKee, P.E. UTILITIES SQUAD LEADER PROJECT ENGINEER  
 Jamshid Hafshejani UTILITIES PROJECT DESIGNER

\$\$\$\$\$ SYSTEM \$\$\$\$\$\$  
\$\$\$\$\$ DGN \$\$\$\$\$\$  
\$\$\$\$\$ USERNAME \$\$\$\$\$\$

NAD 83/NSRS 2007 UTILITIES BY OTHERS

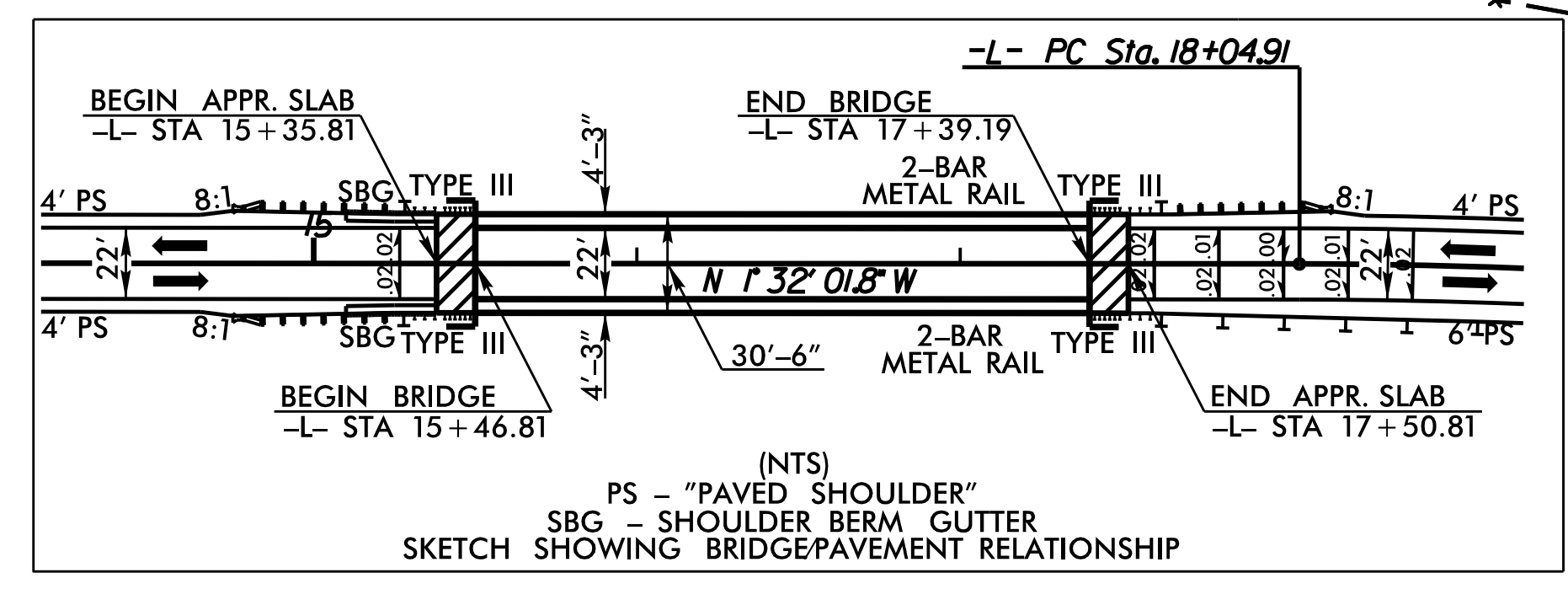

-L-		
PI Sta 11+20.61	PI Sta 12+94.22	PI Sta 19+81.00
$\Delta = 10' 54" 02.5' (RT)$	$\Delta = 2' 01" 20.6' (RT)$	$\Delta = 11' 06' 48.9' (RT)$
$D = 6' 21' 58.3'$	$D = 1' 08' 45.3'$	$D = 3' 09' 55.8'$
$L = 171.23'$	$L = 176.49'$	$L = 351.08'$
$T = 85.87'$	$T = 88.25'$	$T = 176.09'$
$R = 900.00'$	$R = 5,000.00'$	$R = 1,810.00'$
	SE = SEE PLANS	SE = SEE PLANS

NOTE:  
1- Duke Energy- Power poles and aerial lines will remain in place during construction and upon completion of the bridge, they will replace and re-install their down guys to match new grade.

DECK DRAINS REQUIRED  
5" X 4" SLOTS ON 12.0' CENTERS  
FROM STA 15+61 TO STA 16+33 LT.  
FROM STA 15+61 TO STA 16+33 RT.

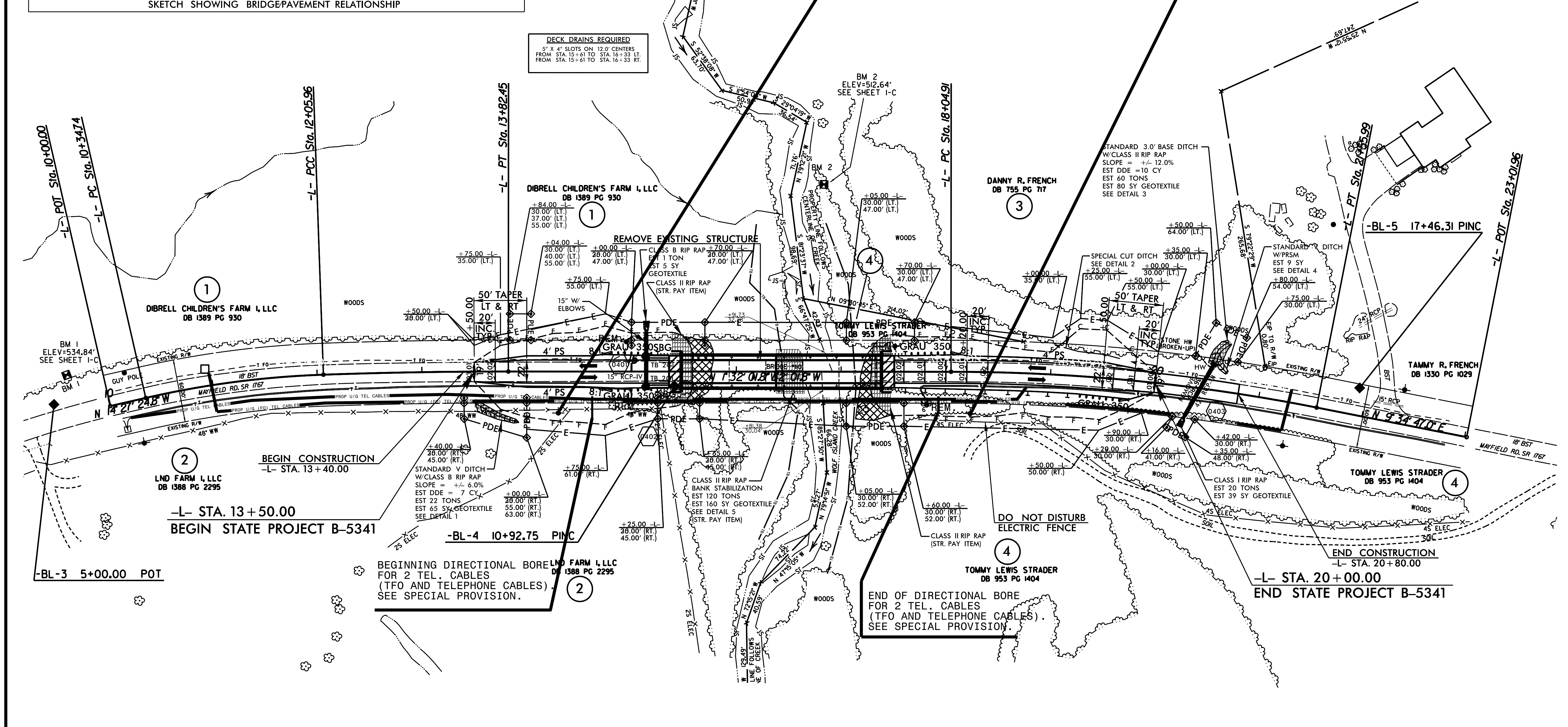

EXCAVATE EXISTING ROAD FILL TO NATURAL GROUND = 180 CY (STRUCTURE PAY ITEM)

NOTE: SBG - SHOULDER BERM GUTTER  
-L- STA. 15+10.00 TO BEGIN APPROACH SLAB LT. & RT.

5/14/99